

**Bench Mark:**  
Chiseled square on Northwest wing wall of existing bridge Elev. 629.60

**Description of Improvement:**  
The improvement includes the replacement of the existing superstructure with a widened cross section. The existing structure 098-0044 built in 1933 is a single span reinforced concrete deck girder 40'-0" front face to front face of abutments and 25'-0" out to out. The existing superstructure shall be replaced with single span prestressed deck beams. Existing abutments to be rehabilitated and widened. Phased construction shall be used to maintain one lane of traffic at all times. No Salvage.

**WATERWAY INFORMATION**

Drainage Area		40.2 sq. mi. Low Grade Elev. 626.4		At Sta. 92+03				
Flood	Frq.	C.F.S.	Openng Sq. Ft.	Met.	Head-Ft.	Headwater Elev.		
		Exist.	Prop.	E.V.E.	Exist.	Prop.		
Design:	30	2,130	326	629.3	1.7	1.7	626.0	628.0
Base:	100	2,680	334	626.9	2.20	2.00	629.10	629.90
Overlapping:	80	2,510	342	626.7	1.84	---	---	---
Max. Calc.:	500	---	---	---	---	---	---	---

PROJECT NO.	SECTION	SHEET NO.	TOTAL SHEETS
F.A.S. 200	141B	16	5

SHEET NO. 1  
9 SHEETS

**DESIGN DATA**  
DESIGN SPECIFICATIONS: A.A.S.E.T.O. 1977, 1978, 1979, 1980, 1981 INTERIMS  
DESIGN LOAD: HS 20  
ALLOW 25 POUNDS PER SQUARE FOOT FOR FUTURE WEARING SURFACE.

**DESIGN STRESSES:**  
CONCRETE CAST IN PLACE  
f<sub>c</sub> = 3,500 P.S.I.  
f<sub>s</sub> = 270,000 P.S.I.  
f<sub>s</sub> = 189,000 P.S.I.  
f<sub>s</sub> = 24,000 P.S.I.  
f<sub>s</sub> = 60,000 P.S.I.

PRECAST PRESTRESSED CONCRETE  
f<sub>c</sub> = 5,000 P.S.I.  
f<sub>c</sub> = 4,000 P.S.I.  
f<sub>c</sub> = 1,800 P.S.I.  
f<sub>s</sub> = 270,000 P.S.I.  
f<sub>s</sub> = 189,000 P.S.I.  
f<sub>s</sub> = 24,000 P.S.I.  
f<sub>s</sub> = 60,000 P.S.I.

REINFORCEMENT  
f<sub>s</sub> = 24,000 P.S.I.  
f<sub>s</sub> = 60,000 P.S.I.

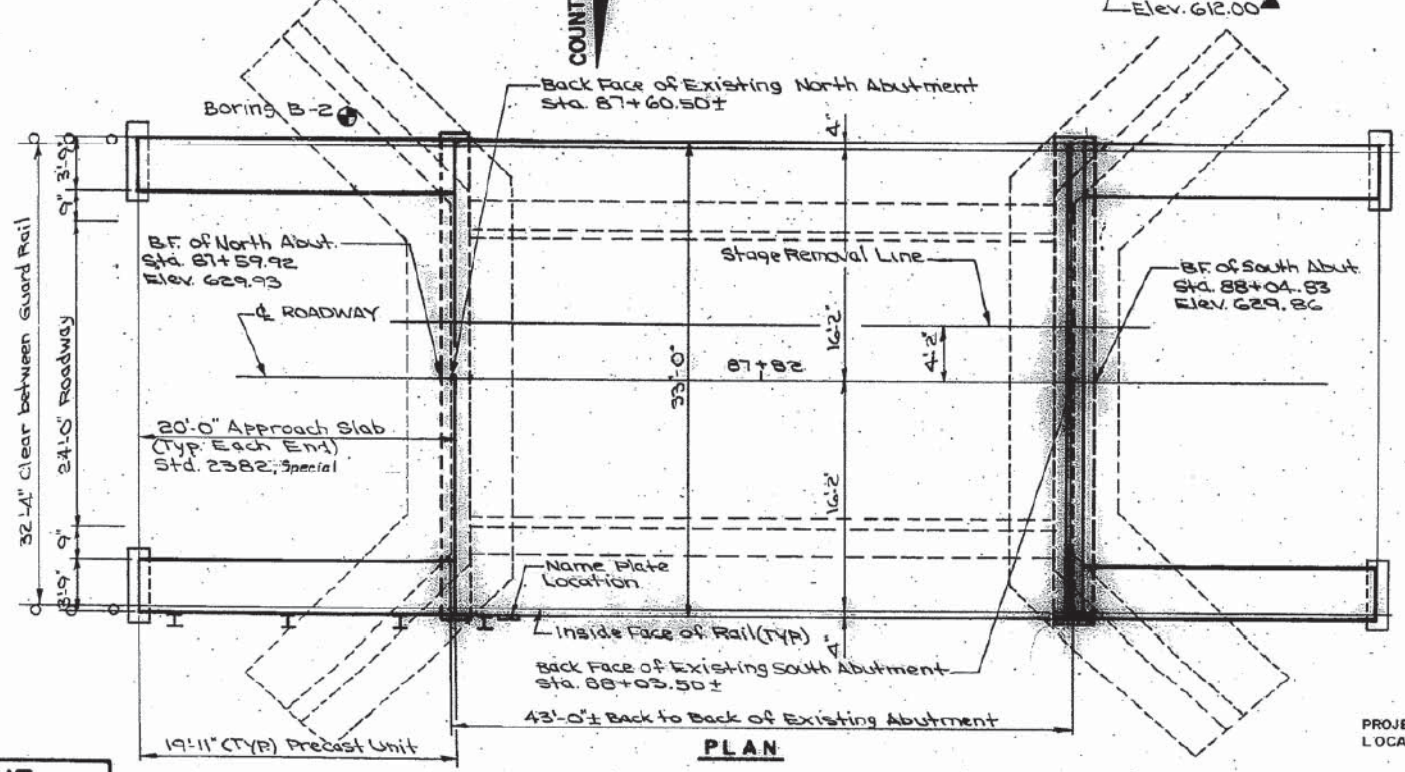
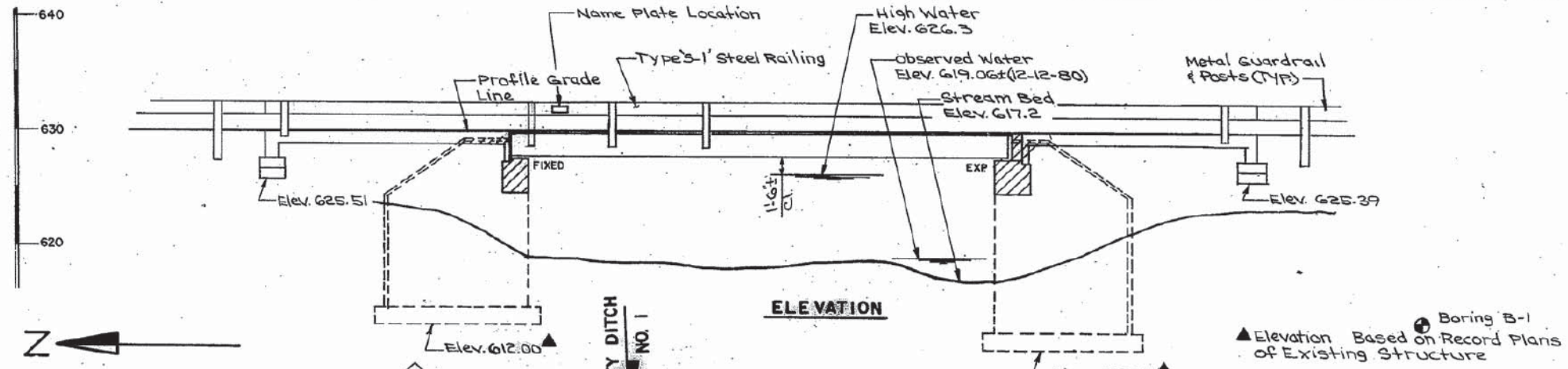

STATION 87+82.00  
COUNTY DITCH NO. 1  
BUILT 198  
F.A.S. RT. 200 SEC. 141BR  
F.A. PROJECT BR-S-200 (104)  
LOADING HS20  
\*STR. NO. 629-0044

**NAME PLATE**  
(See Std. 2113)

APPROVED  
FOR STRUCTURAL ADEQUACY ONLY  
*Carl E. Thompson*  
Engineer of Bridges and Structures

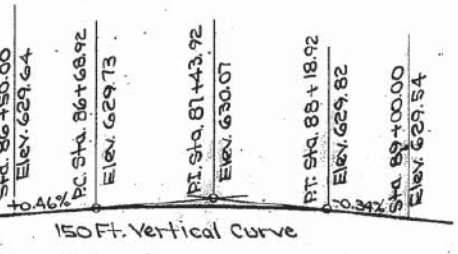
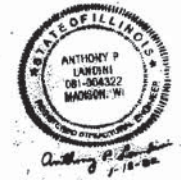
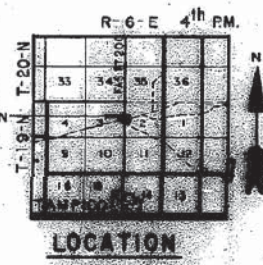

**PROFILE GRADE LINE**

**DONOHUE**  
ENGINEERS & ARCHITECTS

DESIGN	DESIGN CH'D	DRAWN	CHECKED
BY: PRZ.	BY: J.T.T.	BY: J.A.R.	BY: L.N.F.

PROJECT NUMBER 1310.201

REVISIONS	
NAME	DATE

**GENERAL PLAN**  
F.A.S. RTE. 200 (ILL 172)  
OVER COUNTY DITCH R.O.1  
F.A.S. RTE. 200 SECTION 141 BR  
WHITESIDE COUNTY  
STA. 87+ 82.00