

PRE-STAGE 1 CONSTRUCTION NOTES

INSTALL TRAFFIC CONTROL PER STANDARD 701326.

CONSTRUCT CULVERT (SN 008-1106) AT PRIVATE ENTRANCE AT STA 671+84, PLACING PROPOSED EMBANKMENT AS NECESSARY.

REROUTE FLOW FROM EXISTING CULVERT TO PROPOSED CULVERT.

FILL EXISING 7' X 4' CULVERT AT 670+04 AND PLACE EMBANKMENT AT ENDS OF CULVERT TO CREATE PROPOSED DITCHES.

CONSTRUCT TEMPORARY PAVEMENT TO BE USED FOR STAGE 1 TRAFFIC

STAGE 1 CONSTRUCTION NOTES

INSTALL TRAFFIC SIGNALS, TEMPORARY CONCRETE BARRIER, SIGNS AND ETC. ACCORDING TO DETAILS AND TRAFFIC CONTROL STANDARD 701321 MAINTAINING ALL TRAFFIC ON THE EASTBOUND LANE.

REMOVE STAGE 1 PORTION OF THE EXISTING BRIDGE STRUCTURES, WESTBOUND GUARDRAIL AND PAVEMENT AS SHOWN ON THE PLANS.

CONSTRUCT THE STAGE 1 PORTION OF THE PROPOSED STRUCTURES, AND APPROACH PAVEMENT,

CONSTRUCT TEMPORARY RAMP TO TRANSITION FROM PROPOSED PAVEMENT (BRIDGE AND BRIDGE APPROACH) CONSTRUCTED IN STAGE 1 TO EXISTING PAVEMENT,

CONSTRUCT TEMPORARY PAVEMENT FOR PORTION OF SHOULDERS UNDER STAGE 2 TRAFFIC AS SHOWN ON STAGE 2 MAINTENANCE OF TRAFFIC PLANS

CONSTRUCT WESTBOUND PROPOSED GUARDRAIL TO THE END OF THE BRIDGE APPROACH.

STAGE 2 CONSTRUCTION NOTES

RELOCATE THE TRAFFIC CONTROL PER STANDARD 701321 AND AS DETAILED IN THESE PLANS. REDIRECT TRAFFIC TO THE WESTBOUND.

REMOVE THE STAGE 2 PORTION OF THE EXISTING BRIDGE STRUCTURES, GUARDRAIL AND PAVEMENT AS SHOWN ON THE PLANS.

CONSTRUCT THE STAGE 2 PORTION OF THE PROPOSED STRUCTURES, APPROACH PAVEMENT, REMAINING CULVERTS AND GUARDRAIL.

REMOVE TRAFFIC SIGNALS AND ETC. CALLED FOR IN STANDARD 701321.

STAGE 3 CONSTRUCTION NOTES

PERFORM GRADE CHANGE USING LEVELING BINDER, BINDER, AND SURFACE COURSES USING STANDARD 701201

PLACE PAVEMENT MARKINGS AND ALL REMAINING WORK USING STANDARD 701201.

NOTE: A MAXIMUM 2" DROP-OFF IS ALLOWED BETWEEN OPEN LANES AT THE END OF EACH DAY.

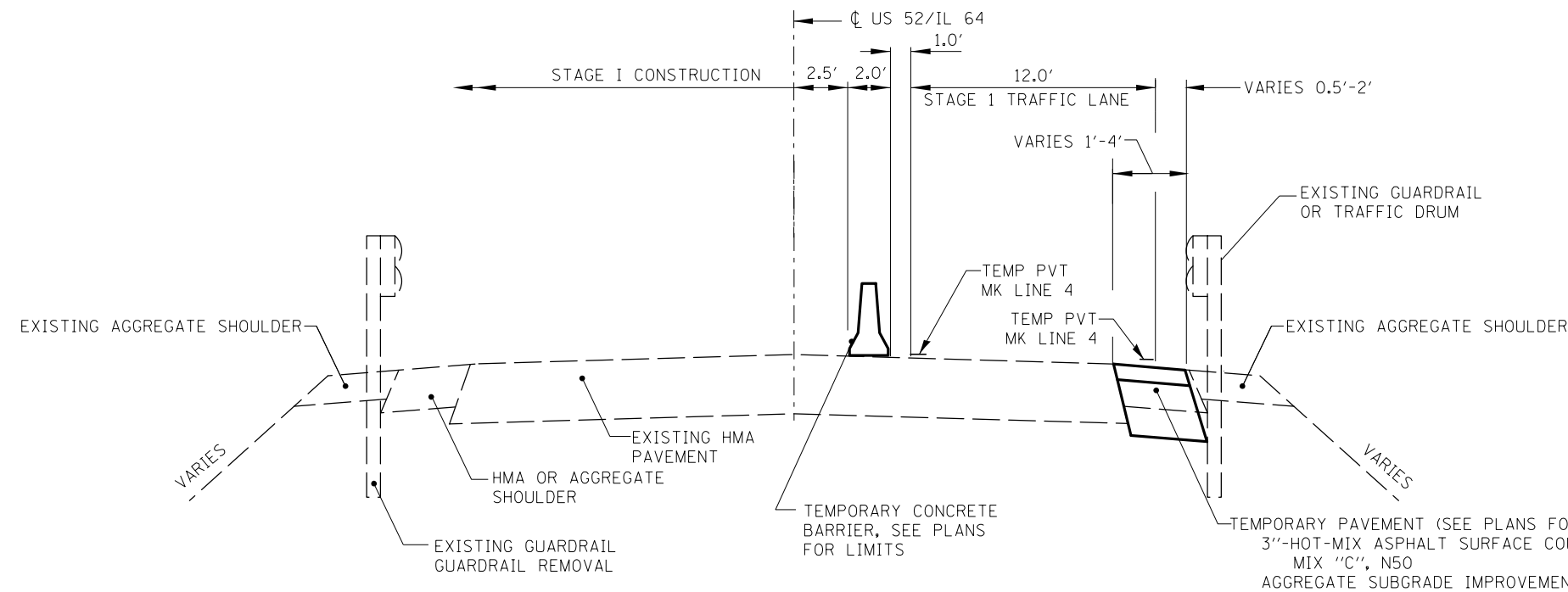

STAGE 1 TYPICAL SECTION

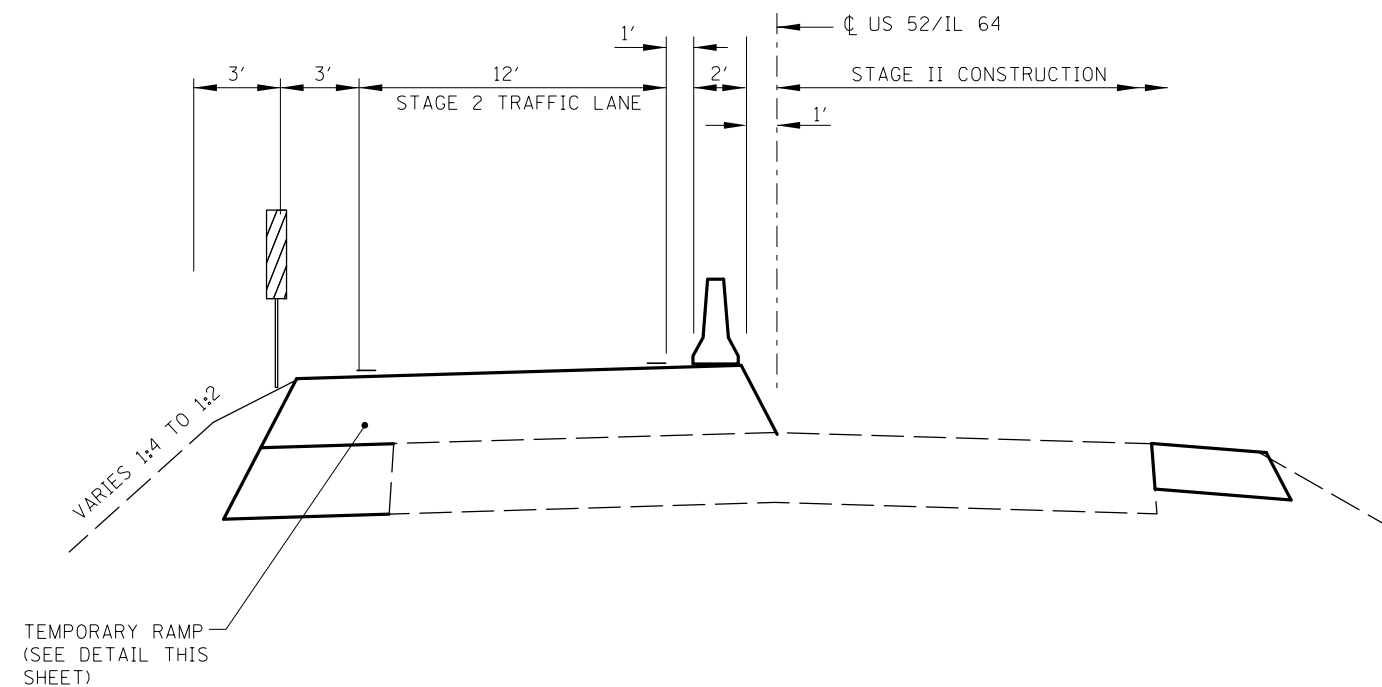

STAGE 2 TYPICAL SECTION

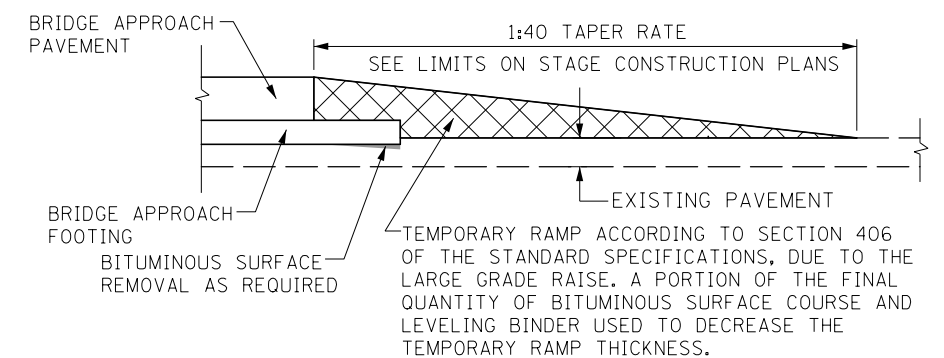

TEMPORARY RAMP
TAPER DETAIL

FILE NAME =	USER NAME = #USER#	DESIGNED - RAC	REVISED -
#FILE#		DRAWN - LCR	REVISED -
		CHECKED - DAZ	REVISED -
		DATE - 06-28-13	REVISED -

STATE OF ILLINOIS
DEPARTMENT OF TRANSPORTATION

ZROKA
engineering

Zroka Engineering, P.C.
4216 North Hermitage
Chicago, IL 60613

MAINTENANCE OF TRAFFIC
TYPICAL SECTIONS

SCALE: SHEET 1 OF 1 SHEETS STA. TO STA.

F.A.P. RTE.	SECTION	COUNTY	TOTAL SHEETS	SHEET NO.
17	4BR-5 & 4BR-6	CARROLL	150	27
CONTRACT NO. 64D83				
ILLINOIS FED. AID PROJECT				