

**FRAMING PLAN**

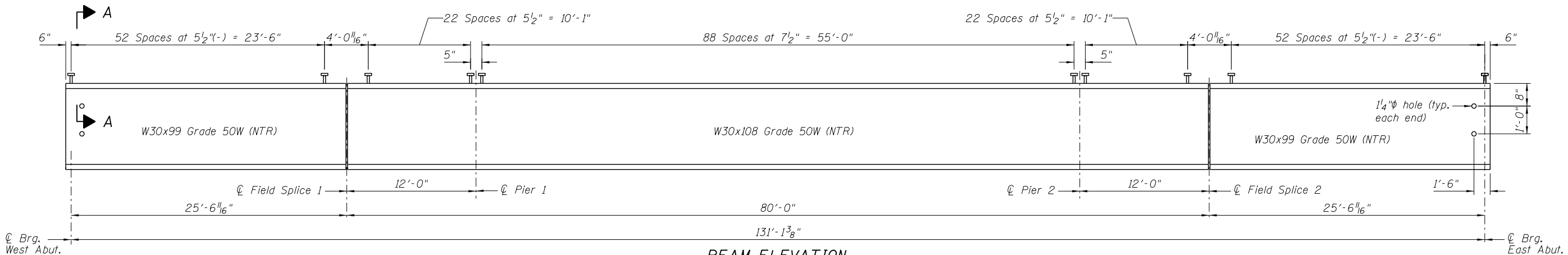

**BEAM ELEVATION**

Load carrying components designated "NTR" shall conform to the Impact Testing Requirements, Zone 2.

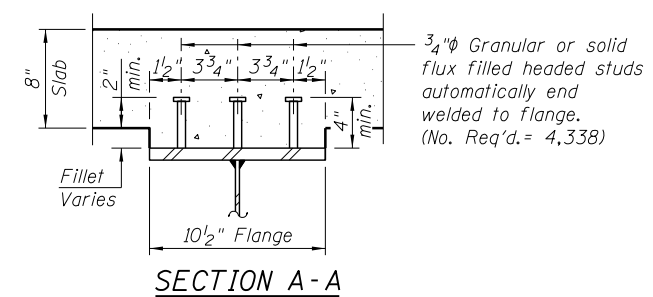

**SECTION A-A**

**TOP OF BEAM ELEVATIONS**  
(For Fabrication Only)

Beam	℄ Brg. W Abut.	℄ Field Splice 1	℄ Pier 1	℄ Pier 2	℄ Field Splice 2	℄ Brg. E. Abut.
1	770.653	770.729	770.793	771.096	771.161	771.362
2	770.761	770.836	770.901	771.204	771.269	771.469
3	770.844	770.920	770.984	771.287	771.352	771.553
4	770.823	770.899	770.964	771.266	771.331	771.532
5	770.698	770.774	770.839	771.141	771.206	771.407
6	770.549	770.625	770.689	770.992	771.057	771.258

The elevation shown at the ℄ Field Splice 1 and ℄ Field Splice 2 is the Top of Beam Elevation for the W30x108.

Notes:  
All dimensions are horizontal.  
Work this sheet with Sheets SB-16 & SB-17 of SB-24.

Note:  
All cross frames or diaphragms shall be installed as steel is erected and secured with erection pins and bolts except as otherwise noted. Individual cross frames or diaphragms at supports may be temporarily disconnected to install bearing anchor rods.

FILE NAME = ...E4083-SN008050-015-FramingPlan.dgn



USER NAME = SAW	DESIGNED - JLA	REVISED -
PLOT SCALE = 0:2.0000 '1' / in.	CHECKED - DAZ	REVISED -
PLOT DATE = 8/19/2013	DRAWN - SAW	REVISED -
	CHECKED - JLA	REVISED -

**STATE OF ILLINOIS**  
**DEPARTMENT OF TRANSPORTATION**

**FRAMING PLAN**  
**S.N. 008-0050**

SHEET NO. SB-15 OF SB-24 SHEETS

F.A.P. RTE.	SECTION	COUNTY	TOTAL SHEETS	SHEET NO.
17	4BR-5	CARROLL	150	78
CONTRACT NO. 64D83				

ILLINOIS FED. AID PROJECT