

**INDEX OF SHEETS**

- SC-1. General Plan & Elevation
- SC-2. General Data
- SC-3. Grated Drop Box
- SC-4. Grated Drop Box Details
- SC-5. Grated Culvert Extension
- SC-6. Grated Culvert Extension Details
- SC-7. Boring Logs

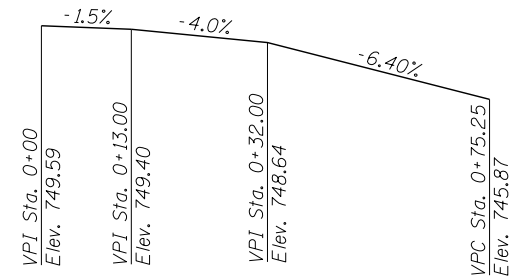

**PROFILE GRADE**  
(along  $\mathcal{C}$  Access Road)

**HORIZONTAL CURVE DATA**

Prop. Curve 1  
 PI Sta. = 0+49.80  
 $\Delta = 52^\circ 02' 02''$  (LT)  
 $D = 114^\circ 35' 30''$   
 $R = 50'$   
 $T = 24.41'$   
 $L = 45.41'$   
 $E = 5.64'$   
 S.E. Run = None  
 P.C. Sta. = 0+25.39  
 P.T. Sta. = 0+70.80

**GENERAL NOTES**

1. The limits and quantities of Removal and Replacement of Unsuitable Material for Structures shown are based on the boring data and may be modified by the District Geotechnical and Field Engineers for variable subsurface conditions encountered in the field.
2. The Rock Fill placed under the cast-in place extension and drop box shall be capped with 6 inch of CA-7. This 6 inch cap will be measured and paid for as Rock Fill.

**TOTAL BILL OF MATERIAL**

ITEM	UNIT	TOTAL
Removal and Disposal of Unsuitable Material for Structures	Cu. Yd.	185
Rock Fill	Ton	142
Stone Riprap, Class A5	Sq. Yd.	48
Filter Fabric	Sq. Yd.	48
Name Plates	Each	1
Concrete Structures	Cu. Yd.	30.4
Reinforcement Bars	Pound	6,020
Traversable Pipe Grate	Foot	422.5
Pipe Culverts, Class D, Type I Equivalent Round-Size 96"	Foot	130

STATION 672+16.53  
 BUILT 20\_\_ BY  
 STATE OF ILLINOIS  
 F.A. RT. 17 SEC. (4BR-2)D  
 LOADING HL-93  
 STRUCTURE NO. 008-1106

**NAME PLATE**  
See Std. 515001

**LOADING HL-93**

Allow 50#/sq. ft. for future wearing surface

**DESIGN SPECIFICATIONS**

2010 AASHTO LRFD Bridge Design Specifications  
w/2010 Interims

**DESIGN STRESSES**

**CAST-IN-PLACE**

$f'_c = 3,500$  psi  
 $f_y = 60,000$  psi (reinforcement)

**SEISMIC DATA**

Seismic Performance Zone (SPZ) = 1  
 Design Spectral Acceleration @ 1.0 sec (SD1) = 5.5g  
 Design Spectral Acceleration @ 0.2 sec (SDS) = 9.0g  
 Soil Site Class = C

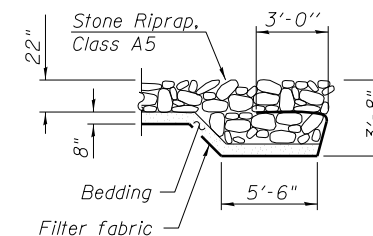

**SECTION A-A**

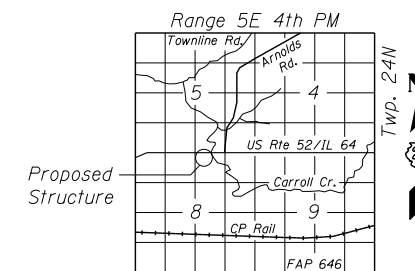

**LOCATION SKETCH**

FILE NAME = ...E4DB3-SN0081106-002-GenData.dgn



Zroka Engineering, P.C.  
4216 North Hermitage  
Chicago, IL 60613

USER NAME = SAW	DESIGNED - JLA	REVISED -
	CHECKED - DAZ	REVISED -
PLOT SCALE = 0:2.0000 '1' / in.	DRAWN - SAW	REVISED -
PLOT DATE = 6/26/2013	CHECKED - JLA	REVISED -

**STATE OF ILLINOIS  
DEPARTMENT OF TRANSPORTATION**

**GENERAL DATA  
S.N. 008-1106**

SHEET NO. SC-2 OF SC-7 SHEETS

F.A.P. RTE.	SECTION	COUNTY	TOTAL SHEETS	SHEET NO.
17	(4BR-2)D	CARROLL	150	89
			CONTRACT NO. 64D83	
ILLINOIS FED. AID PROJECT				