

JOHN AND MARJORIE McCARTHY  
881 IL 35  
EAST DUBUQUE, IL

SCHOOL DISTRICT 119  
100 SCHOOL RD  
EAST DUBUQUE, IL

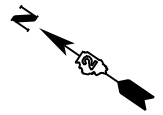

EXISTING 18" STORM SEWER

STA. 0+00  
PROPOSED MH  
RIM=785.54  
EX INV. E. = 776.7  
INV OUT = 773.2

EXISTING 20' DRAINAGE EASEMENT  
TEMPORARY EASEMENT  
CONSTRUCTION LIMIT

EXISTING DRAINAGE DITCH  
RIP RAP AREA 20' x 20'

PLAN	SURVEYED	DATE
NOTE BOOK NO.	PLOTTED	BY
	ALIGNMENT CHECKED	
	FIELD FILE NAME	

NOTE: SEE REMOVAL SHEET FOR ALL REMOVALS AND CONSTRUCTION LIMIT STATION AND OFFSET

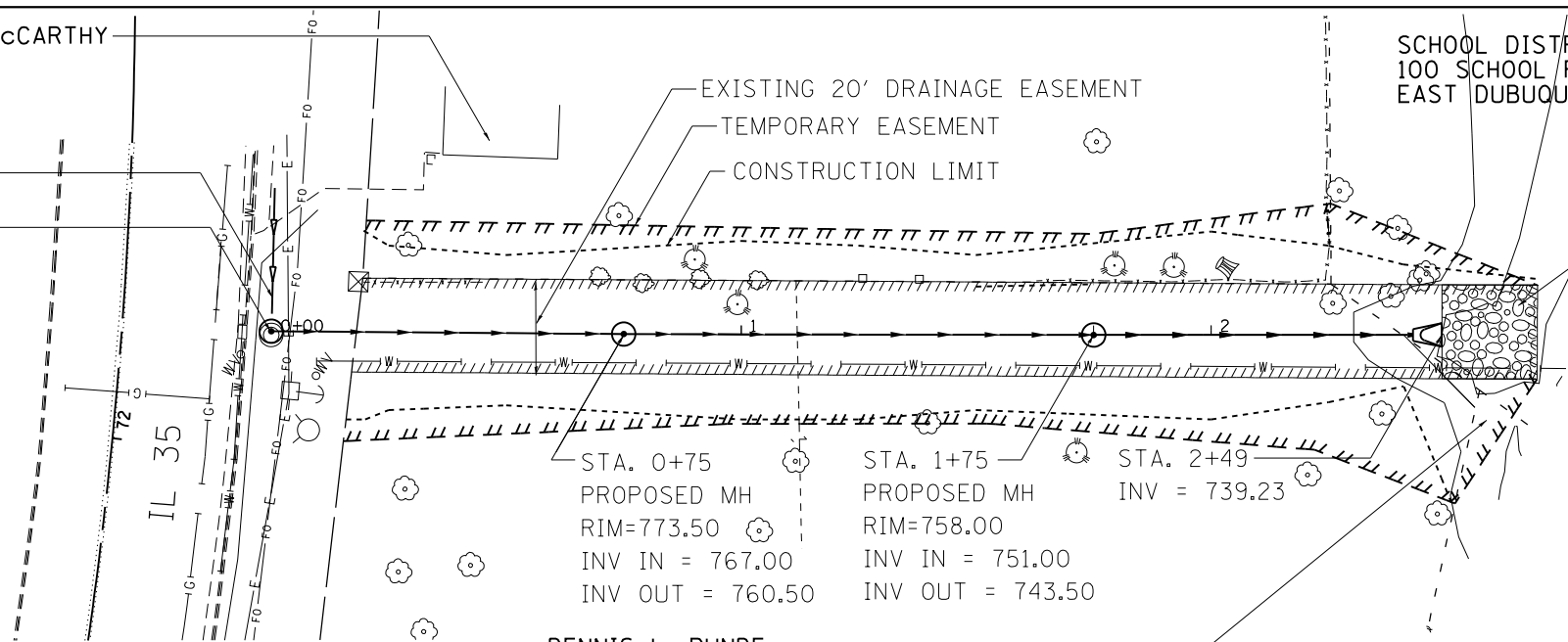

- FO = EXISTING FIBER OPTIC
- G = EXISTING GAS MAIN 4"
- W = EXISTING WATER MAIN
- > = EXISTING STORM SEWER
- > = PROPOSED PIPE CULVERTS, CLASS C, TYPE 3 30"
- [Pattern] = PROPOSED RIP RAP
- [Symbol] = PROPOSED MANHOLE, TYPE A, 5'-DIAMETER, TYPE 5 FRAME, CLOSED LID
- [Symbol] = PROPOSED FLARED END SECTION

DENNIS L. RUNDE  
148 HGWAY 35  
HAZEL GREEN, WI

Church of St. Mary's  
170 Montgomery Ave.  
East Dubuque, IL 61025

PROFILE	SURVEYED	DATE
NOTE BOOK NO.	GRADES CHECKED	BY
	STRUCTURE NOT AT THIS OFFICE	

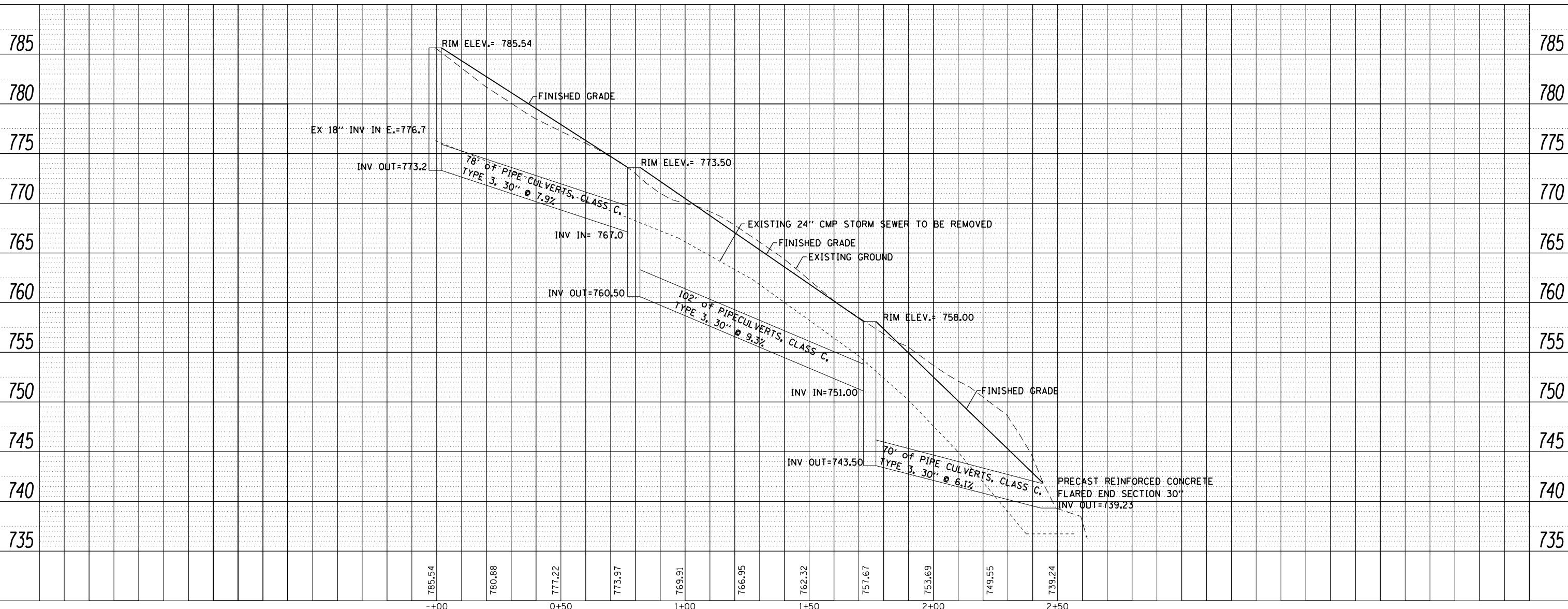

FILE NAME =	USER NAME = rundbladerr	DESIGNED -	REVISED -	<b>STATE OF ILLINOIS DEPARTMENT OF TRANSPORTATION</b>	<b>PLAN AND PROFILE</b>	F.A.P. RTE.	SECTION	COUNTY	TOTAL SHEETS	SHEET NO.
c:\pwork\pwork\rundbladerr\d0304926\0205712-sh-t-plnprf.dgn	DRAWN -	REVISED -	306			106M-3	JoDAVISS	12	8	
Default	PLOT SCALE = 40.0000' / in.	CHECKED -	REVISED -			CONTRACT NO. 64H82				
	PLOT DATE = Wed Jun 12 08:51:22 2013	DATE -	REVISED -			ILLINOIS FED. AID PROJECT				