

PLAN	SURVEYED	BY	DATE
	PLOTTED		
	ALIGNED		
	CHECKED		
	DESIGNED		
	FILE NAME		
	NO.		

PROFILE	SURVEYED	BY	DATE
	PLOTTED		
	GRADES CHECKED		
	STRUCTURE NOTATIONS CHECKED		
	NO.		

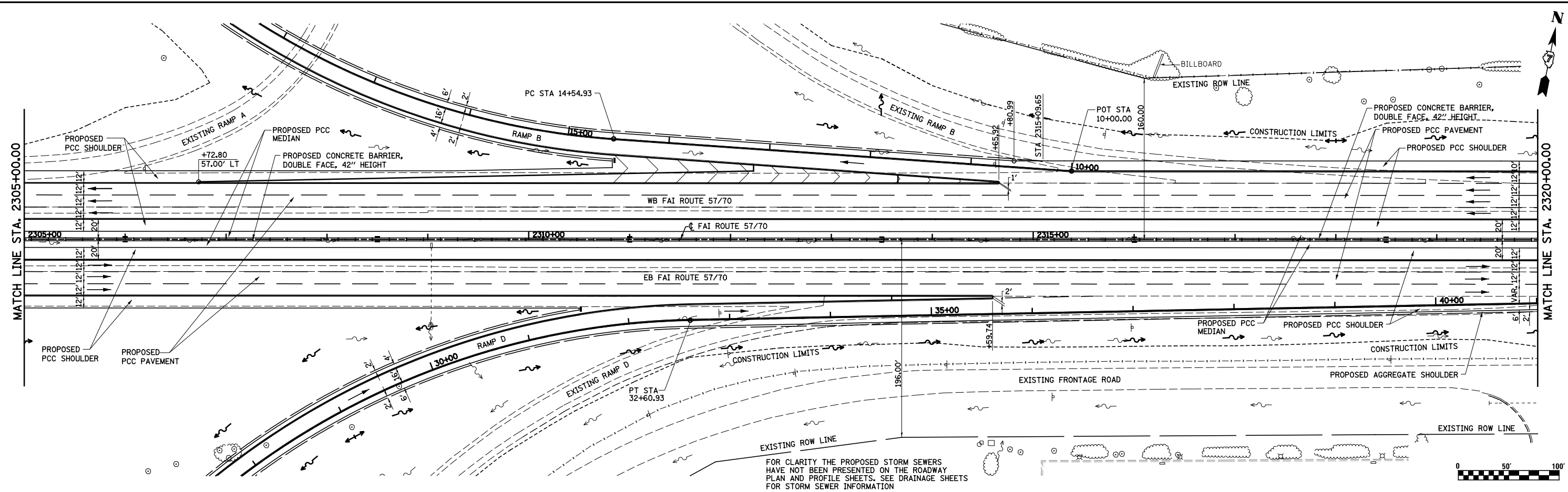

FOR CLARITY THE PROPOSED STORM SEWERS HAVE NOT BEEN PRESENTED ON THE ROADWAY PLAN AND PROFILE SHEETS. SEE DRAINAGE SHEETS FOR STORM SEWER INFORMATION

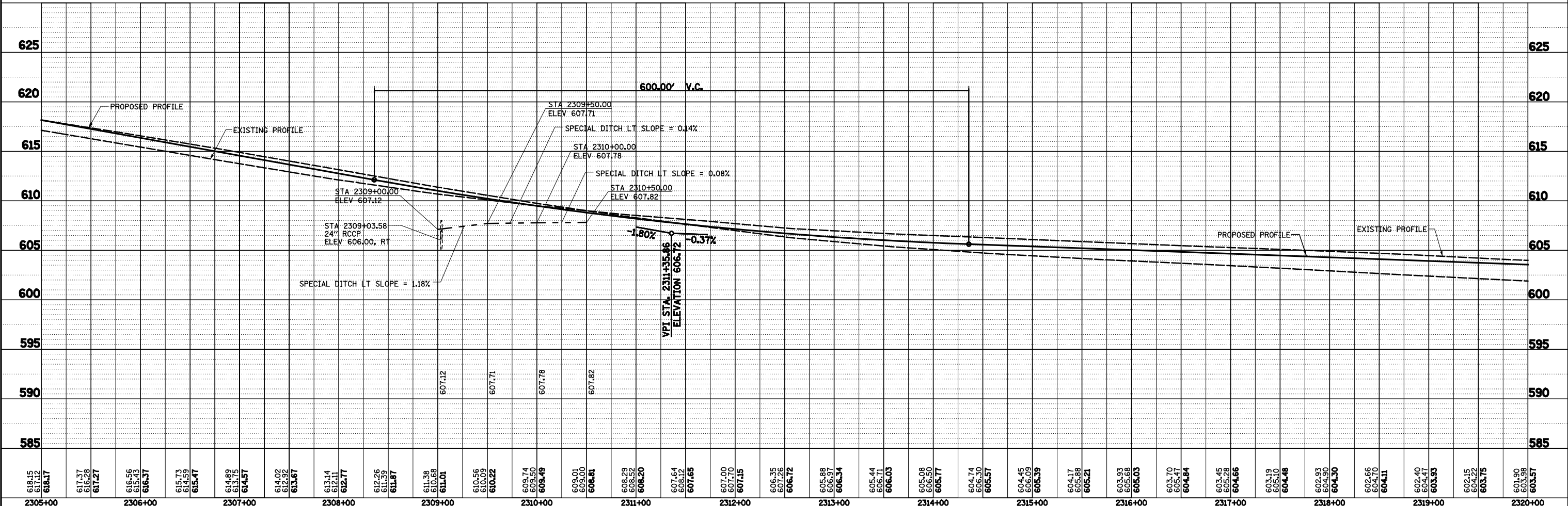

FILE NAME =	USER NAME = *USER*	DESIGNED - JWS	REVISED -	STATE OF ILLINOIS DEPARTMENT OF TRANSPORTATION	PLAN AND PROFILE, FAI ROUTE 57/70	F.A.I. RTE.	SECTION	COUNTY	TOTAL SHEETS	SHEET NO.	
S:\Projects\403-00072-57-70\ dgn\ N Tr\ Lvl\ PP\ NTR1570.dgn		DRAWN - PDB	REVISED -			57/70	(25-4R)	EFFINGHAM	1760	108	
		CHECKED - BRM	REVISED -			SCALE: 1"=50'		SHEET NO. 4 OF 11 SHEETS		STA. 2305+00.00 TO STA. 2320+00.00	CONTRACT NO. 74295
		DATE - 6-5-08	REVISED -			FED. ROAD DIST. NO.		ILLINOIS FED. AID PROJECT			