

PLAN	SURVEYED	BY	DATE
	PLOTTED		
	NOTE BOOK		
	NO.		
	NO.		
	NO.		

PROFILE	SURVEYED	BY	DATE
	PLOTTED		
	GRADES CHECKED		
	STRUCTURE		
	NOT AT THIS OFFICE		
	NO.		
	NO.		

EXIST. CURVE NTRI_RD
 PI STA. = 5369+55.95
 $\Delta = 76^\circ 36' 19''$ (LT)
 $D = 2^\circ 59' 01''$
 $R = 1,920.30'$
 $T = 1,516.71'$
 $L = 2,567.47'$
 $E = 526.73'$
 $e = 5.88\%$
 $T.R. = 41.94'$
 $S.E. RUN = 164.40'$
 $P.C. STA. = 5354+39.24$
 $P.T. STA. = 5380+06.71$

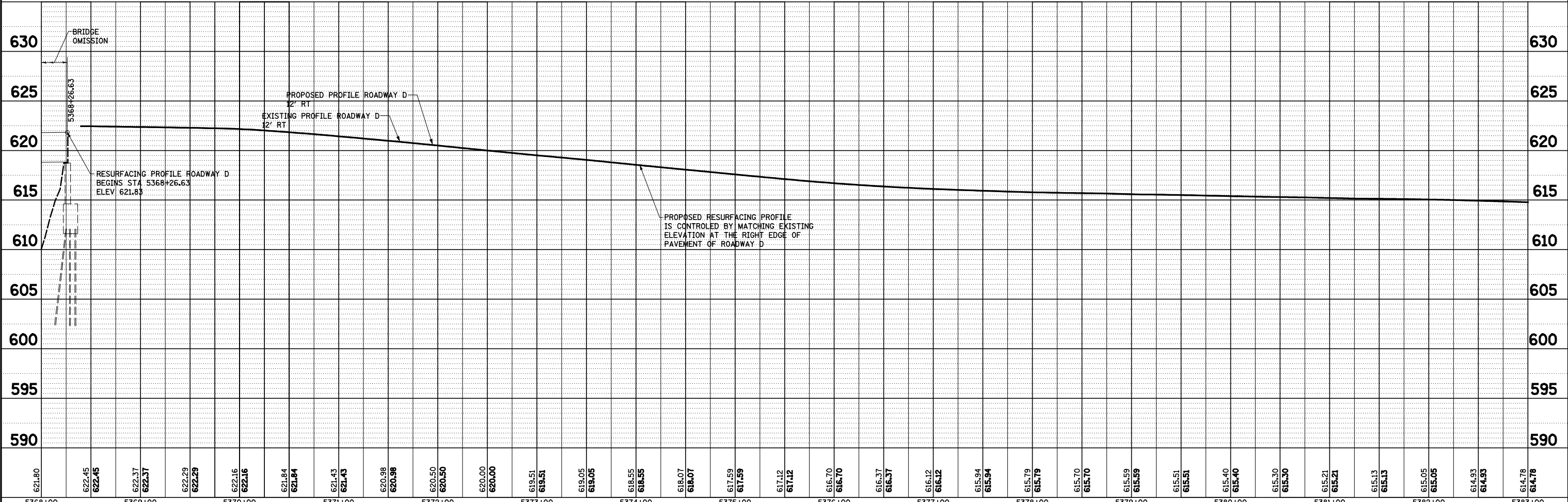
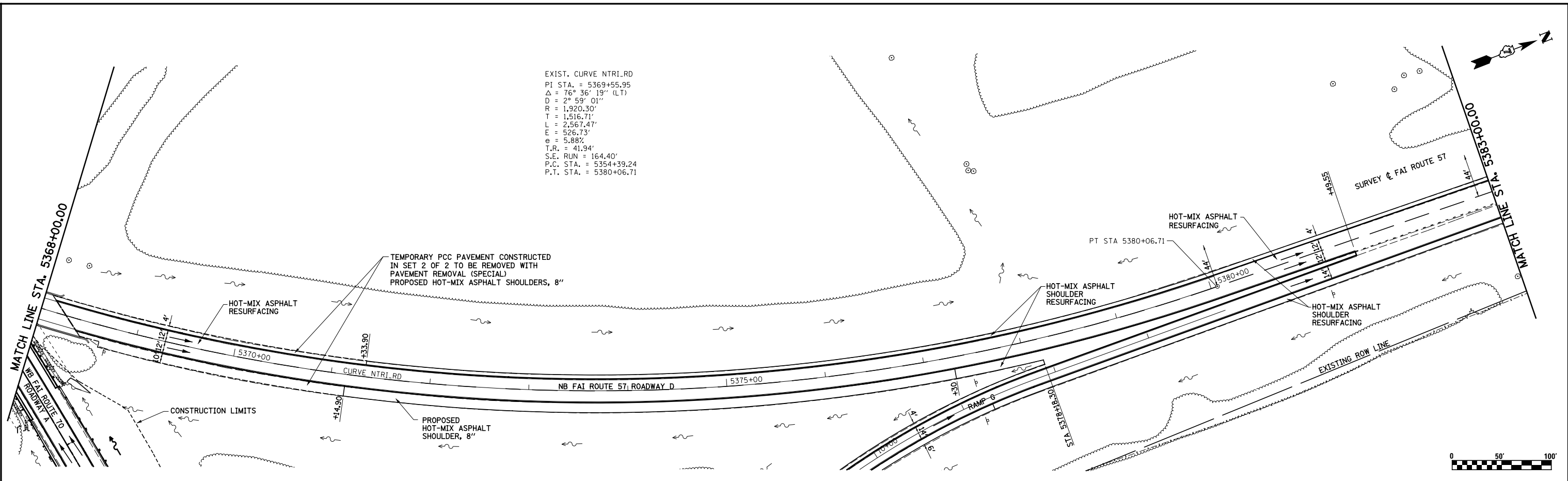

FILE NAME =	USER NAME = *USER*	DESIGNED - JWS	REVISED -
S:\Projects\403-00072-57-70\dgn\NTRI\LV\PP_NTRI1570.dgn		DRAWN - PDB	REVISED -
	PLOT SCALE = *SCALE*	CHECKED - BRM	REVISED -
	PLOT DATE = *DATE*	DATE - 6-5-08	REVISED -

**STATE OF ILLINOIS
 DEPARTMENT OF TRANSPORTATION**

PLAN AND PROFILE, NORTH TRI LEVEL ROADWAY D

SCALE: 1"=50' SHEET NO. 11 OF 18 SHEETS STA. 5368+00.00 TO STA. 5383+00.00

F.A.I. RTE.	SECTION	COUNTY	TOTAL SHEETS	SHEET NO.
57/70	(25-4)R	EFFINGHAM	1760	137
CONTRACT NO. 74295				
FED. ROAD DIST. NO.		ILLINOIS FED. AID PROJECT		