

RAMP A - US 45					
POINT	ELEVATION	NORTHING	EASTING	ROADWAY STATION	CL ROADWAY OFFSET
US45					
100	601.35	903,118.15	927,615.06	64+80.35	34.00
101	601.50	903,127.35	927,618.96	64+90.32	34.62
102	601.64	903,135.99	927,623.98	65+00.14	36.49
103	601.79	903,143.93	927,630.04	65+09.65	39.56
104	601.82	903,151.07	927,637.04	65+18.70	43.79
105	602.85	903,157.27	927,644.87	65+27.15	49.12
US45 - RAMP A					
106	601.85	903,162.45	927,653.42	10+56.70	12.00
107	601.92	903,166.68	927,662.48	10+66.33	9.31
108	601.91	903,170.55	927,671.70	10+76.06	7.00
109	601.89	903,174.11	927,681.04	10+85.86	5.01
110	601.88	903,177.36	927,690.50	10+95.72	3.36
111	601.85	903,180.29	927,700.06	11+05.63	2.03
112	601.81	903,182.90	927,709.71	11+15.58	1.04
113	601.78	903,185.19	927,719.45	11+25.56	0.37
114	601.73	903,187.15	927,729.25	11+35.55	0.04
115	601.68	903,188.83	927,739.11	11+45.55	0.00

RAMP B - US 45					
POINT	ELEVATION	NORTHING	EASTING	ROADWAY STATION	CL ROADWAY OFFSET
US45					
116	604.46	903,387.96	927,748.24	67+62.19	22.00
117	604.40	903,378.45	927,694.30	67+52.20	22.25
118	604.34	903,368.79	927,691.70	67+42.22	23.00
119	604.22	903,359.03	927,689.58	67+32.30	24.25
120	604.11	903,349.16	927,687.95	67+22.46	25.99
121	603.99	903,339.23	927,686.81	67+12.71	28.22
122	603.81	903,329.25	927,686.18	67+03.09	30.93
123	603.64	903,319.62	927,686.03	66+93.61	34.13
124	603.46	903,309.34	927,687.20	66+84.65	38.52
125	603.98	903,299.85	927,690.31	66+76.73	44.60
US45 - RAMP B					
126	602.50	903,291.17	927,695.25	28+25.54	36.14
127	602.44	903,283.64	927,701.80	28+20.30	27.64
128	602.38	903,277.57	927,709.73	28+13.48	20.36
129	602.32	903,273.19	927,718.70	28+05.35	14.57
130	602.25	903,270.68	927,728.36	27+96.22	10.51
131	602.18	903,269.79	927,738.29	27+86.48	8.35
132	602.11	903,271.43	927,748.24	27+76.49	8.00

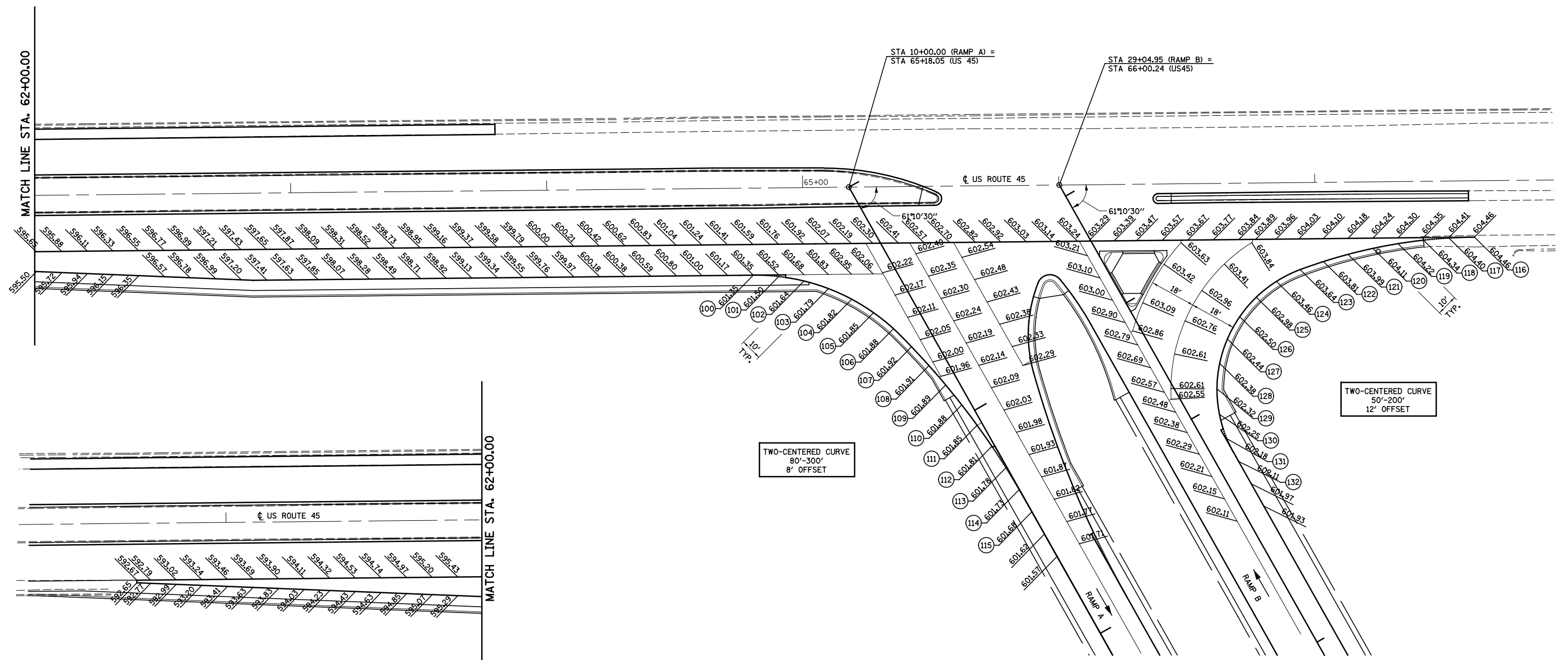

FILE NAME =	USER NAME = \$USER\$	DESIGNED - JWS	REVISED -	STATE OF ILLINOIS DEPARTMENT OF TRANSPORTATION	PAVEMENT ELEVATION DETAIL, RAMPS A & B, US ROUTE 45		F.A.I. RTE.	SECTION	COUNTY	TOTAL SHEETS	SHEET NO.
S:\Projects\403-00072-57-70\dgn\W Tr\ILV\pav_elev_det.dwg_REV.dwg		DRAWN - PDB	REVISED -				57/70	(25-4R)	EFFINGHAM	1760	305
	PLOT SCALE = \$SCALE\$	CHECKED - BRM	REVISED -		SCALE: 1"=20'	SHEET NO. 1 OF 2 SHEETS	STA.	TO STA.	CONTRACT NO. 74295		
	PLOT DATE = \$DATE\$	DATE - 7-31-08	REVISED -					FED. ROAD DIST. NO. ILLINOIS FED. AID PROJECT			