

PROP. ROADWAY "C"
 CURVE C67
 PI STA. = 19+58.36
 $\Delta = 25^{\circ} 09' 26''$ (RT)
 D = $1^{\circ} 20' 02''$
 R = 4,295.00'
 T = 958.36'
 L = 1,885.82'
 E = 105.62'
 e = 4.30%
 T.R. = 45.00'
 S.E. RUN = 129.00'
 P.C. STA. = 10+00.00
 P.T. STA. = 28+85.82

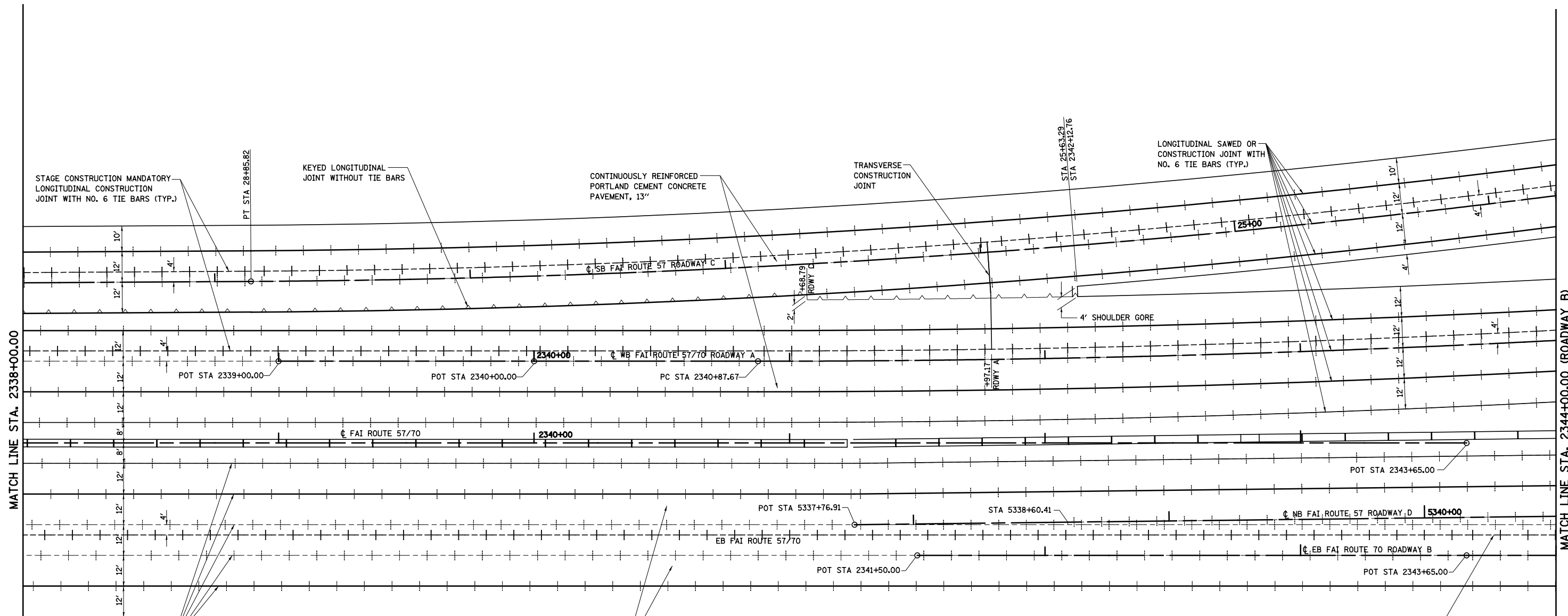

<p>LONGITUDINAL SAWED OR CONSTRUCTION JOINT WITH NO. 6 TIE BARS (TYP.)</p> <p>LONGITUDINAL CONSTRUCTION JOINT WITH NO. 6 TIE BARS (TYP.)</p> <p>TRANSVERSE CONTRACTION JOINT AT 15' CENTERS (TYP.)</p> <p>WIDE FLANGE BEAM TERMINAL JOINT (SPECIAL)</p> <p>TRANSVERSE EXPANSION JOINT</p> <p>LONGITUDINAL KEYED JOINT (WITHOUT TIE BARS)</p>	<p>LEGEND</p>	<p>CONTINUOUSLY REINFORCED PORTLAND CEMENT CONCRETE PAVEMENT, 13"</p>	<p>STAGE CONSTRUCTION MANDATORY LONGITUDINAL CONSTRUCTION JOINT WITH NO. 6 TIE BARS (TYP.)</p>
--	----------------------	---	--

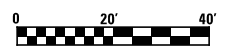

FILE NAME =	USER NAME = *USER*	DESIGNED - JWS	REVISED -	STATE OF ILLINOIS DEPARTMENT OF TRANSPORTATION	JOINTING DETAIL, NORTH TRI LEVEL ROADWAY C & D	F.A.I. RTE.	SECTION	COUNTY	TOTAL SHEETS	SHEET NO.
SC:\Projects\03-00072-57-70.dgn\11 Trk\1\joint_details.dgn		DRAWN - PDB	REVISED -			57/70	(25-4R)	EFFINGHAM	1760	358
PLOT SCALE = *SCALE*		CHECKED - BRM	REVISED -			CONTRACT NO. 74295				
PLOT DATE = *DATE*		DATE - 6-29-09	REVISED -			FED. ROAD DIST. NO. ILLINOIS FED. AID PROJECT				