

NOTE:
1. RECOVER SUFFICIENT LENGTH OF EXISTING UNIT DUCT AND REUSE IT TO FEED SIGN LIGHTING AT STA 2434+00 WITHOUT SPLICES.

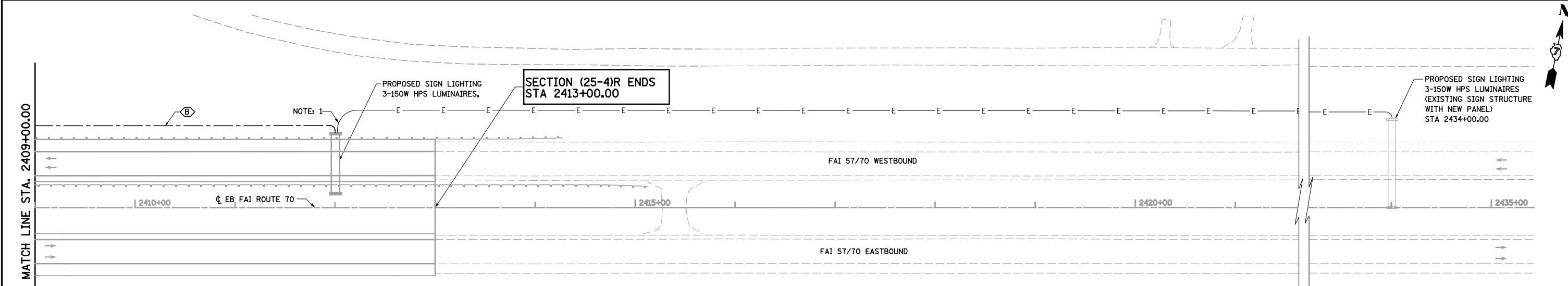

LEGEND

- EXISTING LIGHTING UNIT, TWIN
- PROPOSED LIGHTING UNIT, 45 FT ALUMINUM POLE, TWIN 8 FT DAVIT ARM, (2) 400W HPS LUMINAIRES, M-C-3
- PROPOSED LIGHTING UNIT, 50 FT ALUMINUM POLE, TWIN 15 FT DAVIT ARM, (2) 400W HPS LUMINAIRES, M-C-3
- EXISTING LIGHTING CONTROLLER
- PROPOSED LIGHTING CONTROLLER
- SERVICE INSTALLATION
- COMBINATION LIGHTING UNIT, 45 FT MH, 15 FT MAST ARM, 400 HPS LUMINAIRE, PHOTO-CELL CONTROL, M-C-3
- PROPOSED LIGHTING UNIT, 50 FT ALUMINUM POLE, TWIN 15 FT DAVIT ARM, (2) 400W HPS LUMINAIRES, M-C-3
- JUNCTION BOX, STAINLESS STEEL, ATTACHED TO STRUCTURE OR EMBEDDED IN STRUCTURE, SIZE AS NOTED
- PROPOSED UNIT DUCT, SIZE AS NOTED
- PROPOSED ELECTRIC CABLE IN CONDUIT, SIZE AS NOTED
- PROPOSED UNDERGROUND COILABLE NON-METALLIC CONDUIT, SIZE AS NOTED
- EXISTING UNIT DUCT OR CABLE IN CONDUIT

CABLE / CONDUIT SCHEDULE

- UNIT DUCT, 600V, 2-1C NO. 8, 1/C NO. 8 GROUND, (XLP-TYPE USE), 3/4" DIA. POLYETHYLENE
- UNIT DUCT, 600V, 2-1C NO. 6, 1/C NO. 8 GROUND, (XLP-TYPE USE), 1" DIA. POLYETHYLENE
- UNIT DUCT, 600V, 2-1C NO. 4, 1/C NO. 6 GROUND, (XLP-TYPE USE), 1" DIA. POLYETHYLENE
- ELECTRIC CABLE IN CONDUIT, 600V, (XLP-TYPE USE), 2-1C NO. 8, 1/C NO. 8 GROUND IN 2" DIA. PVC CONDUIT EMBEDDED IN STRUCTURE
- ELECTRIC CABLE IN CONDUIT, 600V, (XLP-TYPE USE), 2-1C NO. 6, 1/C NO. 8 GROUND IN 2" DIA. PVC CONDUIT EMBEDDED IN STRUCTURE
- ELECTRIC CABLE IN CONDUIT, 600V, (XLP-TYPE USE), 2-1C NO. 4, 1/C NO. 6 GROUND IN 2" DIA. PVC CONDUIT EMBEDDED IN STRUCTURE
- UNIT DUCT, 600V, 2-1C NO. 2, 1/C NO. 4 GROUND, (XLP-TYPE USE), 1 1/4" DIA. POLYETHYLENE
- LIGHT POLE FOUNDATION
- LIGHT POLE FOUNDATION (SPECIAL)

FILE NAME =
s:\project\2012\57-70\plan\57-70\plan.sld.dwg

USER NAME = \$USER\$
PLOT SCALE = \$SCALE\$
PLOT DATE = \$DATE\$

DESIGNED - JWS
DRAWN - PDB
CHECKED - BRM
DATE - 11-02-12

REVISED -
REVISED -
REVISED -
REVISED -

**STATE OF ILLINOIS
DEPARTMENT OF TRANSPORTATION**

PROPOSED LIGHTING, FAI ROUTE 70
SCALE: 1"=50' SHEET NO. 18 OF 35 SHEETS STA. 2394+00.00 TO STA. 2424+00.00

F.A.I. RTE.	SECTION	COUNTY	TOTAL SHEETS	SHEET NO.
57/70	(25-4)R	EFFINGHAM	1760	465
CONTRACT NO. 74295			L-18	
FED. ROAD DIST. NO.		ILLINOIS FED. AID PROJECT		