

STATE OF ILLINOIS  
DEPARTMENT OF TRANSPORTATION

BILL OF MATERIALS		
ITEM	UNIT	QUANTITY
REMOVAL & DISPOSAL OF UNSUITABLE MATERIAL	CU YD	193
BEDDING MATERIAL, SPECIAL	CU YD	193
PRECAST CONCRETE BOX CULVERTS 8'X6'	FOOT	131
PRECAST CONCRETE BOX CULVERTS 8'X6' (SPECIAL)	FOOT	161
PRECAST REINFORCED CONCRETE FLARED END SECTIONS 78"	EACH	1
PIPE CULVERTS, CLASS A, TYPE 4 78"	FOOT	98
PIPE CULVERTS, CLASS A 78" (JACKED)	FOOT	177
BOX CULVERT END SECTIONS, CULVERT NO. 1	EACH	1

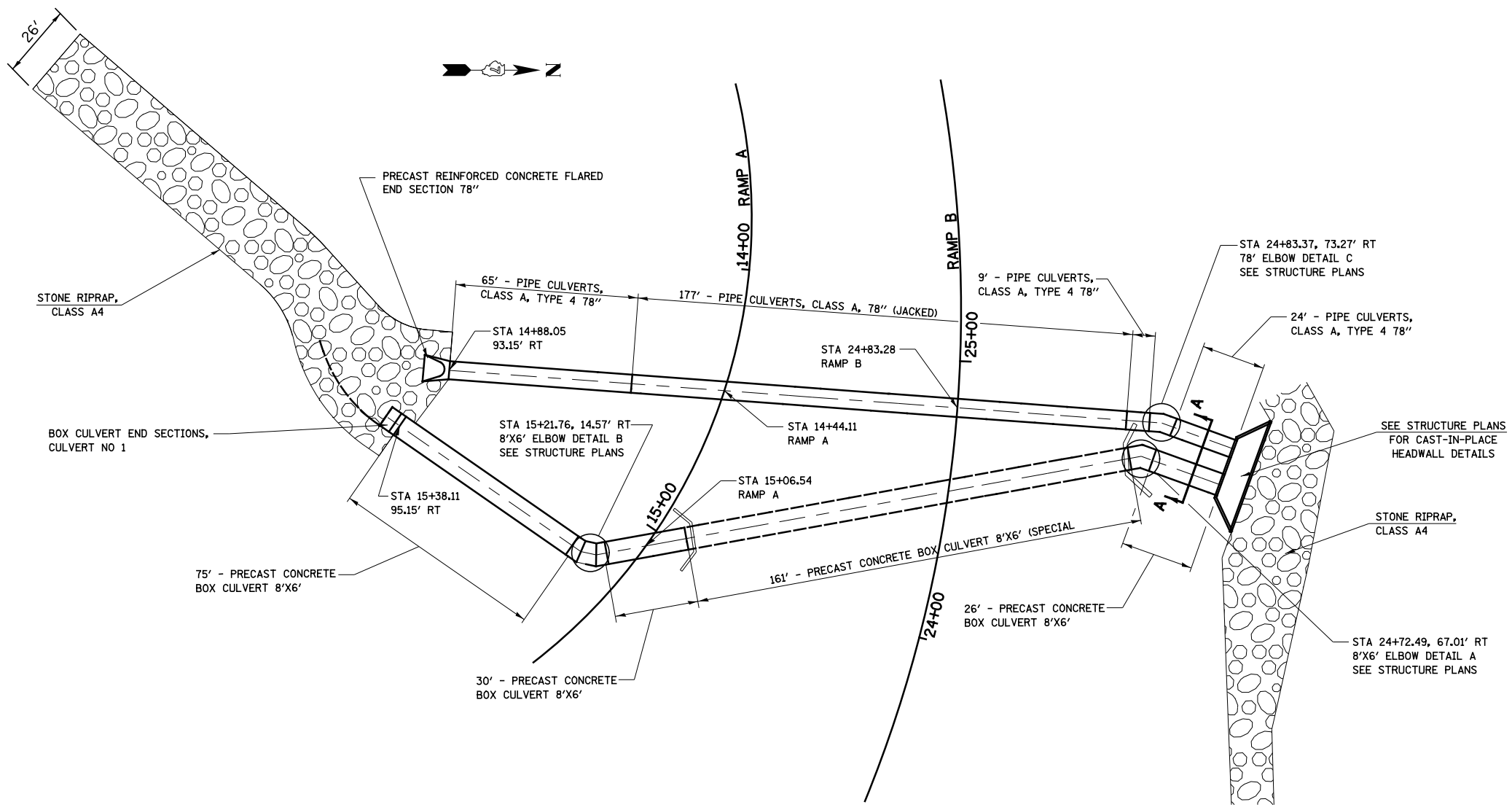

**CULVERT LAYOUT DETAIL**

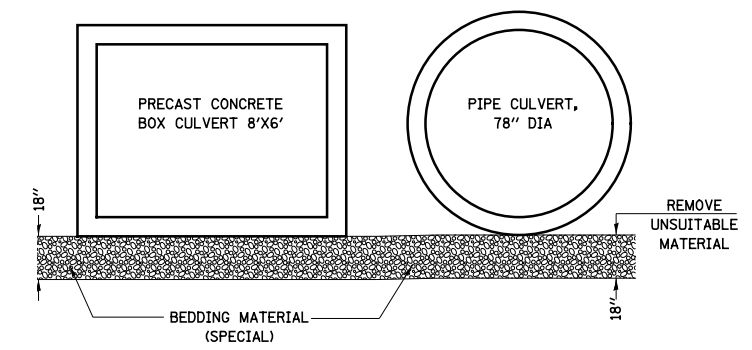

**SECTION A-A**  
SEE CULVERT PROFILES FOR LIMITS OF BEDDING MATERIAL (SPECIAL)

CULVERT LAYOUT  
US ROUTE 45 - RAMPS A & B

SHEET NO. 1 OF 1 SHEETS	F.A.I RTE.	SECTION	COUNTY	TOTAL SHEETS	SHEET NO.
	57/70	(25-4)R	EFFINGHAM	1760	511
			CONTRACT NO. 74295		
FED. ROAD DIST. NO.		ILLINOIS	FED. AID PROJECT		