

**SUPERSTRUCTURE
BILL OF MATERIAL**

Bar	No.	Size	Length	Shape
a200(E)	38	#6	32'-2"	—
a201(E)	716	#6	32'-0"	—
a202(E)	22	#6	33'-9"	—
a203(E)	430	#6	32'-0"	—
a204(E)	4	#6	37'-6"	—
a205(E)	23	#6	42'-11"	—
a206(E)	1378	#6	28'-8"	—
a207(E)	32	#6	55'-9"	—
a208(E)	14	#6	41'-9"	—
a209(E)	1242	#6	20'-2"	—
a210(E)	19	#6	55'-2"	—
a211(E)	4	#6	25'-0"	—
a212(E)	4	#6	33'-4"	—
a218(E)	1489	#6	6'-6"	—
b200(E)	936	#5	31'-5"	—
b201(E)	169	#5	31'-5"	—
b202(E)	70	#5	30'-4"	—
b203(E)	1470	#5	29'-5"	—
b204(E)	455	#6	24'-8"	—
d200(E)	413	#5	7'-5"	—
d201(E)	404	#5	8'-0"	—
d202(E)	817	#5	6'-10"	—
d203(E)	12	#6	8'-11"	—
d204(E)	6	#6	5'-1"	—
e200(E)	235	#4	19'-9"	—
e201(E)	7	#4	20'-5"	—
e202(E)	7	#4	16'-10"	—
e203(E)	7	#4	12'-5"	—
e204(E)	7	#4	16'-5"	—
e205(E)	14	#4	9'-9"	—
e206(E)	4	#8	19'-9"	—
e207(E)	6	#4	28'-6"	—
e208(E)	7	#8	27'-5"	—
e209(E)	6	#4	31'-3"	—
e210(E)	7	#8	29'-9"	—
e211(E)	7	#4	30'-6"	—
e212(E)	7	#8	29'-2"	—
e213(E)	6	#4	27'-10"	—
e214(E)	7	#8	26'-10"	—
m200(E)	12	#6	3'-1"	—
m201(E)	36	#6	10'-0"	—
m202(E)	6	#6	2'-3"	—
m203(E)	6	#6	3'-6"	—
m204(E)	12	#6	10'-4"	—
m205(E)	24	#6	6'-7"	—
m206(E)	12	#6	3'-9"	—
m207(E)	6	#6	2'-3"	—
m208(E)	6	#6	3'-6"	—
m209(E)	24	#5	10'-8"	—
m210(E)	7	#6	37'-7"	—
m211(E)	14	#6	25'-2"	—
m212(E)	7	#6	37'-7"	—
m213(E)	14	#6	33'-3"	—
m214(E)	120	#5	4'-0"	—
s200(E)	138	#5	16'-6"	—
s201(E)	178	#5	12'-5"	—
Reinforcement Bars, Epoxy Coated	Pound	304,650		
Concrete Superstructure	Cu. Yd.	1099.2		
Bridge Deck Grooving	Sq. Yd.	3706		
Protective Coat	Sq. Yd.	4302		
Diamond Grinding (Bridge Section)	Sq. Yd.	3706		

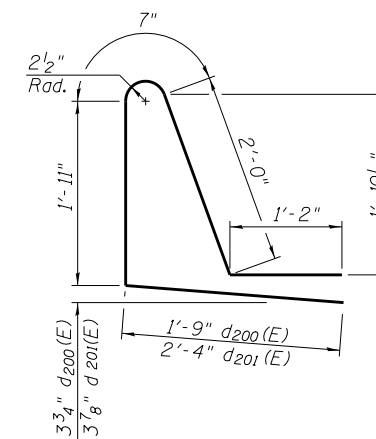

BAR d200(E) & d201(E)

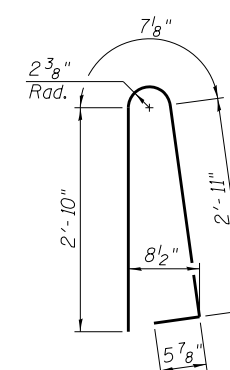

BAR d202(E)

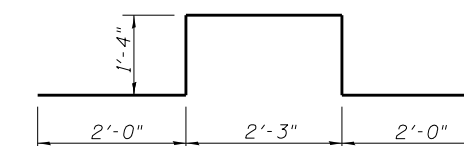

BAR d203(E)

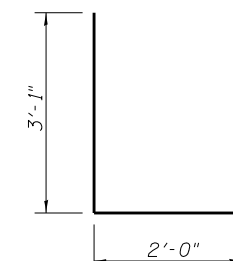

BAR d204(E)

MINIMUM BAR LAP

#4 bar = 2'-0"
#8 bar = 5'-2"

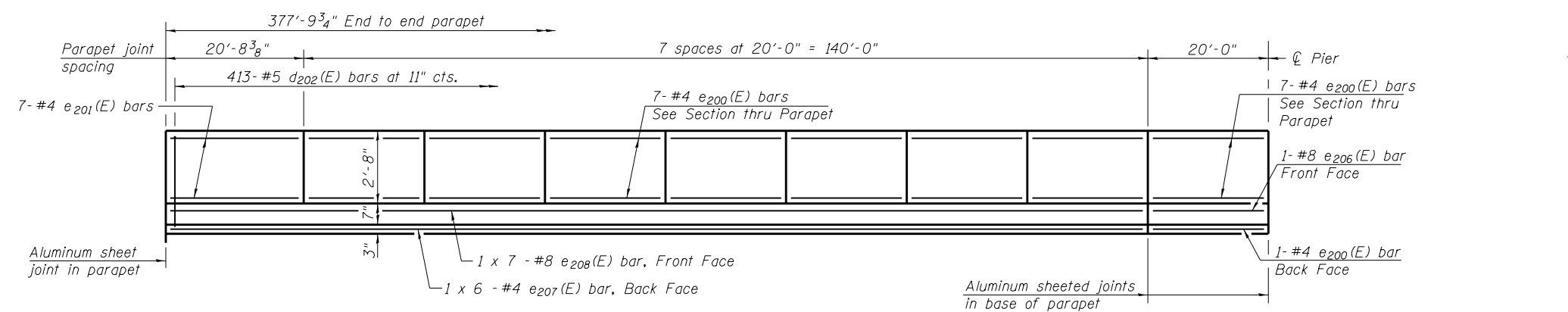

INSIDE ELEVATION OF PARAPET

(North Parapet)

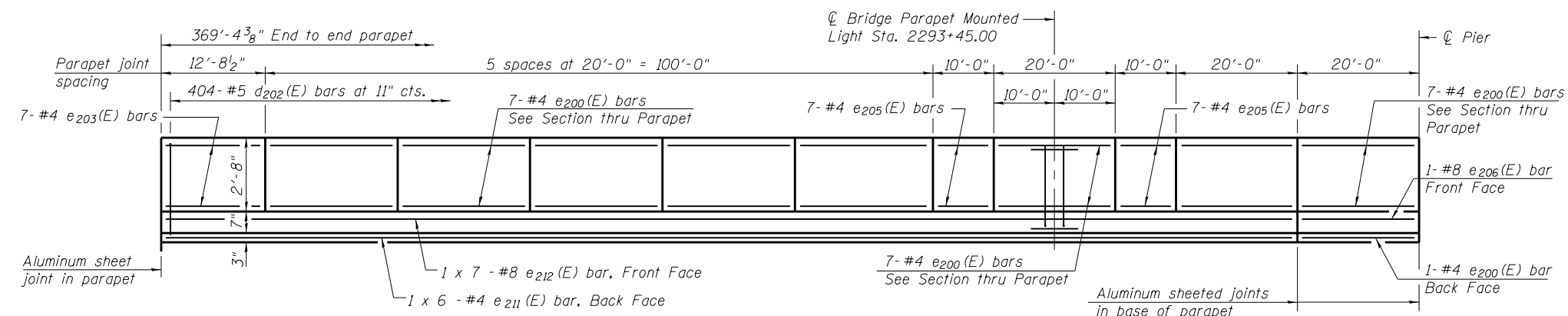
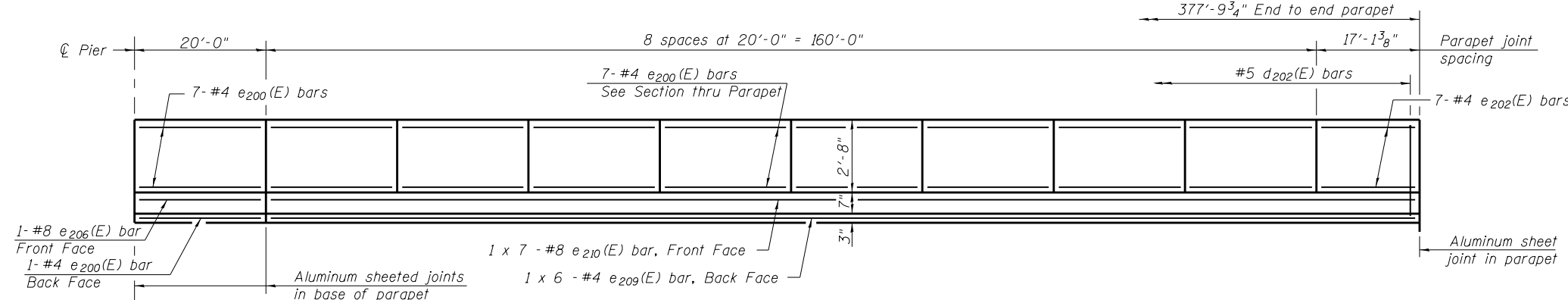

INSIDE ELEVATION OF PARAPET

(South Parapet)

