

NOTES:

TRAFFIC CONTROL AND PROTECTION FOR PRE-STAGE AND POST-STAGE OPERATIONS SHALL BE PERFORMED IN ACCORDANCE WITH STANDARD 701201.

TRAFFIC CONTROL AND PROTECTION FOR EB AND WB FAI TO SHALL BE IN ACCORDANCE WITH STANDARDS 701400 AND 701401 AS DIRECTED BY THE ENGINEER.

ADDITIONAL SIGNING WILL BE REQUIRED ON THE ADJACENT SIDE ROADS. SEE SIDE ROAD ADDITIONAL SIGNING DETAIL SHEET.

STAGE 1

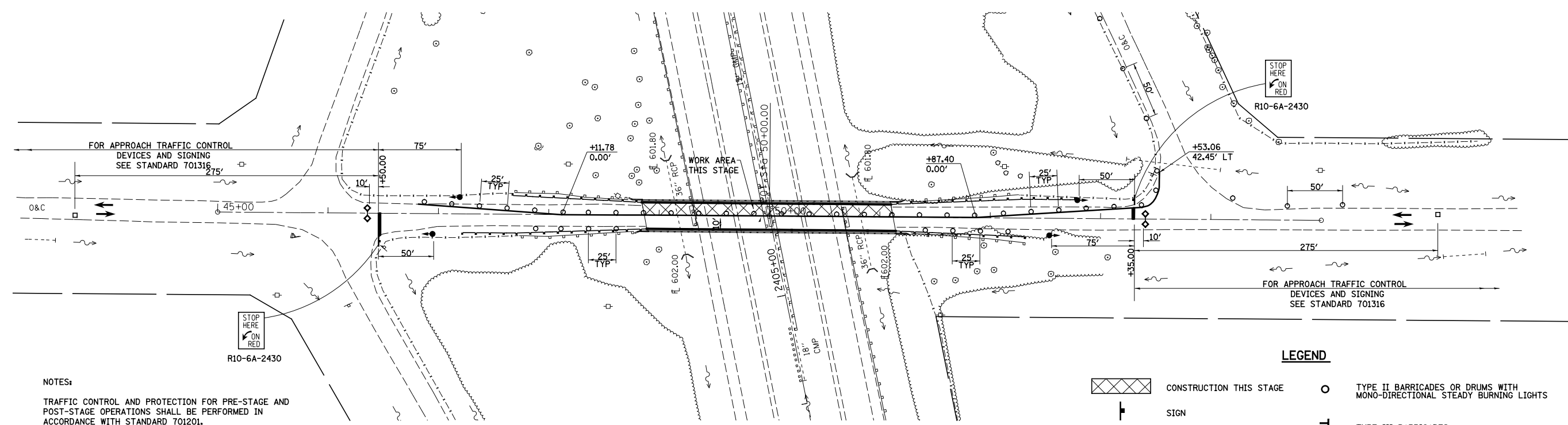

NOTES:







TRAFFIC CONTROL AND PROTECTION FOR PRE-STAGE AND POST-STAGE OPERATIONS SHALL BE PERFORMED IN ACCORDANCE WITH STANDARD 701201.

TRAFFIC CONTROL AND PROTECTION FOR EB AND WB FAI TO SHALL BE IN ACCORDANCE WITH STANDARDS 701400 AND 701401 AS DIRECTED BY THE ENGINEER.

ADDITIONAL SIGNING WILL BE REQUIRED ON THE ADJACENT SIDE ROADS. SEE SIDE ROAD ADDITIONAL SIGNING DETAIL SHEET.

STAGE 2

LEGEND

-  CONSTRUCTION THIS STAGE
-  SIGN
-  DIRECTION OF TRAFFIC
-  DETECTOR LOOPS
-  TEMPORARY BRIDGE SIGNAL
-  TYPE II BARRICADES OR DRUMS WITH MONO-DIRECTIONAL STEADY BURNING LIGHTS
-  TYPE III BARRICADES

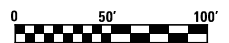

FILE NAME = S:\Projects\403-00072.57-70\dgn\Br Repair\Work\mot\52_#50th.dgn	USER NAME = \$USER\$	DESIGNED - JWS	REVISED -	STATE OF ILLINOIS DEPARTMENT OF TRANSPORTATION	LOCATION 5 MAINTENANCE OF TRAFFIC, STAGE 1 AND STAGE 2, 1650th			F.A.I. RTE. 57/70	SECTION (25-4)BR	COUNTY EFFINGHAM	TOTAL SHEETS 1760	SHEET NO. 1675
PLOT SCALE = \$SCALE\$	CHECKED - BRM	REVISIED -	REVISIED -		SCALE: 1"=50'	SHEET NO. 2 OF 2 SHEETS	STA. TO STA.	CONTRACT NO. 74295				
PLOT DATE = \$DATE\$	DATE - 7-21-08	REVISIED -	REVISIED -		FED. ROAD DIST. NO. ILLINOIS FED. AID PROJECT							