

PI STA. = 586+16.79  
 $\Delta$  = 0° 28' 25" (RT)  
 D = 0° 12' 15"  
 R = 28,077.70'  
 T = 116.02'  
 L = 232.03'  
 E = 0.24'  
 e = NONE  
 T.R. = NONE  
 S.E. RUN = NONE  
 P.C. STA. = 585+00.77  
 P.T. STA. = 587+32.81

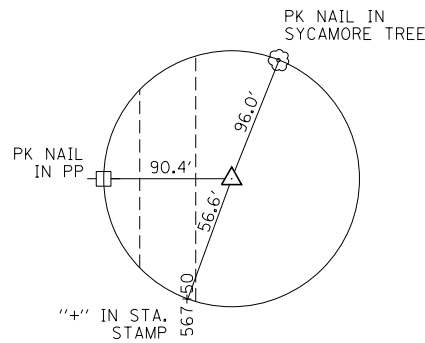

CP 09700103  
 IRON PIN & CAP  
 26' RT. ≈ STA. 568+64

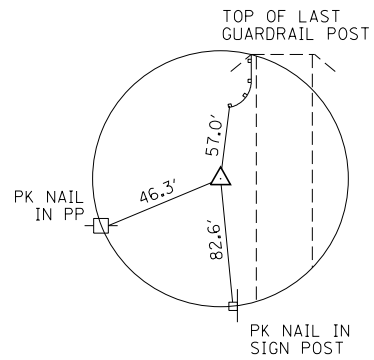

CP 09700102  
 IRON PIN & CAP  
 26.5' LT. ≈ STA. 580+91

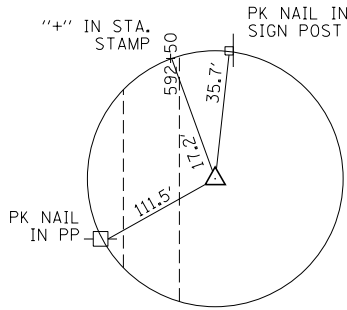

CP 09700101  
 IRON PIN & CAP  
 22' RT. ≈ STA. 592+37

IL 1 CENTERLINE			
DESCRIPTION	STATION	NORTHING	EASTING
POT	555+00.2300	511044.1460	1019575.1525
PC	585+00.7733	508919.2843	1017456.6090
PI	586+16.7914	508837.1250	1017374.6950
PT	587+32.8082	508755.6455	1017292.1039
POT	616+89.1245	506679.4244	1015187.5583

CONTROL POINTS					
POINT NUMBER	STATION	OFFSET	NORTHING	EASTING	ELEVATION
C.P. 09700103	586+64	LT 26'	510095.4214	1018593.418	
C.P. 09700102	580+91	LT 26.5'	509189.9013	1017764.448	
C.P. 09700101	592+37	RT 22'	508416.435	1016918.852	

**BENCHMARK**

B.M. AS29 CHISELED SQUARE ON N.E. WING WALL OF STR #097-0010(E)  
 22' LT. STA. 582+08 ELEV. 381.17

FILE NAME = D978103-sht-ATB.dgn	USER NAME = *USER*	DESIGNED - L.F.S.	REVISED -
HAMPTON, LENZINI AND RENWICK, INC. 3035 STEVENSON DRIVE, SUITE 201 SPRINGFIELD, ILLINOIS 62703 ILLINOIS PROFESSIONAL DESIGN FIRM LS / PE / SE CORP. 184.000959		DRAWN - T.W.K.	REVISED -
PLOT SCALE = *SCALE*		CHECKED - J.W.F.	REVISED -
PLOT DATE = 5/8/2013		DATE - 04/26/13	REVISED -

**STATE OF ILLINOIS  
DEPARTMENT OF TRANSPORTATION**

**ALIGNMENT, TIES AND BENCHMARKS  
ILLINOIS ROUTE 1**

SCALE: SHEET NO. OF SHEETS STA. TO STA.

F.A.P.	SECTION	COUNTY	TOTAL SHEETS	SHEET NO.
332	2B-1	WHITE	52	12
CONTRACT NO. 78103				
ILLINOIS FED. AID PROJECT				