

DATE	
BY	
PLAN	
NO.	
DATE	
BY	
PROFILE	
NO.	

DATE	
BY	
PROFILE	
NO.	
DATE	
BY	
PLAN	
NO.	

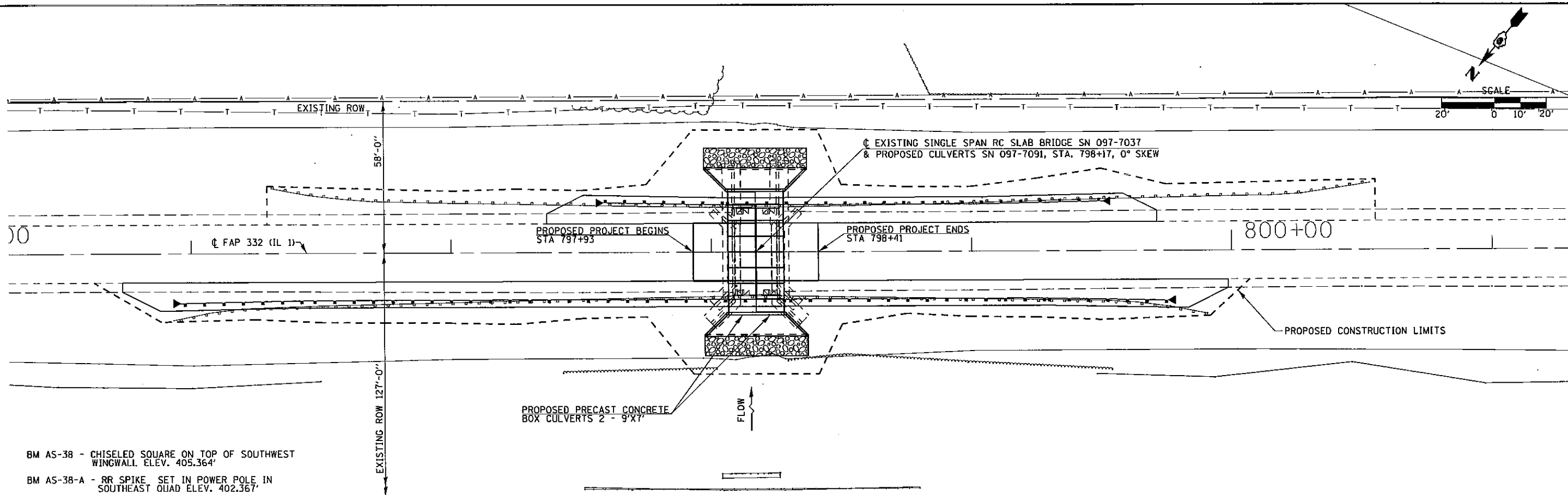

BM AS-38 - CHISELED SQUARE ON TOP OF SOUTHWEST WINGWALL ELEV. 405.364'
 BM AS-38-A - RR SPIKE SET IN POWER POLE IN SOUTHEAST QUAD ELEV. 402.367'

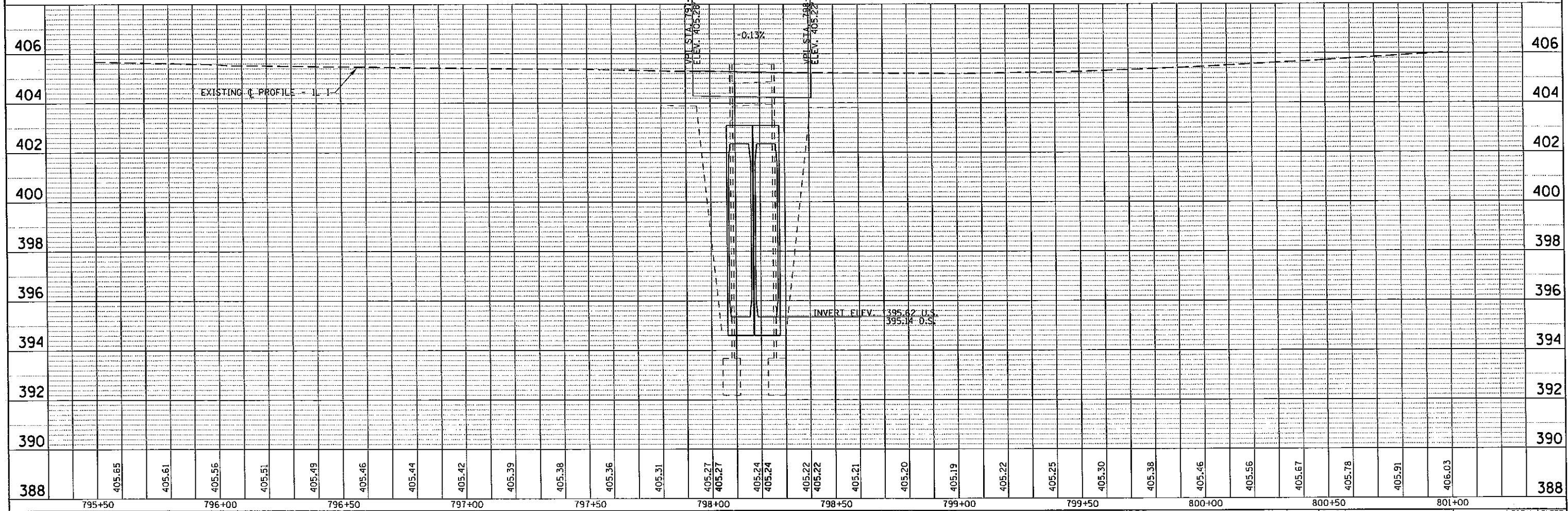

FILE NAME =	USER NAME = walkerra	DESIGNED -	REVISED -	F.A.P. RTE. 332	SECTION 2B-2	COUNTY WHITE	TOTAL SHEETS 23	SHEET NO. 7
Default	PLOT SCALE = 3/32" = 1'	DRAWN -	REVISED -	CONTRACT NO. 78312				
	PLOT DATE = 5/30/2013	CHECKED -	REVISED -	ILLINOIS FED. AID PROJECT				
		DATE -	REVISED -	SCALE: SHEET OF SHEETS STA. TO STA.				

STATE OF ILLINOIS
DEPARTMENT OF TRANSPORTATION

PLAN AND PROFILE