

09-20-13 LETTING ITEM 059

STATE OF ILLINOIS  
DEPARTMENT OF TRANSPORTATION  
DIVISION OF HIGHWAYS

F.A.P. RTE.	SECTION	COUNTY	TOTAL SHEETS	SHEET NO.
332	2B-2	WHITE	23	1
ILLINOIS			CONTRACT NO. 78312	

FOR INDEX OF SHEETS, SEE SHEET NO. 2

# PROPOSED HIGHWAY PLANS

FAP ROUTE 332 (IL 1)  
SECTION 2B-2  
PROJECT ACF-0332 (115)  
BRIDGE REPLACEMENT  
WHITE COUNTY

**TRAFFIC DATA**

**WHITE COUNTY**

IL 1 SN 097-7037

2011 ADT = 4050 WITH 12% TRUCKS

C-99-043-12

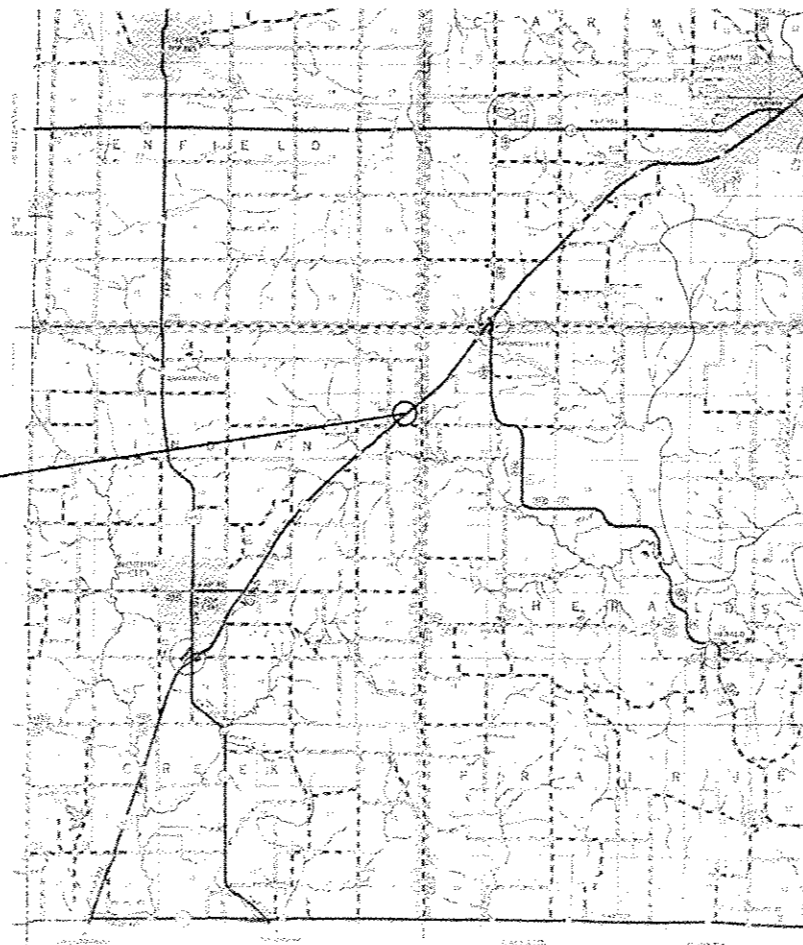

PROJECT LOCATION  
SN 097-7037 (E)  
SN 097-7091 (P)

**TOWNSHIP:**  
INDIAN CREEK

J.U.L.I.E.  
JOINT UTILITY LOCATION INFORMATION FOR EXCAVATION  
1-800-892-0123  
OR 811

DESIGNER: RUSS WALKER  
PROJECT MANAGER: DAVID PICHE (618) 351-5227

GROSS LENGTH = 48.00 FT. = 0.009 MILE  
NET LENGTH = 48.00 FT. = 0.009 MILE

CONTRACT NO. 78312

STATE OF ILLINOIS  
DEPARTMENT OF TRANSPORTATION  
DIVISION OF HIGHWAYS

SUBMITTED May 31 2013

Jeffrey S. Keim  
DEPUTY DIRECTOR OF HIGHWAYS, REGION ENGINEER

Aug 16 2013  
John D. Baranelli, P.E. Ia  
acting ENGINEER OF DESIGN AND ENVIRONMENT

Aug 16 2013  
Omer Osman, P.E. Ia  
DIRECTOR OF HIGHWAYS, CHIEF ENGINEER

PRINTED BY THE AUTHORITY  
OF THE STATE OF ILLINOIS

**GENERAL NOTES**

- 1) THE THICKNESS OF HOT-MIX ASPHALT MIXTURE SHOWN ON THE PLANS IS THE NOMINAL THICKNESS. DEVIATIONS FROM THE NOMINAL THICKNESS WILL BE PERMITTED WHEN SUCH DEVIATIONS OCCUR DUE TO IRREGULARITIES IN THE EXISTING SURFACE OR BASE ON WHICH THE HOT-MIX ASPHALT MIXTURE IS PLACED.
- 2) FACTORS USED FOR ESTIMATING PLAN QUANTITIES ARE AS FOLLOWS AND SHALL NOT BE USED FOR THE BASIS OF FINAL QUANTITIES:  
 ALL HOT-MIX ASPHALT: 2.016 TONS / CU YD  
 ALL AGGREGATE: 2.05 TONS / CU YD  
 RIP RAP: 1.50 TONS / CU YD
- 3) AT ALL LOCATIONS WHERE EXISTING HOT-MIX ASPHALT OR CONCRETE PAVEMENT JOINS AN EXISTING HOT-MIX ASPHALT OR CONCRETE PAVEMENT, A FULL DEPTH SAWED JOINT SHALL BE CONSTRUCTED. THE COST OF THIS JOINT WILL BE INCLUDED IN THE COST OF THE TYPE OF PAVEMENT BEING CONSTRUCTED.
- 4) THE CONTRACTOR MAY USE P.C.C. PAVEMENT 10' WITH PAVEMENT FABRIC FOLLOWING STANDARD 420601 IN LIEU OF THE HMA PAVEMENT SHOWN IN THE PLANS. NO ADDITIONAL COMPENSATION WILL BE ALLOWED. A CALCIUM CHLORIDE ACCELERATOR WILL BE ALLOWED ONLY IN THE P.C.C. PAVEMENT. THE CONCRETE SHALL BE CLASS PP-1 OR PP-2 PER ARTICLE 1020 OF THE STANDARD SPECS.
- 5) REMOVAL OF THE PAVED SHOULDERS ARE PAID FOR AS PAVEMENT REMOVAL.
- 6) COMMITMENTS: NONE AS OF JUNE 28, 2013

**MIXTURE REQUIREMENTS**

Location(s):	Hot-Mix Asphalt Surface Course
Mixture Use(s):	Hot-Mix Asphalt Surface Course, Mix D, N90
AC/PG:	PG64-22
ABR % (Max):	See Special Provision
Design Air Voids:	4.0 %, 90 Gyration Design
Mixture Composition:(Gradation Mixture)	IL-9.5 mm
Friction Aggregate:	D Surface

Location(s):	Hot-Mix Asphalt Binder Course
Mixture Use(s):	Hot-Mix Asphalt Binder Course, N90, IL-19.0, Fine Grade
AC/PG:	PG64-22
ABR % (Max):	See Special Provision
Design Air Voids:	4.0 %, 90 Gyration Design
Mixture Composition:(Gradation Mixture)	IL-19.0 mm Fine Grade
Friction Aggregate:	None

Location(s):	Hot-Mix Asphalt Shoulders
Mixture Use(s):	Hot-Mix Asphalt Shoulder, N30
AC/PG:	PG58-22
ABR % (Max):	50
Design Air Voids:	2.0 %, 30 Gyration Design
Mixture Composition:(Gradation Mixture)	HMA Shoulder
Friction Aggregate:	None

**INDEX OF SHEETS**

- 1) COVER SHEET
- 2) SIGNATURES, STANDARDS, GENERAL NOTES, MIXTURE REQUIREMENTS, & INDEX OF SHEETS
- 3) SUMMARY OF QUANTITIES
- 6) TYPICAL SECTIONS
- 7) PLAN AND PROFILE
- 8) PROPOSED SHOULDER LAYOUT AND GUARDRAIL LAYOUT
- 9) EROSION CONTROL PLAN
- 10) TEMPORARY AND FINAL SECTIONS
- 11) SECTION THRU PROPOSED BOXES
- 12) PROPOSED CAST-IN-PLACE APRON END SECTION
- 14) CROSS SECTIONS

**HIGHWAY STANDARDS**

- |           |   |
|-----------|---|
| 000001-06 | STANDARD SYMBOLS, ABBREVIATIONS, AND PATTERNS   |
| 001001-02 | AREAS OF REINFORCEMENT BARS   |
| 630001-10 | STEEL PLATE BEAM GUARDRAIL  |
| 630101-09 | GUARDRAIL MOUNTED ON EXISTING CULVERTS  |
| 630201-06 | PCC/HMA STABILIZATION AT STEEL PLATE BEAM GUARDRAIL                                     |
| 630301-06 | SHOULDER WIDENING FOR TYPE 1 (SPECIAL) GUARDRAIL TERMINALS                              |
| 635006-03 | REFLECTOR AND TERMINAL MARKER PLACEMENT   |
| 701001-02 | OFF-ROAD OPERATIONS, 2L, 2W, MORE THAN 15' AWAY   |
| 701006-04 | OFF-ROAD OPERATIONS, 2L, 2W, 15' TO EOP   |
| 701201-04 | LANE CLOSURE 2L, 2W, DAY ONLY   |
| 701901-02 | TRAFFIC CONTROL DEVICES   |
| BLR 21-9  | TYPICAL APPLICATION OF TRAFFIC CONTROL DEVICES FOR CONSTRUCTION ON RURAL LOCAL HIGHWAYS |

Prepared By:	<i>Ape Z...</i> DISTRICT STUDIES & PLANS ENGINEER
Examined By:	<i>[Signature]</i> DISTRICT LAND ACQUISITION ENGINEER
Examined By:	<i>[Signature]</i> DISTRICT PROGRAM DEVELOPMENT ENGINEER
Examined By:	<i>[Signature]</i> DISTRICT OPERATIONS ENGINEER
Examined By:	<i>[Signature]</i> DISTRICT PROJECT IMPLEMENTATION ENGINEER
Examined By:	<i>[Signature]</i> DISTRICT CONSTRUCTION ENGINEER
Examined By:	<i>[Signature]</i> DISTRICT MATERIALS ENGINEER

# SUMMARY OF QUANTITIES

CODE NUMBER	ITEM DESCRIPTION	UNIT	CONSTRUCTION TYPE CODE: 0040 FUNDING: 80% FED 20% STATE
20200100	EARTH EXCAVATION	CU YD	595
20700220	POROUS GRANULAR EMBANKMENT	CU YD	280
* 25000200	SEEDING, CLASS 2	ACRE	0.25
* 25000400	NITROGEN FERTILIZER NUTRIENT	POUND	9
* 25000500	PHOSPHORUS FERTILIZER NUTRIENT	POUND	9
* 25000600	POTASSIUM FERTILIZER NUTRIENT	POUND	9
* 25000700	AGRICULTURAL GROUND LIMESTONE	TON	0.2
25100630	EROSION CONTROL BLANKET	SQ YD	503
28000250	TEMPORARY EROSION CONTROL SEEDING	POUND	11
28000400	PERIMETER EROSION BARRIER	FOOT	676
28100107	STONE RIPRAP, CLASS A4	SQ YD	66
28200200	FILTER FABRIC	SQ YD	66
40603092	HOT-MIX ASPHALT BINDER COURSE, IL-19.0 FG, N90	TON	69
40603345	HOT-MIX ASPHALT SURFACE COURSE, MIX "D", N90	TON	10

\*SPECIALTY ITEM

FILE NAME =	USER NAME = walkerr	DESIGNED -	REVISED -	<b>STATE OF ILLINOIS DEPARTMENT OF TRANSPORTATION</b>	<b>SUMMARY OF QUANTITIES</b>	F.A.P. RTE.	SECTION	COUNTY	TOTAL SHEETS	SHEET NO.
c:\pwork\pwork\walkerr\0326424\783	2-Design\dn	DRAWN -	REVISED -			332	2B-2	WHITE	23	3
Default	PLOT SCALE = 1/8"=1'-0"	CHECKED -	REVISED -		SCALE: _____ SHEET _____ OF _____ SHEETS STA. _____ TO STA. _____					
	PLOT DATE = 5/26/2013	DATE -	REVISED -							

## SUMMARY OF QUANTITIES - CONT

CODE NUMBER	ITEM DESCRIPTION	UNIT	CONSTRUCTION TYPE CODE: 0040 FUNDING: 80% FED 20% STATE
44000100	PAVEMENT REMOVAL	SQ YD	391
48203029	HOT-MIX ASPHALT SHOULDERS, 8"	SQ YD	713
50100100	REMOVAL OF EXISTING STRUCTURES	EACH	1
50800205	REINFORCEMENT BARS, EPOXY COATED	POUND	1,610
54003000	CONCRETE BOX CULVERTS	CU YD	30.8
54010907	PRECAST CONCRETE BOX CULVERTS 9' X 7'	FOOT	96
* 63000001	STEEL PLATE BEAM GUARDRAIL, TYPE A, 6 FOOT POSTS	FOOT	337.5
* 63000025	STEEL PLATE BEAM GUARDRAIL, ATTACHED TO STRUCTURES	FOOT	45.5
* 63100167	TRAFFIC BARRIER TERMINAL, TYPE 1 (SPECIAL) TANGENT	EACH	4
63200310	GUARDRAIL REMOVAL	FOOT	785
67000400	ENGINEER'S FIELD OFFICE, TYPE A	CAL MO	1
67100100	MOBILIZATION	L SUM	1
70100450	TRAFFIC CONTROL AND PROTECTION, STANDARD 701201	L SUM	1
70101830	TRAFFIC CONTROL AND PROTECTION, STANDARD BLR 21	L SUM	1

\*SPECIALTY ITEM

FILE NAME =	USER NAME = walorra	DESIGNED - _____	REVISED - _____	<b>STATE OF ILLINOIS DEPARTMENT OF TRANSPORTATION</b>	<b>SUMMARY OF QUANTITIES</b>	F.A.P. RTE.	SECTION	COUNTY	TOTAL SHEETS	SHEET NO.	
c:\pcc\work\pccdot\walorra\0326424\703	2-Design.dgn	DRAWN - _____	REVISED - _____			332	28-2	WHITE	23	4	
Default	PLOT SCALE = 1/8" = 1' / 1"	CHECKED - _____	REVISED - _____			SCALE: _____ SHEET _____ OF _____ SHEETS STA. _____ TO STA. _____		CONTRACT NO. 78312			
	PLOT DATE = 5/29/2013	DATE - _____	REVISED - _____			ILLINOIS FED. AID PROJECT					

## SUMMARY OF QUANTITIES - CONT

CODE NUMBER	ITEM DESCRIPTION	UNIT	CONSTRUCTION TYPE CODE: 0040 FUNDING: 80% FED 20% STATE
70103815	TRAFFIC CONTROL SURVEILLANCE	CAL DA	4
70106800	CHANGEABLE MESSAGE SIGN	CAL MO	2
70300220	TEMPORARY PAVEMENT MARKING - LINE 4"	FOOT	108
70301000	WORK ZONE PAVEMENT MARKING REMOVAL	SQ FT	36
* 78001110	PAINT PAVEMENT MARKING - LINE 4"	FOOT	108
* 78200410	GUARDRAIL MARKERS, TYPE A	EACH	8
* 78201000	TERMINAL MARKER - DIRECT APPLIED	EACH	4

\* SPECIALTY ITEM

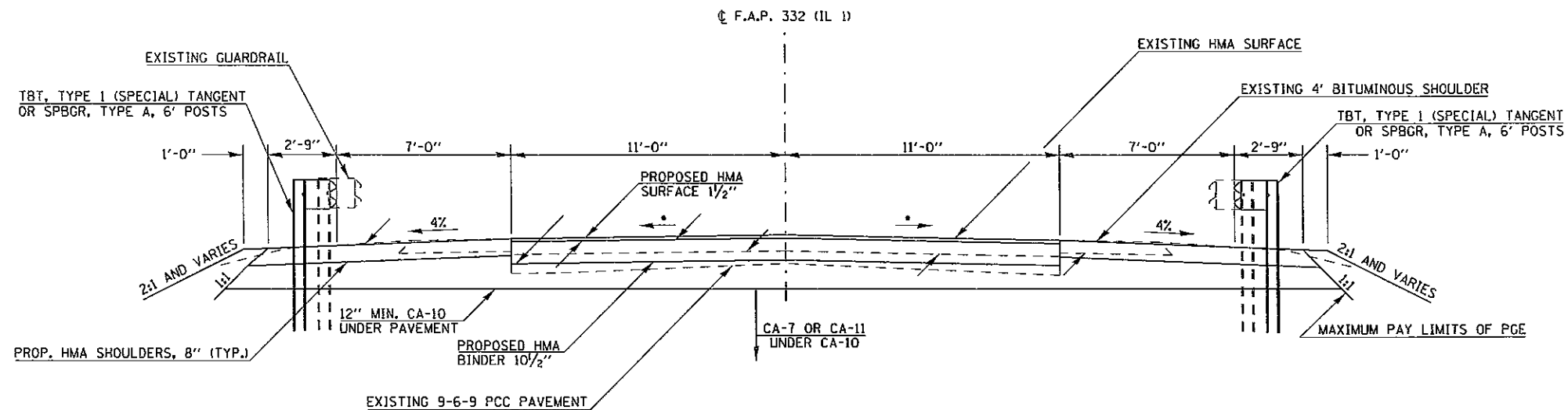

TYPICAL SECTION WITHIN PAVEMENT REMOVAL  
(EXCLUDES PAVEMENT SECTION OVER CULVERT)

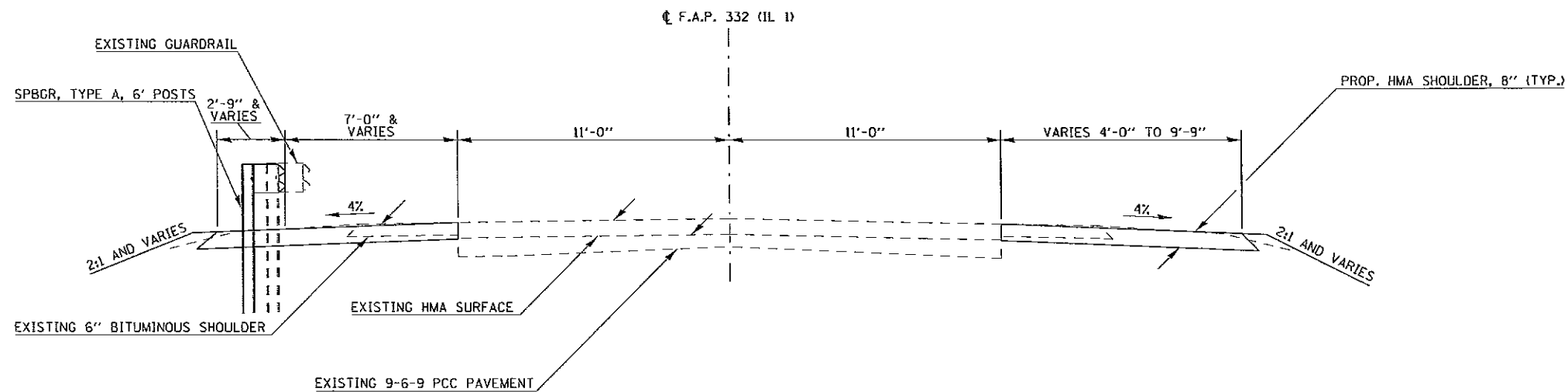

TYPICAL SECTION OUTSIDE PAVEMENT REMOVAL

FILE NAME =	USER NAME = walkerra	DESIGNED -	REVISED -	<b>STATE OF ILLINOIS DEPARTMENT OF TRANSPORTATION</b>	<b>TYPICAL SECTIONS</b>		F.A.P. RTE.	SECTION	COUNTY	TOTAL SHEETS	SHEET NO.
cs:\pwork\pavdot\walkerra\0326424\783	2-Design.dgn	DRAWN -	REVISED -				332	2B-2	WHITE	23	6
Default	PLOT SCALE = 5.0000' / in.	CHECKED -	REVISED -		SCALE: _____ SHEET _____ OF _____ SHEETS		ILLINOIS FED. AID PROJECT		CONTRACT NO. 78312		
	PLOT DATE = 5/28/2013	DATE -	REVISED -		STA. _____ TO STA. _____						

DATE	
BY	
PLAN	
NO.	
DATE	
BY	
PROFILE	
NO.	

DATE	
BY	
PROFILE	
NO.	
DATE	
BY	
PLAN	
NO.	

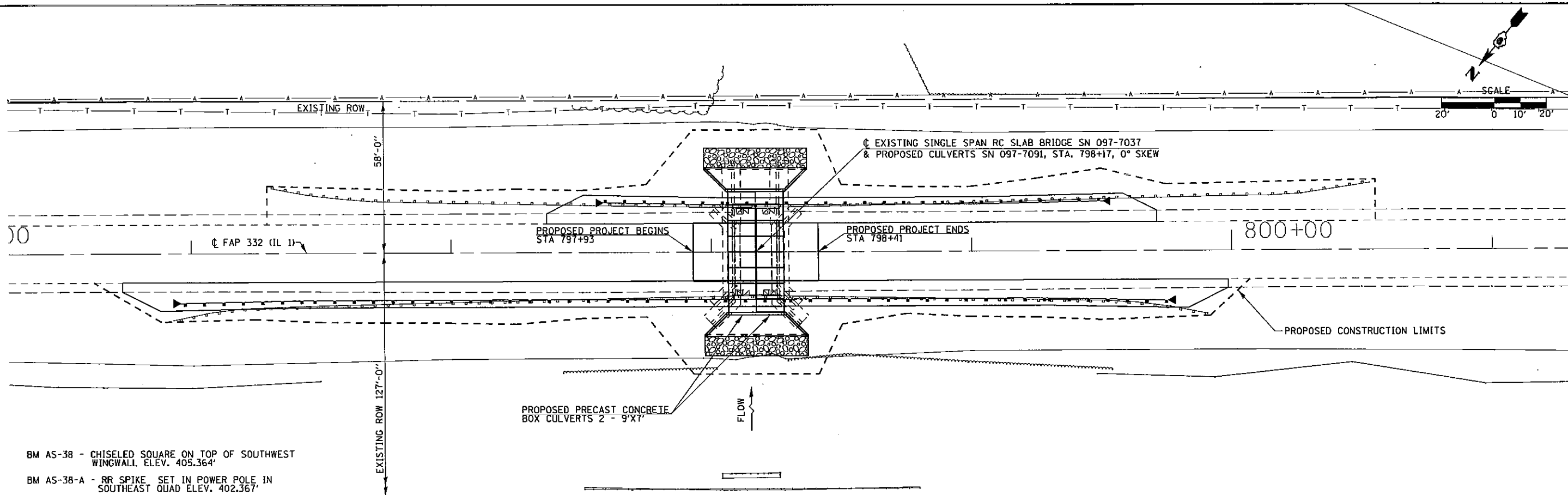

BM AS-38 - CHISELED SQUARE ON TOP OF SOUTHWEST WINGWALL ELEV. 405.364'  
 BM AS-38-A - RR SPIKE SET IN POWER POLE IN SOUTHEAST QUAD ELEV. 402.367'

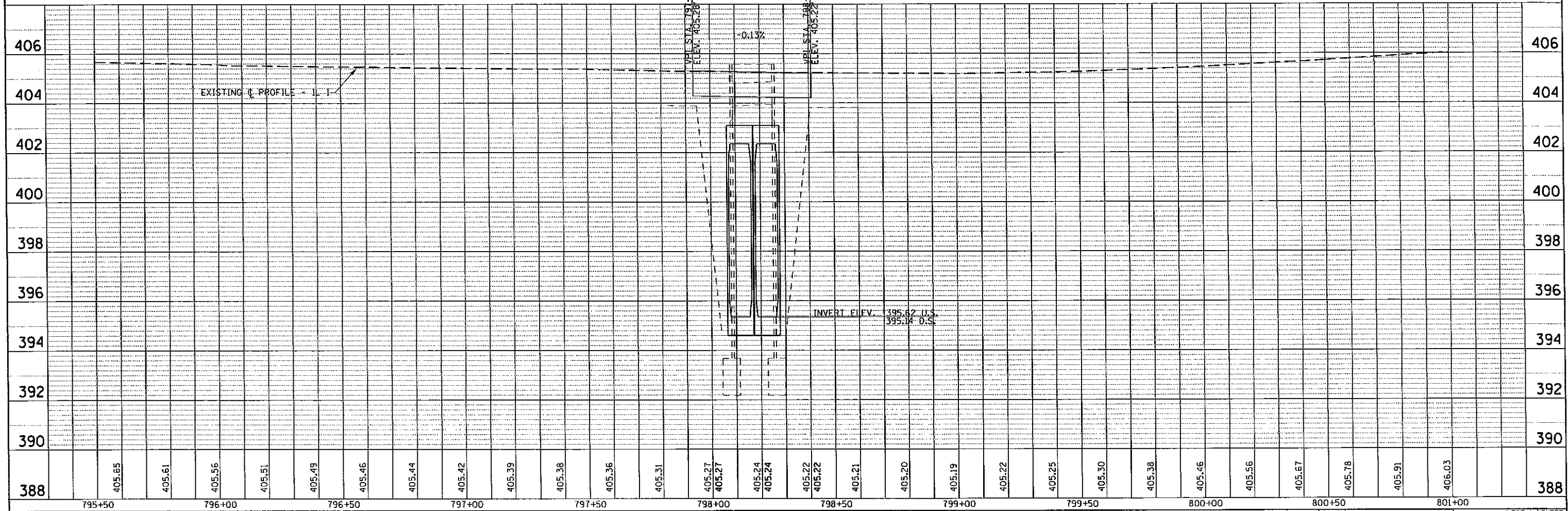

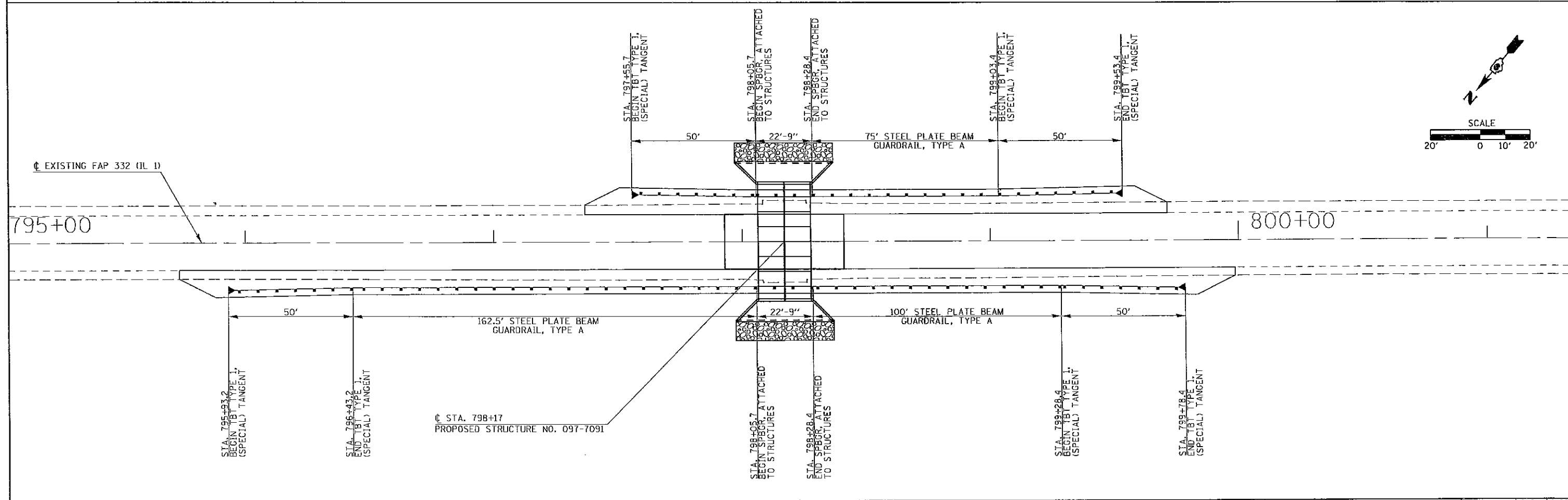
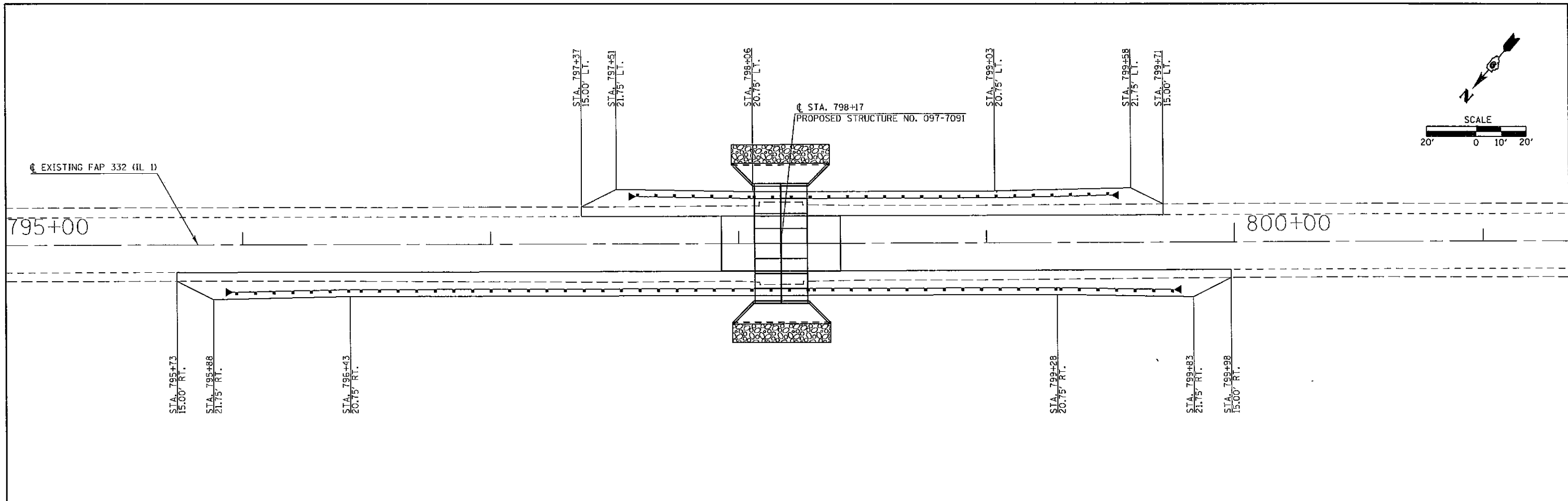

FILE NAME =	USER NAME = walkerra	DESIGNED -	REVISED -	<b>STATE OF ILLINOIS</b> <b>DEPARTMENT OF TRANSPORTATION</b>	<b>PLAN AND PROFILE</b>	SCALE: SHEET OF SHEETS STA. TO STA.	F.A.P. RTE. 332 SECTION 2B-2 COUNTY WHITE TOTAL SHEETS 23 SHEET NO. 7 CONTRACT NO. 78312
Default	Plot Scale = 3/32" = 1'	DRAWN -	REVISED -				
	Plot Date = 5/30/2013	CHECKED -	REVISED -				
		DATE -	REVISED -				



FILE NAME = c:\pwwork\pwwork\dot\walkerr\ad0326433\7832-shgt-road\road\data\1s.dgn	USER NAME = walkerr	DESIGNED - _____	REVISED - _____	<b>STATE OF ILLINOIS DEPARTMENT OF TRANSPORTATION</b>	<b>PROPOSED SHOULDER LAYOUT AND GUARDRAIL LAYOUT SN 097-7091</b>		F.A.P. RTE. 332	SECTION 2B-2	COUNTY WHITE	TOTAL SHEETS 23	SHEET NO. 8
	PLOT SCALE = 40,0000' / in.	CHECKED - _____	REVISED - _____				CONTRACT NO. 78312				
DoFault	PLOT DATE = 5/29/2013	DATE - _____	REVISED - _____	SCALE: _____ SHEET _____ OF _____ SHEETS STA. _____ TO STA. _____		ILLINOIS FED. AID PROJECT					

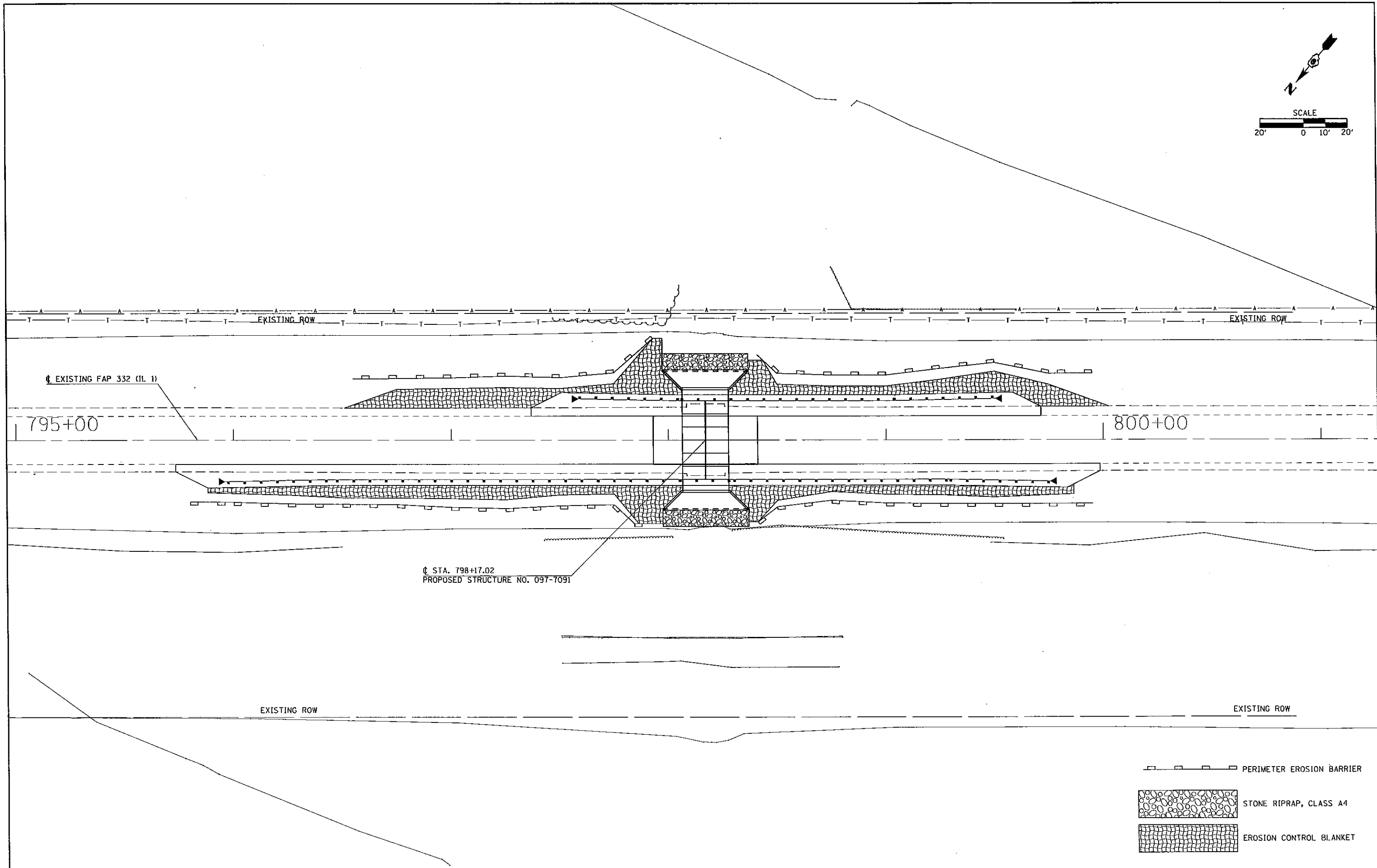
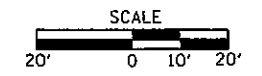

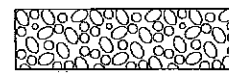
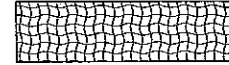

-  PERIMETER EROSION BARRIER
-  STONE RIPRAP, CLASS A4
-  EROSION CONTROL BLANKET

FILE NAME =	USER NAME = walke	DESIGNED -	REVISED -
c:\pwork\pndot\walke\8326433\783	2-sht-erosion_drainage.dwg	DRAWN -	REVISED -
Default	PLOT SCALE = 48.0033 1/ in.	CHECKED -	REVISED -
	PLOT DATE = 5/30/2013	DATE -	REVISED -

**STATE OF ILLINOIS  
DEPARTMENT OF TRANSPORTATION**

**EROSION CONTROL PLAN  
SN 097-7091**

SCALE: \_\_\_\_\_ SHEET \_\_\_\_\_ OF \_\_\_\_\_ SHEETS STA. \_\_\_\_\_ TO STA. \_\_\_\_\_

F.A.P. RTE.	SECTION	COUNTY	TOTAL SHEETS	SHEET NO.
332	28-2	WHITE	23	9
CONTRACT NO. 78312				
ILLINOIS FED. AID PROJECT				

MINIMUM REQUIREMENTS TO OPEN TO TRAFFIC

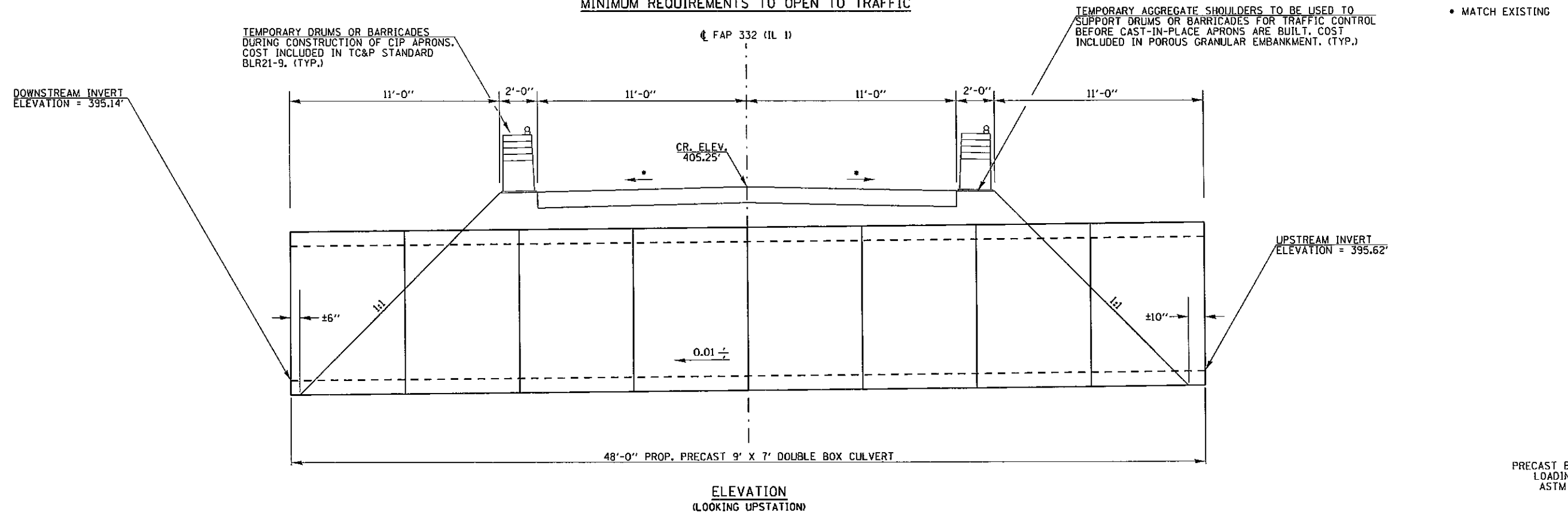

ELEVATION  
(LOOKING UPSTATION)

PRECAST BOX CULVERT  
LOADING HL-93  
ASTM C 1557

FINAL SECTION AFTER CONSTRUCTION OF CAST-IN-PLACE APRONS

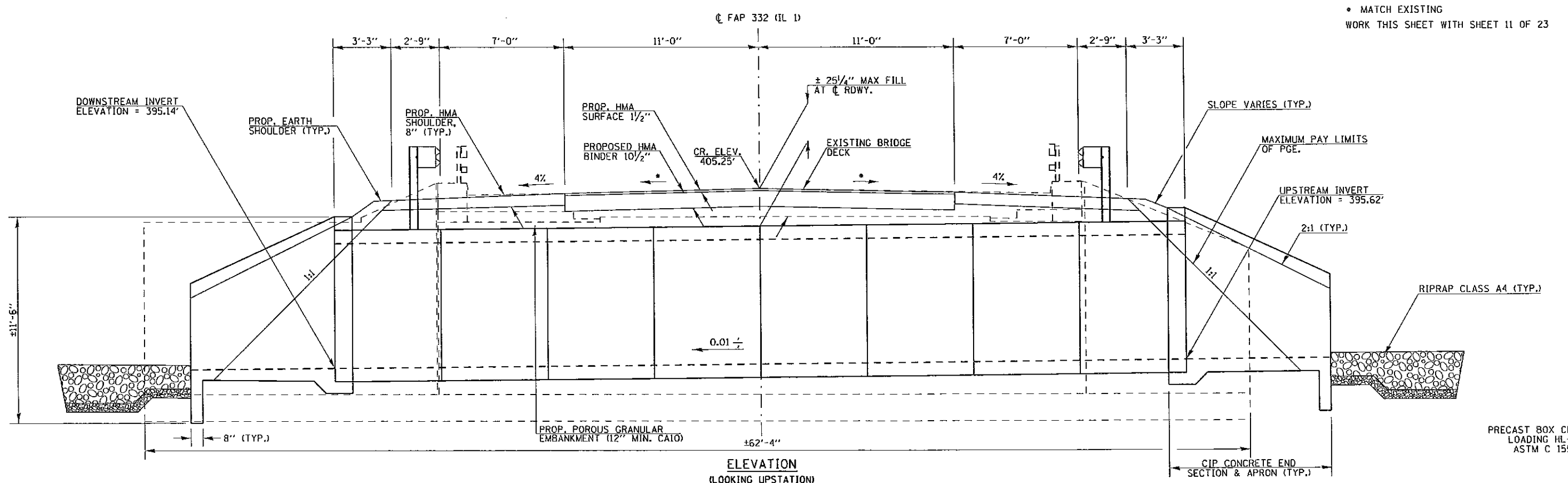

ELEVATION  
(LOOKING UPSTATION)

PRECAST BOX CULVERT  
LOADING HL-93  
ASTM C 1557

FILE NAME =	USER NAME = walkerra	DESIGNED -	REVISED -	<b>STATE OF ILLINOIS DEPARTMENT OF TRANSPORTATION</b>	<b>TEMPORARY AND FINAL SECTIONS</b>			F.A.P. RTE.	SECTION	COUNTY	TOTAL SHEETS	SHEET NO.
c:\pwwork\pwwork\walkerra\08326424\7832-Design.dgn	2-Design.dgn	DRAWN -	REVISED -					332	2B-2	White	23	10
Default	PLOT SCALE = 6.8000' / in.	CHECKED -	REVISED -					CONTRACT NO. 78312				
	PLOT DATE = 5/29/2013	DATE -	REVISED -					(ILLINOIS) FED. AID PROJECT				

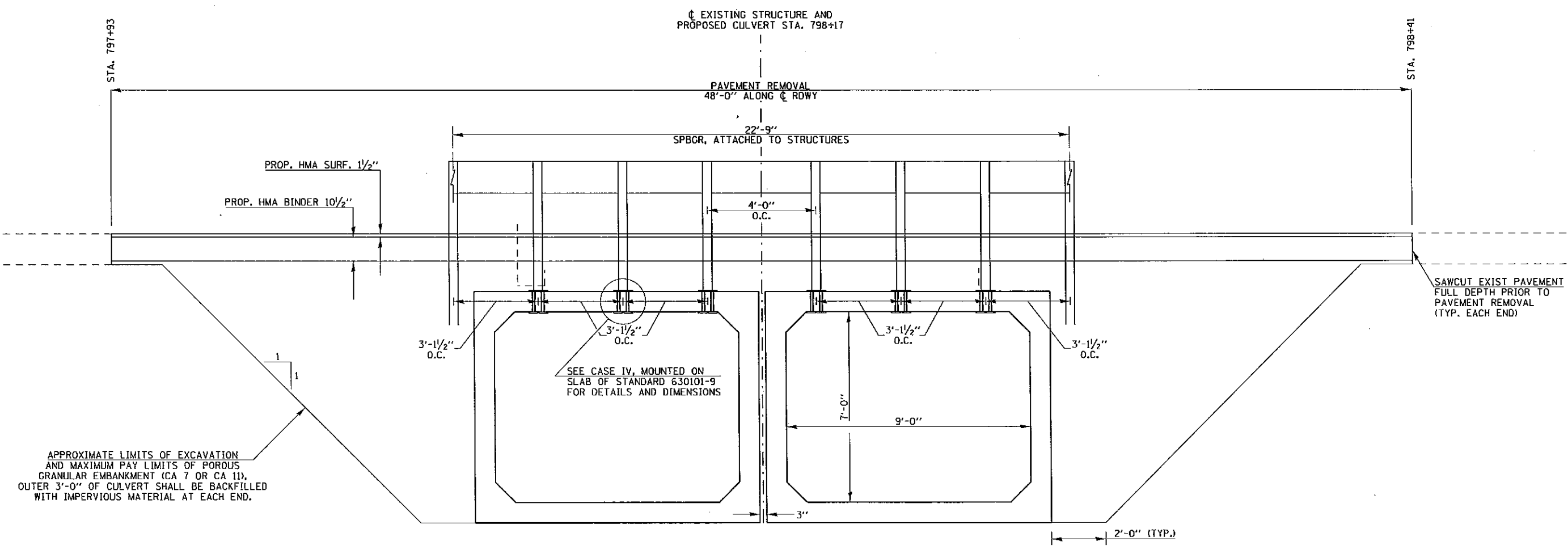

SECTION THRU BOXES  
(LOOKING EAST)

FILE NAME =	USER NAME = wolkerra	DESIGNED - _____	REVISED - _____	<b>STATE OF ILLINOIS DEPARTMENT OF TRANSPORTATION</b>	<b>SECTION THRU PROPOSED BOXES (SN 097-7091)</b>	F.A.P. RTE. 332	SECTION 2B-2	COUNTY WHITE	TOTAL SHEETS 23	SHEET NO. 11		
c:\pwwork\pindot\wolkerra\03264241783-2-Design.dgn	PLOT SCALE = 4.0000' / in.	DRAWN - _____	REVISED - _____			SCALE: _____	SHEET _____ OF _____ SHEETS	STA. _____ TO STA. _____	CONTRACT NO. 78312			
Default	PLOT DATE = 5/29/2013	CHECKED - _____	REVISED - _____			ILLINOIS FED. AID PROJECT						
		DATE - _____	REVISED - _____									

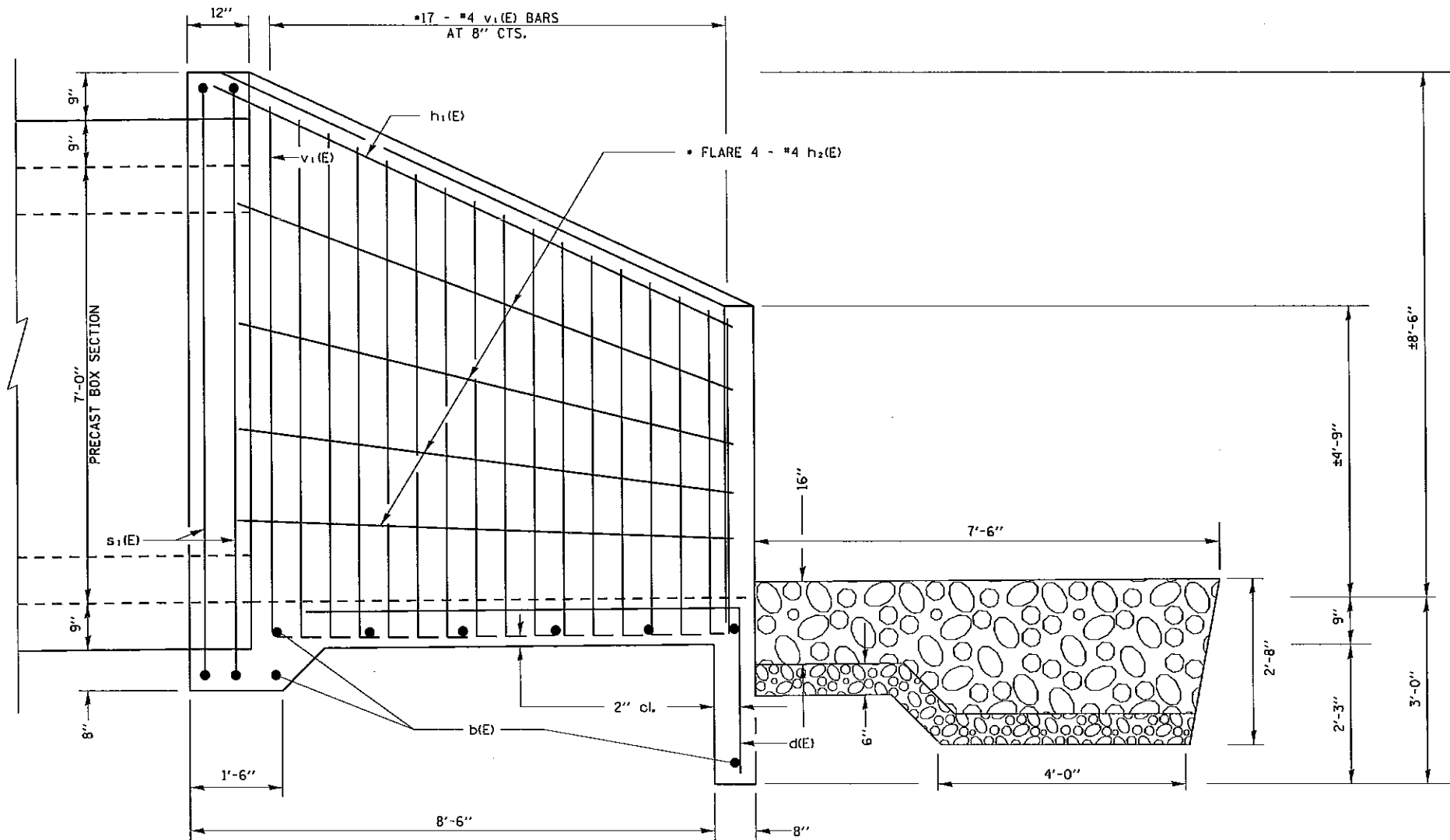

• CUT OR BEND TO FIT  
 MIN BAR LAP  
 #4 1'-4"  
 WORK THIS SHEET WITH  
 SHEET 13 of 23

HALF SIDE ELEVATION

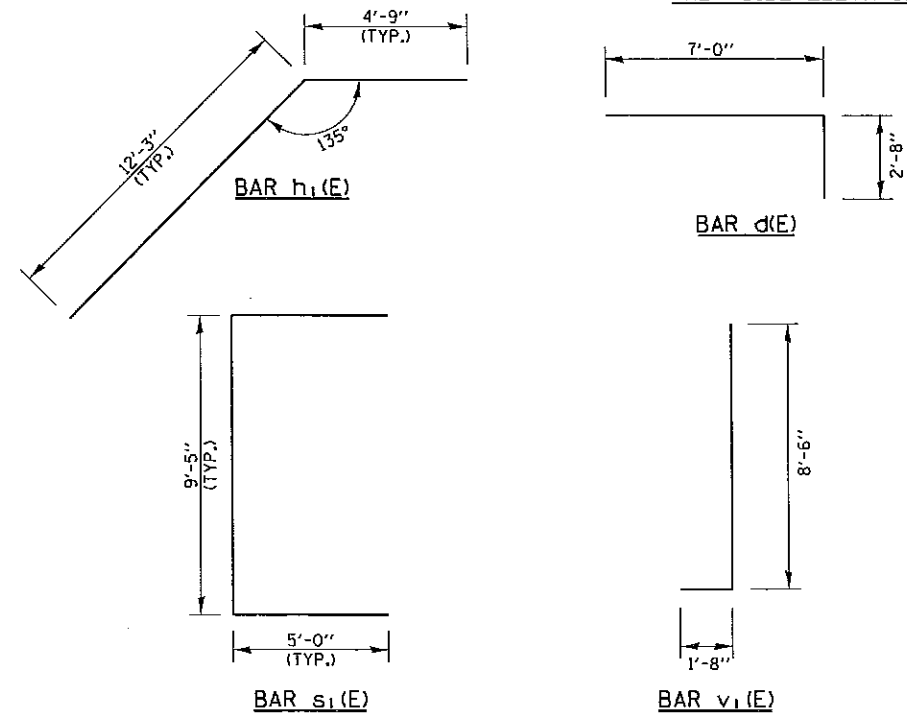

BILL OF MATERIAL (BOTH APRONS)

Bar	No.	Size	Length	Shape
b(E)	32	#4	20'-0"	—
d(E)	52	#4	9'-8"	┌
h(E)	2	#4	15'-6"	—
h1(E)	4	#4	17'-0"	└
h2(E)	16	#4	11'-9"	—
s(E)	8	#4	15'-0"	—
s1(E)	8	#4	19'-5"	┌
v1(E)	68	#4	10'-2"	└
			CONCRETE BOX CULVERTS	CU. YD. 30.8
			REINFORCEMENT BARS, EPOXY COATED.	Pound 1610

REINFORCEMENT BARS DESIGNATED (E) SHALL BE EPOXY COATED.

FILE NAME *	USER NAME = walkerra	DESIGNED -	REVISED -
as\pe_work\pandot\walkerra\d0326424\703	2-Design.dgn	DRAWN -	REVISED -
Default	PLOT SCALE = 2.4000 1/1 in.	CHECKED -	REVISED -
	PLOT DATE = 5/30/2013	DATE -	REVISED -

STATE OF ILLINOIS  
 DEPARTMENT OF TRANSPORTATION

PROPOSED CAST-IN-PLACE APRON END  
 SECTION (SN 097-7091)

SCALE: \_\_\_\_\_ SHEET \_\_\_\_\_ OF \_\_\_\_\_ SHEETS STA. \_\_\_\_\_ TO STA. \_\_\_\_\_

F.A.P. RTE. 332	SECTION 2B-2	COUNTY WHITE	TOTAL SHEETS 23	SHEET NO. 12
				CONTRACT NO. 78312
ILLINOIS FED. AID PROJECT				

• CUT OR BEND TO FIT  
WORK THIS SHEET WITH  
SHEET 12 OF 23

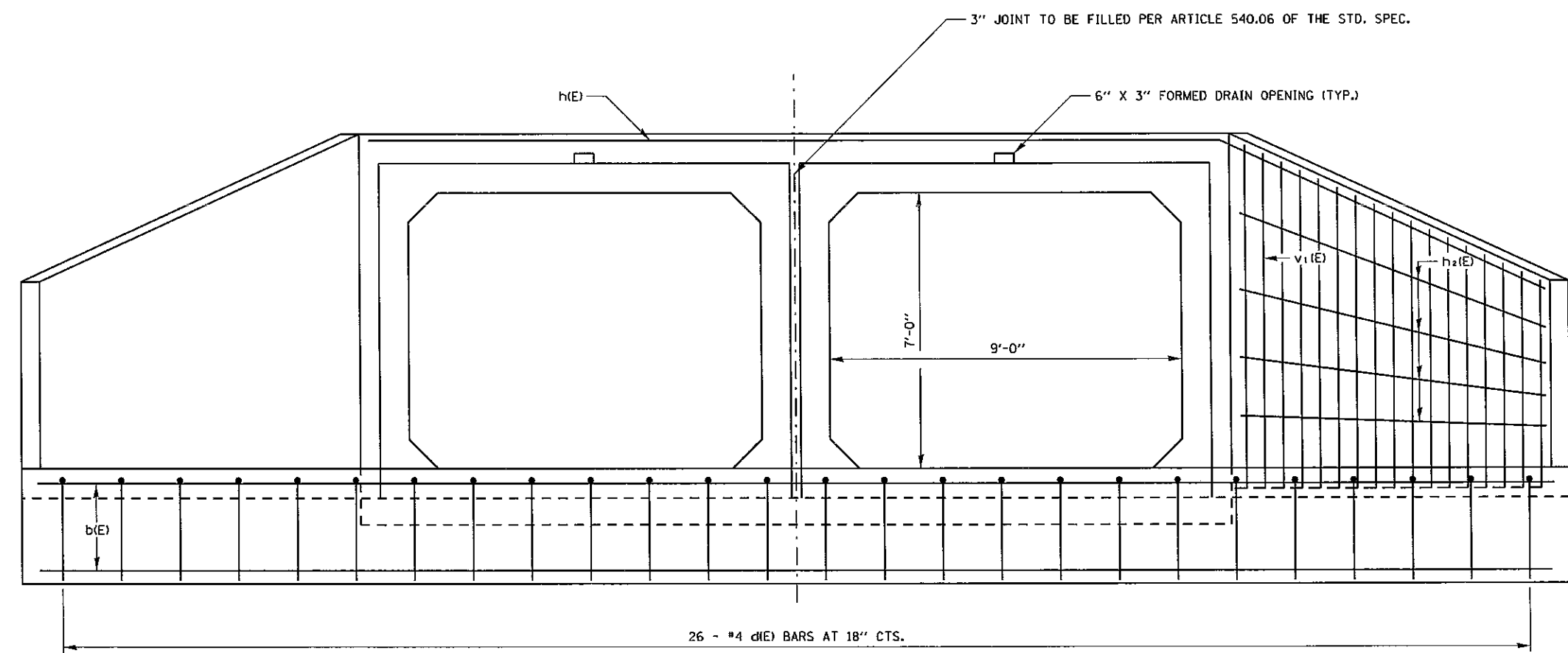

END ELEVATION

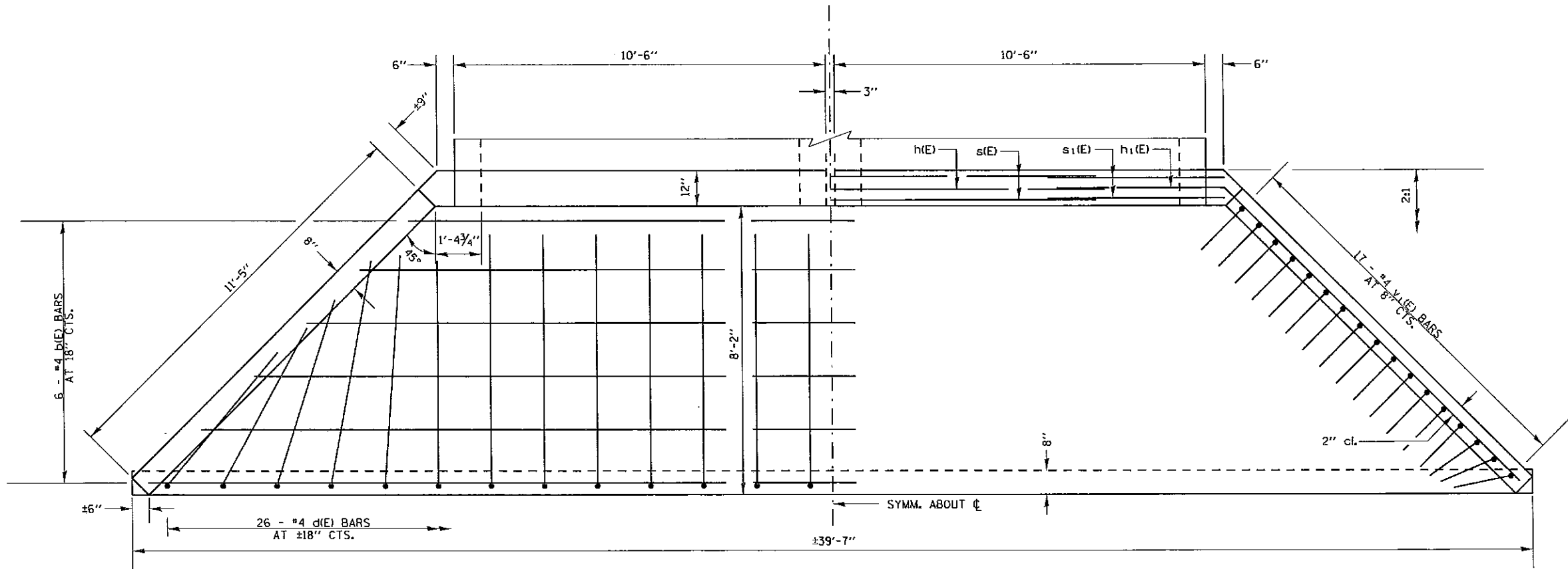

PLAN

FILE NAME =	USER NAME = walkerra	DESIGNED -	REVISED -
c:\pwwork\pwwork\walkerra\d0326424\783	2-Design.dgn	DRAWN -	REVISED -
	PLOT SCALE = 3/8" = 1' / in.	CHECKED -	REVISED -
Default	PLOT DATE = 5/30/2013	DATE -	REVISED -

STATE OF ILLINOIS  
DEPARTMENT OF TRANSPORTATION

PROPOSED CAST-IN-PLACE APRON END  
SECTION (SN 097-7091)

SCALE: \_\_\_\_\_ SHEET \_\_\_\_\_ OF \_\_\_\_\_ SHEETS STA. \_\_\_\_\_ TO STA. \_\_\_\_\_

F.A.P. RTE.	SECTION	COUNTY	TOTAL SHEETS	SHEET NO.
332	2B-2	WHITE	23	13
CONTRACT NO. 78312				
ILLINOIS FED. AID PROJECT				

DATE	
BY	
FINAL SURVEY	
REVISIONS	
NO.	

DATE	
BY	
ORIGINAL SURVEY	
REVISIONS	
NO.	

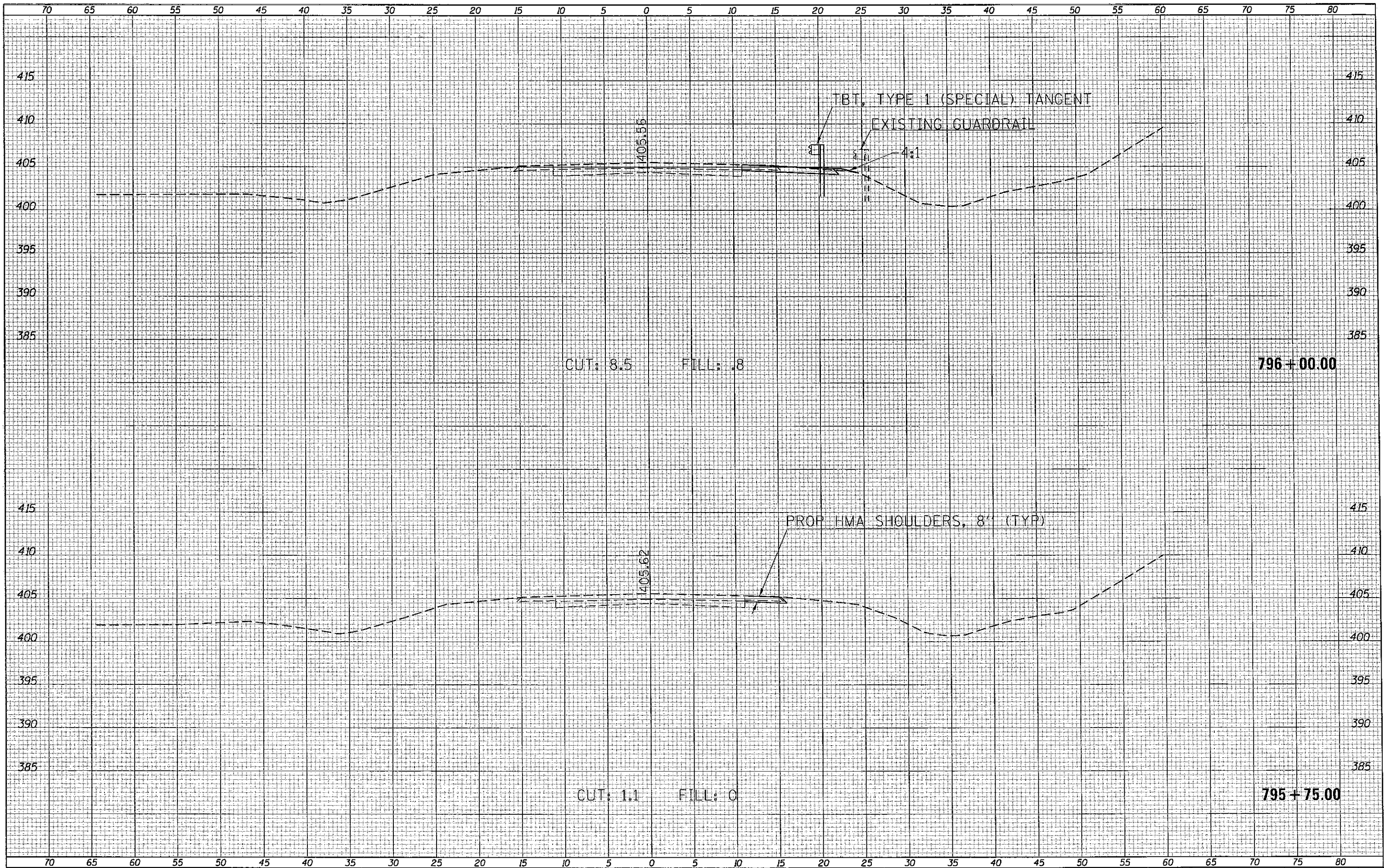

FILE NAME =	USER NAME = walkerra	DESIGNED -	REVISED -	<b>STATE OF ILLINOIS</b> <b>DEPARTMENT OF TRANSPORTATION</b>	<b>CROSS SECTIONS - IL 1</b>		F.A.P. RTE.	SECTION	COUNTY	TOTAL SHEETS	SHEET NO.
Default		DRAWN -	REVISED -		332	2B-2	WHITE	23	14		
	PLOT SCALE = 10.0000' / in.	CHECKED -	REVISED -		SCALE: SHEET OF SHEETS STA. 795+75.00 TO STA. 796+00.00		CONTRACT NO. 78312		ILLINOIS FED. AID PROJECT		
	PLOT DATE = 5/29/2013	DATE -	REVISED -								

DATE	
BY	
FINAL SURVEY	
SURVEYED	
NOTE BOOK	
PLANNED	
TEMP. PLATE	
AREAS CHECKED	
NO.	

DATE	
BY	
ORIGINAL SURVEY	
SURVEYED	
NOTE BOOK	
PLANNED	
TEMP. PLATE	
AREAS CHECKED	
NO.	

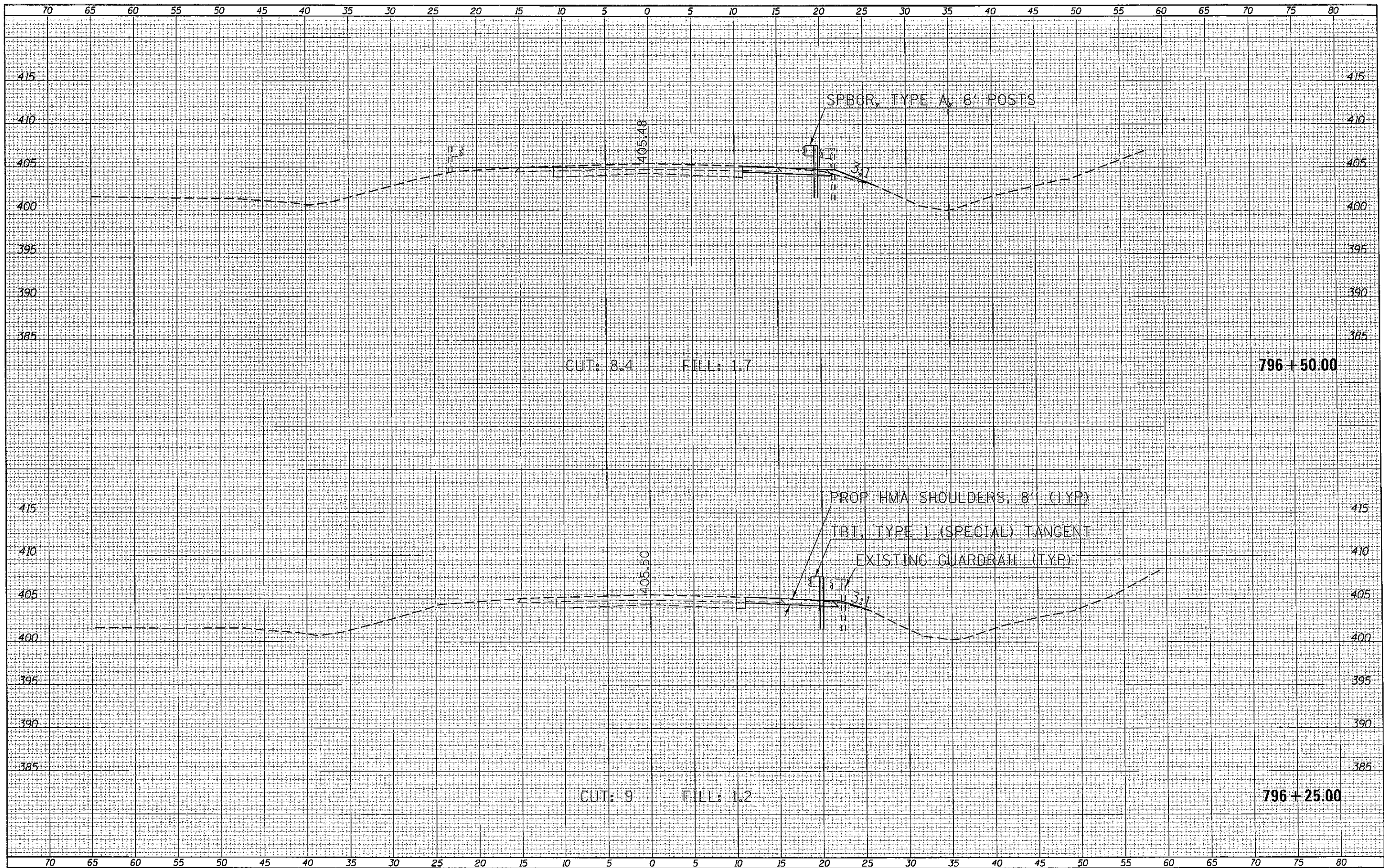

FILE NAME =	USER NAME = walkerra	DESIGNED -	REVISED -	F.A.R. RTE.	SECTION	COUNTY	TOTAL SHEETS	SHEET NO.
Default	sections.dgn	DRAWN -	REVISED -	332	2B-2	WHITE	23	15
	PLOT SCALE = 10.0000' / in.	CHECKED -	REVISED -	CONTRACT NO. 78312				
	PLOT DATE = 5/29/2013	DATE -	REVISED -	ILLINOIS FED. AID PROJECT				

STATE OF ILLINOIS  
DEPARTMENT OF TRANSPORTATION

CROSS SECTIONS - IL 1

SCALE: SHEET OF SHEETS STA. 796+25.00 TO STA. 796+50.00

DATE	
BY	
FINAL SURVEY	
PLOTTED	
NOTE BOOK	
AREAS CHECKED	
NO.	

DATE	
BY	
ORIGINAL SURVEY	
PLOTTED	
NOTE BOOK	
AREAS CHECKED	
NO.	

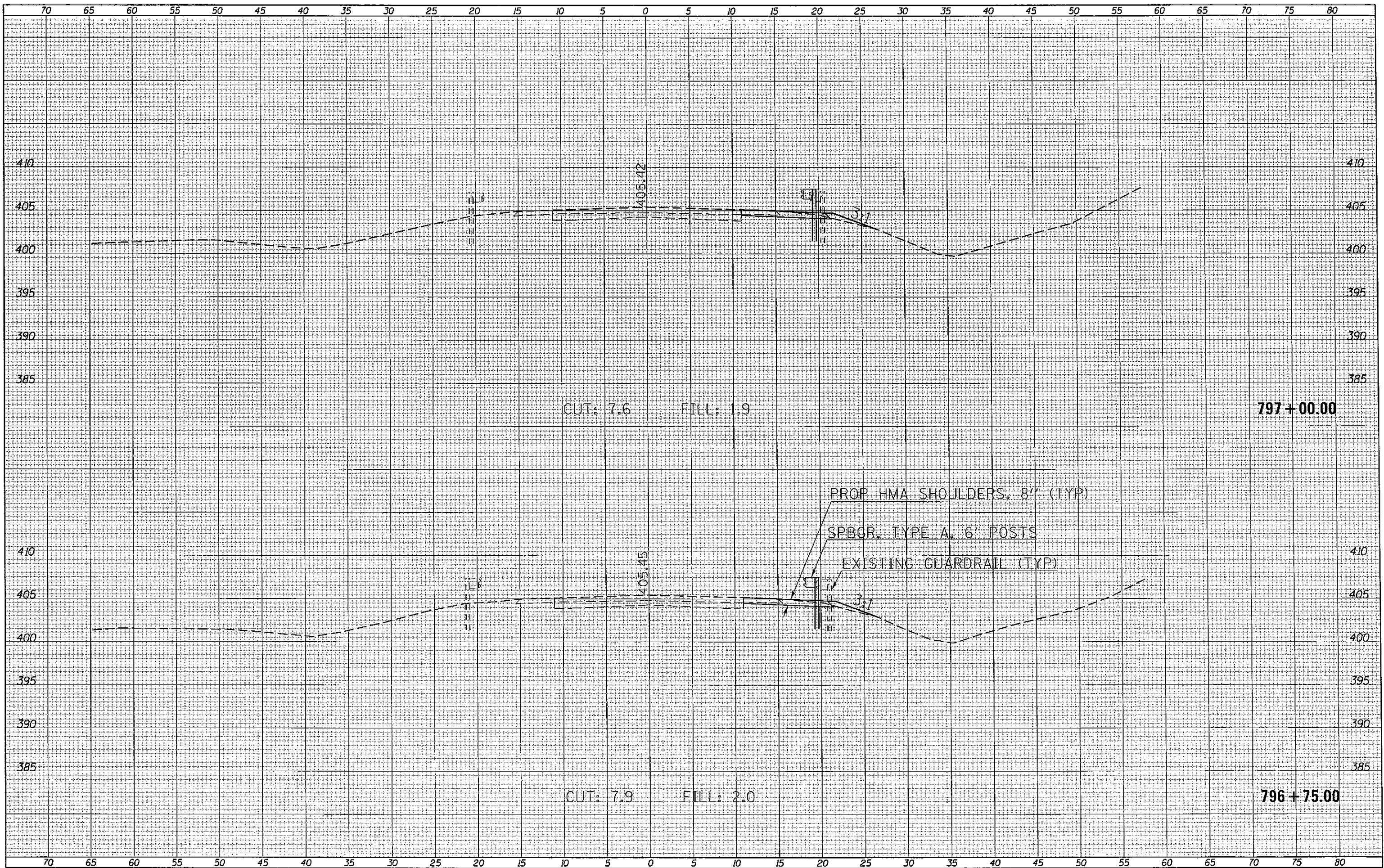

FILE NAME =	USER NAME = wolkera	DESIGNED -	REVISED -	F.A.P. RTE.	SECTION	COUNTY	TOTAL SHEETS	SHEET NO.
c:\pwworksp\pwwork\wolkera\0326433\78312-sht\sections.dgn		DRAWN -	REVISED -	332	2B-2	WHITE	23	16
PLOT SCALE = 10,0000' / 1".		CHECKED -	REVISED -	CROSS SECTIONS - IL 1				CONTRACT NO. 78312
PLOT DATE = 5/29/2013		DATE -	REVISED -	SCALE:	SHEET	OF	SHEETS	STA. 796+75.00 TO STA. 797+00.00
				ILLINOIS FED. AID PROJECT				



DATE	
BY	
FINISHED SURVEY	SURVEYED
NOTE BOOK	PLOTTED
NO.	TEMPLATE
	AREAS CHECKED

DATE	
BY	
ORIGINAL SURVEY	SURVEYED
NOTE BOOK	PLOTTED
NO.	TEMPLATE
	AREAS CHECKED

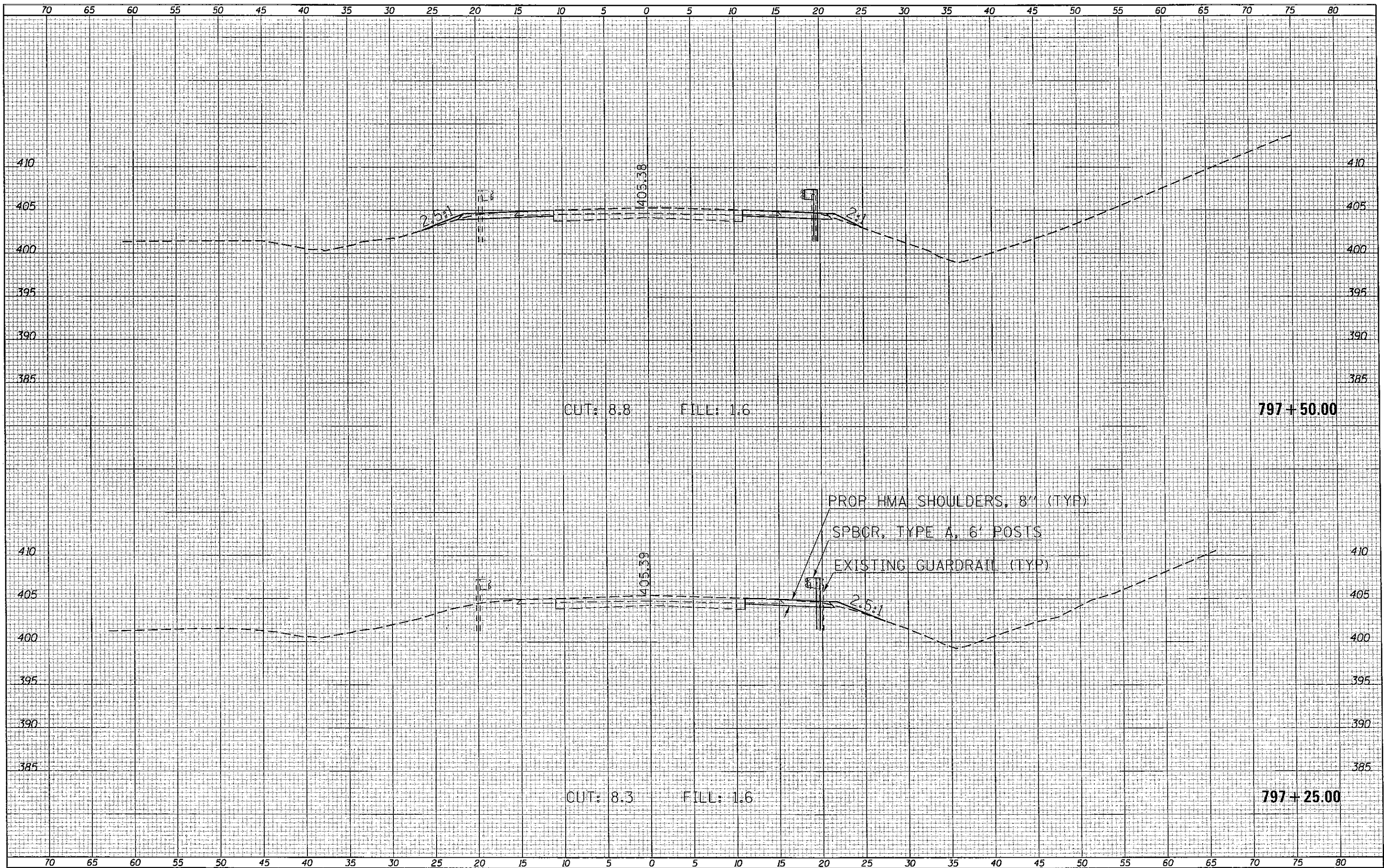

FILE NAME =	USER NAME = walkarra	DESIGNED -	REVISED -	F.A.P. RTE.	SECTION	COUNTY	TOTAL SHEETS	SHEET NO.
Default	Plot Scale = 10.0000' / in.	DRAWN -	REVISED -	332	2B-2	WHITE	23	17
	PLOT DATE = 5/24/2013	CHECKED -	REVISED -	SCALE: SHEET OF SHEETS STA. 797+25.00 TO STA. 797+50.00		CONTRACT NO. 78312		
		DATE -	REVISED -	ILLINOIS FED. AID PROJECT				

STATE OF ILLINOIS  
DEPARTMENT OF TRANSPORTATION

CROSS SECTIONS - IL 1

DATE	
BY	
FINISHED SURVEY	
PLOTTED	
NOTE BOOK	
TEMPLATE	
AREAS CHECKED	
NO.	

DATE	
BY	
ORIGINAL SURVEY	
PLOTTED	
NOTE BOOK	
TEMPLATE	
AREAS CHECKED	
NO.	

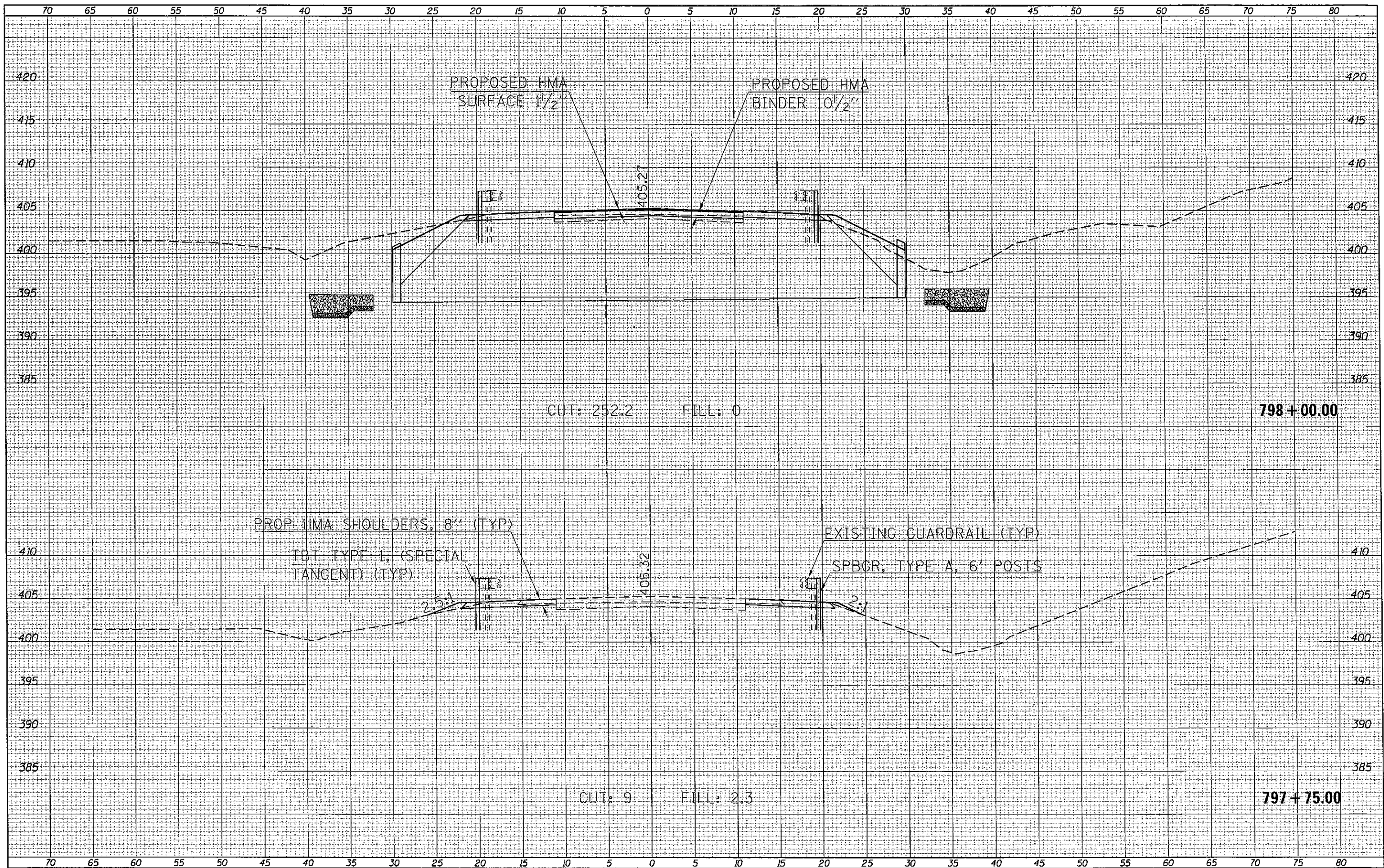

FILE NAME =	USER NAME = walkarra	DESIGNED -	REVISED -	<b>STATE OF ILLINOIS</b> <b>DEPARTMENT OF TRANSPORTATION</b>	<b>CROSS SECTIONS - II 1</b> SCALE: SHEET OF SHEETS STA. 797+75.00 TO STA. 798+00.00	F.A.P. RTE.	SECTION	COUNTY	TOTAL SHEETS	SHEET NO.	
cr:\pw\work\p\walkarra\09326433\78312-shj	actions.dgn	DRAWN -	REVISED -			332	2B-2	WHTE	23	18	
Default	PLOT SCALE = 9.9997' / in.	CHECKED -	REVISED -			CONTRACT NO. 78312					
	PLOT DATE = 5/29/2013	DATE -	REVISED -			ILLINOIS FED. AID PROJECT					

DATE	
BY	
FINAL SURVEY	
ORIGINAL SURVEY	
NOTE BOOK	
NO.	
AREAS CHECKED	

DATE	
BY	
FINAL SURVEY	
ORIGINAL SURVEY	
NOTE BOOK	
NO.	
AREAS CHECKED	

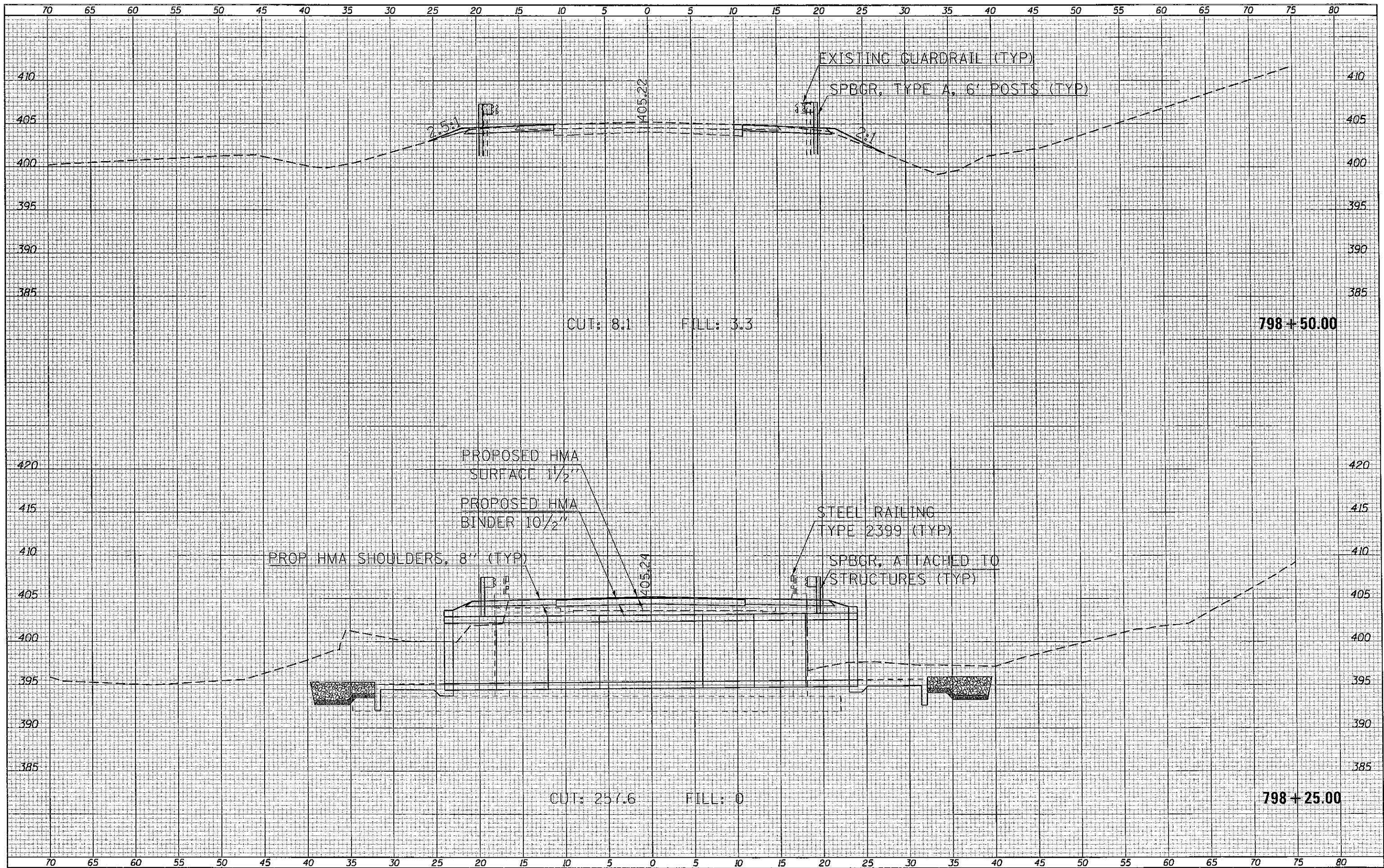



DATE	
BY	
FINAL SURVEY	
PLOTTED	
NOTE BOOK	
AREAS	
CHECKED	
NO.	

DATE	
BY	
ORIGINAL SURVEY	
PLOTTED	
NOTE BOOK	
AREAS	
CHECKED	
NO.	

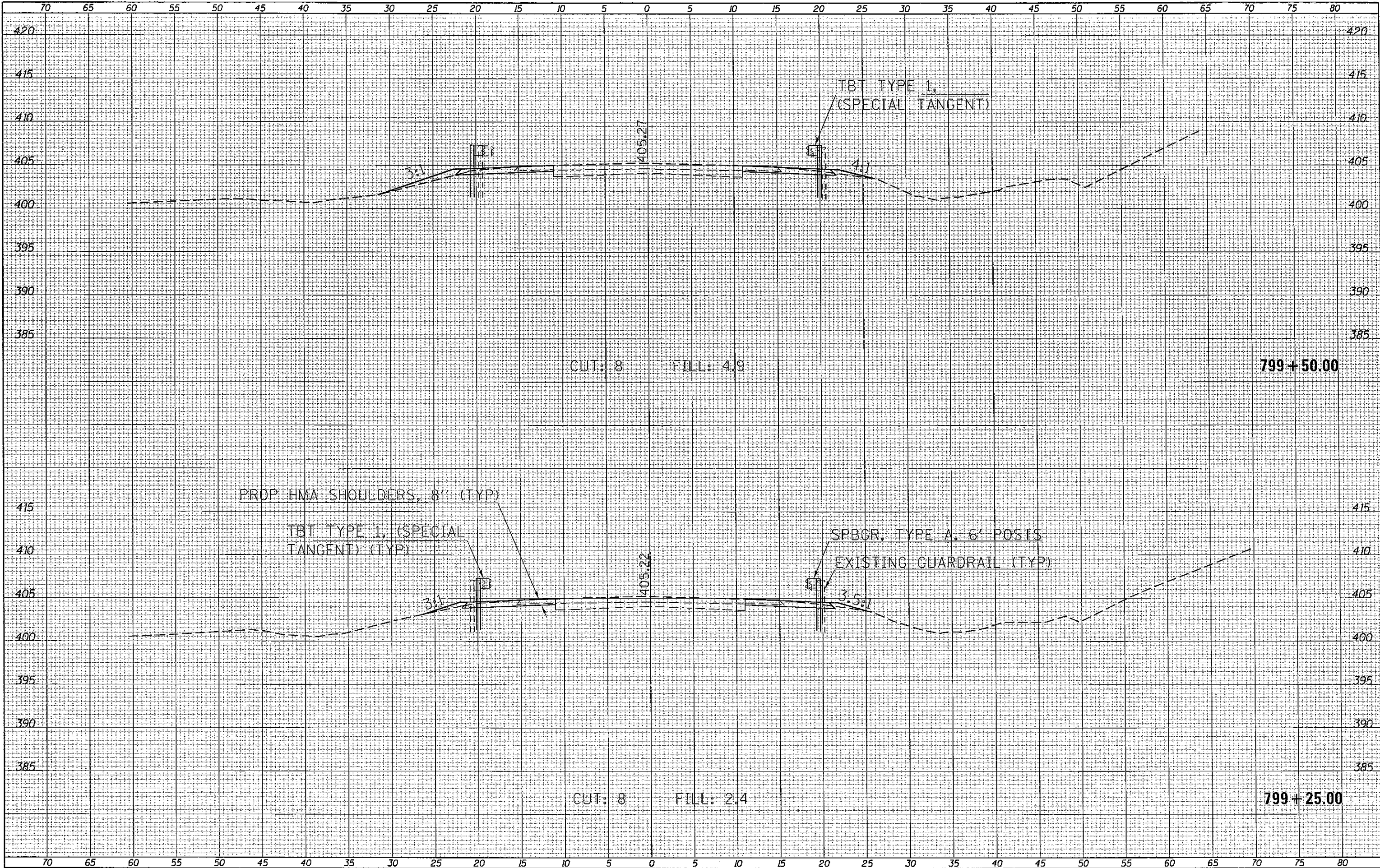

DATE	
BY	
FINAL SURVEY	SURVEYED
NOTE BOOK	PLOTTED
NO.	TEMPLATE
	AREAS CHECKED

DATE	
BY	
ORIGINAL SURVEY	SURVEYED
NOTE BOOK	PLOTTED
NO.	TEMPLATE
	AREAS CHECKED

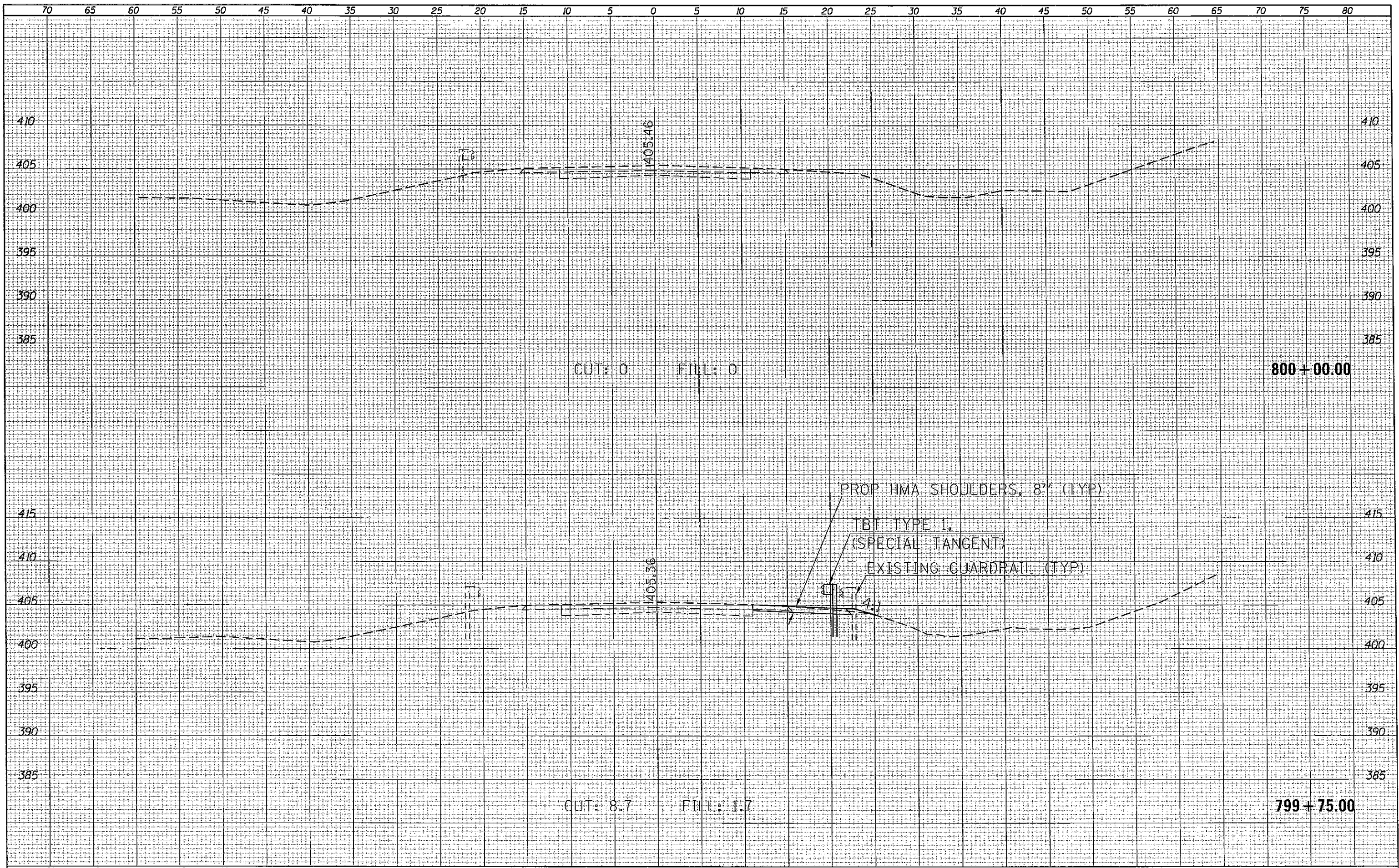

FILE NAME *	USER NAME * walkerra	DESIGNED -	REVISED -	F.A.P. RTE.	SECTION	COUNTY	TOTAL SHEETS	SHEET NO.
c:\pwork\owido\walkerra\08326433\78312-sh.t	sections.dgn	DRAWN -	REVISED -	332	2B-2	WHITE	23	22
Default	PLOT SCALE = 1/4" = 10'	CHECKED -	REVISED -	CROSS SECTIONS - IL 1				CONTRACT NO. 78312
	PLOT DATE = 5/29/2013	DATE -	REVISED -	SCALE: SHEET OF SHEETS STA. 799+75.00 TO STA. 800+00.00				ILLINOIS FED. AID PROJECT

STATE OF ILLINOIS  
DEPARTMENT OF TRANSPORTATION

DATE	
BY	
FINAL SURVEY	SURVEYED
NOTE BOOK	PLOTTED
NO.	TEMPLATE
	AREAS
	CHECKED

DATE	
BY	
ORIGINAL SURVEY	SURVEYED
NOTE BOOK	PLOTTED
NO.	TEMPLATE
	AREAS
	CHECKED

