

F.A. RTE.	SECTION	COUNTY	TOTAL SHEETS	SHEET NO.
	12-00037-00-SW	PEORIA	20	1
		ILLINOIS	CONTRACT NO. 89645	

INDEX OF SHEETS 09-20-13 LETTING ITEM 062

- 1 COVER SHEET, INDEX OF SHEETS AND HIGHWAY STANDARDS
- 2 GENERAL NOTES AND TYPICAL SECTION
- 3 SUMMARY OF QUANTITIES
- 4-5 SCHEDULE OF QUANTITIES
- 6 SHEET INDEX LINE DIAGRAM, COORDINATES AND BENCHMARKS
- 7-18 SIDEWALK PLAN SHEETS
- 19-20 DETAILS

STATE OF ILLINOIS
DEPARTMENT OF TRANSPORTATION
DIVISION OF HIGHWAYS

PROPOSED SAFE ROUTES TO SCHOOL

SECTION 12-00037-00-SW
PROJECT SRTS-4009 (262)
CITY OF CHILlicothe
PEORIA COUNTY
JOB NO. C-94-070-13

HIGHWAY STANDARDS

- 000001-06
- 424001-07
- 424011-01
- 606001-05
- 701001-02
- 701006-04
- 701011-03
- 701501-06
- 701801-05
- 701901-02

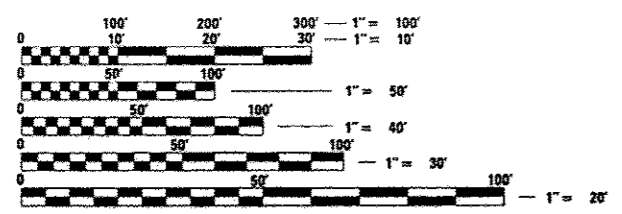
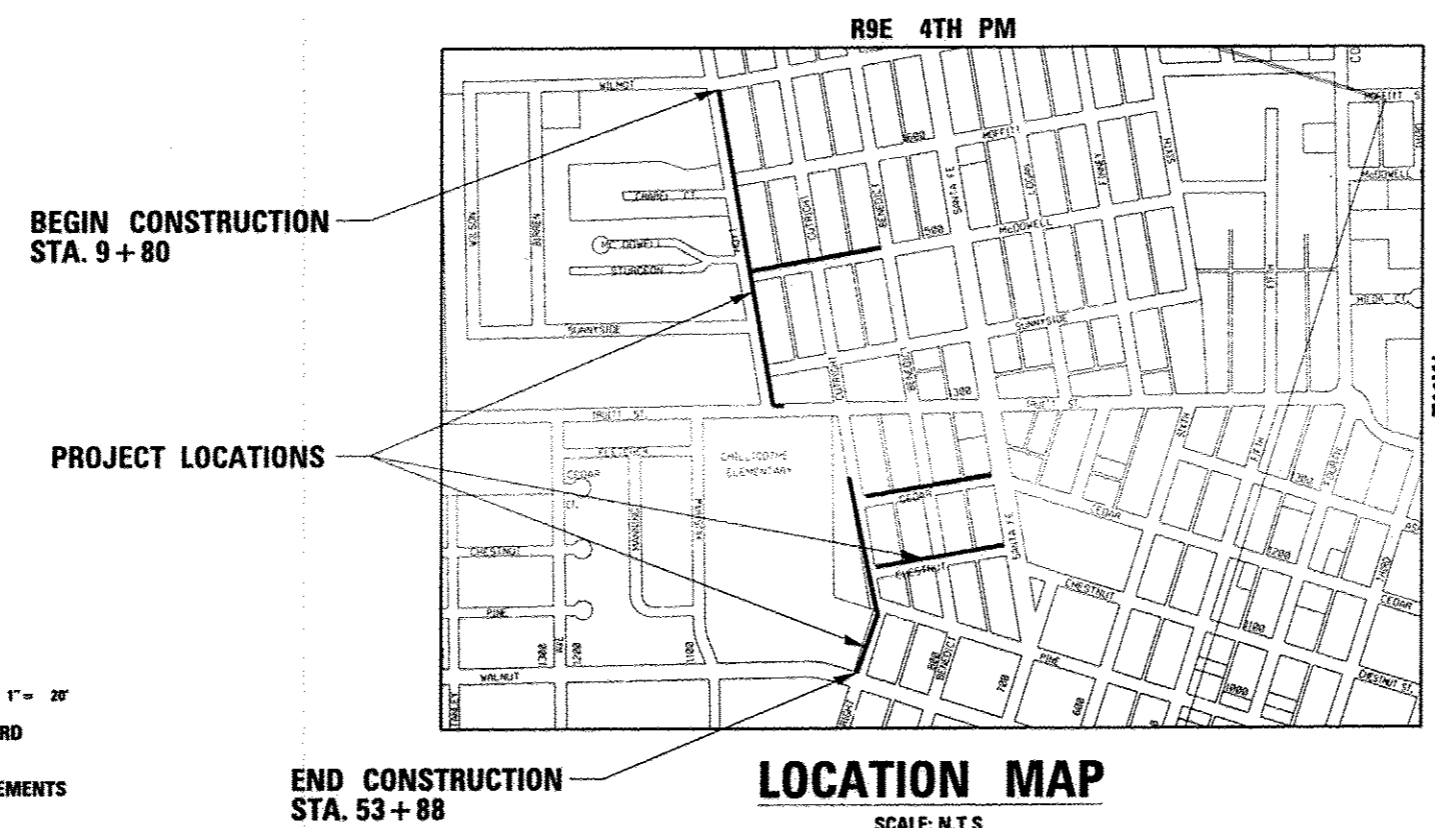
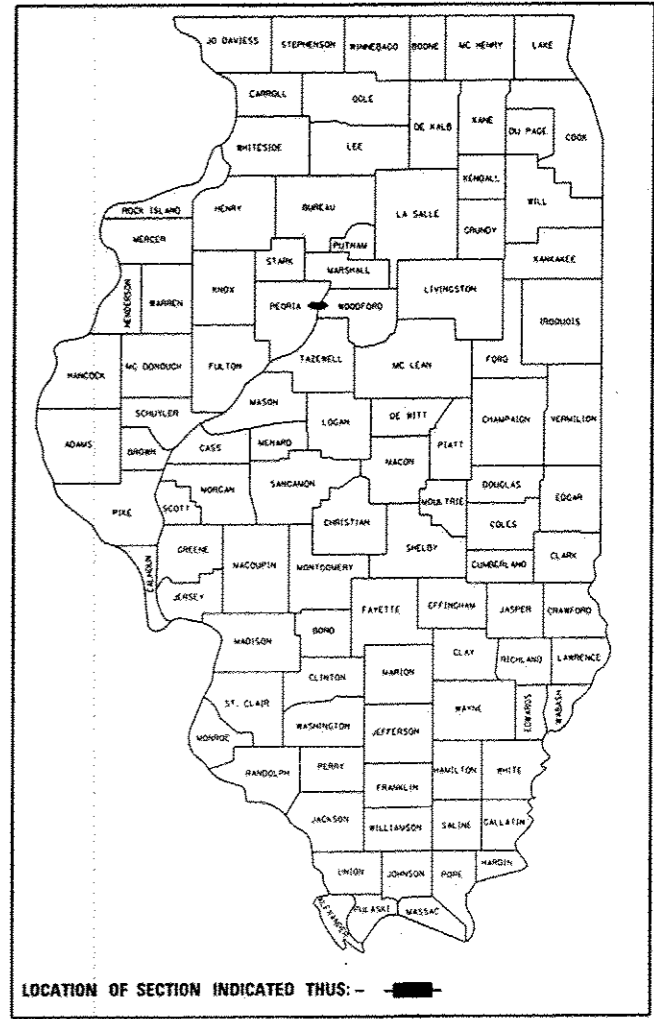

FULL SIZE PLANS HAVE BEEN PREPARED USING STANDARD ENGINEERING SCALES. REDUCED SIZED PLANS WILL NOT CONFORM TO STANDARD SCALES. IN MAKING MEASUREMENTS ON REDUCED PLANS, THE ABOVE SCALES MAY BE USED.

J.U.L.I.E.
 JOINT UTILITY LOCATION INFORMATION FOR EXCAVATION
 1-800-892-0123
 OR 811



Kenneth M. Coulter
 KENNETH M. COULTER
 ILLINOIS REGISTERED PROFESSIONAL ENGINEER
 No. 062-038839
 EXPIRATION DATE 11/30/13
 DATE 7-5-13

GROSS LENGTH = 5,265 FT. = 0.997 MILE
 NET LENGTH = 4,800 FT. = 0.909 MILE



CONTRACT NO. 89645

APPROVED	<i>July 3</i>	2013
	<i>Stanford Deans</i>	
	LOCAL AGENCY OFFICIAL	CITY OF CHILlicothe
PASSED	<i>07-10</i>	2013
	<i>Ray Garcia</i>	
	DISTRICT ENGINEER OF LOCAL	ROADS AND STREETS
RELEASING FOR BID BASED ON LIMITED REVIEW	<i>July 11</i>	2013
	DEPUTY DIRECTOR OF HIGHWAYS,	REGION FOUR ENGINEER
	STATE OF ILLINOIS	DEPARTMENT OF TRANSPORTATION

**PRINTED BY THE AUTHORITY
OF THE STATE OF ILLINOIS**

GENERAL NOTES

- The locations of existing water mains, gas mains, sewers, electric power lines, telephone lines and other utilities as shown on the plans are based on careful field investigation and the best information available, but they are not guaranteed. Unless elevations are shown --- all utility locations shown on the plans are based on the approximate depth supplied by the utility company. It shall be the Contractor's responsibility to ascertain their exact location from the utility companies and by field inspection.
- All work shall be in accordance with the "Standard Specifications For Road And Bridge Construction" adopted January 1, 2012, and the latest edition of the "Illinois Manual On Uniform Traffic Control Devices For Streets And Highways" in effect on the date of invitation for bids.
- Access must be maintained to all existing properties during construction per Article 107.09 unless arrangements are made in writing by the Contractor with the property owners with a copy to the Engineer for short-term closures.
- Erosion control practices shall be followed at all times in accordance with the latest "Standards And Specifications For Soil Erosion And Sediment Control".
- The material used for construction of permanent aggregate driveways shall be gravel or crushed stone, as directed by the Engineer, to replace in kind the existing aggregate driveways. No additional compensation shall be provided for this requirement but shall be considered as included in the cost of the pay item for the aggregate as specified on the plans.
- The Contractor shall provide traffic control in conformance with the "Manual On Uniform Traffic Control Devices For Streets And Highways", State of Illinois, and Section 107.14 of the Highway Standards. Barricades and other required traffic control shall be considered incidental to the contract.
- The City of Chillicothe Public Works Department will relocate any stop signs or regulatory signs as needed. The contractor shall coordinate the relocations as required. The cost of coordinating the relocations shall be considered as included in the cost of PCC Sidewalk 4".
- All elevations shown on the plans are established from U.S.C.S. mean sea level datum.
- Trees and shrubs not labeled on the plans for removal shall be saved unless Engineer or his assigned determines that construction operations prohibit saving. Shrub and bush removal shall be considered incidental to the contract.
- Water valves shall be adjusted to grade as needed by the city of Chillicothe public works department. The contractor shall coordinate the adjustments as required. The cost of coordinating the adjustments shall be considered as included in the cost of PCC Sidewalk 4".

STATUS OF UTILITIES			
Station	Type of Utility	Type of Conflict	Disposition
17+01, 25' LT.	Water Valve	Sidewalk	Adjust
21+97, 24.4' LT.	Water Valve	Grading	Caution
23+90, 28.8' LT.	Sewer Cleanout	Grading	Caution
26+66, 50.3' LT.	Traffic Signal	Sidewalk	Caution
31+78, 26.4' LT.	Power Pole	Sidewalk	Caution
32+81, 23.2' LT.	Water Valve	Sidewalk	Adjust
33+96, 23.7' LT.	Power Pole	Sidewalk	Relocate
34+77, 24.5' LT.	Water Valve	Sidewalk	Adjust
35+58, 23.4' LT.	Power Pole	Sidewalk	Relocate
37+09, 24.4' LT.	Power Pole	Sidewalk	Caution
37+10, 25.2' RT.	Fire Hydrant	Sidewalk	Caution
48+51, 21.4' RT.	Street Light	Sidewalk	Caution
49+55, 28.7' RT.	Street Light	Sidewalk	Caution
60+22, 23.8' LT.	Power Pole	Sidewalk	Caution
60+92, 24.4' LT.	Guy Anchor	Sidewalk	Relocate
61+13, 23.3' LT.	Power Pole	Sidewalk	Caution
61+90, 23.5' LT.	Power Pole	Sidewalk	Caution
63+42, 23.0' LT.	Power Pole	Sidewalk	Caution
64+40, 23.0' LT.	Power Pole	Sidewalk	Caution
65+44, 23.8' LT.	Power Pole	Sidewalk	Caution
67+11, 23.7' LT.	Water Valve	Sidewalk	Adjust
83+41, 16.0' LT.	Water Valve	Sidewalk	Adjust

HMA ASPHALT MIXTURE REQUIREMENTS

Mixture Uses(s):	INCIDENTAL HOT-MIX ASPHALT SURFACING
RAP % (Max)**:	10
AC/PG:	SBR OR SBS PG 64-22
Design Air Voids:	4.0% @ N = 50
Mixture Composition: (Gradation Mixture)	IL 9.5 OR IL 12.5
Friction Aggregate	MIX "C"
Mixture Weight:	112#/50 YD/IN

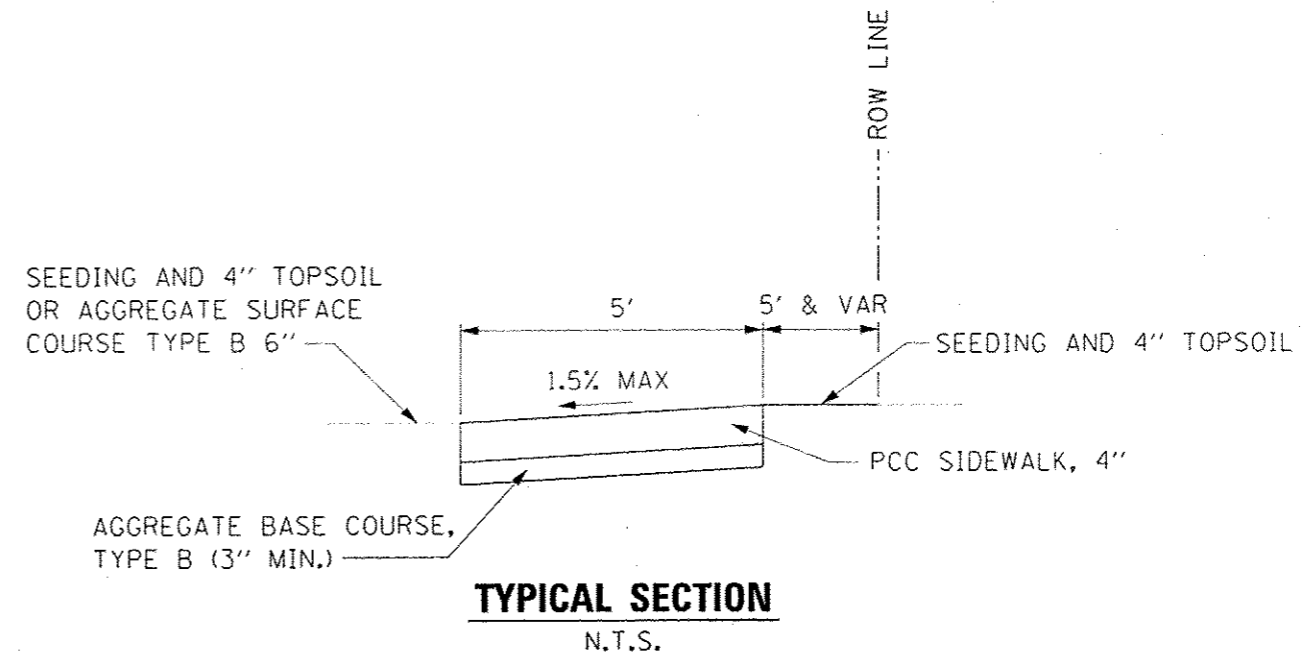

K:\PROJECTS\62015\55\Task 100 - Misc Engineer\msh\535 Safe_Route to School - 2012\CAD\GENERAL NOTES.DWG

SUMMARY OF QUANTITIES				PEORIA COUNTY	
				CONSTRUCTION TYPE CODE	
				ROADSIDE IMPROVEMENTS	
				0021	
CODE NO.	PAY ITEM	UNIT	TOTAL QUANTITY		
20100210	TREE REMOVAL (OVER 15 UNITS DIAMETER)	UNIT	30		30
20400800	FURNISHED EXCAVATION	CU YD	43		43
21101615	TOPSOIL FURNISH AND PLACE, 4"	SQ YD	2,185		2,185
25000110	SEEDING, CLASS 1A	ACRE	0.5		0.5
25000400	NITROGEN FERTILIZER NUTRIENT	POUND	41		41
25000500	PHOSPHORUS FERTILIZER NUTRIENT	POUND	41		41
25000600	POTASSIUM FERTILIZER NUTRIENT	POUND	41		41
25100115	MULCH, METHOD 2	ACRE	0.5		0.5
35101598	AGGREGATE BASE COURSE, TYPE B 3"	SQ YD	2,715		2,715
40200800	AGGREGATE SURFACE COURSE, TYPE B	TON	111		111
△ 40800050	INCIDENTAL HOT-MIX ASPHALT SURFACING	TON	33		33
42300200	PORTLAND CEMENT CONCRETE DRIVEWAY PAVEMENT, 6 INCH	SQ YD	47		47
42400100	PORTLAND CEMENT CONCRETE SIDEWALK 4 INCH	SQ FT	21,090		21,090
42400300	PORTLAND CEMENT CONCRETE SIDEWALK 6 INCH	SQ FT	3,337		3,337
42400800	DETECTABLE WARNINGS	SQ FT	491		491
44000200	DRIVEWAY PAVEMENT REMOVAL	SQ YD	103		103
44000500	COMBINATION CURB AND GUTTER REMOVAL	FOOT	132		132
44000600	SIDEWALK REMOVAL	SQ FT	6,101		6,101
60603800	COMBINATION CONCRETE CURB AND GUTTER, TYPE B-6.12	FOOT	74		74
67100100	MOBILIZATION	L SUM	1		1
Z0003855	BICYCLE RACKS	EACH	2		2
Z0013798	CONSTRUCTION LAYOUT	L SUM	1		1
60600005	CONCRETE CURB, TYPE B	FOOT	230		230
X7010216	TRAFFIC CONTROL AND PROTECTION, (SPECIAL)	L SUM	1		1

△ SPECIALTY ITEMS

K:\PROJECTS\815455\Task 108 - Misc Engineering\435 Safe Routes to School - 2013\CADD\S000.dwg

FILE NAME : \$FILE	USER NAME : I00T	DESIGNED - KMC	REVISED -	STATE OF ILLINOIS DEPARTMENT OF TRANSPORTATION	SUMMARY OF QUANTITIES SAFE ROUTES TO SCHOOL			F.A. RTE.	SECTION	COUNTY	TOTAL SHEETS	SHEET NO.
PLOT SCALE = 2.0000" = 1'		DRAWN - CAM	REVISED -						12-00037-00-SW	PEORIA	20	3
PLOT DATE = 7/12/2013		CHECKED - REW	REVISED -		SCALE:	SHEET NO. OF SHEETS	STA. TO STA.	CONTRACT NO. 89645				
		DATE - 6-18-13	REVISED -		ILLINOIS FED. AID PROJECT							

LOCATION				TREE REMOVAL OVER 15'	DRIVEWAY REMOVAL	SIDEWALK REMOVAL	CURB & GUTTER REMOVAL
				UNITS	SQ YD	SQ FT	FOOT
HOYT STREET							
STA. 10+18.43	TO	STA. 12+38.37	LT			885.1	
STA. 12+45.74	TO	STA. 14+68.58	LT			882.9	
STA. 21+90.79	TO	STA. 22+41.99	LT			200.2	
STA. 23+22.87	TO	STA. 23+33.10	LT		5.8		
STA. 25+11.28	TO	STA. 25+17.42	LT			23.5	
STA. 25+17.42	TO	STA. 26+41.02	LT			496.0	
STA. 26+41.02	TO	STA. 26+77.78	LT			347.2	48.0
STA. 26+44.89	TO	STA. 26+60.84	RT			102.0	19.9
STA. 27+04.54	TO	STA. 27+12.91	RT			44.7	7.4
CUTRIGHT STREET							
STA. 40+91.70	TO	STA. 41+08.30	RT				14.0
STA. 44+13.85	TO	STA. 44+29.82	RT			59.5	
STA. 44+29.82	TO	STA. 44+63.61	RT		29.1		
MCDOWELL STREET							
STA. 30+34.98	TO	STA. 30+34.98	LT	30			
STA. 35+04.23	TO	STA. 35+42.00	LT				44.2
STA. 35+62.69	TO	STA. 35+98.77	LT		12.5		
STA. 37+03.78	TO	STA. 37+07.25	LT			43.0	
STA. 37+03.58	TO	STA. 37+07.69	RT			75.7	
STA. 37+58.29	TO	STA. 37+70.72	RT			63.2	
CEDAR STREET							
STA. 60+12.73	TO	STA. 63+43.65	LT			1,254.9	
STA. 63+91.55	TO	STA. 67+18.96	LT			1,310.5	
STA. 67+02.79	TO	STA. 67+06.63	RT			58.0	
STA. 67+81.40	TO	STA. 67+75.99	LT			54.0	
CHESTNUT STREET							
STA. 81+06.69	TO	STA. 81+26.39	LT		8.8		
STA. 81+59.38	TO	STA. 81+61.69	LT			9.5	
STA. 83+35.22	TO	STA. 83+38.90	LT			51.1	
STA. 85+10.17	TO	STA. 85+34.17	LT		48.1		
STA. 87+00.92	TO	STA. 87+04.42	LT			43.2	
STA. 87+01.42	TO	STA. 87+64.41	RT			98.3	
SUBTOTAL				30.0	102.4	6,100.4	131.5
TOTAL				30	103	6,101	132

LOCATION				COMBINATION CONCRETE CURB AND GUTTER TY. B. 8-12
				FOOT
HOYT STREET				
STA. 28+41.02	TO	STA. 28+77.78	LT	48.0
STA. 28+44.99	TO	STA. 28+60.84	RT	19.9
STA. 27+04.54	TO	STA. 27+12.91	RT	7.4
SUBTOTAL				73.3
TOTAL				74

LOCATION				CONCRETE CURB, TYPE B
				FOOT
HOYT STREET				
STA. 18+18.24	TO	STA. 18+24.24	LT	12.0
STA. 25+17.83	TO	STA. 28+64.55	LT	152.0
MCDOWELL STREET				
STA. 35+04.23	TO	STA. 35+44.45	LT	85.8
SUBTOTAL				229.8
TOTAL				230

MOBILIZATION	
LOCATION	L SUM
ENTIRE PROJECT	1
TOTAL	1

CONSTRUCTION LAYOUT	
LOCATION	L SUM
ENTIRE PROJECT	1
TOTAL	1

TRAFFIC CONTROL AND PROTECTION (SPECIAL)	
LOCATION	L SUM
ENTIRE PROJECT	1
TOTAL	1

LOCATION				LENGTH	AVE WIDTH	SQ YD	SEEDING, CLASS 1A	NITROGEN FERTILIZER NUTRIENT	PHOSPHORUS FERTILIZER NUTRIENT	POTASSIUM FERTILIZER NUTRIENT	MULCH, METHOD 2	TOPSOIL FURNISH AND PLACE, 4"
							ACRE	POUNDS	POUNDS	POUNDS	ACRE	SQ YD
HOYT STREET												
STA. 10+00.00	TO	STA. 15+00.00	LT	480.0	5.0	286.7	0.06	5.0	5.0	5.0	0.06	286.7
STA. 15+00.00	TO	STA. 20+00.00	LT	400.0	5.0	222.2	0.05	4.1	4.1	4.1	0.05	222.2
STA. 20+00.00	TO	STA. 28+50.00	LT	540.0	5.0	300.0	0.06	5.6	5.6	5.6	0.06	300.0
CUTRIGHT STREET												
STA. 44+15.00	TO	STA. 60+00.00	RT	370.0	5.0	205.6	0.04	3.8	3.8	3.8	0.04	205.6
STA. 50+00.00	TO	STA. 53+90.00	RT	318.0	5.0	176.7	0.04	3.3	3.3	3.3	0.04	176.7
MCDOWELL STREET												
STA. 30+00.00	TO	STA. 33+50.00	LT & RT	270.0	5.0	150.0	0.03	2.8	2.8	2.8	0.03	150.0
STA. 33+50.00	TO	STA. 38+00.00		295.0	5.0	163.9	0.03	3.0	3.0	3.0	0.03	163.9
CEDAR STREET												
STA. 60+00.00	TO	STA. 63+70.00	LT	330.0	5.0	183.3	0.04	3.4	3.4	3.4	0.04	183.3
STA. 60+00.00	TO	STA. 68+00.00	LT & RT	320.0	5.0	177.8	0.04	3.3	3.3	3.3	0.04	177.8
CHESTNUT STREET												
STA. 80+00.00	TO	STA. 83+70.00	LT & RT	310.0	5.0	172.2	0.04	3.2	3.2	3.2	0.04	172.2
STA. 83+70.00	TO	STA. 88+00.00		300.0	5.0	166.7	0.03	3.1	3.1	3.1	0.03	166.7
SUBTOTAL				3,933.00	55.00	2,185.00	0.45	40.63	40.63	40.63	0.45	2,185.00
TOTAL				3,933.0	55.0	2,185.0	0.5	41	41	41	0.5	2,185

K:\PROJECTS\89645\1\Task_028 - Misc Engineering\325 Safe Routes to School - 2012\CAD\SP\EDULES.dwg

FILE NAME	USER NAME - JDOT	DESIGNED - KMC	REVISED -	STATE OF ILLINOIS DEPARTMENT OF TRANSPORTATION	SCHEDULE OF QUANTITIES SAFE ROUTES TO SCHOOL				F.A. RTE.	SECTION	COUNTY	TOTAL SHEETS	SHEET NO.
FILE #		DRAWN - CAM	REVISED -		SCALE:	SHEET NO.	OF	SHEETS	STA.	TO STA.	PEORIA	20	5
		CHECKED - REW	REVISED -		CONTRACT NO. 89645								
		DATE - 6-18-13	REVISED -		ILLINOIS FED. AID PROJECT								

POINT # OR STATION	NORTHING	EASTING	MONUMENT DESCRIPTION	ELEVATION
CP #1	5000.00	10000.00	PK NAIL	520.00
CP #2	5059.47	9662.76	PK NAIL	522.07
CP #3	5119.35	9314.60	PK NAIL	524.59
CP #4	5191.39	9036.19	PK NAIL	526.44
CP #5	5216.76	8651.97	CROSS IN CONC	528.37
CP #6	5605.82	8575.37	CROSS IN CONC	528.07
CP #7	5683.85	8165.03	PK NAIL	526.33
CP #8	5758.69	7808.25	PK NAIL	525.78
CP #9	5818.24	7522.63	PK NAIL	523.96
CP #10	5693.27	7281.28	PK NAIL	520.97
CP #11	6096.64	7888.89	PK NAIL	522.65
CP #12	6462.76	7924.41	PK NAIL	519.43
CP #13	6032.62	8254.66	PK NAIL	522.77
CP #14	6398.22	8284.18	PK NAIL	522.50
CP #15	5438.32	9380.25	PK NAIL	525.10
CP #16	5822.00	9449.07	PK NAIL	521.88
10+00	4960.09	10286.27	PK NAIL	
26+00	5238.13	8710.62	PK NAIL	
30+00	5130.75	9313.80	PK NAIL	
37+00	5819.90	9436.55	PK NAIL	
40+00	5619.53	8640.67	PK NAIL	
50+31.47	5802.31	7625.52	PK NAIL	
50+95.97	5799.11	7561.66	PK NAIL	
54+00	5715.76	7269.28	PK NAIL	
60+00	5702.51	8179.68	PK NAIL	
67+19.52	6411.76	8300.76	PK NAIL	
70+00	6678.75	8214.81	PK NAIL	
80+00	5768.26	7815.07	PK NAIL	
87+37.17	6494.29	7942.62	PK NAIL	
88+21.03	6507.73	7859.85	PK NAIL	

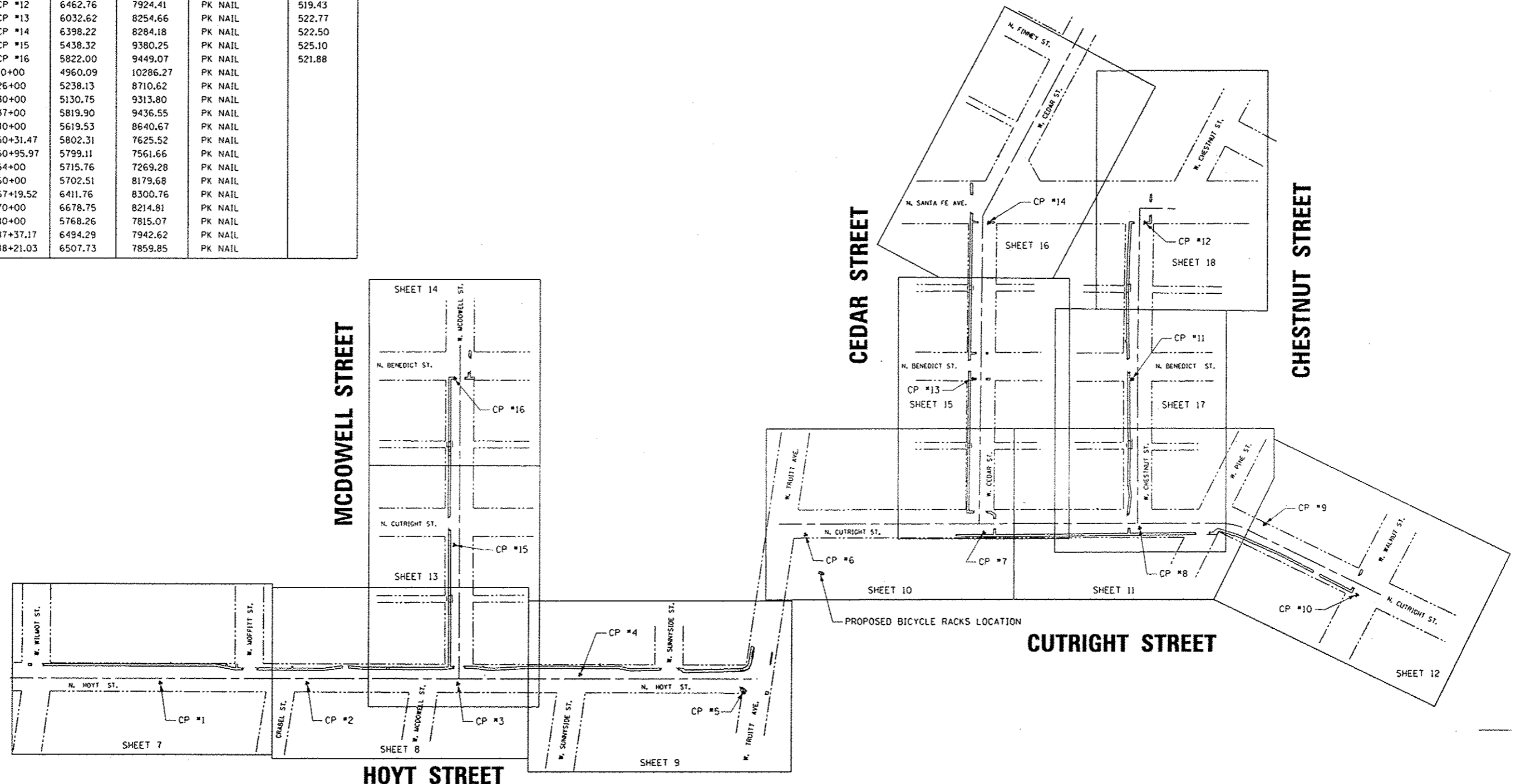
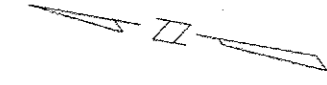

FILE NAME: #FIL#	USER NAME: IDOT	DESIGNED: KMC	REVISED: -	STATE OF ILLINOIS DEPARTMENT OF TRANSPORTATION	SHEET INDEX, LINE DIAGRAM, COORDINATES AND BENCHMARKS				F.A. RTE.	SECTION	COUNTY	TOTAL SHEETS	SHEET NO.
	PLOT SCALE: NOT TO SCALE	DRAWN: CAM	REVISED: -		SCALE: N.T.S.	SHEET NO.	OF	SHEETS	STA.	TO STA.	12-00037-00-SW	20	6
	PLOT DATE: 7/9/2013	CHECKED: REW	REVISED: -								PEORIA		
		DATE: 6-18-13	REVISED: -								CONTRACT NO. 89645		
										ILLINOIS FED. AID PROJECT			

NOTES:

1. ALL SIDEWALKS SHALL BE CONSTRUCTED WITH 1.5% CROSS SLOPE, OR FLATTER.
2. HOYT STREET ADT = 275 VPD.
3. SEE SHEET 20 FOR DETECTABLE WARNING TYPES.

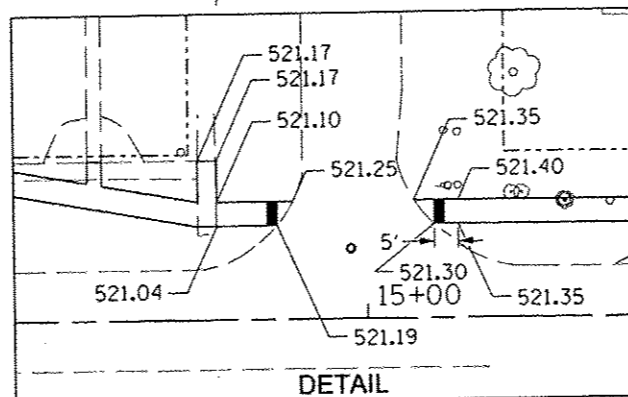
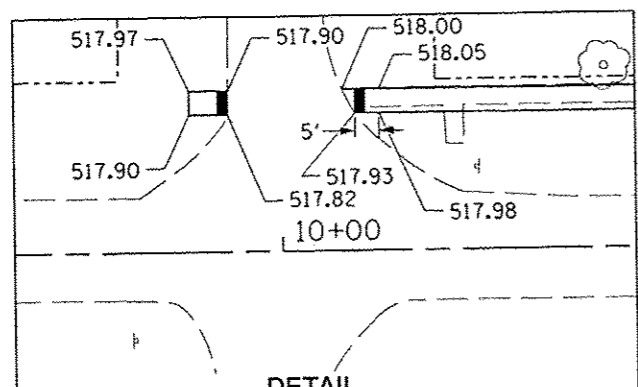
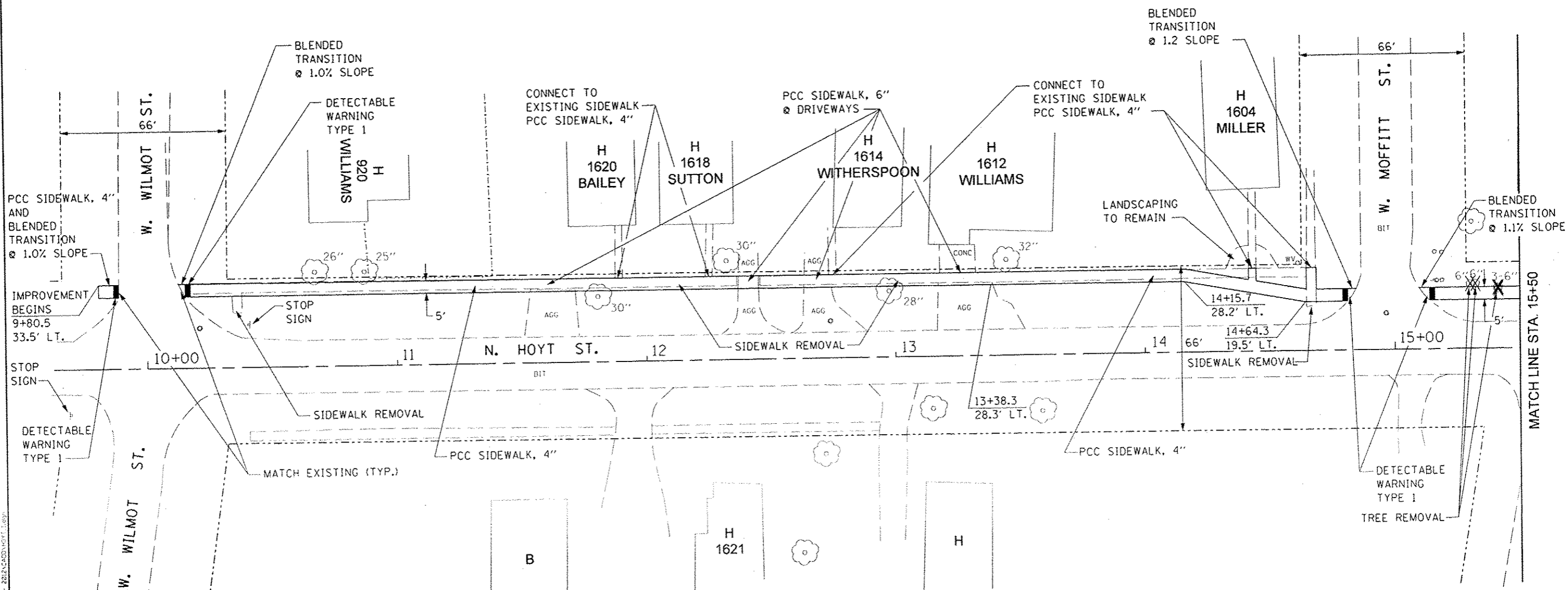

EXISTING LEGEND

- DECIDUOUS TREE
- EVERGREEN TREE
- BUSH
- FENCE
- FIRE HYDRANT
- UTILITY POLE WITH GUY WIRE
- SIGN
- CB CATCH BASIN
- MANHOLE
- WV WATER VALVE
- WM WATER METER
- CULVERT
- RIGHT OF WAY



FILE NAME:
 USER NAME: IDOT

DESIGNED - KMC
 DRAWN - CAM
 CHECKED - REW
 DATE - 6-18-13

REVISED -
 REVISED -
 REVISED -
 REVISED -

STATE OF ILLINOIS
 DEPARTMENT OF TRANSPORTATION

CHILlicothe - HOYT STREET
 SAFE ROUTES TO SCHOOL
 SCALE: SHEET NO. OF SHEETS STA. 10+00 TO STA. 15+50

F.A. RTE.	SECTION	COUNTY	TOTAL SHEETS	SHEET NO.
	12-00037-00-SW	PEORIA	20	7
CONTRACT NO. 89645			ILLINOIS FED. AID PROJECT	

X:\PROJECTS\2012\Safe Routes to School - 2012\CAD\HOYT.1.dwg

K:\PROJECTS\6015155\Task 100 - Misc Engineering\435 Safe Routes to School - 2012\6015155.dwg, 2:45:00

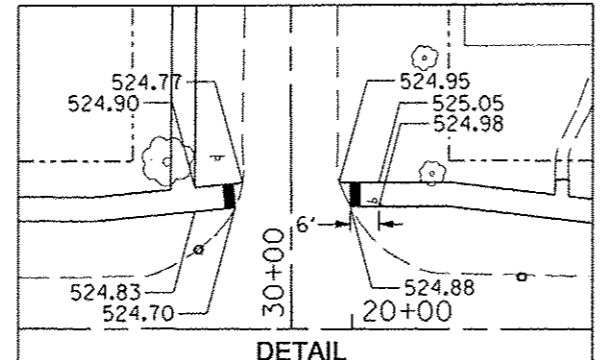
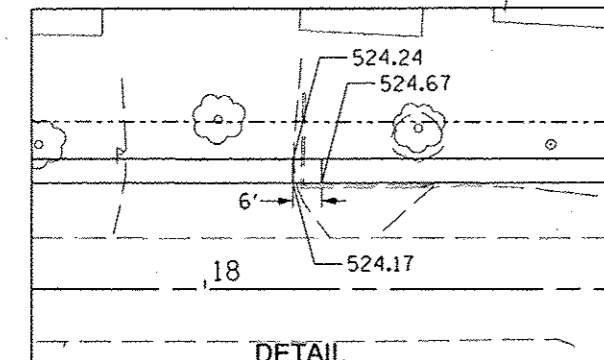
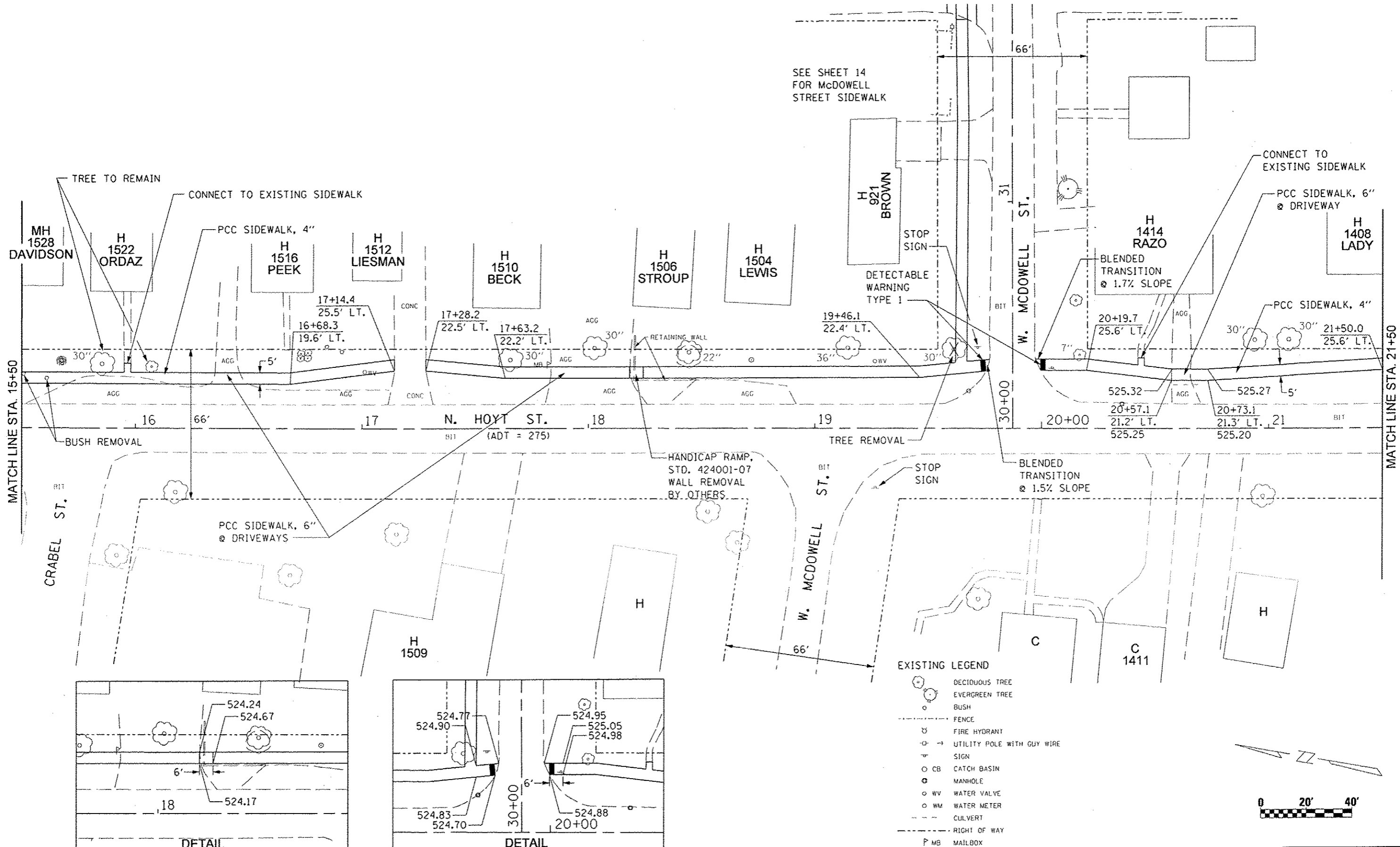

FILE NAME :	USER NAME : IDDT	DESIGNED - KMC	REVISED -
#FILE :		DRAWN - CAM	REVISED -
	PLOT SCALE = 48.0000' / IN.	CHECKED - REW	REVISED -
	PLOT DATE = 7/9/2013	DATE = 6-18-13	REVISED -

**STATE OF ILLINOIS
DEPARTMENT OF TRANSPORTATION**

**CHILICOTHE - HOYT STREET
SAFE ROUTES TO SCHOOL**

SCALE: SHEET NO. OF SHEETS STA. 15+50 TO STA. 21+50

F.A. RTE.	SECTION	COUNTY	TOTAL SHEETS	SHEET NO.
	12-00037-00-SW	PEORIA	20	8
CONTRACT NO. 89645			ILLINOIS FED. AID PROJECT	

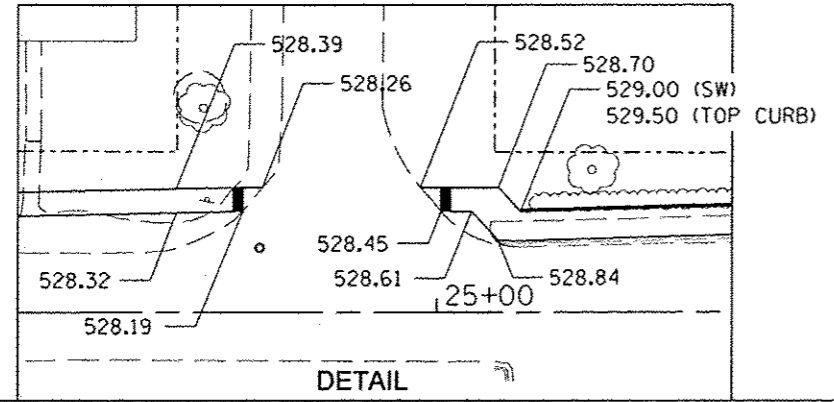
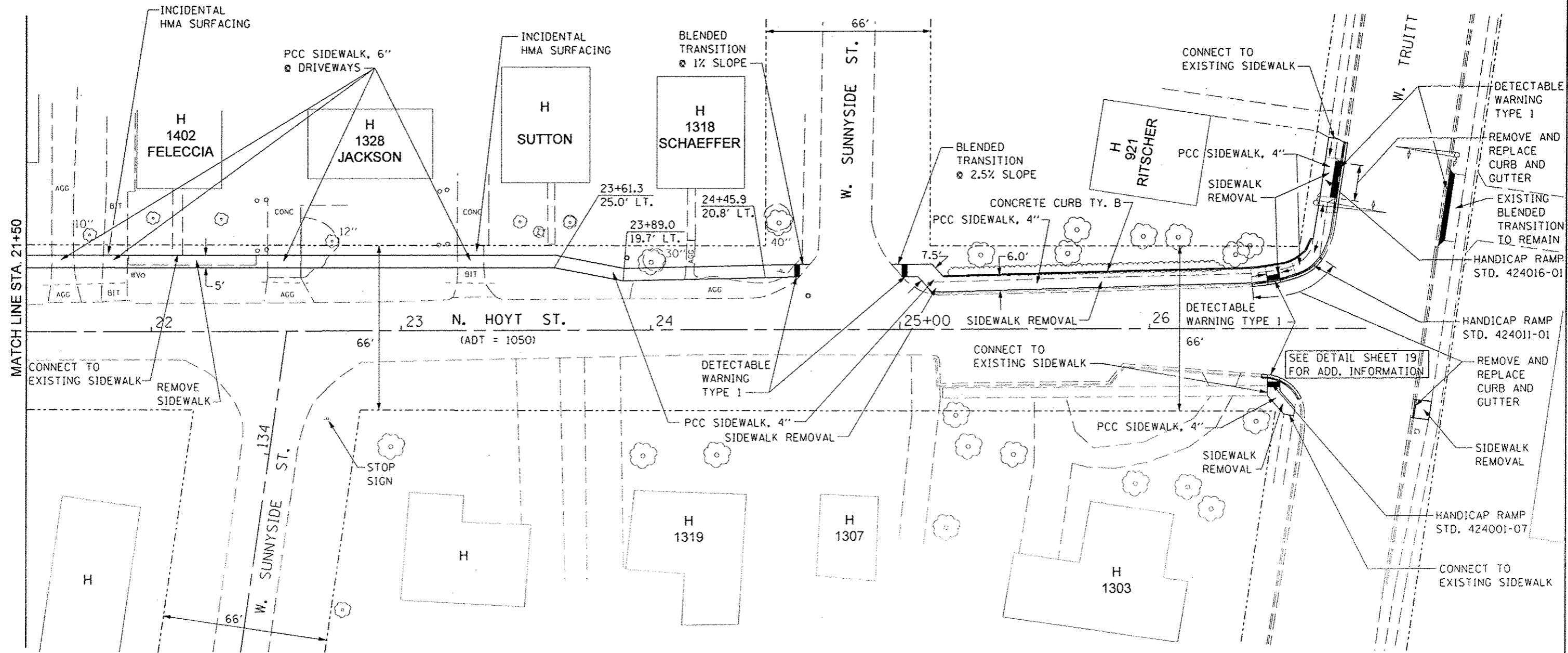

- EXISTING LEGEND**
- DECIDUOUS TREE
 - EVERGREEN TREE
 - BUSH
 - FENCE
 - FIRE HYDRANT
 - UTILITY POLE WITH GUY WIRE
 - SIGN
 - CB CATCH BASIN
 - MANHOLE
 - WV WATER VALVE
 - WM WATER METER
 - CULVERT
 - RIGHT OF WAY

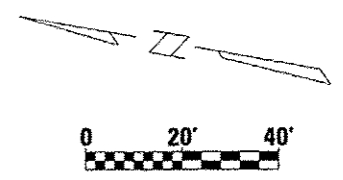

FILE NAME: #FIL4	USER NAME: IODT	DESIGNED: KMC	REVISED: -	STATE OF ILLINOIS DEPARTMENT OF TRANSPORTATION	CHILLICOTHE -- HOYT STREET SAFE ROUTES TO SCHOOL	F.A. RTE.	SECTION	COUNTY	TOTAL SHEETS	SHEET NO.		
		DRAWN: CAM	REVISED: -					12-00037-00-SW	PEORIA	20	9	
		CHECKED: REW	REVISED: -			CONTRACT NO. 89645						
		DATE: 6-18-13	REVISED: -			ILLINOIS FED. AID PROJECT						
				SCALE: SHEET NO. OF SHEETS STA. 21+50 TO STA. 26+00								

K:\PROJECTS\89645\SSV\Task 128 - Misc. Engineering\USF Safe Routes to School - 2012\CAD\Drawings\Drawings

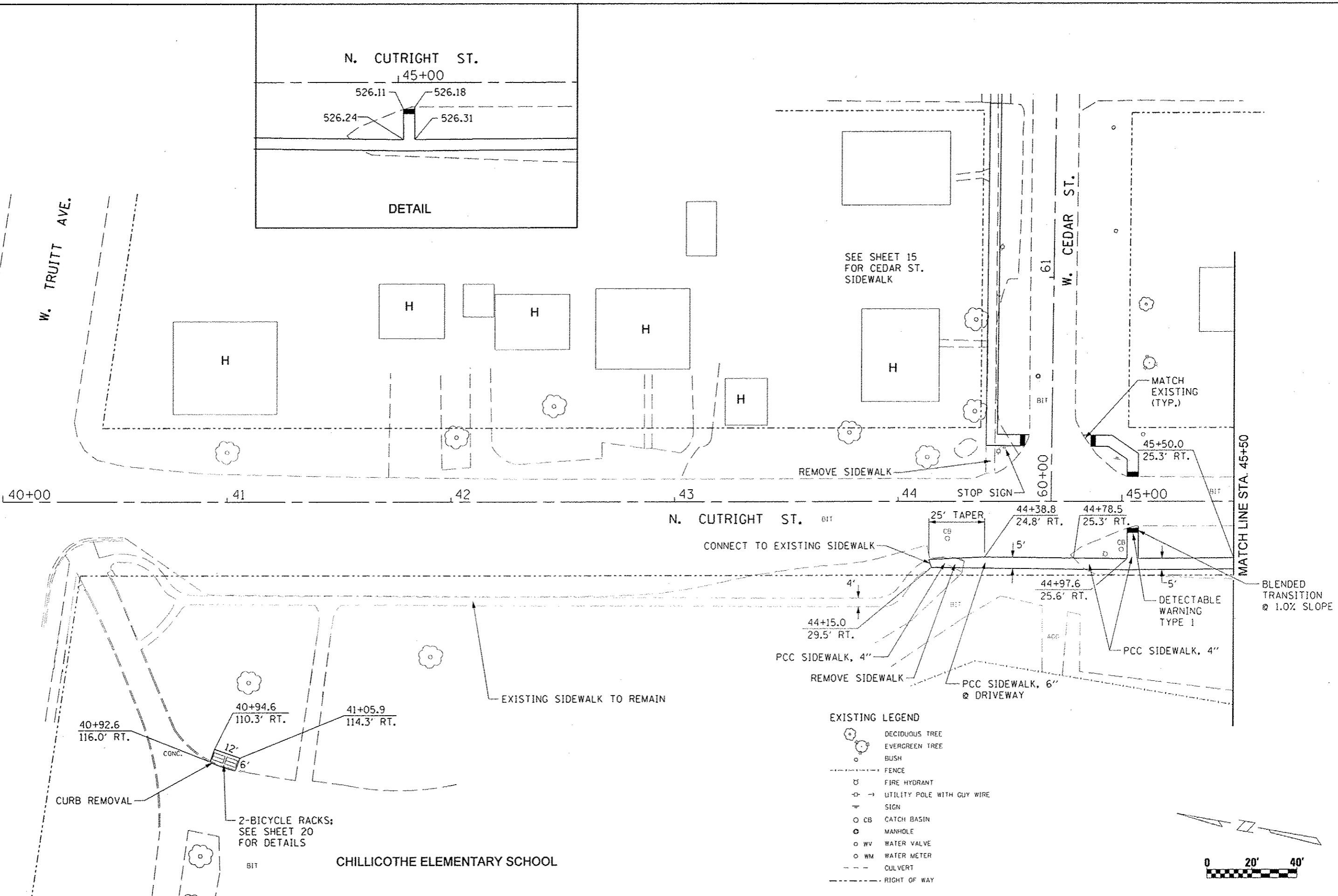

K:\PROJECTS\88294155\Task 102 - Misc Engineering\103 Safe Routes to School - 2012\CADD\Cutright.dwg

FILE NAME	USER NAME	DESIGNED	REVISED
88294155	1001	KMC	-
		DRAWN	REVISED
		CAM	-
		CHECKED	REVISED
		REW	-
		DATE	REVISED
		6-18-13	-

**STATE OF ILLINOIS
DEPARTMENT OF TRANSPORTATION**

**CHILICOTHE - CUTRIGHT STREET
SAFE ROUTES TO SCHOOL**

F.A. RTE.	SECTION	COUNTY	TOTAL SHEETS	SHEET NO.
	12-00037-00-5W	PEORIA	20	10
CONTRACT NO. 89645				
ILLINOIS FED. AID PROJECT				

SCALE: SHEET NO. OF SHEETS STA. 40+00 TO STA. 45+50

SEE SHEET 17
FOR CHESTNUT ST.
SIDEWALK

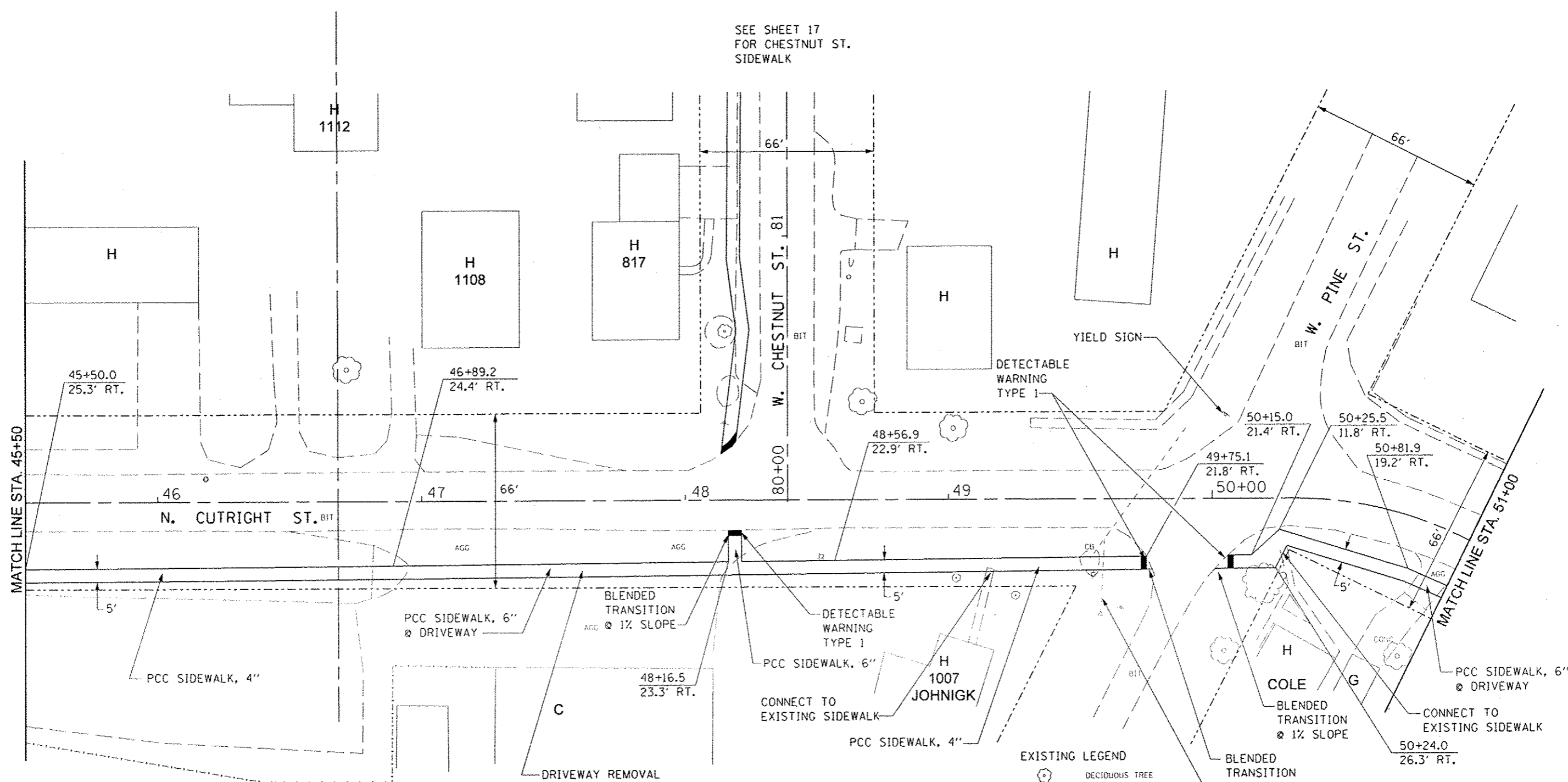

EXISTING LEGEND

- DECIDUOUS TREE
- EVERGREEN TREE
- BUSH
- FENCE
- FIRE HYDRANT
- UTILITY POLE WITH GUY WIRE
- SIGN
- CATCH BASIN
- MANHOLE
- WATER VALVE
- WATER METER
- CULVERT
- RIGHT OF WAY

CULVERT TO BE
RELOCATED BY
OTHERS

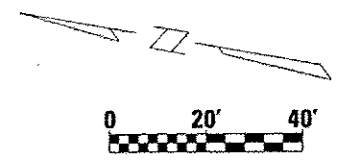
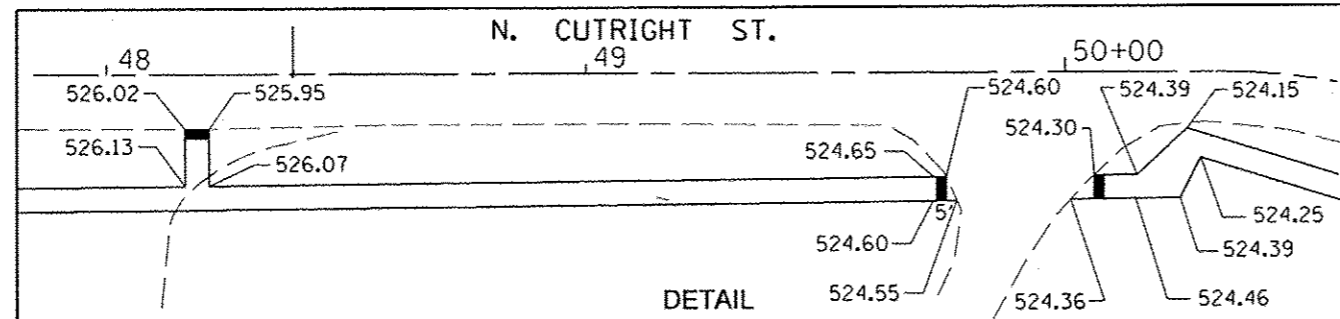

FILE NAME : #FIL 6	USER NAME : IDOT	DESIGNED - KMC	REVISED -	STATE OF ILLINOIS DEPARTMENT OF TRANSPORTATION	CHILICOTHE - CUTRIGHT STREET SAFE ROUTES TO SCHOOL			F.A. RTE.	SECTION	COUNTY	TOTAL SHEETS	SHEET NO.	
		DRAWN - CAM	REVISED -		SCALE:	SHEET NO.	OF	SHEETS	STA. 45+50 TO STA. 51+00	12-00037-00-SW	PEORIA	20	11
		PLT SCALE = 1/8" = 10'-0"	CHECKED - REW		REVISED -								
		PLT DATE = 7/9/2013	DATE - 6-18-13		REVISED -								CONTRACT NO. 89645
ILLINOIS FED. AID PROJECT													

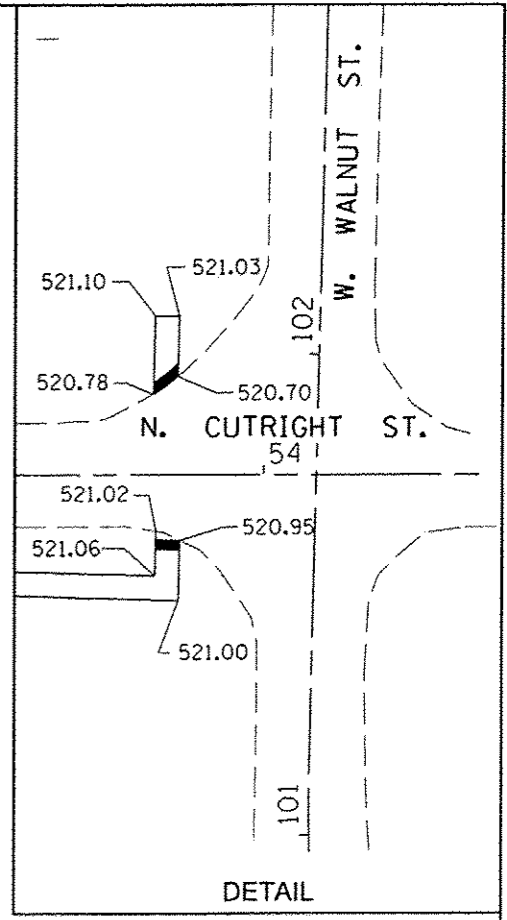
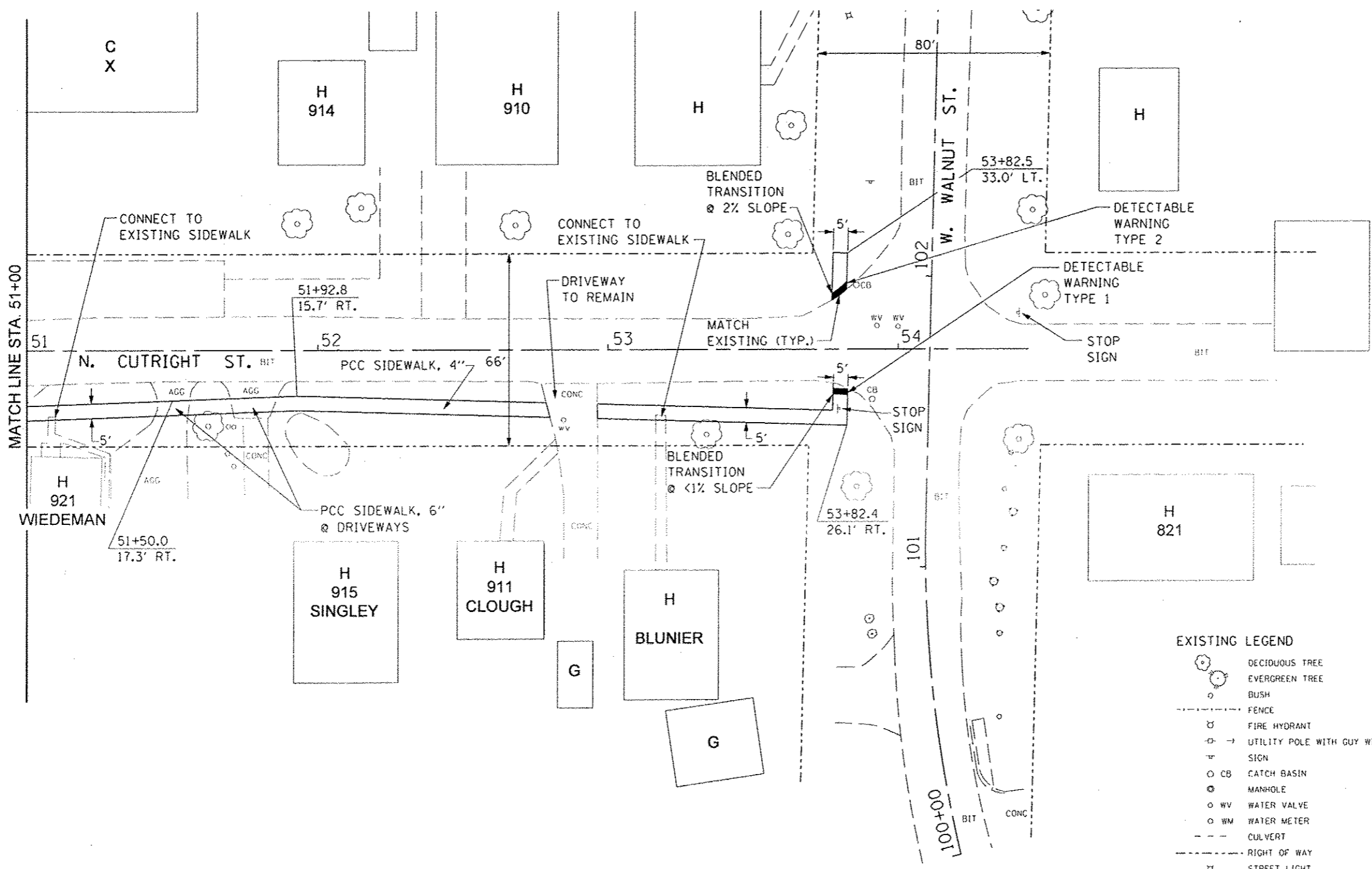

- EXISTING LEGEND**
- DECIDUOUS TREE
 - EVERGREEN TREE
 - BUSH
 - FENCE
 - FIRE HYDRANT
 - UTILITY POLE WITH GUY WIRE
 - SIGN
 - CB CATCH BASIN
 - MANHOLE
 - WV WATER VALVE
 - WM WATER METER
 - CULVERT
 - RIGHT OF WAY
 - STREET LIGHT

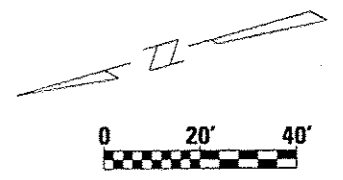

FILE NAME : \$FILE#	USER NAME : IDDT	DESIGNED : KMC	REVISED : KMC	STATE OF ILLINOIS DEPARTMENT OF TRANSPORTATION	CHILICOTHE - CUTRIGHT STREET SAFE ROUTES TO SCHOOL	F.A. RTE.	SECTION	COUNTY	TOTAL SHEETS	SHEET NO.
	PLOT SCALE : 48,0000' / IN.	CHECKED : REW	REVISED : CAM			12-00037-00-SW	PEORIA	20	12	
	PLOT DATE : 7/9/2013	DATE : 6-18-13	REVISED : REW			CONTRACT NO. 89645		ILLINOIS FED. AID PROJECT		
					SCALE:	SHEET NO. OF SHEETS		STA. 51+00 TO STA. 54+50		

K:\PROJECTS\88054\551\Task 128 - Miss. Engineering\05 Safe Route to School - 2012\ACBD\CU\FRSH\3.dwg

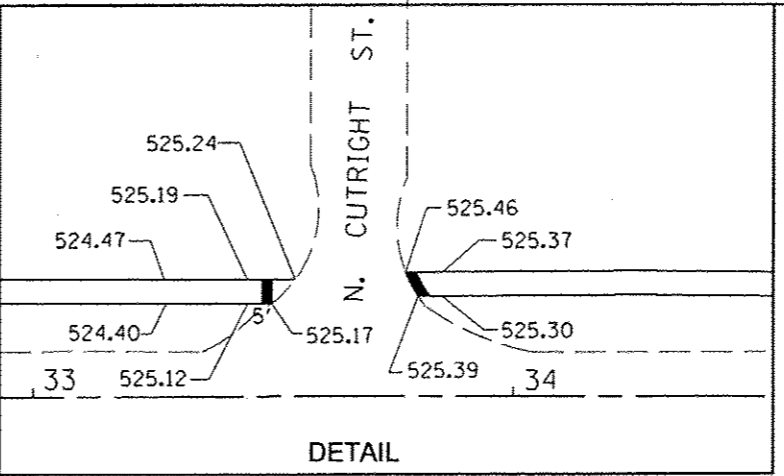
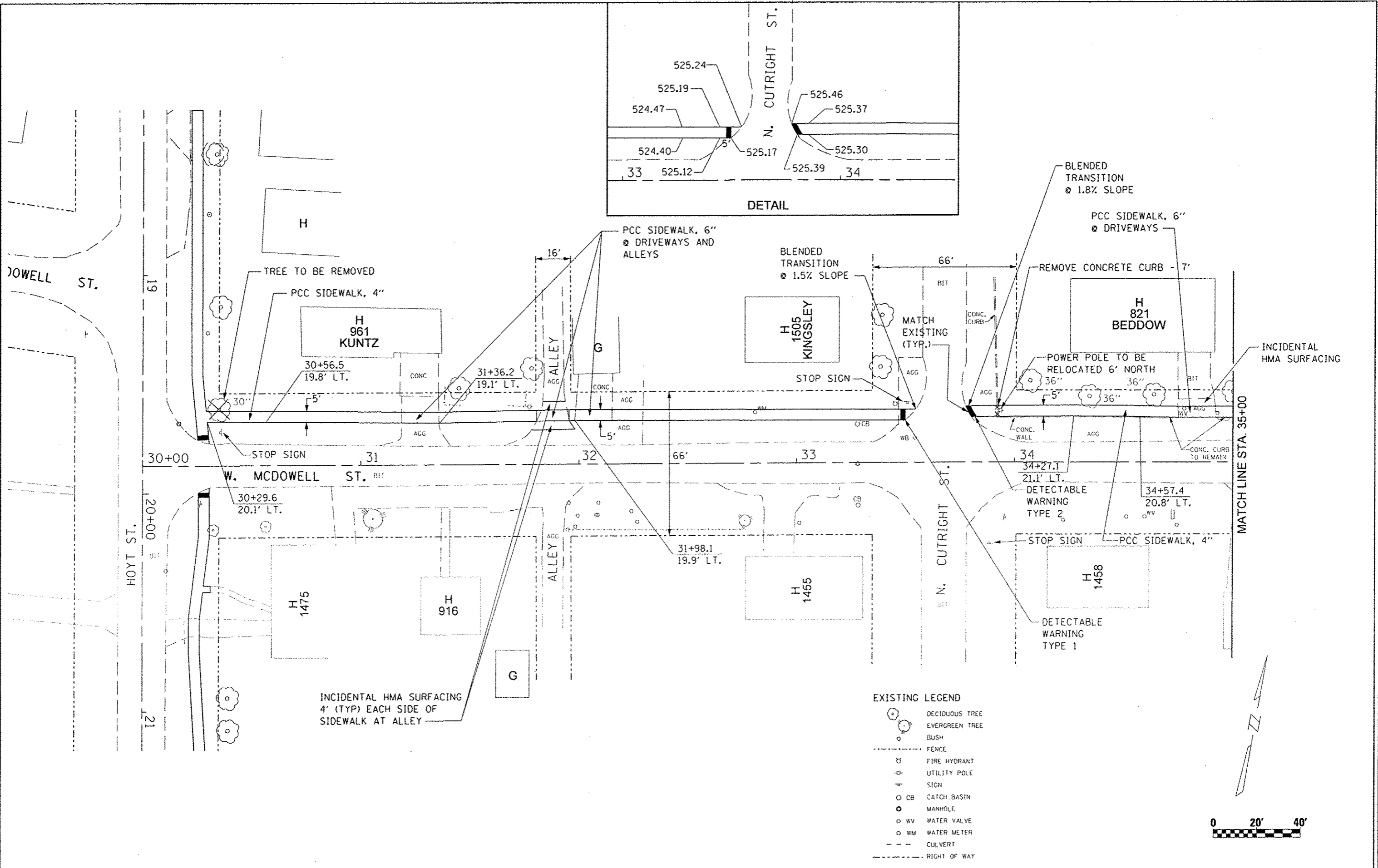

- EXISTING LEGEND**
- DECIDUOUS TREE
 - EVERGREEN TREE
 - BUSH
 - FENCE
 - FIRE HYDRANT
 - UTILITY POLE
 - SIGN
 - CB CATCH BASIN
 - MANHOLE
 - WV WATER VALVE
 - WM WATER METER
 - CULVERT
 - RIGHT OF WAY



FILE NAME :	USER NAME : IDOT	DESIGNED - KMC	REVISED -	STATE OF ILLINOIS DEPARTMENT OF TRANSPORTATION	CHILlicothe - McDOWELL STREET SAFE ROUTES TO SCHOOL			F.A. RTE.	SECTION	COUNTY	TOTAL SHEETS	SHEET NO.
FILE #		DRAWN - CAM	REVISED -		SCALE: SHEET NO. OF SHEETS STA. 30+00 TO STA. 35+00			12-00037-00-SW	PEORIA	20	13	
		CHECKED - REW	REVISED -					CONTRACT NO. 89645				
		DATE - 6-18-13	REVISED -					ILLINOIS FED. AID PROJECT				

K:\PROJECTS\BID\ISS\Task_100 - Mac Engineering\125 Safe Routes to School - 22121000\MCOWELL.dwg

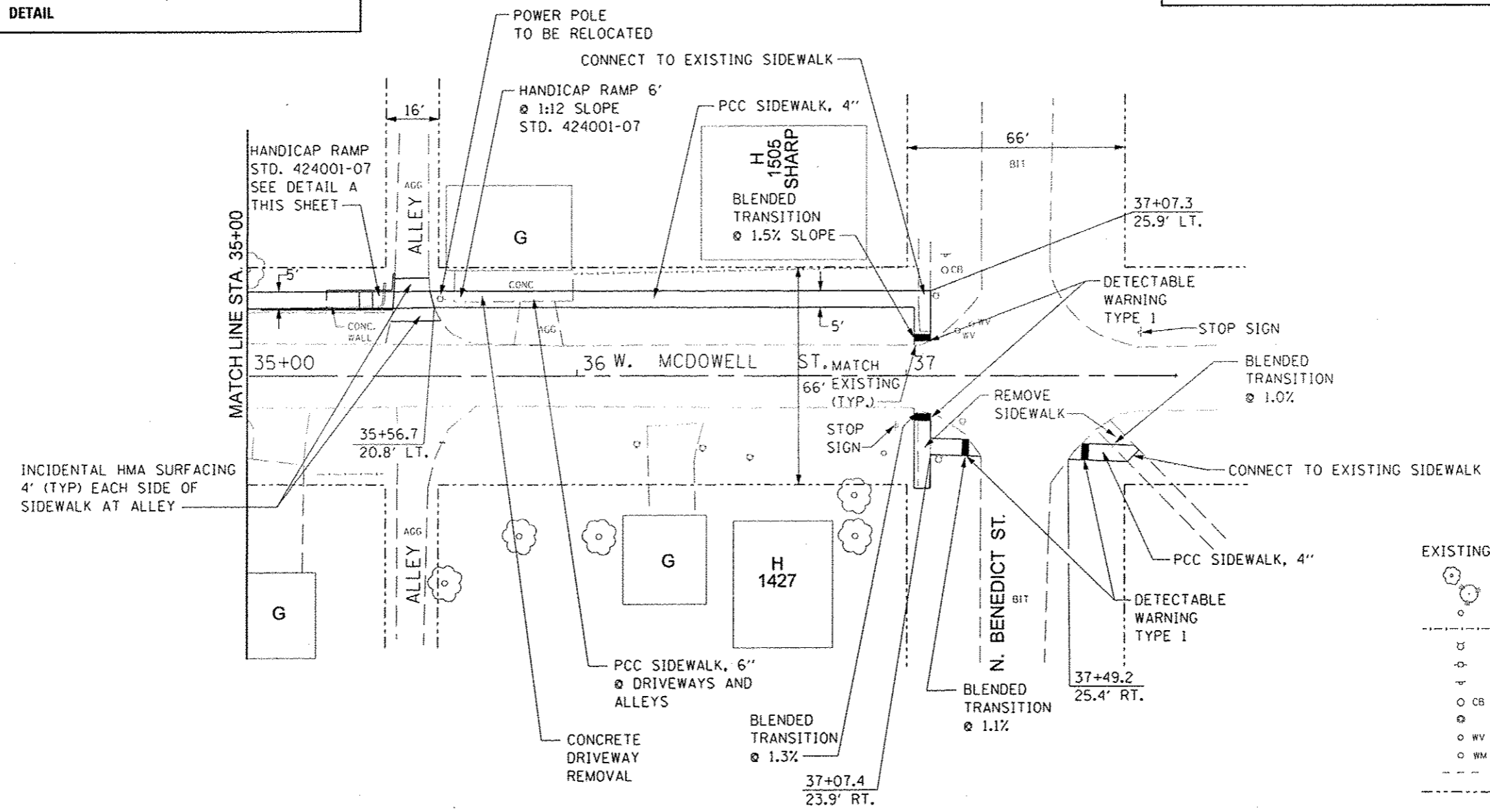
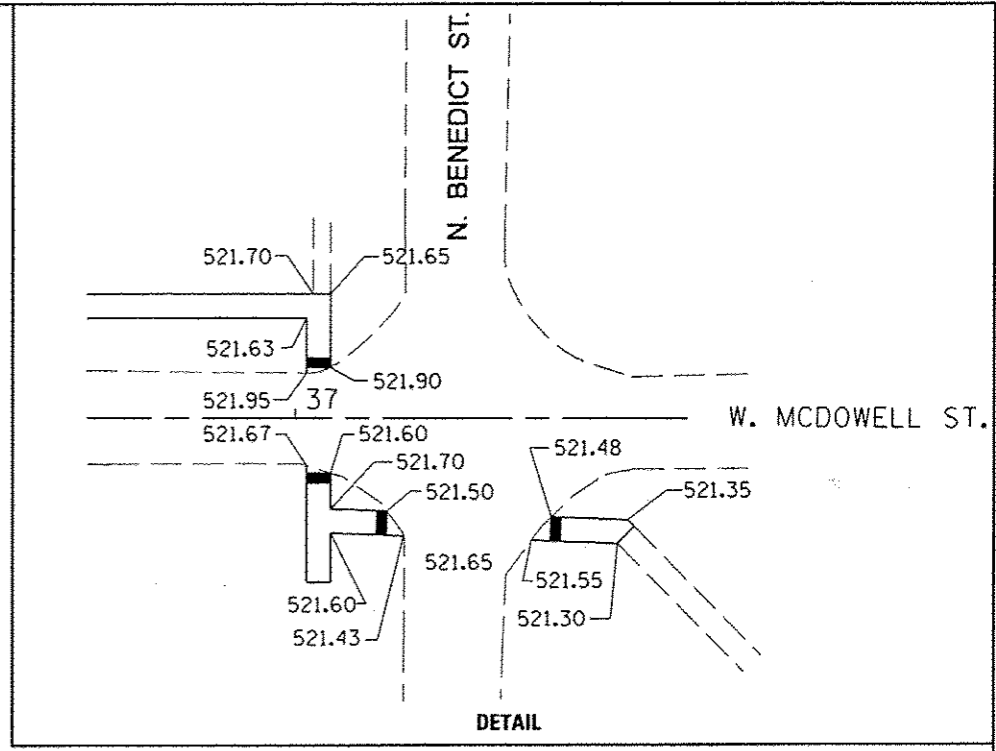
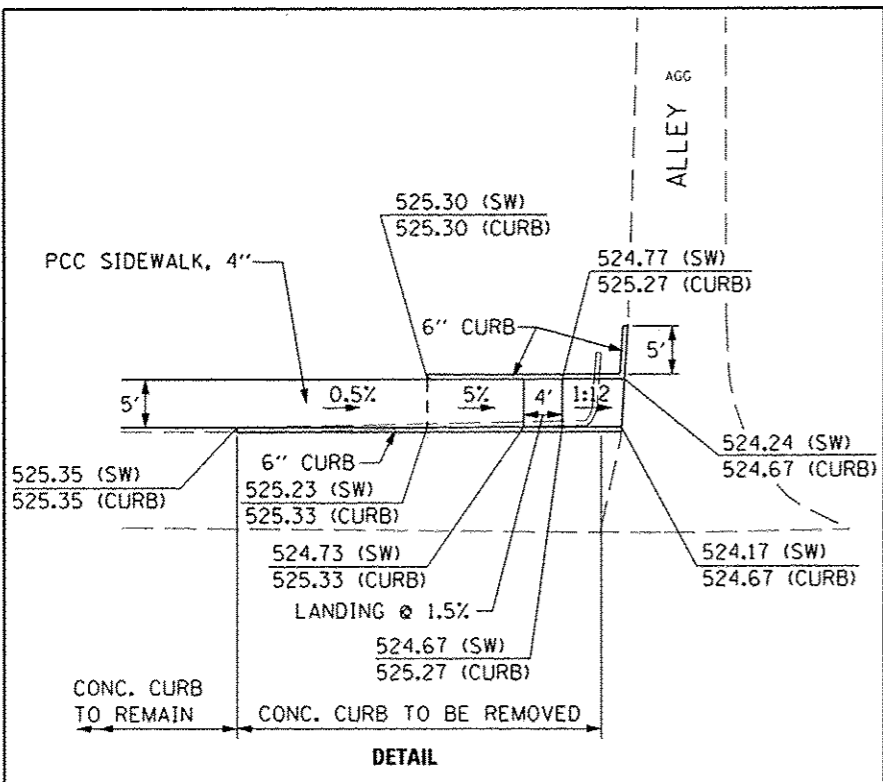

- EXISTING LEGEND**
- DECIDUOUS TREE
 - EVERGREEN TREE
 - BUSH
 - FENCE
 - FIRE HYDRANT
 - UTILITY POLE
 - SIGN
 - CATCH BASIN
 - MANHOLE
 - WATER VALVE
 - WATER METER
 - CULVERT
 - RIGHT OF WAY

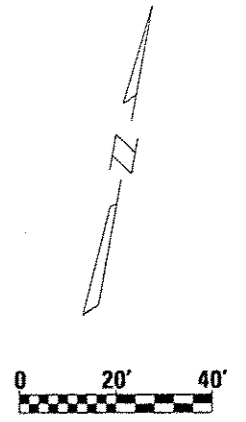

FILE NAME :	USER NAME : JDOT	DESIGNED : KMC	REVISED :
FILE # :		DRAWN : CAM	REVISED :
		CHECKED : REW	REVISED :
		DATE : 6-18-13	REVISED :

**STATE OF ILLINOIS
DEPARTMENT OF TRANSPORTATION**

**CHILlicothe - McDOWELL STREET
SAFE ROUTES TO SCHOOL**

SCALE: SHEET NO. OF SHEETS STA. 35+00 TO STA. 37+50

F.A. RTE.	SECTION	COUNTY	TOTAL SHEETS	SHEET NO.
	12-00037-00-SW	PEORIA	20	14
CONTRACT NO. 89645				
ILLINOIS FED. AID PROJECT				

C:\PROJECTS\GIS\155\Task 120 - Misc Engineering\135 Safe Route to School - 2212\CDOT\McDOWELL.DWG

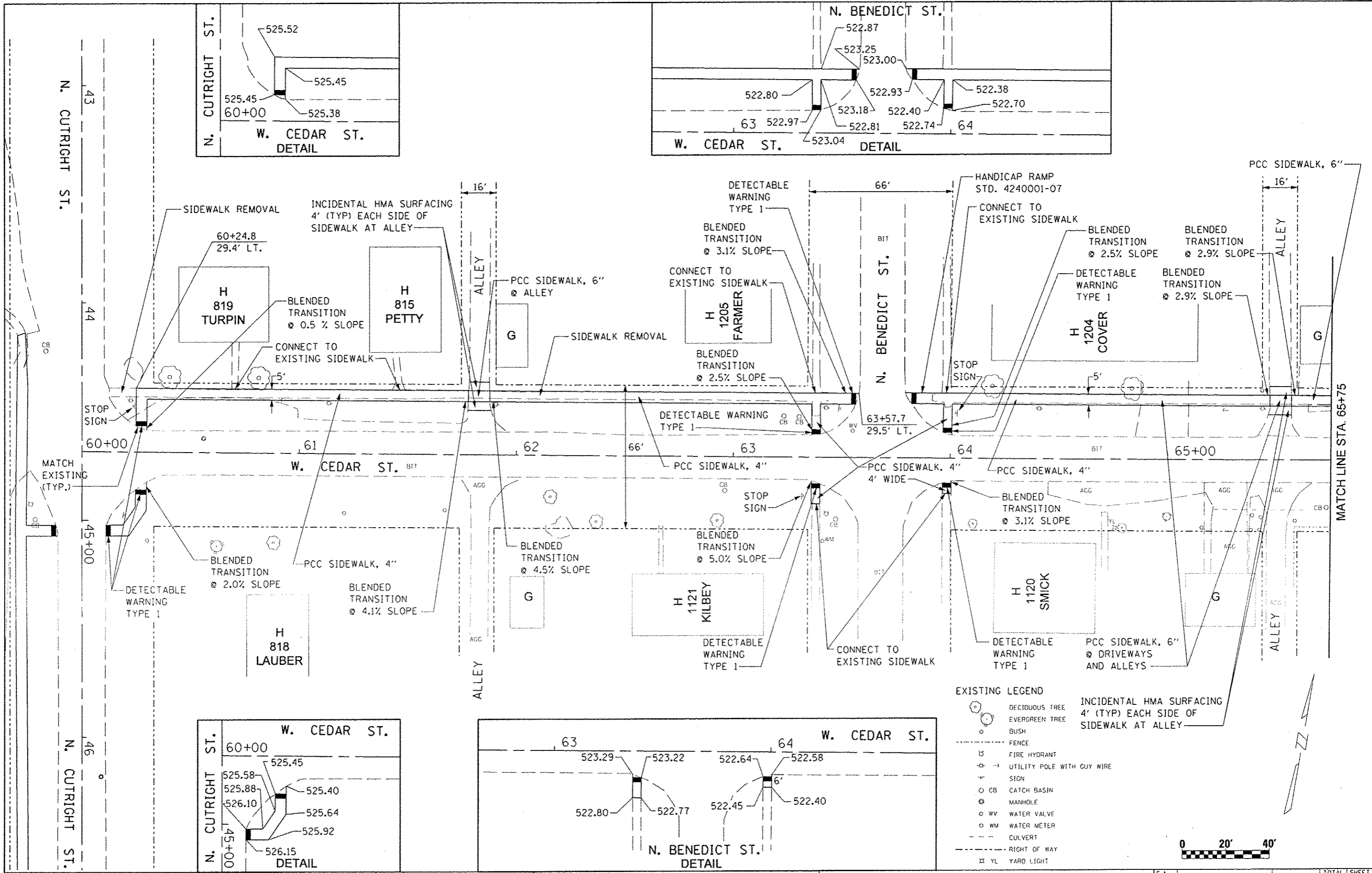
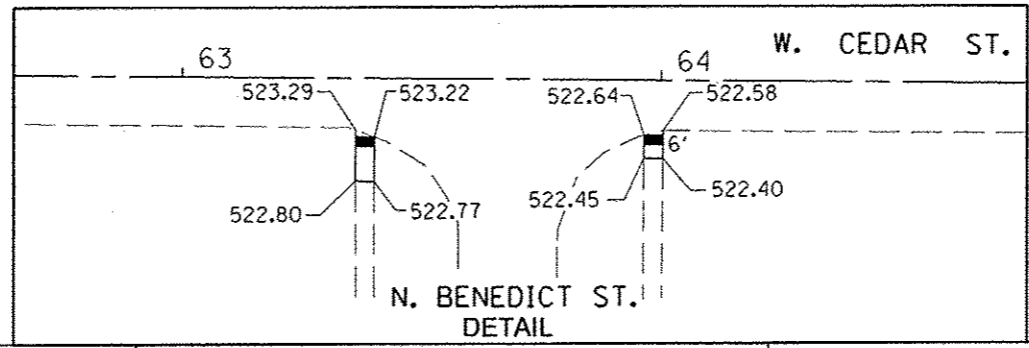
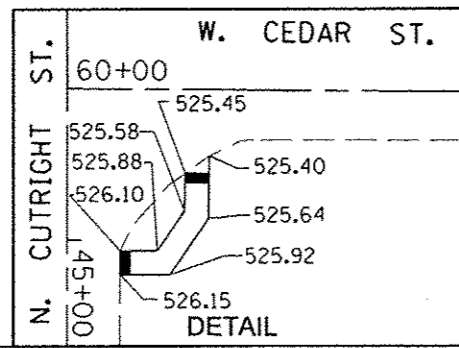
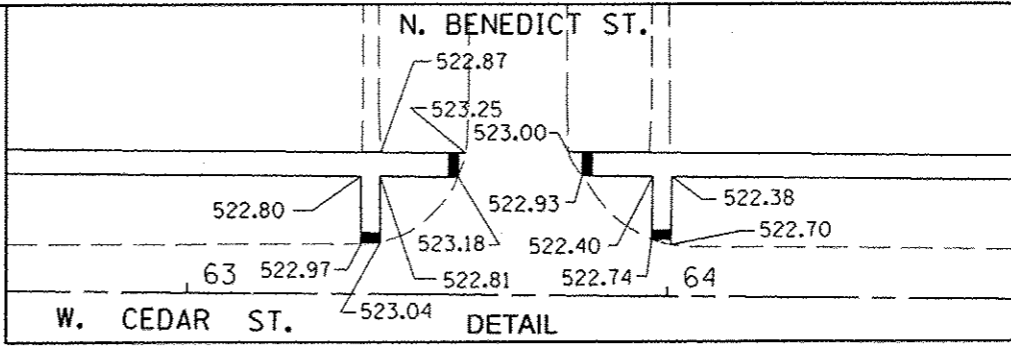
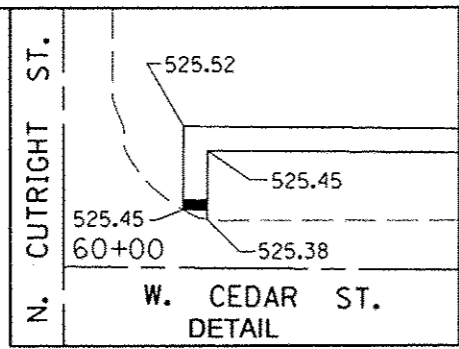

EXISTING LEGEND

- DECIDUOUS TREE
- EVERGREEN TREE
- BUSH
- FENCE
- FIRE HYDRANT
- UTILITY POLE WITH GUY WIRE
- SIGN
- CB CATCH BASIN
- MANHOLE
- WV WATER VALVE
- WM WATER METER
- CULVERT
- RIGHT OF WAY
- YL YARD LIGHT

INCIDENTAL HMA SURFACING
4' (TYP) EACH SIDE OF
SIDEWALK AT ALLEY

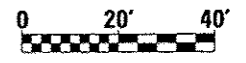

FILE NAME
#FILE#

USER NAME : #USER#
PLOT SCALE : #SCALE#
PLOT DATE : #DATE#

DESIGNED - KMC
DRAWN - CAM
CHECKED - REW
DATE - 6-18-13

REVISED -
REVISED -
REVISED -
REVISED -

**STATE OF ILLINOIS
DEPARTMENT OF TRANSPORTATION**

**CHILICOTHE - CEDAR STREET
SAFE ROUTES TO SCHOOL**

SCALE: SHEET NO. OF SHEETS STA. 60+00 TO STA. 65+75

F.A. RTE.	SECTION	COUNTY	TOTAL SHEETS	SHEET NO.
	12-00037-00-SW	PEORIA	20	15
			CONTRACT NO. 89645	
ILLINOIS FED. AID PROJECT				

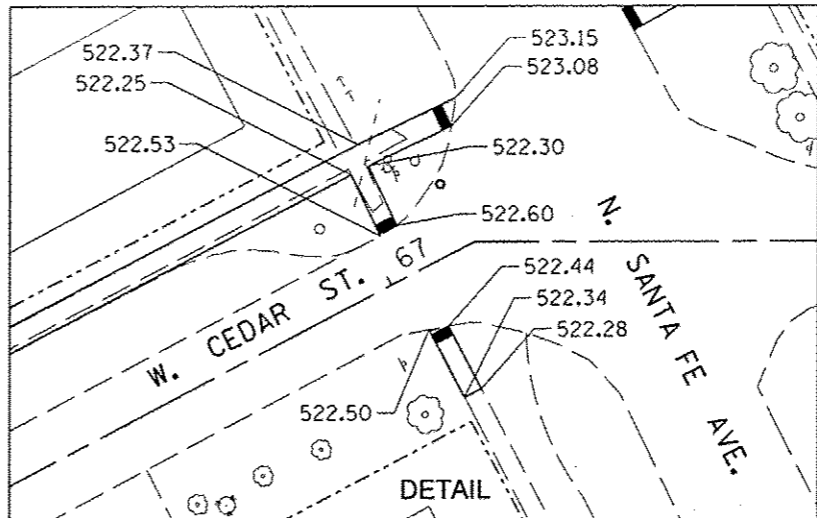
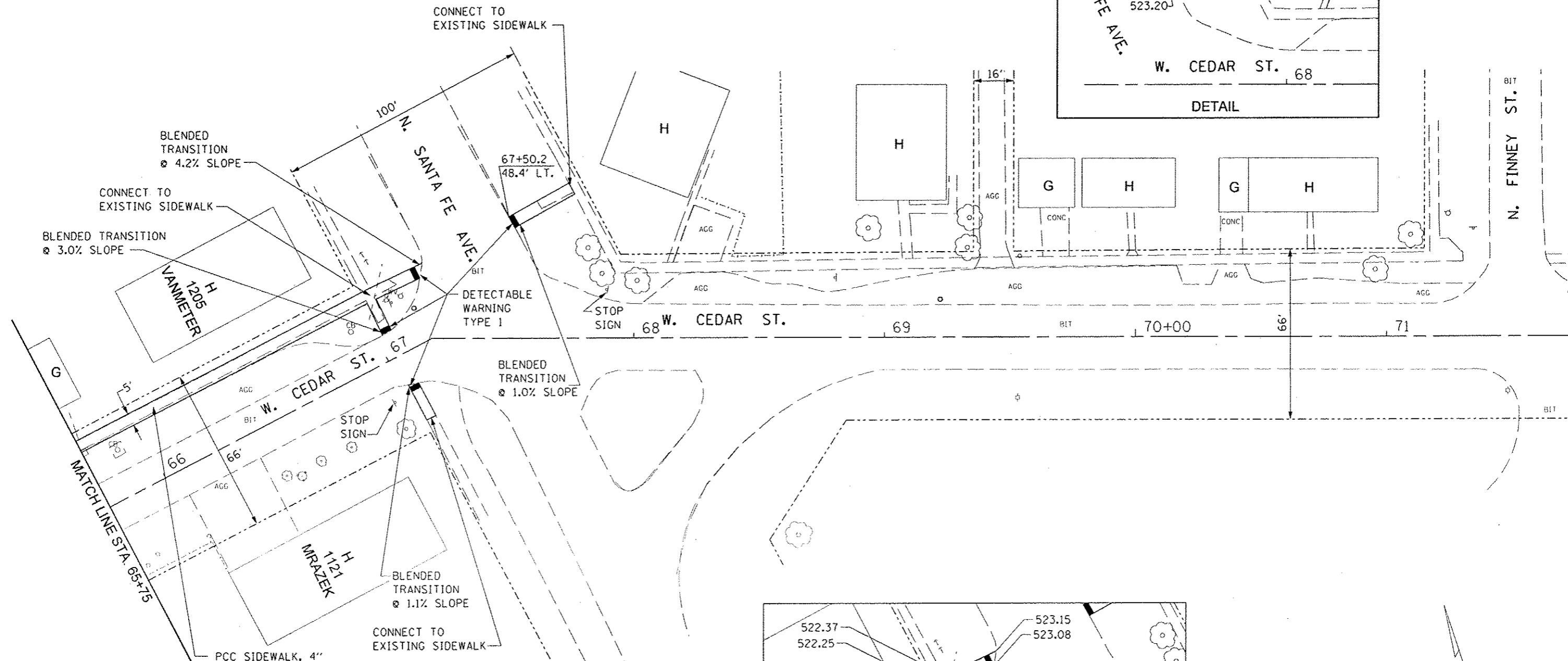
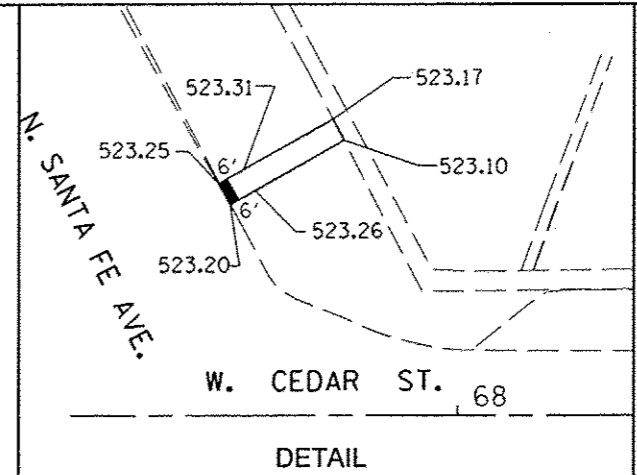

EXISTING LEGEND

- DECIDUOUS TREE
- EVERGREEN TREE
- BUSH
- FENCE
- FIRE HYDRANT
- UTILITY POLE WITH GUY WIRE
- SIGN
- CB CATCH BASIN
- MANHOLE
- WV WATER VALVE
- WM WATER METER
- CULVERT
- RIGHT OF WAY

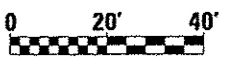

FILE NAME :	USER NAME : *USER#	DESIGNED - KMC	REVISED -
#FILE#		DRAWN - CAM	REVISED -
	PLOT SCALE = #SCALE#	CHECKED - REW	REVISED -
	PLOT DATE = #DATE#	DATE - 6-18-13	REVISED -

**STATE OF ILLINOIS
DEPARTMENT OF TRANSPORTATION**

**CHILLICOTHE - CEDAR STREET
SAFE ROUTES TO SCHOOL**

SCALE: SHEET NO. OF SHEETS STA. 65+75 TO STA. 71+50

F.A. RTE.	SECTION	COUNTY	TOTAL SHEETS	SHEET NO.
	12-00037-00-SW	PEORIA	20	16
CONTRACT NO. 89645				
ILLINOIS FED. AID PROJECT				

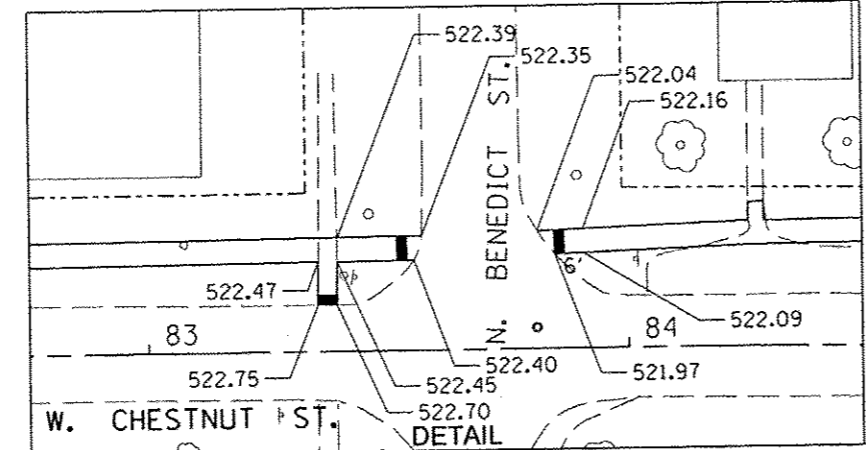
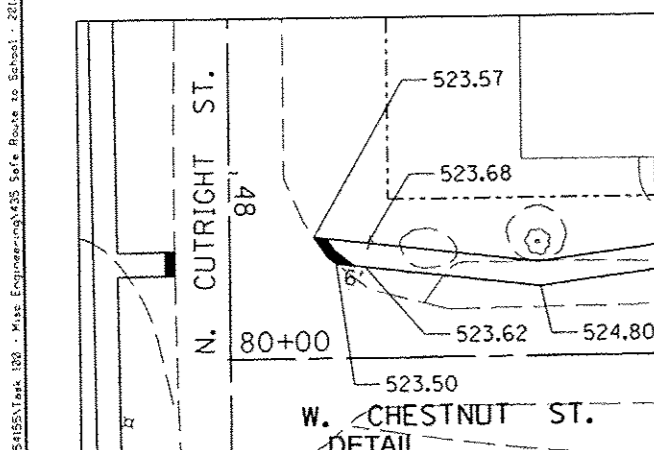
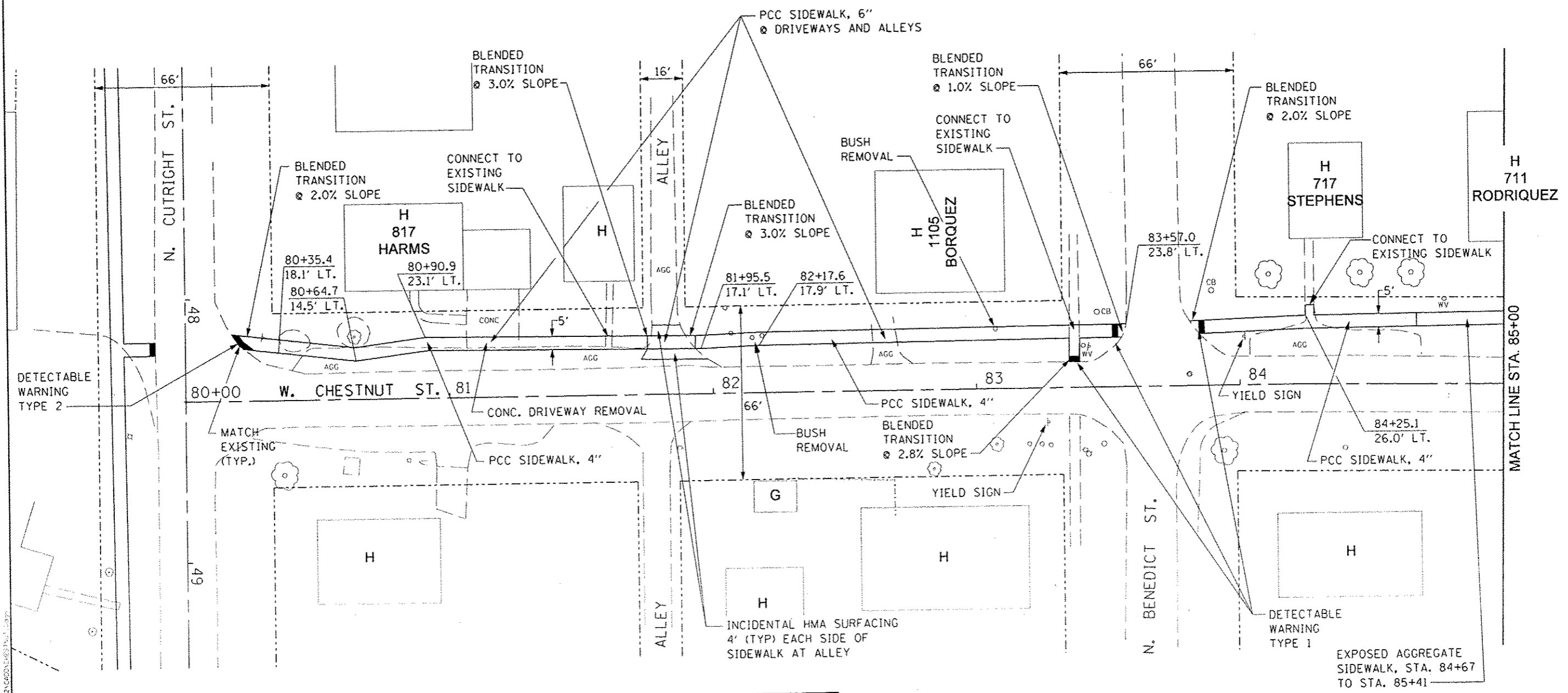

- EXISTING LEGEND**
- DECIDUOUS TREE
 - EVERGREEN TREE
 - BUSH
 - FENCE
 - FIRE HYDRANT
 - UTILITY POLE WITH GUY WIRE
 - SIGN
 - CB CATCH BASIN
 - MANHOLE
 - WV WATER VALVE
 - WM WATER METER
 - CULVERT
 - RIGHT OF WAY
 - STREET LIGHT

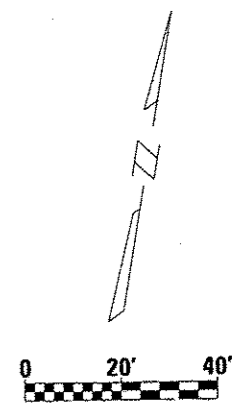

FILE NAME :	USER NAME : I00T	DESIGNED - KMC	REVISED -
\$FILE#		DRAWN - CAM	REVISED -
		CHECKED - REW	REVISED -
		DATE - 6-18-13	REVISED -

**STATE OF ILLINOIS
DEPARTMENT OF TRANSPORTATION**

CHILICOTHE - CHESTNUT STREET SAFE ROUTES TO SCHOOL			
SCALE:	SHEET NO. OF SHEETS	STA. 80+00 TO STA. 85+00	

F.A. RTE.	SECTION	COUNTY	TOTAL SHEETS	SHEET NO.
	12-00037-00-SW	PEORIA	20	17
			CONTRACT NO. 89645	
ILLINOIS FED. AID PROJECT				

K:\PROJECTS\130151851\Task_130 - Miss Engineering\135 Safe Route to School - 2012\GD\130151851.dwg

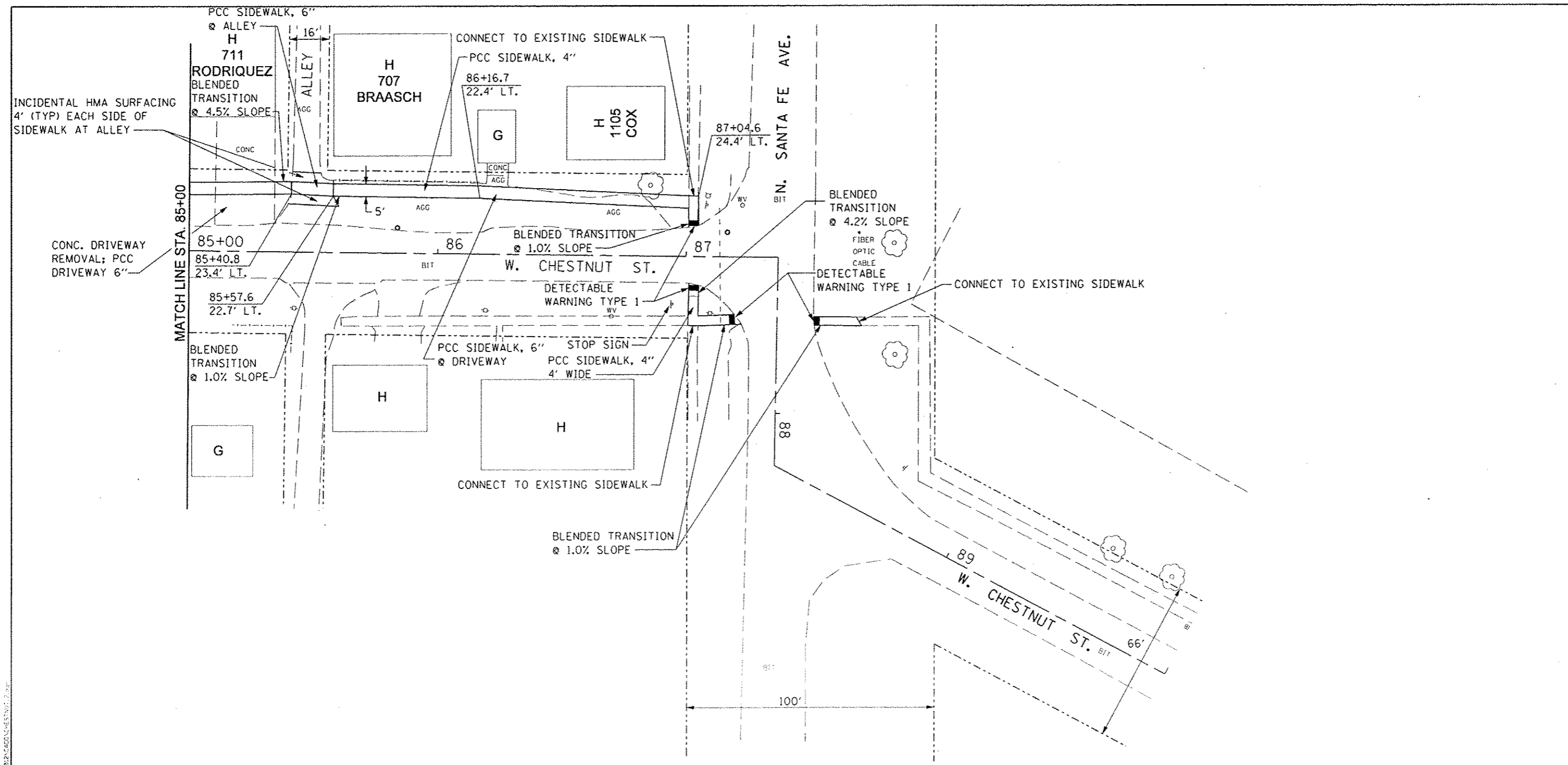

INCIDENTAL HMA SURFACING
4' (TYP) EACH SIDE OF
SIDEWALK AT ALLEY

CONC. DRIVEWAY
REMOVAL; PCC
DRIVEWAY 6"

MATCH LINE STA. 85+00

N. SANTA FE AVE.

W. CHESTNUT ST.

- EXISTING LEGEND**
- DECIDUOUS TREE
 - EVERGREEN TREE
 - BUSH
 - FENCE
 - FIRE HYDRANT
 - UTILITY POLE WITH GUY WIRE
 - SIGN
 - CATCH BASIN
 - MANHOLE
 - WV WATER VALVE
 - WM WATER METER
 - CULVERT
 - RIGHT OF WAY
 - TELEPHONE PEDESTAL

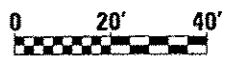

FILE NAME: RTJL6	USER NAME: ADOT	DESIGNED: KMC	REVISED: -	STATE OF ILLINOIS DEPARTMENT OF TRANSPORTATION	CHILlicothe - CHESTNUT STREET SAFE ROUTES TO SCHOOL		F.A. RTE.	SECTION	COUNTY	TOTAL SHEETS	SHEET NO.	
		DRAWN: CAM	REVISED: -		SCALE:	SHEET NO. OF SHEETS	STA. 85+00 TO STA. 90+00	12-00037-00-SW	PEORIA	20	18	
		PLOT SCALE: 48.0000' / IN.	CHECKED: REW		REVISED: -							CONTRACT NO. 89645
		PLOT DATE: 7/9/2013	DATE: 6-18-13		REVISED: -							ILLINOIS FED. AID PROJECT

K:\PROJECTS\15160154\15160154.dwg - Misc Engineering\425 Safe Route to School - 2012-2013\000 CHESTNUT.dwg

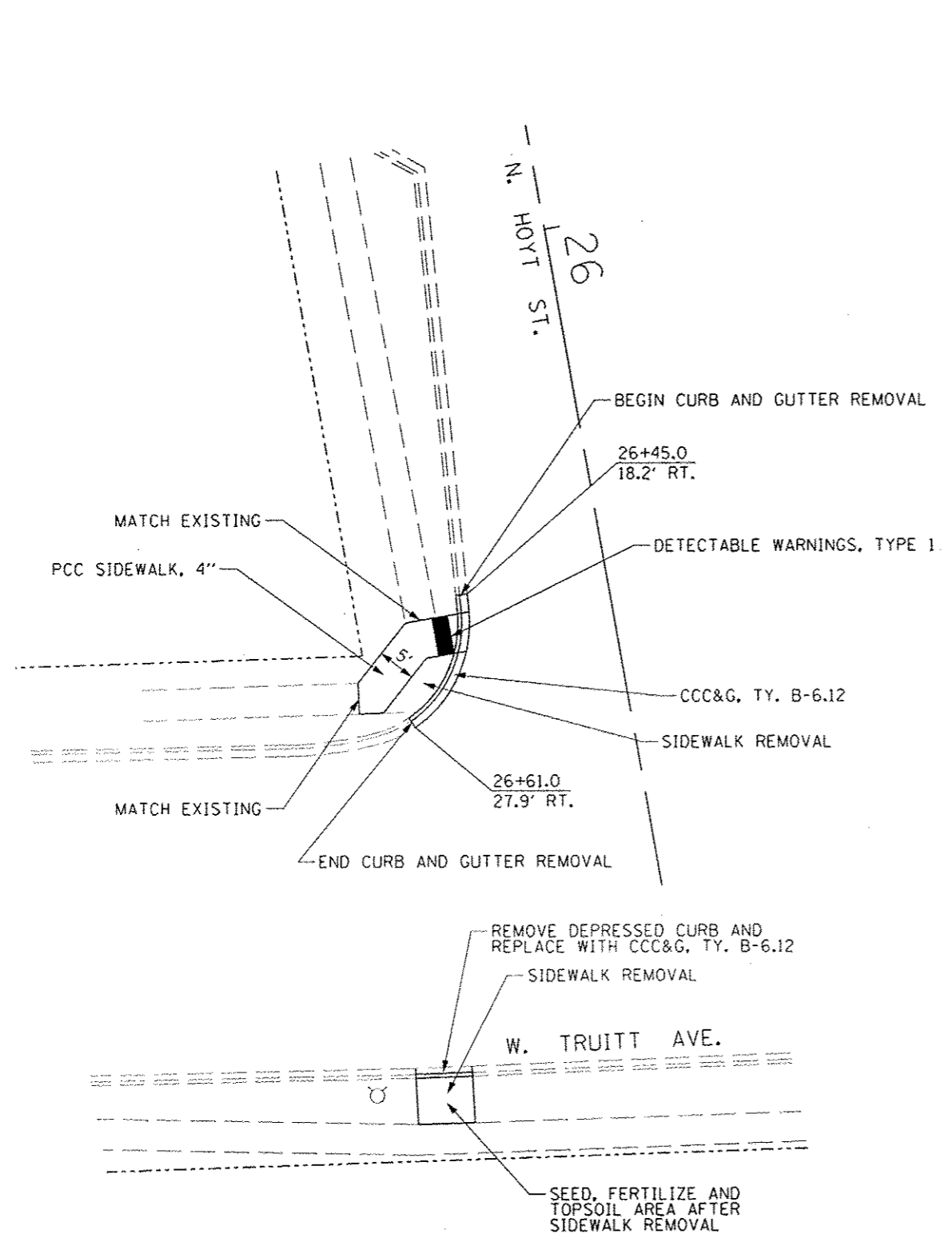

NORTHWEST CORNER

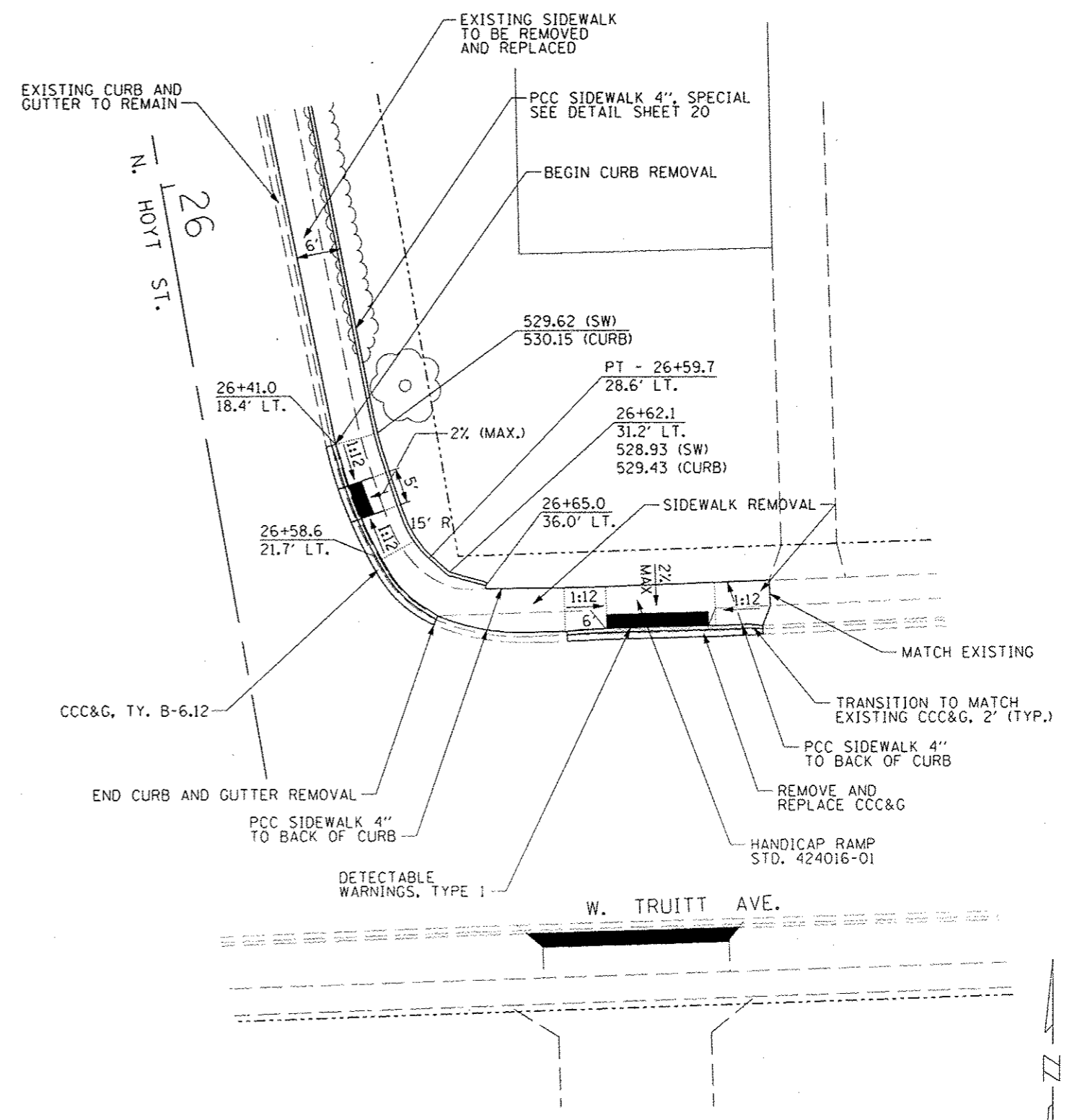

NORTHEAST CORNER

HOYT STREET AT TRUITT AVENUE INTERSECTION

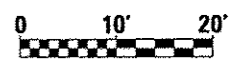

K:\PROJECTS\12-00037-00-SW\Task 188 - Misc Engineering\425 Safe Routes to School - 2012\CAD\01 Detail.dwg

FILE NAME	USER NAME	DESIGNED	REVISED	STATE OF ILLINOIS DEPARTMENT OF TRANSPORTATION	CHILICOTHE - DETAILS SAFE ROUTES TO SCHOOL	F.A. RTE.	SECTION	COUNTY	TOTAL SHEETS	SHEET NO.
	#FILES	DATE	DRAWN			REVISIONS	12-00037-00-SW	PEORIA	20	19
PLOT SCALE = 20,000 th / IN.		CHECKED	REVISIONS	SCALE:		CONTRACT NO. 89645		ILLINOIS FED. AID PROJECT		
PLOT DATE = 7/9/2013		DATE	REVISIONS	SHEET NO. OF SHEETS STA. TO STA.						

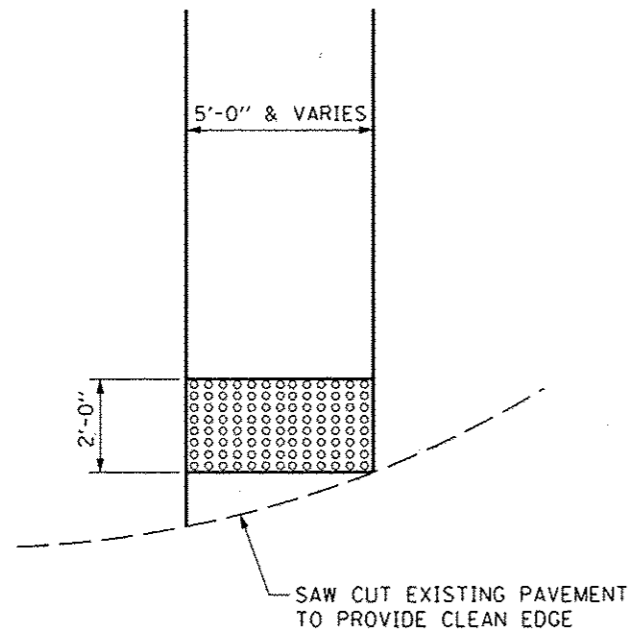

**DETECTABLE WARNING
TYPE 1**

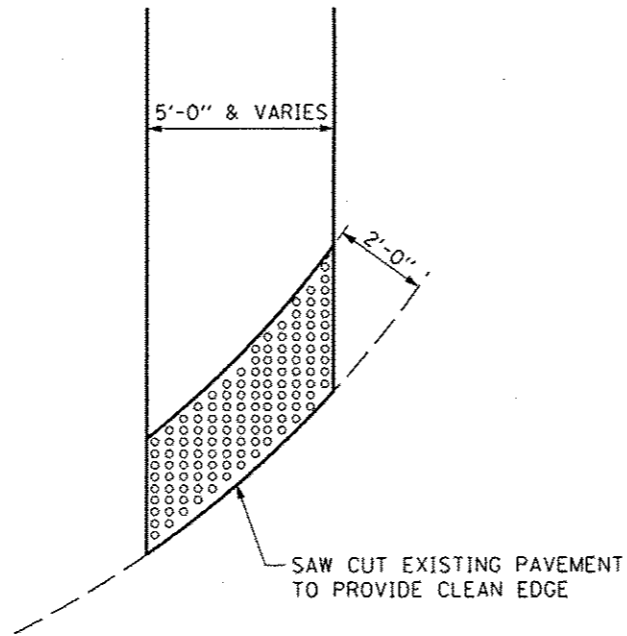

**DETECTABLE WARNING
TYPE 2**

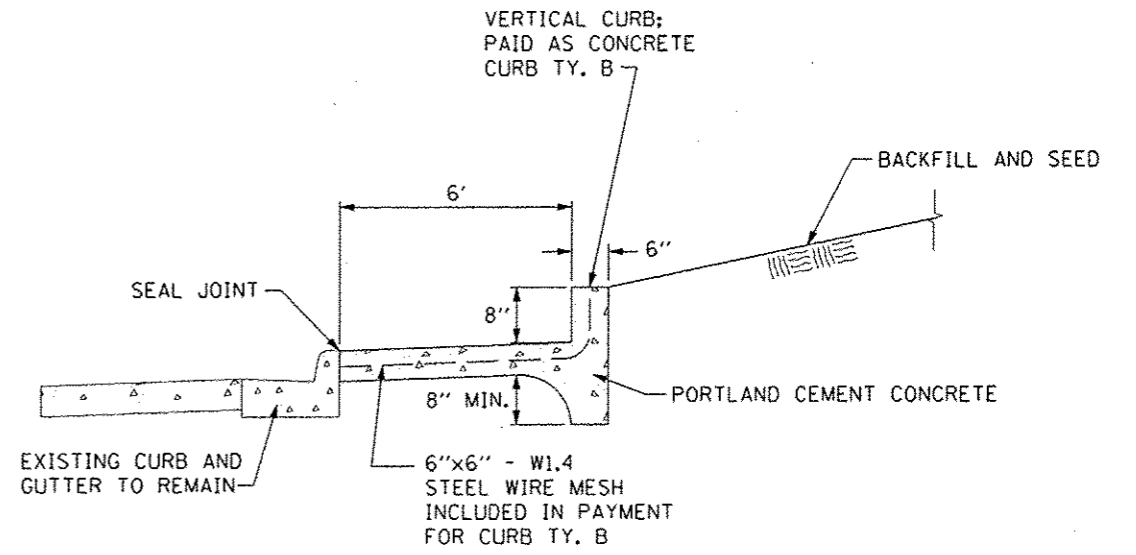

SIDEWALK 4" (SPECIAL)

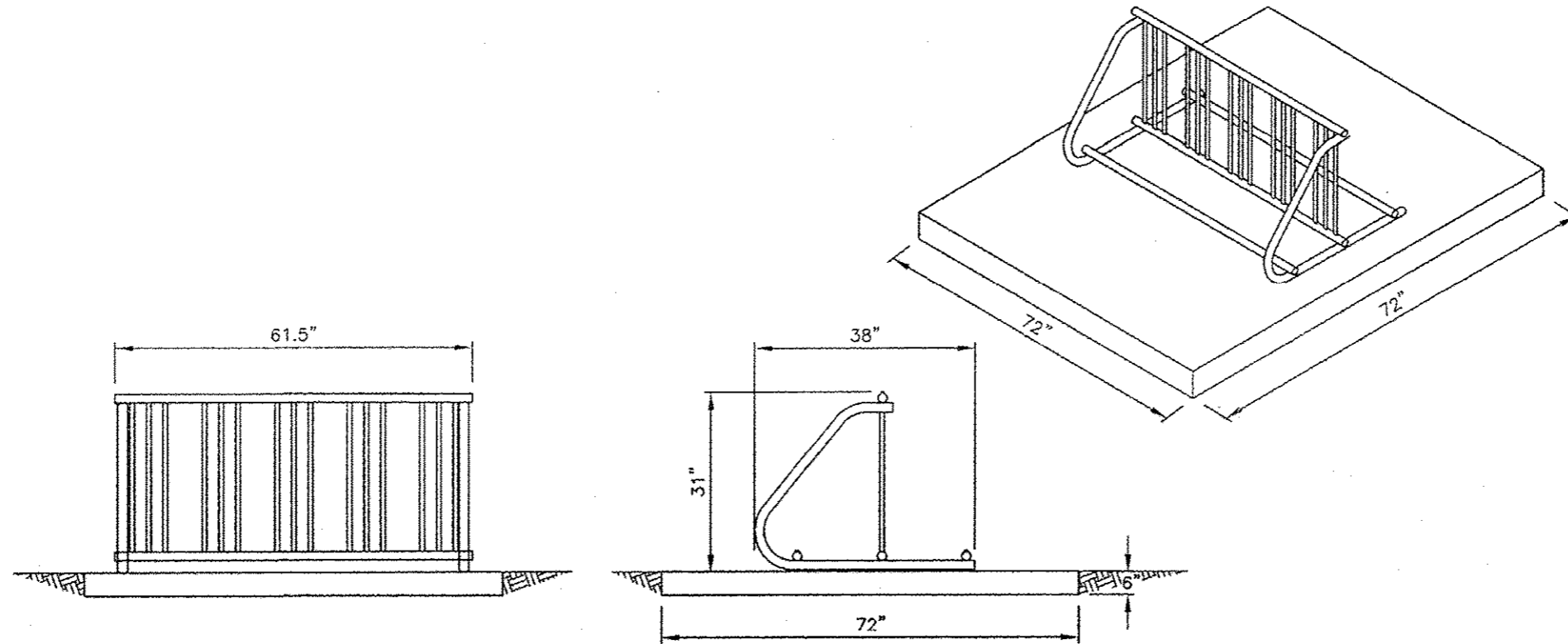

BICYCLE RACK DETAIL

X:\PROJECTS\CHILICOTHE\12-00037-00-SW-Safe Routes to School - 221213\001\0213.dwg

FILE NAME =	USER NAME = IDOT	DESIGNED = KMC	REVISED =	STATE OF ILLINOIS DEPARTMENT OF TRANSPORTATION	CHILICOTHE - DETAILS SAFE ROUTES TO SCHOOL			F.A. R.I.E.	SECTION	COUNTY	TOTAL SHEETS	SHEET NO.	
APL#		DRAWN = CAM	REVISED =		SCALE: N.T.S.	SHEET NO.	OF SHEETS	STA.	TO STA.	12-00037-00-SW	PEORIA	20	20
		CHECKED = REW	REVISED =										
		DATE = 6-18-13	REVISED =										
		PLOT DATE = 7/1/2013											
										ILLINOIS FED. AID PROJECT			