

046

FOR INDEX OF SHEETS, SEE SHEET NO. 3
 FOR STATION EQUATIONS & OMISSIONS, SEE SHEET NO. 4
 FOR SUMMARY OF QUANTITIES, SEE SHEET NO. 5

STATE OF ILLINOIS
 DEPARTMENT OF TRANSPORTATION

F.A.L. RTE.	SECTION	COUNTY	TOTAL SHEETS	SHEET NO.
24	D9 Patch 2020-2	MASSAC	8	1
ILLINOIS			CONTRACT NO. 78737	

TRAFFIC DATA EB LANES I-24 MASSIC COUNTY

LEG A:	FAI 24 STA 0.00-2.91 EB ONLY!		
	2018	2020	2040
PV =	5,875	6,050	8,150
SU =	325	335	450
MU =	3,200	3,295	4,440
ADT =	9,400	9,680	13,040
LEG B:	FAI 24 STA 2.91-13.52 EB ONLY!		
	2018	2020	2040
PV =	7,025	7,240	9,750
SU =	375	385	520
MU =	3,100	3,195	4,300
ADT =	10,500	10,820	14,570
LEG C:	FAI 24 STS 13.52-15.09 EB ONLY!		
	2018	2020	2040
PV =	12,350	12,850	19,095
SU =	550	570	850
MU =	3,200	3,330	4,945
ADT =	16,100	16,750	24,890

STATIONING IS FROM THE JOHNSON/MASSIC COUNTY LINE EASTWARD.
 FOR INTERSTATE MILEPOST STATIONING, ADD 23.92

PROJECT BEGINS - MP 23.92
 JOHNSON COUNTY LINE: EQ. STA. 456+69.50 BK (€ MEDIAN)
 MASSAC COUNTY LINE: STA. 50+54.47 AH (€ MEDIAN)

C-99-075-19

PROPOSED
 HIGHWAY PLANS

FAI ROUTE 24 (I-24)
 SECTION D9 PATCH 2020-2

CENTERLINE REPAIR
 MASSAC COUNTY

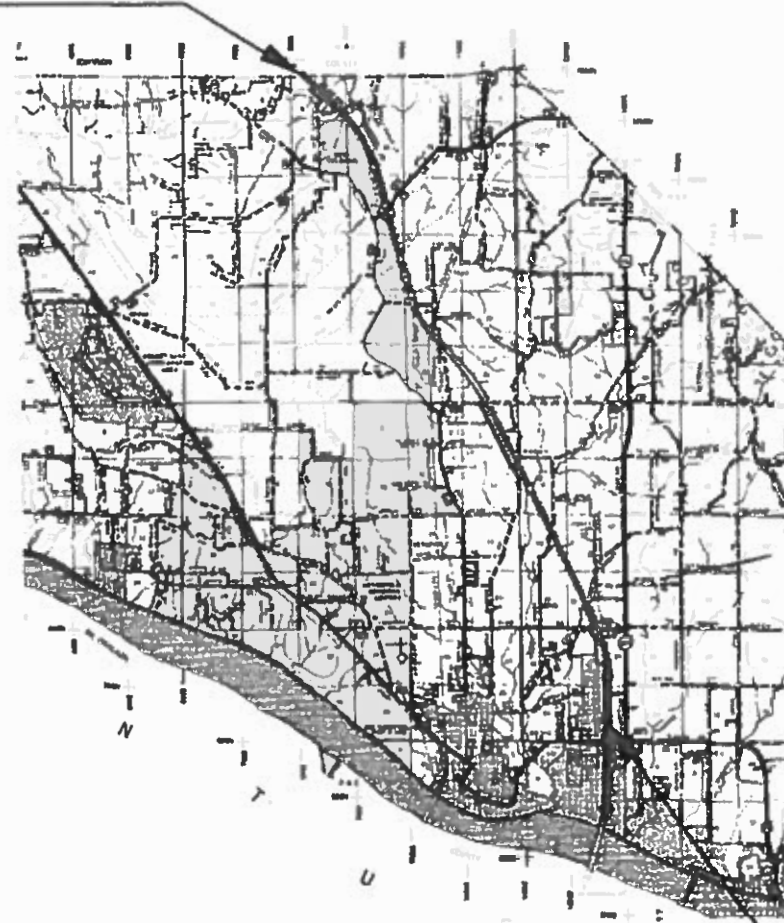
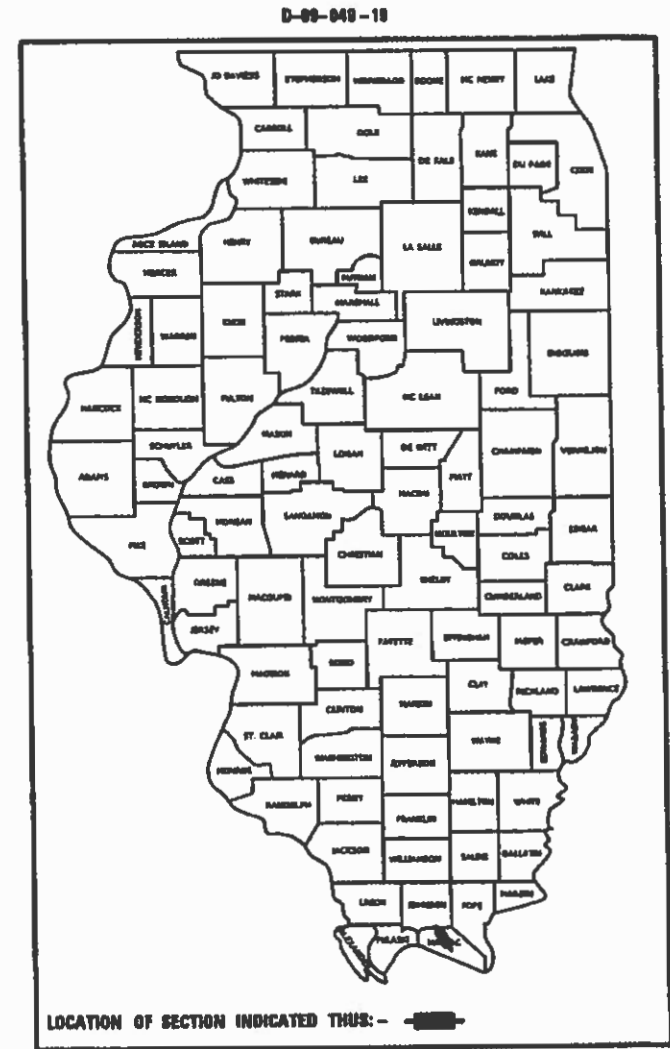

TOWNSHIPS

GEORGES CREEK BENTON
 GRANT WASHINGTON
 METROPOLIS WEST BROOKLYN

DESIGN DESIGNATION : NA

COORDINATE SYSTEM : NA

POSTED SPEED : 70 MPH

J.U.L.I.E.
 JOINT UTILITY LOCATION INFORMATION FOR EXCAVATION
 1-800-882-0123
 OR 811

PROJECT ENGINEER - VALERIE ROLLA 618-351-5214
 PROJECT DESIGNER - DARRYL LEFTWICH 618-351-5291

GROSS LENGTH = 69374.03 FT = 13.139 MILES
 NET LENGTH = 68942.87 FT = 13.057 MILES

PROJECT ENDS - MP 37.00
 STA 330+00.00 (€ EB LANES)

STATE OF ILLINOIS
 DEPARTMENT OF TRANSPORTATION

SUBMITTED 08-20-2019
[Signature] REGION FIVE ENGINEER

Aug 16 2019
[Signature] ENGINEER OF DESIGN AND ENVIRONMENT

Aug 16 2019
[Signature] DIRECTOR OF HIGHWAYS PROJECT IMPLEMENTATION

PRINTED BY THE AUTHORITY
 OF THE STATE OF ILLINOIS

CONTRACT NO. 78737

SHEET NO	DESCRIPTION
1	COVER SHEET
2	SIGNATURE SHEET
3	INDEX OF SHEETS, HIGHWAY STANDARDS,
4	GENERAL NOTES, STATION EQUATIONS, BRIDGE OMISSIONS, MIX DESIGN
5-6	SUMMARY OF QUANTITIES
7	TYPICAL SECTION: I 24 MASSAC CO
8	I-24 MASSAC CO - PLAN (FOR INFO ONLY)

HIGHWAY STANDARDS

- 000001-07 STANDARDS SYMBOLS ABBREVIATIONS & PATTERNS
- 001006-00 DECIMAL OF INCH & FOOT
- 701101-05 OFF RD OP - MULTI LN - LESS THAN 15 FT TO EOP
- 701106-02 OFF RD OP - MULTI LN - MORE THAN 15 FT AWAY
- 701400-09 APPROACH TO LN CLOSURE - FRWAY EXPWAY
- 701401-12 LN CLOSURE FRWAY EXPWAY
- 701411-09 LN CLOSURE MULTI LN - ENTR OR EXIT RAMP 45 MPH OR MORE
- 701901-08 TRAF CNTRL DEVICES
- 780001-05 TYPICAL PVMT MRKINGS
- 781001-04 TYPICAL APP RAISED REFLC PVMT MRKRS

MODEL: Default
 FILE: \\blm1c1-pub\pubroom\data\illinois.gov\PWIDOT\Documents\DOT_Offices\District_9\Projects\78737\CADDData\CAD\Sheets\I9xxx-Sheets.dgn

USER NAME = Leftwichdt	DESIGNED -	REVISED -	STATE OF ILLINOIS DEPARTMENT OF TRANSPORTATION	INDEX OF SHEETS HIGHWAY STANDARDS & COMMITMENTS	F.A.I. RTE.	SECTION	COUNTY	TOTAL SHEETS	SHEET NO.
PLOT SCALE = 100.0000 ' / in.	DRAWN -	REVISED -			24	D9 Patch 2020-2	MASSAC	8	3
PLOT DATE = 6/25/2019	CHECKED -	REVISED -			CONTRACT NO. 78737				
	DATE -	REVISED -			SCALE:		SHEET	OF	SHEETS
					ILLINOIS FED. AID PROJECT				

GENERAL NOTES

FACTORS USED FOR ESTIMATING PLAN QUANTITIES ARE AS FOLLOWS AND SHALL NOT BE USED FOR THE BASIS OF FINAL QUANTITIES:

ALL HOT MIX ASPHALT 2.016 TONS/CU. YD.

THE QUANTITY OF SHORT TERM PAVEMENT MARKING SHOWN IN THE PLANS IS BASED ON ONE APPLICATION AFTER THE SURFACE COURSE ONLY

QUANTITIES SHOWN IN THE PLANS FOR CENTERLINE REPAIR ARE ESTIMATES. THE ACTUAL CENTERLINE REPAIR LOCATIONS AND AMOUNT OF CENTERLINE REPAIR REQUIRED SHALL BE DETERMINED BY THE ENGINEER.

COMMITMENTS: NONE

STATION EQUATIONS

I-24 MASSAC CO EAST BOUND LANES

STA 456+69.50 BK (MEDIAN) = STA 50+54.47 AH (MEDIAN)
 40' LT. STA 301+81.06 BK (MEDIAN) = STA 1301+73.45 AH (TL WBL)
 40' RT. STA 301+81+.06 BK (MEDIAN) = STA 301+86.33 AH (TL EBL)
 40' RT. STA 1417+84.96 (TL WBL) BK = STA 417+03.53 AH (MEDIAN)
 40' LT. STA 417+07.71 BK (TL EBL) = STA 417+03.53 AH (MEDIAN)
 STA 446+93.78 BK (MEDIAN) = STA 32+66.19 AH (MEDIAN)

EAST BOUND LANES - BRIDGES

OMISSIONS FOR THIS PROJECT

SN 064-0015	STA 201+16.37	TO	STA 202+08.62	EBL
SN 064-0018	STA 253+53.07	TO	STA 255+03.90	EBL
SN 064-0021	STA 328+84.92	TO	STA 330+73.00	EBL
SN 064-0024	STA 94+17.08	TO	STA 95+73.91	EBL
SN 064-0026	STA 139+09.68	TO	STA 140+28.18	EBL
SN 064-0027	STA 239+87.16	TO	STA 241+17.66	EBL

HMA MIXTURE REQUIREMENTS TABLE

The following HMA mixture requirements are applicable for this project

Location(s):	Hot-Mix Asphalt Surface Course
Mixture Use(s):	Hot-Mix Asphalt Surface Course, Mix D, N90
PG:	PG64-22
Design Air Voids:	See Special Provision
Mixture Composition: (Mixture Gradation)	4.0 %, 90 Gyration Design IL-9.5mm
Friction Aggregate:	D Surface
Mixture Weight:	112 lbs/Sq Yd/in
Quality Management Program:	QCQA
Sublot Size:	NA

MODEL: Default
 FILE: \\blm1c01.pw.us.ibm.com\data\illinois.gov\PIWDOT\Documents\DOT_Offices\District_9\Projects\78737\CAADData\CAD\Sheets\09xxx-Sheets.dgn

USER NAME = Leftwichdl	DESIGNED -	REVISED -	STATE OF ILLINOIS DEPARTMENT OF TRANSPORTATION	GENERAL NOTES, STATION EQUATIONS BRIDGE OMISSIONS, MIX DESIGNS		F.A.I. RTE.	SECTION	COUNTY	TOTAL SHEETS	SHEET NO.
DRAWN -	REVISED -	24				D9 Patch 2020-2	MASSAC	8	4	
PLOT SCALE = 100,0000 ' / in.	CHECKED -	REVISED -				CONTRACT NO. 78737				
PLOT DATE = 6/26/2019	DATE -	REVISED -		SCALE:	SHEET	OF	SHEETS	STA.	TO	STA.

SUMMARY OF QUANTITIES

ROUTE:	EB I-24
COUNTY:	MASSAC CO
FUNDING:	80% FED / 20% STATE
LOCATION:	RURAL
	ROADWAY
	0005

CODE NUMBER	ITEM DESCRIPTION	UNIT	QUANTITY
40600290	BITUMINOUS MATERIALS (TACK COAT)	POUND	1,700
40603345	HOT-MIX ASPHALT SURFACE COURSE, MIX "D", N90	TON	578
67100100	MOBILIZATION	L SUM	1
70100420	TRAFFIC CONTROL AND PROTECTION, STANDARD 701411	EACH	2
70100800	TRAFFIC CONTROL AND PROTECTION, STANDARD 701401	L SUM	1
70107025	CHANGEABLE MESSAGE SIGN	CAL DA	14
70300100	SHORT TERM PAVEMENT MARKING	FOOT	1,697
70300150	SHORT TERM PAVEMENT MARKING REMOVAL	SQ FT	568
* 78000400	THERMOPLASTIC PAVEMENT MARKING - LINE 6"	FOOT	4,240
* 78100100	RAISED REFLECTIVE PAVEMENT MARKER	EACH	214

* SPECIALTY ITEM

MODEL: Default
 FILE: \\nas01c.psu.edu\pub\baronm.d\at\illinois.gov\PWIDOT\Documents\DOT_Offices\District_9\Projects\78737\CADD\Drawings\CAD\Drawings\Drawings\Sheet1.dgn

FAI 24 MASSAS CO STATION EQUATIONS & BRIDGE LOCATIONS

PROJECT BEGINS
STATION EQUATION AT JOHNSON / MASSAC COUNTY LINE
STA 456+69.50 BK = STA 50+55.77 AH

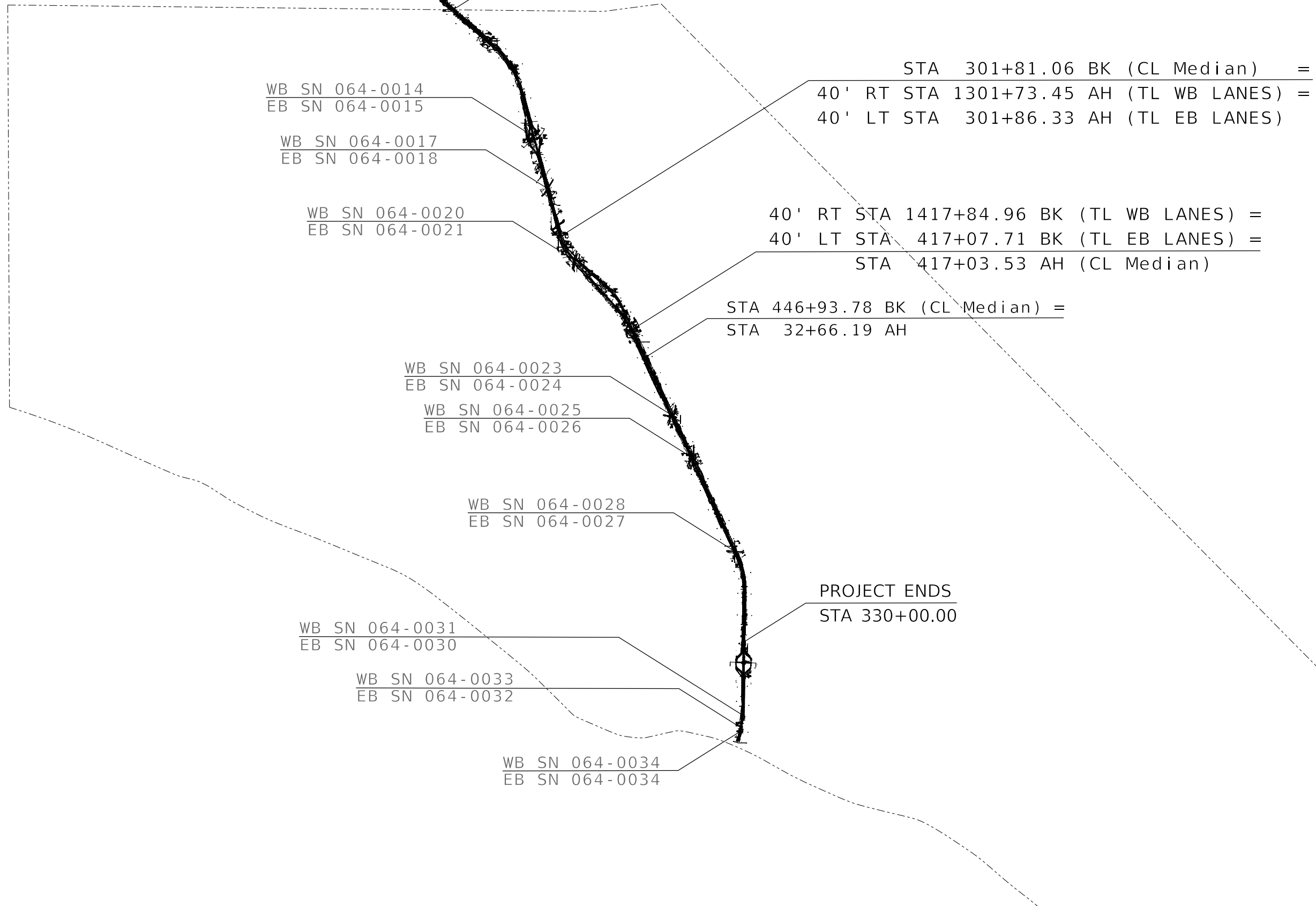

MODEL: Default
 FILE: \\blm1c:\pub\blm1room\dat\illinois.gov\PWIDOT\Documents\DOT_Offices\District 9\Projects\78737\CADData\CAD\Sheets\09xxx-Sheets.dgn

USER NAME = Leftwichd	DESIGNED -	REVISED -
	DRAWN -	REVISED -
PLOT SCALE = 100,0000' / in.	CHECKED -	REVISED -
PLOT DATE = 6/25/2019	DATE -	REVISED -

**STATE OF ILLINOIS
DEPARTMENT OF TRANSPORTATION**

**ROADWAY DETAILS
FOR INFORMATION ONLY**

SCALE: SHEET OF SHEETS STA. TO STA.

F.A.I. RTE.	SECTION	COUNTY	TOTAL SHEETS	SHEET NO.
24	D9 Patch 2020-2	MASSAC	8	8
CONTRACT NO. 78737				
ILLINOIS FED. AID PROJECT				