

```

=====
Point 1          N 1,490,088.753861 E 2,346,550.219871 Sta 1425+00.00
Course from 1 to PC EXCL2-1 N 23° 52' 38.49" W Dist 2,514.674121

Curve Data
-----
Curve EXCL2-1
P. I. Station    1454+20.68 N 1,492,759.468270 E 2,345,367.984583
Delta           21° 26' 16.02" (RT)
Degree          2° 40' 16.66"
Tangent         406.010000
Length          802.524552
Radius          2,144.870577
External        38.089320
Long Chord      797.851490
Mtd. Ord.       37.424720
P. C. Station   1450+14.67 N 1,492,388.207048 E 2,345,532.329418
P. T. Station   1458+17.20 N 1,493,165.110290 E 2,345,350.702461
C. C.           1,493,256.408325 E 2,347,493.629072
Back            = N 23° 52' 38.49" W
Ahead           = N 2° 26' 22.47" W
Chord Bear     = N 13° 09' 30.48" W

Course from PT EXCL2-1 to 2 N 2° 26' 22.47" W Dist 562.991568
Point 2          N 1,493,727.591600 E 2,345,326.738300 Sta 1463+80.19
=====

```

```

EXIST. CURVE EXCL2-1
PI STA. = 1454+20.68
Δ = 21° 26' 16" (RT)
D = 2° 40' 17"
R = 2,144.87'
T = 406.01'
L = 802.52'
E = 38.09'
e = -----
T.R. = -----
S.E. RUN = -----
P.C. STA. = 1450+14.67
P.T. STA. = 1458+17.20

```

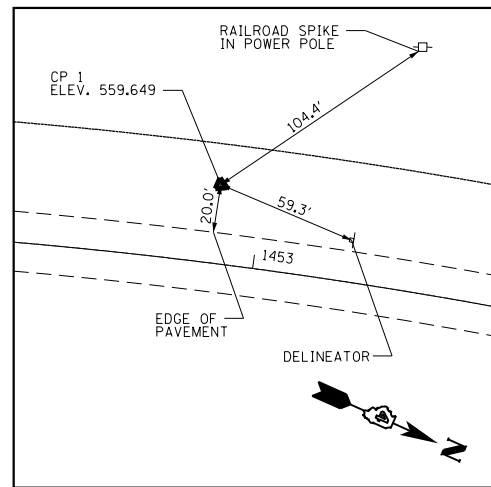

CONTROL POINT 1

SET IRON PIN WITH HLC CAP
 STA. 1452+82.48, 32.91' LT.
 N. 1,492,629.7461
 E. 2,345,407.9614
 ELEV. 631.60

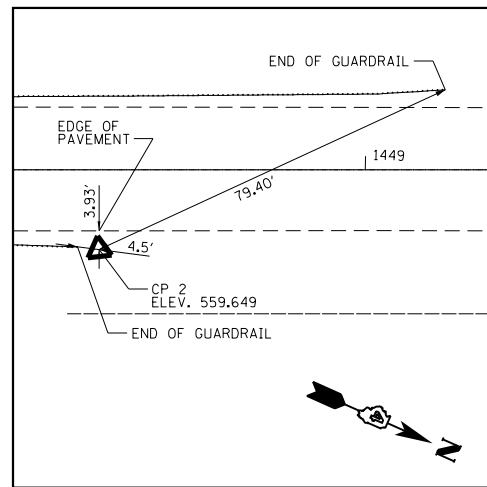

CONTROL POINT 2

SET IRON PIN WITH HLC CAP
 STA. 1448+44.54, 16.62' RT.
 N. 1,492,239.3590
 E. 2,345,616.3970
 ELEV. 612.59

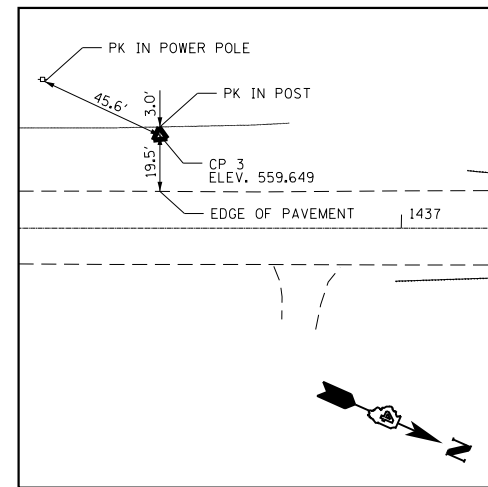

CONTROL POINT 3

SET IRON PIN WITH HLC CAP
 STA. 1436+16.18, 32.30' LT.
 N. 1,491,096.3320
 E. 2,346,068.8740
 ELEV. 628.41

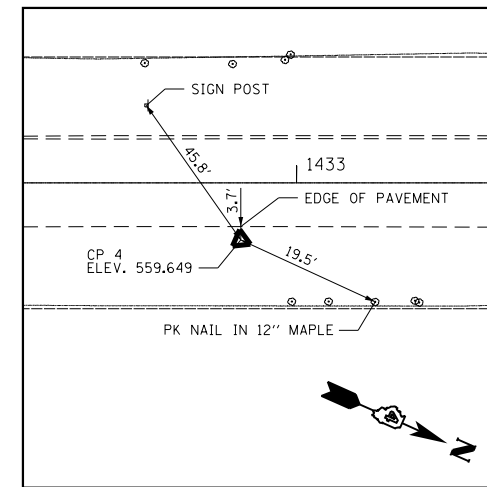

CONTROL POINT 4

SET IRON PIN WITH HLC CAP
 STA. 1432+84.53, 15.84' RT.
 N. 1,490,812.5059
 E. 2,346,247.0015
 ELEV. 635.42

BENCHMARK 3

ELEV. 635.30
 RAILROAD SPIKE IN POWER POLE
 0.6 MILES SOUTH OF RAILROAD BRIDGE
 OVER RTE 78, WEST SIDE OF RTE 78.

BENCHMARK 4

ELEV. 610.54
 CHISLED SQUARE ON NORTHEAST
 WINGWALL AT BRIDGE ON RTE 78
 OVER KICKAPOO CREEK.

BENCHMARK 5

ELEV. 610.64
 CHISLED SQUARE ON SOUTHWEST
 WINGWALL AT BRIDGE ON RTE 78
 OVER KICKAPOO CREEK.

BENCHMARK 6

ELEV. 647.24
 RAILROAD SPIKE IN POWER POLE
 0.3 MILES SOUTH OF BRIDGE ON RTE 78
 OVER KICKAPOO CREEK, EAST SIDE OF RTE 78.

DECATUR (217) 422-8544
 SCHAUMBURG (815) 714-0050
 ROCKFORD (815) 499-0050
 184-001397

CHASTAIN & ASSOCIATES, LLC
 CONSULTING ENGINEERS

FILE NAME =	USER NAME = jacobsmr	DESIGNED - CHASTAIN	REVISED -
p:\planroom\dot\illinois.gov\PIDOT\Documents\IDOT Offices\District 4\Projects\04.68\BROWN to CAD\Sheets\Chastain\0468758-sh-11-16-16		CHECKED - CAS	REVISED -
Default	PLOT DATE = 5/9/2019	DATE - 10/16	REVISED -

**STATE OF ILLINOIS
DEPARTMENT OF TRANSPORTATION**

**ALIGNMENT, TIES AND BENCHMARKS
ILLINOIS ROUTE 78**

SCALE: SHEET OF SHEETS STA. TO STA.

F.A.P. RTE.	SECTION	COUNTY	TOTAL SHEETS	SHEET NO.
22	48(B-1)BR(CR)	KNOX	94	21
CONTRACT NO. 68758				
ILLINOIS FED. AID PROJECT				