

F.A.P. RTE.	SECTION	COUNTY	TOTAL SHEETS	SHEET NO.
332		COOK	54	23
STA.		TO STA.		
FED. ROAD DIST. NO. 1		ILLINOIS HIGHWAY PROJECT		

• (0101, 0203B & 0303) RS-10

I-394 (BISHOP FORD EXPY)

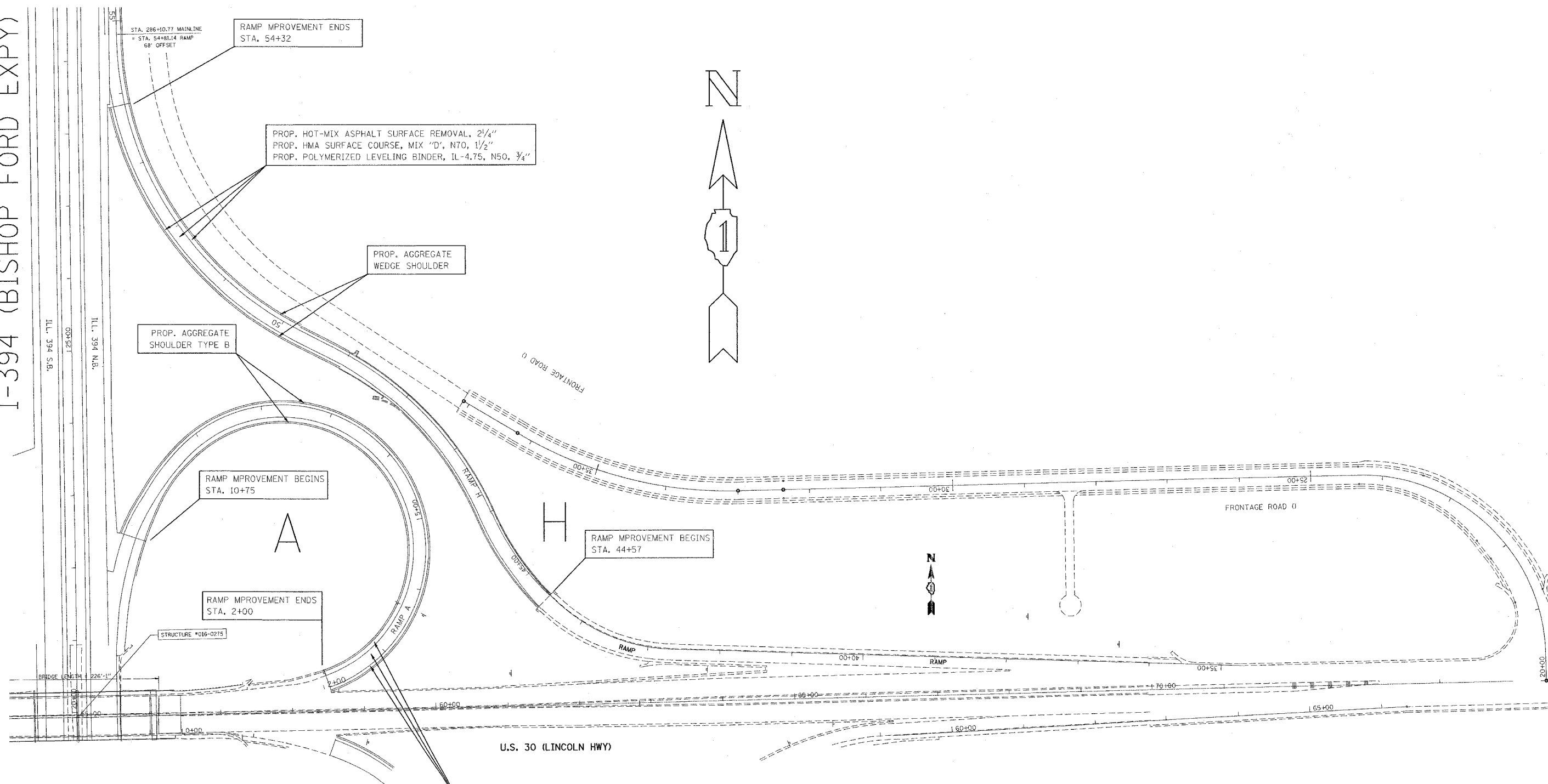

RAMP IMPROVEMENT ENDS
STA. 54+32

PROP. HOT-MIX ASPHALT SURFACE REMOVAL, 2 1/4"
PROP. HMA SURFACE COURSE, MIX "D", N70, 1 1/2"
PROP. POLYMERIZED LEVELING BINDER, IL-4.75, N50, 3/4"

PROP. AGGREGATE
WEDGE SHOULDER

PROP. AGGREGATE
SHOULDER TYPE B

RAMP IMPROVEMENT BEGINS
STA. 10+75

RAMP IMPROVEMENT BEGINS
STA. 44+57

RAMP IMPROVEMENT ENDS
STA. 2+00

STRUCTURE #015-0275

PROP. HOT-MIX ASPHALT SURFACE REMOVAL, 2 1/4"
PROP. HMA SURFACE COURSE, MIX "D", N70, 1 1/2"
PROP. POLYMERIZED LEVELING BINDER, IL-4.75, N50, 3/4"

REVISIONS	
NAME	DATE

ILLINOIS DEPARTMENT OF TRANSPORTATION
FAP 332 IL 394
IL 394 (BISHOP FORD MEMORIAL EXPWY)
RAMPS AT US 30

SCALE: N.T.S. DRAWN BY

8/6/2007
C:\p1\ref\020502\020502.dwg
REF.