

F.A.P. RTE.	SECTION	COUNTY	TOTAL SHEETS	SHEET NO.
301	(2HB-2, 2HB-1D)	WINNEBAGO	107	15
STA.		TO STA.		
FED. ROAD DIST. NO.	ILLINOIS	FED. AID PROJECT		

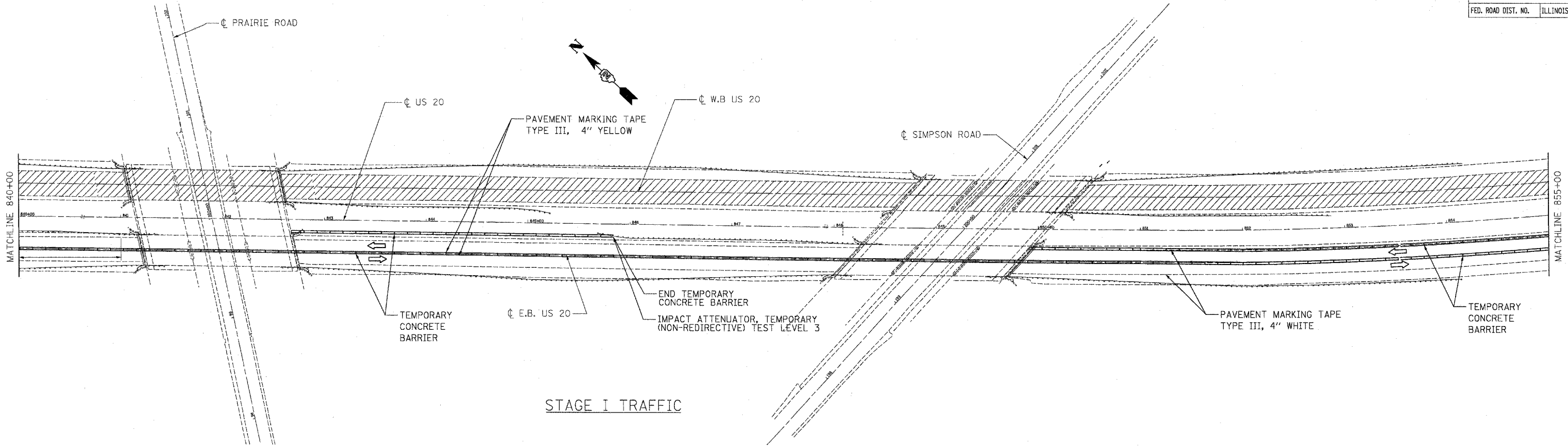

STAGE I TRAFFIC

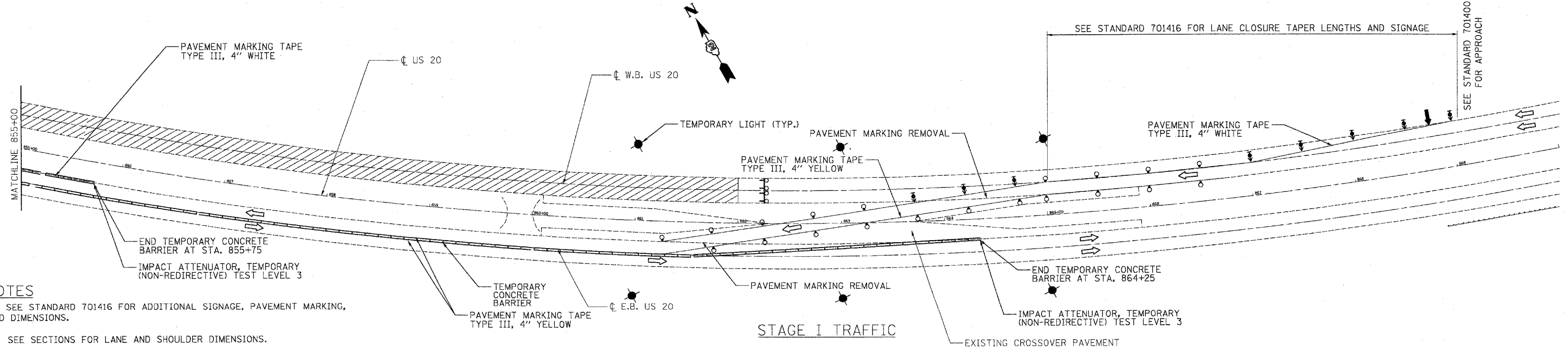

STAGE I TRAFFIC

- NOTES**
- SEE STANDARD 701416 FOR ADDITIONAL SIGNAGE, PAVEMENT MARKING, AND DIMENSIONS.
  - SEE SECTIONS FOR LANE AND SHOULDER DIMENSIONS.
  - ALL BARRICADES, DRUMS, AND VERTICAL PANELS SHALL BE AT 15 m (50 ft.) CENTERS. WHERE THE TANGENT DISTANCE "T" ON THE TEMPORARY RUNAROUND EXCEEDS 180 m (600 ft.) CLEAR DELINEATORS AT 15 m (50 ft.) CENTERS MAY BE SUBSTITUTE FOR THE VERTICAL PANELS, OR SPACING BETWEEN VERTICAL PANELS MAY BE INCREASED TO 30 m (100 ft.) WITHIN THE LIMITS OF THE TANGENT.
  - SEE TEMPORARY ROADWAY LIGHTING DETAIL FOR MORE INFORMATION. THE COST FOR TEMPORARY LIGHTS WILL BE INCLUDED IN LUMP SUM COST FOR TEMPORARY LIGHTING SYSTEM.
  - CONTRACTOR TO COORDINATE WITH COM ED ON PROPOSED LOCATION FOR TEMPORARY LIGHTING.

REVISIONS	
NAME	DATE

ILLINOIS DEPARTMENT OF TRANSPORTATION  
 US 20 OVER  
 PRAIRIE AND SIMPSON ROADS

TRAFFIC CONTROL PLAN  
 STAGE I

SCALE: VERT. 1" = 50'  
 HORIZ. 1" = 50'  
 DATE 04/03/07

DRAWN BY AJP  
 CHECKED BY SPF