

B.M. - Cut "X" on North side of Prairie Road, east of bypass. Elev.=739.34
 Existing S.N.'s 101-0051 (W.B.) and 101-0052 (E.B.)

Each structure is a three span reinforced concrete deck bridge on steel I-beams. Spans of 47'-0", 56'-0", 47'-0", 154'-1 1/4" Back to Back Abutments. 35'-8" O. to O. Built in 1963. The Contractor shall remove existing concrete deck, abutment bearings, abutment backwalls, abutment wingwalls, and approach slabs. Replace with widened R.C. deck, Elastomeric bearings, and widen structure for additional beam line. The road shall be kept open with one lane of traffic in each direction using a median crossover.

No Salvage

STATE OF ILLINOIS
 DEPARTMENT OF TRANSPORTATION

INDEX OF SHEETS

- 1 General Plan and Elevation
- 2 General Notes and Total Bill of Materials
- 3 Stage Construction
- 4-6 Top of Slab Elevations
- 7-10 Top of Slab Approach Elevations
- 11 Superstructure Plan
- 12 Superstructure Details
- 13 Drainage Scupper, DS-II
- 14 Preformed Joint Strip Seal
- 15 Framing Plan
- 16 Structural Steel Details
- 17 Pier Steel Bearing Assembly
- 18 Elastomeric Bearing Assembly Type I
- 19 Elastomeric Bearing Type II
- 20 Westbound West Abutment
- 21 Westbound West Abutment Wingwalls
- 22 Westbound West Abutment Details
- 23 Westbound East Abutment
- 24 Westbound East Abutment Wingwalls
- 25 Westbound East Abutment Details
- 26 Eastbound West Abutment
- 27 Eastbound West Abutment Wingwalls
- 28 Eastbound West Abutment Details
- 29 Eastbound East Abutment
- 30 Eastbound East Abutment Wingwalls
- 31 Eastbound East Abutment Details
- 32 Westbound Pier 1
- 33 Westbound Pier 2
- 34 Eastbound Pier 1
- 35 Eastbound Pier 2
- 36 Slope Wall and Abutment Drainage Details
- 37 Bar Splicer Assembly Details
- 38 Pile and Encasement Details
- 39 Parapet Slip Forming Option
- 40-43 Boring Logs

ROUTE NO.	SECTION	COUNTY	SHEET NO.	SHEET NO.
F.A.P. 301 (US 20)	(2HB-2)D	WINNEBAGO	107	23
FED. ROAD DIST. NO. 7	ILLINOIS	FED. AID PROJECT-		

43 SHEETS

Contract #64B07

DESIGN SPECIFICATIONS

2002 AASHTO Standard Specifications - 17th ed.

LOADING HS20-44

No allowance for future wearing surface.

DESIGN STRESSES

New construction field units

f'c = 3,500 psi

fy = 60,000 psi (Reinforcement)

fy = 36,000 psi (Structural Steel AASHTO M270 Grade 50)

Existing construction field units

f'c = 3,500 psi

fy = 40,000 psi (Reinforcement)

fy = 36,000 psi (Structural Steel AASHTO M270 Grade 50)

SEISMIC DATA

Seismic Performance Category (SPC) = A

Bedrock Acceleration Coefficient (A) = 0.035

Site Coefficient (S) = 1.2

APPROVED

FOR STRUCTURAL ADEQUACY ONLY

Ralph E. Anderson (SE)
 ENGINEER OF BRIDGES AND STRUCTURES

Jennifer L. Anderson (SE)
 JENNIFER L. ANDERSON, S.E., P.E.
 LICENSE NO: 081-005858
 EXPIRES: 11/2008

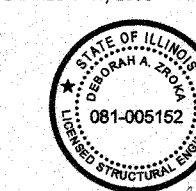

Deborah A. Zroka (SE)
 DEBORAH A. ZROKA, S.E.
 LICENSE NO. 081-005152
 EXPIRES: 11/30/2008

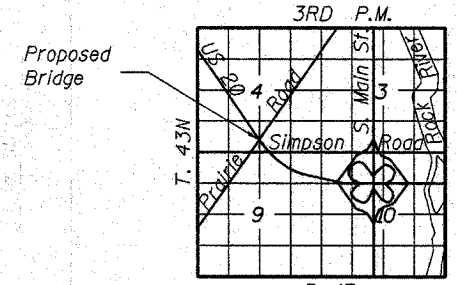
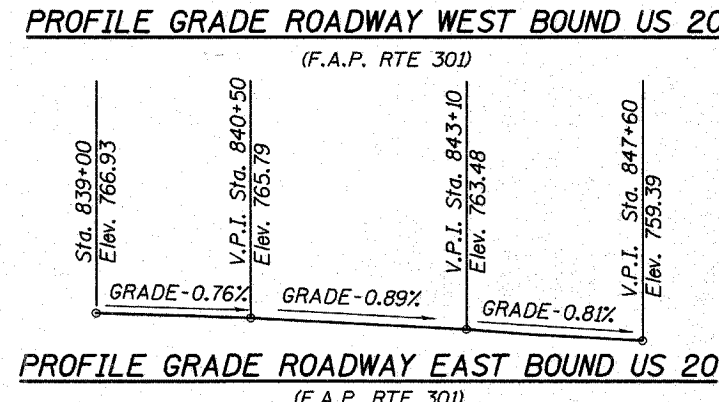
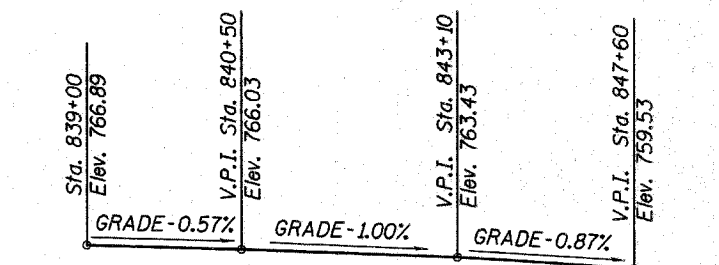
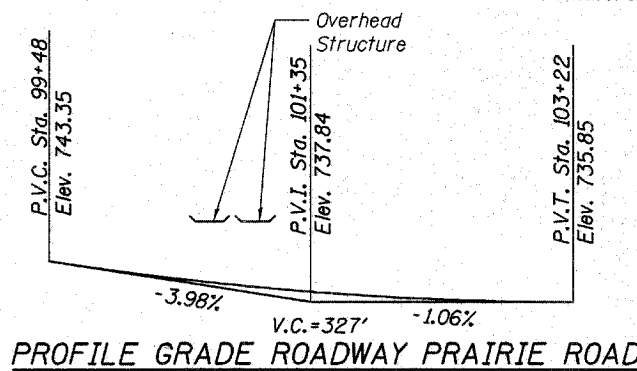
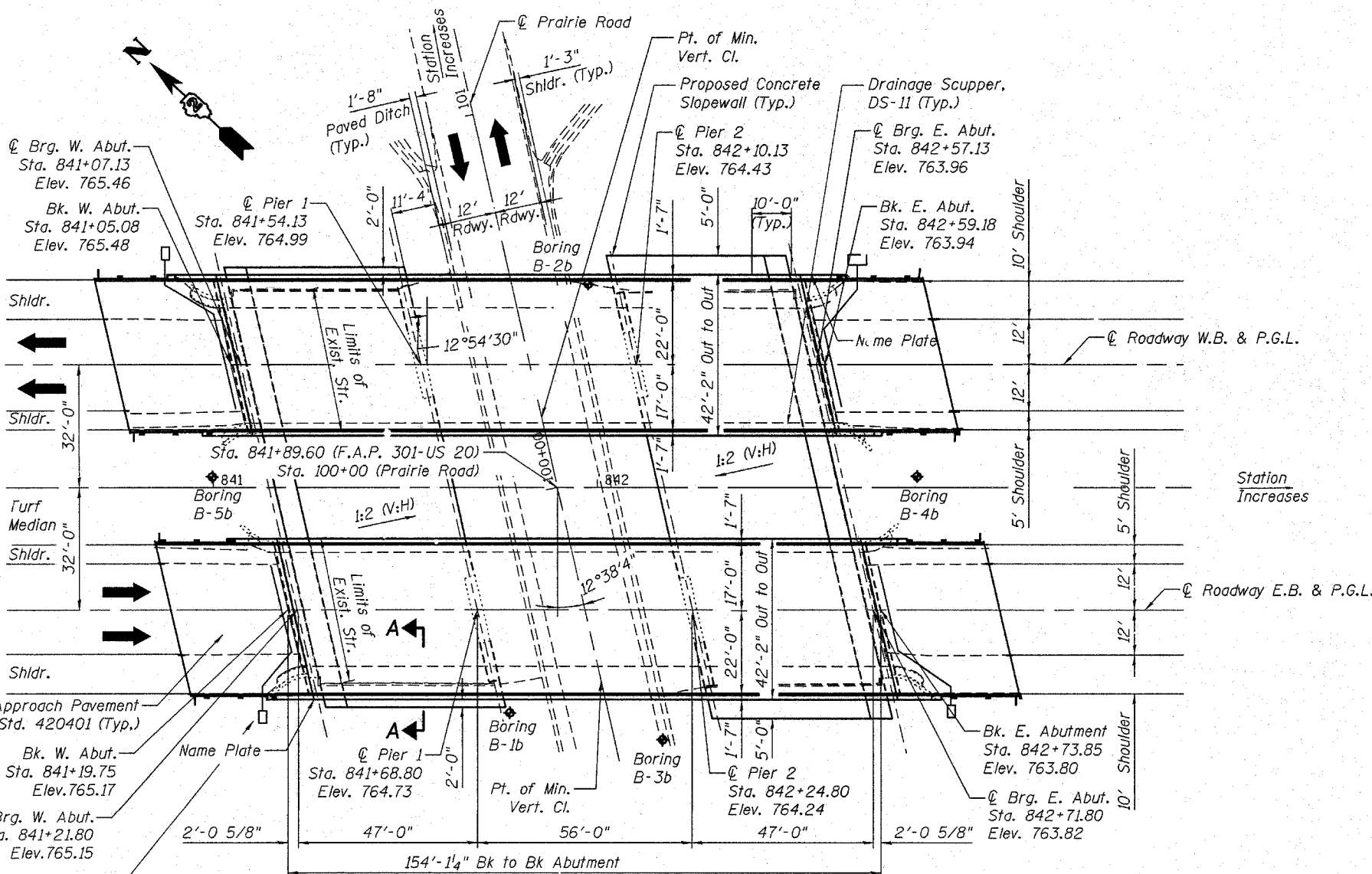
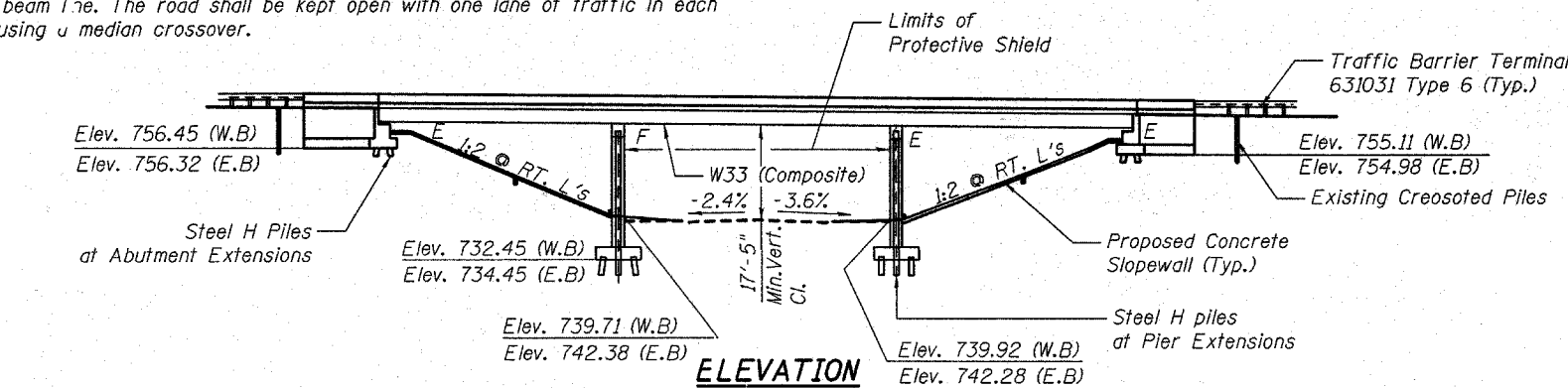

Underdrain Extension and Concrete Headwall for Pipedrain, pitch to Drain, Std. 601101 (Typ.)

DESIGNED	SSM
CHECKED	JLA
DRAWN	GYR
CHECKED	SSM

STATION 841+89.60
 REBUILT 2007 BY
 STATE OF ILLINOIS
 F.A.P. RT. 301 SEC. (2HB-2)D
 LOADING HS20
 STR. NO. 101-0051 (W.B.)

STATION 841+89.60
 REBUILT 2007 BY
 STATE OF ILLINOIS
 F.A.P. RT. 301 SEC. (2HB-2)D
 LOADING HS20
 STR. NO. 101-0052 (E.B.)

NAME PLATE
 See Std. 515001

NAME PLATE
 See Std. 515001

Note:
 Clean and relocate existing Name Plates adjacent to new Name Plates. Cost included with Name Plates.

GENERAL PLAN AND ELEVATION
 F.A.P. ROUTE 301 (US 20)
 OVER PRAIRIE ROAD
 SECTION (2HB-2)D
 WINNEBAGO COUNTY
 STATION 841+89.60
 STRUCTURE NO. 101-0051 (W.B.)
 STRUCTURE NO. 101-0052 (E.B.)