

STATE OF ILLINOIS
DEPARTMENT OF TRANSPORTATION

ROUTE NO.	SECTION	COUNTY	ISTH SHEETS	SHEET NO.	SHEET NO. 9 43 SHEETS
F.A.P. 301 (US 20)	(2HB -2)D	WINNEBAGO	107	31	
FED. ROAD DIST. NO. 7		ILLINOIS	FED. AID PROJECT-		

Contract #64B07

NORTH CURB LINE

Location	Station	Offset	Theoretical Grade Elevations
End W. Appr. Pav't.	840+85.85	-17.00	765.18
C	840+95.85	-17.00	765.10
D	841+05.85	-17.00	765.01
Bk. W. Abut.	841+15.85	-17.00	764.92

NORTH EDGE OF PAVEMENT

Location	Station	Offset	Theoretical Grade Elevations
End W. Appr. Pav't.	840+87.00	-12.00	765.28
C	840+97.00	-12.00	765.19
D	841+07.00	-12.00	765.10
Bk. W. Abut.	841+17.00	-12.00	765.01

☉ EB ROADWAY & PGL

Location	Station	Offset	Theoretical Grade Elevations
End W. Appr. Pav't.	840+89.75	0.00	765.44
C	840+99.75	0.00	765.35
D	841+09.75	0.00	765.26
Bk. W. Abut.	841+19.75	0.00	765.17

SOUTH EDGE OF PAVEMENT

Location	Station	Offset	Theoretical Grade Elevations
End W. Appr. Pav't.	840+92.50	12.00	765.22
C	841+02.50	12.00	765.13
D	841+12.50	12.00	765.04
Bk. W. Abut.	841+22.50	12.00	764.95

SOUTH CURB LINE

Location	Station	Offset	Theoretical Grade Elevations
End W. Appr. Pav't.	840+94.79	22.00	764.99
C	841+04.79	22.00	764.90
D	841+14.79	22.00	764.81
Bk. W. Abut.	841+24.79	22.00	764.72

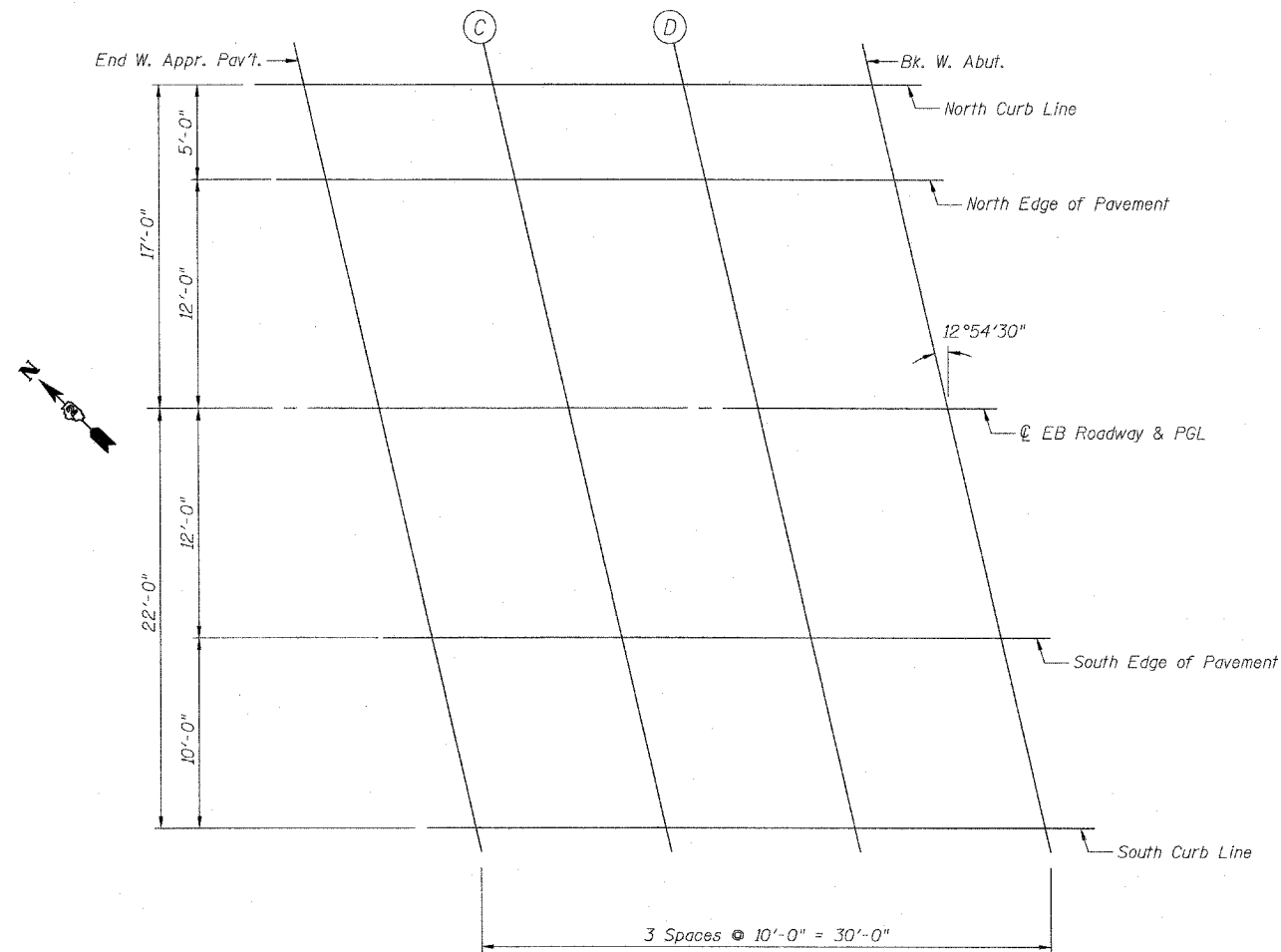

PLAN

DESIGNED	SSM
CHECKED	JLA
DRAWN	GYR
CHECKED	SSM

TOP OF SLAB ELEVATIONS
SOUTHWEST APPROACH
F.A.P. ROUTE 301 (US 20)
OVER PRAIRIE ROAD
SECTION (2HB-2)D
WINNEBAGO COUNTY
STATION 841+89.60
STRUCTURE NO. 101-0051 (W.B.)
STRUCTURE NO. 101-0052 (E.B.)