

F.A.P. RTE.	SECTION	COUNTY	TOTAL SHEETS	SHEET NO.
41	(14BR)MCHD	KANKAKEE	6	1
ILLINOIS				

CONTRACT NO. 66721

D-93-032-07

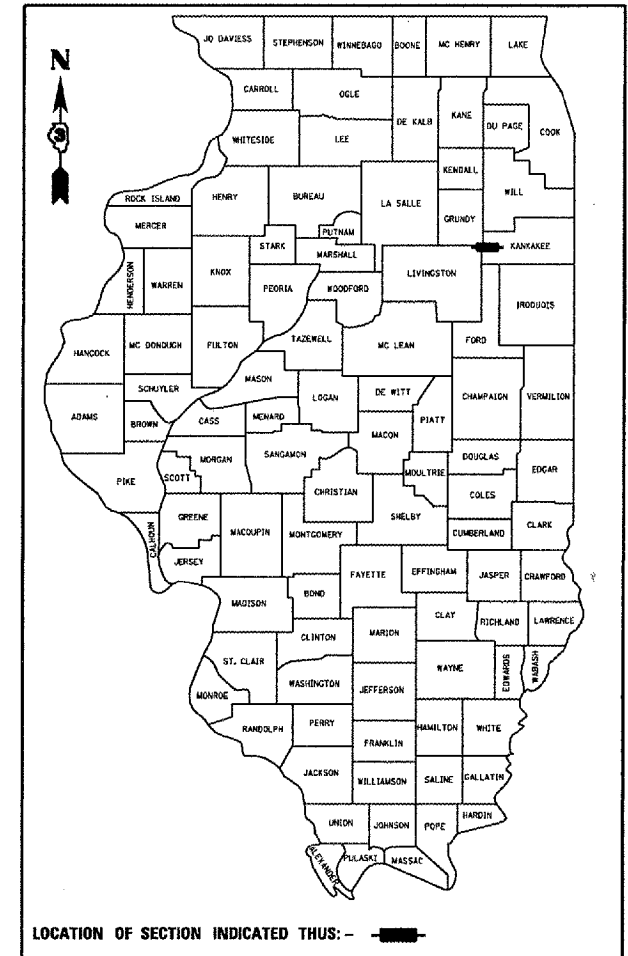

LOCATION OF SECTION INDICATED THUS: - [black bar] -

FUNCTIONAL CLASSIFICATION  
 RURAL - MINOR ARTERIAL  
 F.A.P. ROUTE 41 (IL 17)  
 2005 ADT = 2950  
 P.V. = 68.0% M.U. = 24.0% S.U. = 8.0%

STATE OF ILLINOIS  
 DEPARTMENT OF TRANSPORTATION  
 DIVISION OF HIGHWAYS

SUBMITTED 7/12/07  
*George F. [Signature]*  
 DEPUTY DIRECTOR OF HIGHWAYS, REGION ENGINEER

August 17, 2007  
*Eric E. [Signature]*  
 ENGINEER OF DESIGN AND ENVIRONMENT

August 17, 2007  
*Milton R. [Signature]*  
 DIRECTOR OF HIGHWAYS, CHIEF ENGINEER

PRINTED BY THE AUTHORITY  
 OF THE STATE OF ILLINOIS

STATE OF ILLINOIS  
 DEPARTMENT OF TRANSPORTATION  
 DIVISION OF HIGHWAYS

**PROPOSED  
 HIGHWAY PLANS**

FAP ROUTE 41 (IL 17)  
 SECTION (14BR)MCHD

KANKAKEE COUNTY  
 C-93-074-07  
 BRIDGE REPAIR

**PROJECT LOCATION**

SN 046-0132  
 FAP 41 (IL 17) OVER CRANE CREEK  
 2.0 MILES EAST OF REDDICK

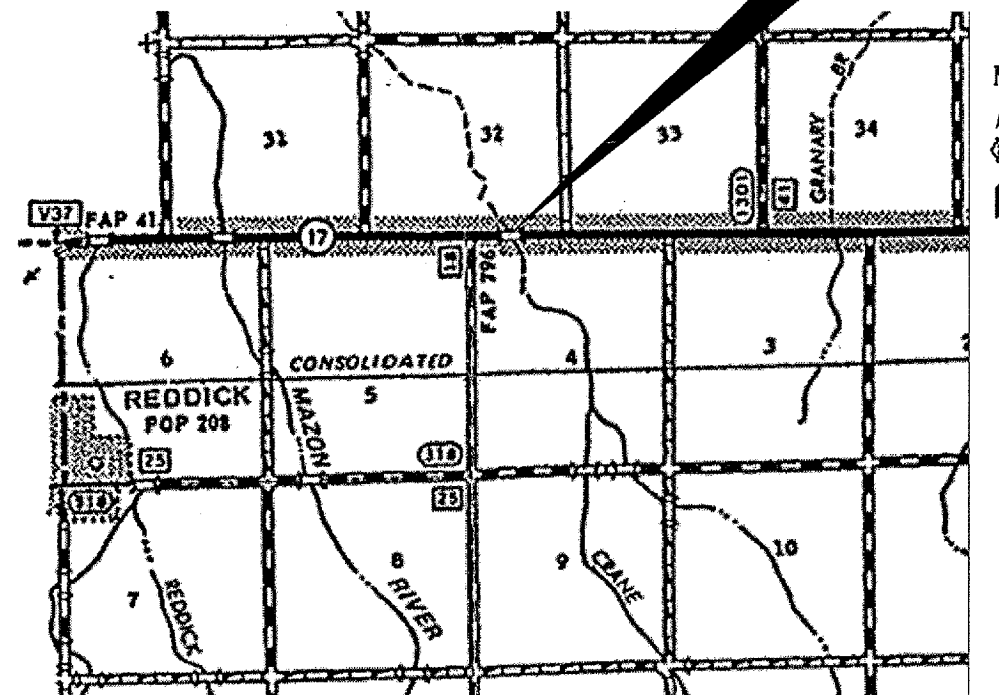

**LOCATION MAP**

NOT TO SCALE  
 POINT LOCATION

**INDEX OF SHEETS**

- COVER SHEET
- GENERAL NOTES
- SUMMARY OF QUANTITIES
- TYPICAL SECTION
- GENERAL PLAN AND ELEVATION
- PARAPET DETAILS

**STANDARDS**

- 000001-04 STANDARD SYMBOLS, ABBREVIATIONS AND PATTERNS
- 001001-01 AREAS OF REINFORCEMENT BARS
- 001006 DECIMAL OF AN INCH AND OF A FOOT
- 630001-07 STEEL PLATE BEAM GUARDRAIL, TYPE A
- 631031-06 TRAFFIC BARRIER TERMINAL, TYPE 6
- 635006-02 REFLECTOR AND TERMINAL MARKER PLACEMENT
- 635011-01 REFLECTOR MARKER AND MOUNTING DETAILS
- 701001-01 OFF-ROAD OPERATIONS 2L, 2W, MORE THAN 4.5 m (15') AWAY
- 701006-02 OFF-ROAD OPERATIONS 2L, 2W, 4.5 m (15') TO 600 mm (24") FROM PAVEMENT EDGE
- 701201-02 LANE CLOSURE, 2L, 2W, DAY ONLY, FOR SPEEDS ≥ 45 MPH
- 702001-06 TRAFFIC CONTROL DEVICES

MICROFILMED \_\_\_\_\_  
 REEL NUMBER \_\_\_\_\_  
 AWARDED \_\_\_\_\_  
 RESIDENT ENGINEER \_\_\_\_\_  
 AS BUILT CHANGES WERE MADE  
 ON THE FOLLOWING SHEETS \_\_\_\_\_

J.U.L.I.E.  
 JOINT UTILITY LOCATION INFORMATION FOR EXCAVATION  
 DIAL 811 OR 1-800-892-0123

DISTRICT 3 NO. (815) 434-6131

PROJECT ENGINEER: JOE KANNEL  
 UNIT CHIEF: RON WOODSHANK  
 TOWNSHIP: ESSEX

CONTRACT NO. 66721