

FAS RTG.	SECTION	COUNTY	TOTAL SHEETS	SHEET NO.
220	(23-BR) I	Mercer	50	11
STA. 99+71		TO STA. 109+76		
FED. ROAD DIST. NO. 1		ILLINOIS	FED. AID PROJECT	

MS. DEBRA ALVAREZ
1112 STATE HIGHWAY 94
ALEDO, IL 61231

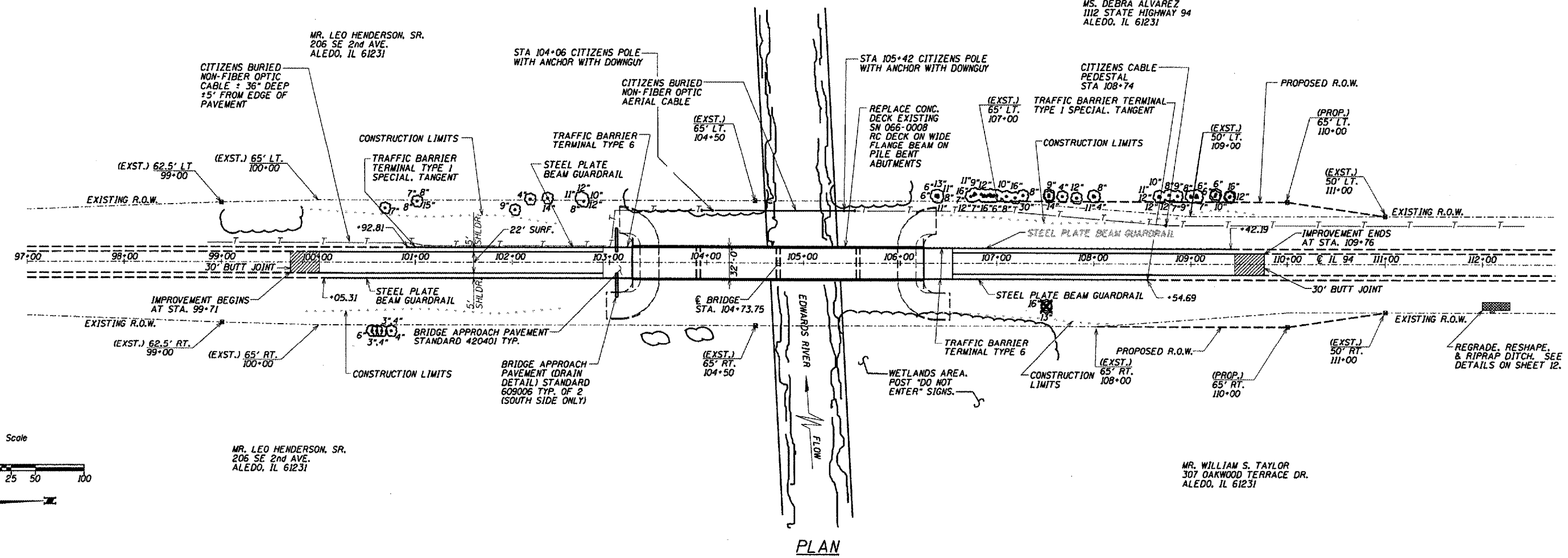

PLAN

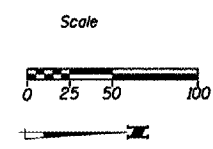

MR. LEO HENDERSON, SR.
206 SE 2nd AVE.
ALEDO, IL 61231

MR. WILLIAM S. TAYLOR
307 OAKWOOD TERRACE DR.
ALEDO, IL 61231

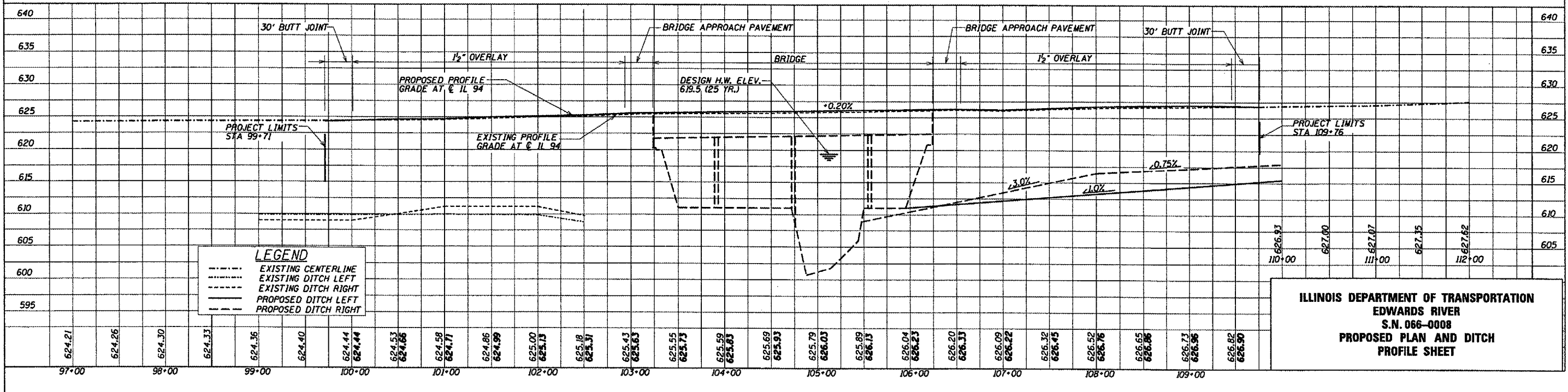

LEGEND

- EXISTING CENTERLINE
- - - EXISTING DITCH LEFT
- - - EXISTING DITCH RIGHT
- PROPOSED DITCH LEFT
- - - PROPOSED DITCH RIGHT

ILLINOIS DEPARTMENT OF TRANSPORTATION
EDWARDS RIVER
S.N. 066-0008
PROPOSED PLAN AND DITCH
PROFILE SHEET