

FAP RTE.	SECTION	COUNTY	TOTAL SHEETS	SHEET NO.
666	SP-Z, RS-4	SANGAMON	80	46
STA.		TO STA.		
FED. ROAD DIST. NO.		ILLINOIS FED. AID PROJECT		

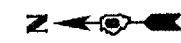
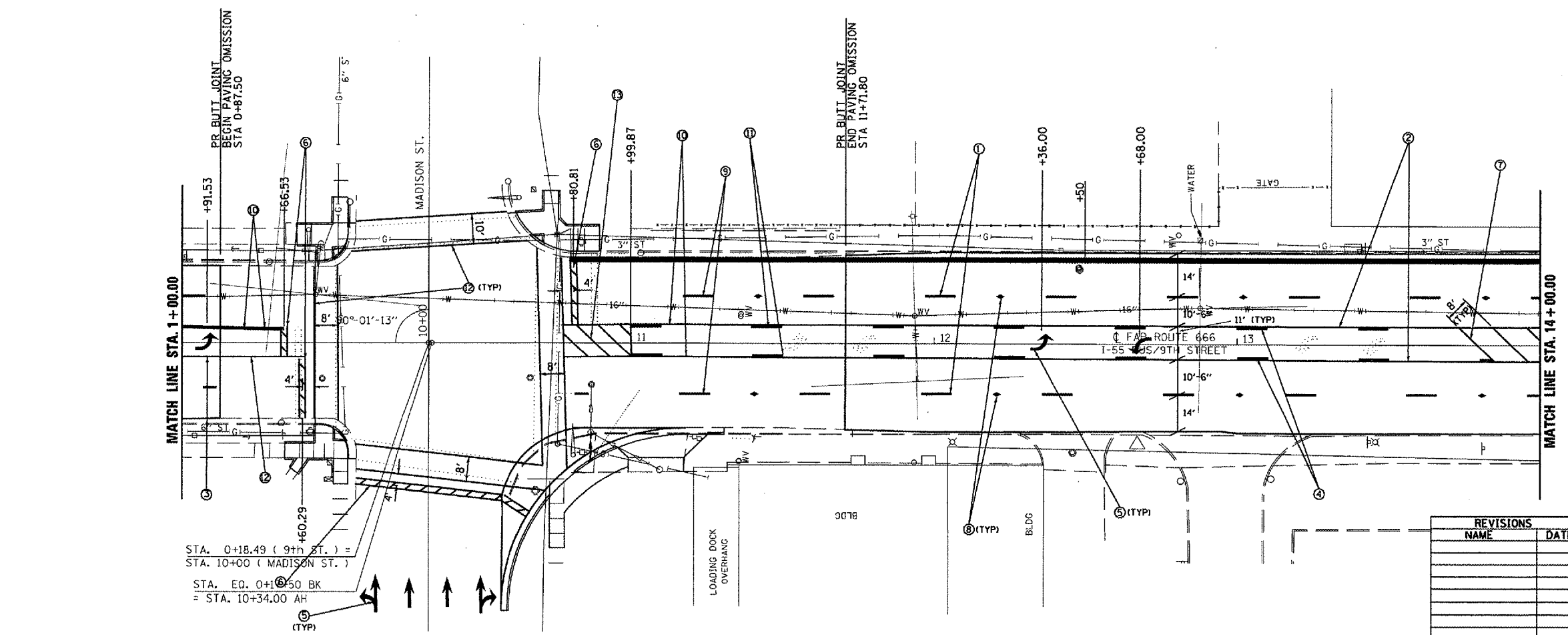
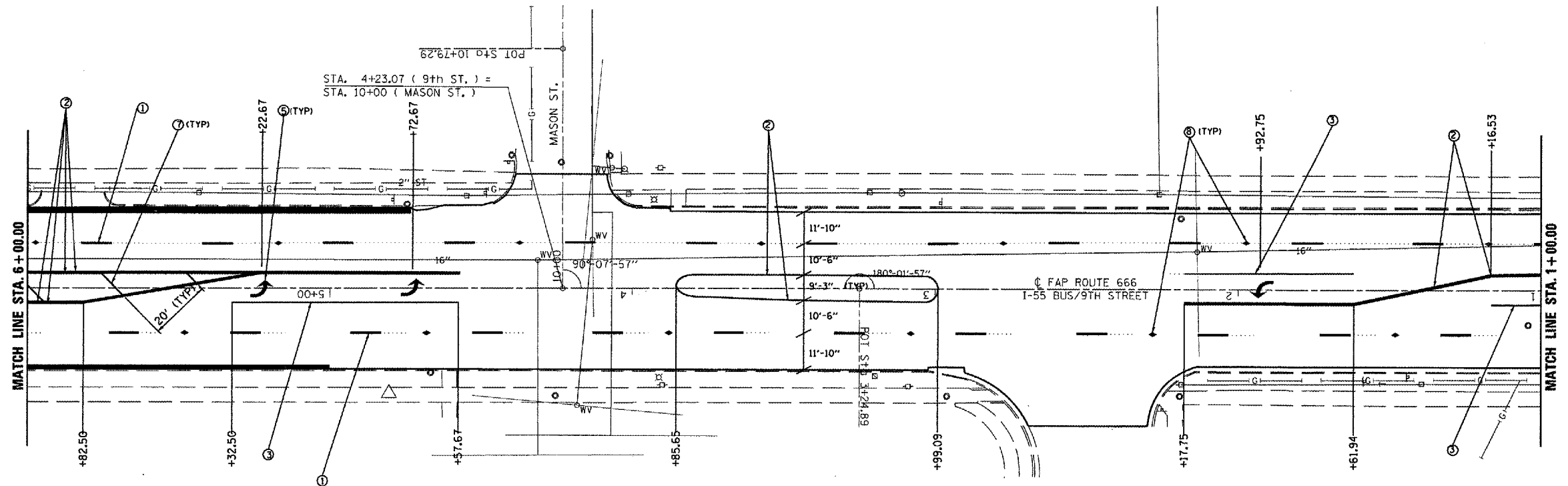

- PAVEMENT MARKING LEGEND**
- ① PR PPPM TY B (SKIP-DASH, WHITE, 5"
  - ② PR THERMOPLASTIC PM (SOLID, YELLOW, 5"
  - ③ PR PPPM TY B (SOLID, WHITE, 6"
  - ④ PR THERMOPLASTIC PM (SKIP-DASH, YELLOW, 5"
  - ⑤ PR PPPM TY B, LETTERS & SYMBOLS
  - ⑥ PR PPPM TY B (SOLID, WHITE, 24"
  - ⑦ PR THERMOPLASTIC PM (SOLID, YELLOW, 12"
  - ⑧ PR RAISED REFLECTIVE PAVEMENT MARKER
  - ⑨ PR POLYUREA PM TY I (SKIP-DASH, WHITE, 5"
  - ⑩ PR POLYUREA PM TY I (SOLID, YELLOW, 5"
  - ⑪ PR POLYUREA PM TY I (SKIP-DASH, YELLOW, 5"
  - ⑫ PR POLYUREA PM TY I (SOLID, WHITE, 6"
  - ⑬ PR POLYUREA PM TY I (SOLID, YELLOW, 12"

PR BUTT JOINT  
BEGIN PAVING OMISSION  
STA 0+87.50

PR BUTT JOINT  
END PAVING OMISSION  
STA 11+71.80

STA. 0+18.49 (9th ST.) =  
STA. 10+00 (MADISON ST.)

STA. EQ. 0+10.50 BK  
= STA. 10+34.00 AH

REVISIONS	
NAME	DATE

ILLINOIS DEPARTMENT OF TRANSPORTATION  
**PAVEMENT MARKING SHEET**  
FAP ROUTE 666 (I-55 BUS/9TH STREET)  
SECTION SP-Z, RS-4  
SANGAMON COUNTY  
**SHEET 6 OF 12**

SCALE: VERT. \_\_\_\_\_  
HORIZ. \_\_\_\_\_  
DATE \_\_\_\_\_ DRAWN BY \_\_\_\_\_  
CHECKED BY \_\_\_\_\_