

| F.A. RTE. | SECTION | COUNTY | TOTAL SHEETS | SHEET NO. |
|---------------------|-----------|-------------------|------------------|-----------|
| 7825 | (K-15D)BR | ADAMS | 31 | 11 |
| STA. 118+77.80 | | TO STA. 142+88.39 | | |
| FED. ROAD DIST. NO. | | ILLINOIS | FED. AID PROJECT | |

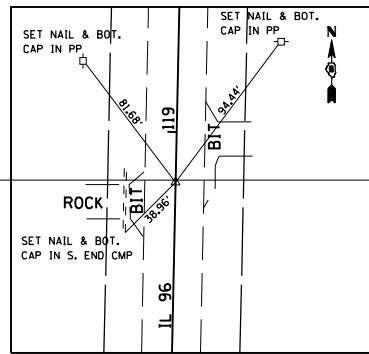

P.O.T. STA. 118+77.80
(SET P.K. NAIL & BOT. CAP IN CHSLD "X")

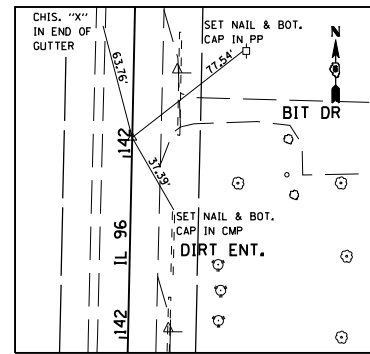

P.O.T. STA. 142+88.39
(SET P.K. NAIL & BOT. CAP IN CHSLD "X")

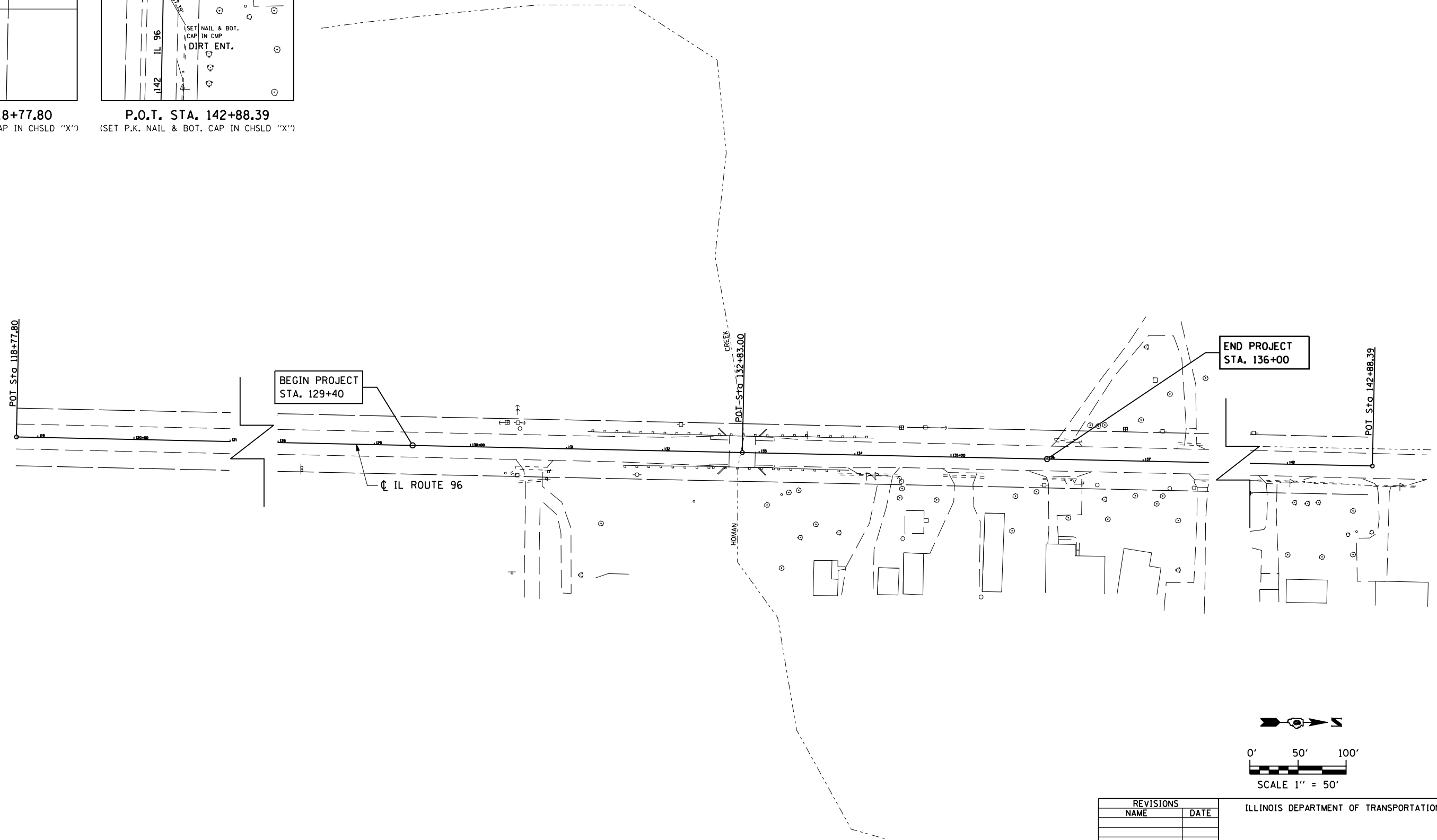

PLOT DATE = 6/29/2007
 FILE NAME = c:\projects\651686\hutchison\lma\2447-7a001.dgn
 PLOT SCALE = 1/85,8824 / IN.
 USER NAME = laughlin-1

BM TA-14: STA. 132+83
 CHISLED "□" AROUND HIGH POINT
 ON COARSE W. WALL, SN 001-0031
 ● SE CORNER
 ELEV. = 581.89

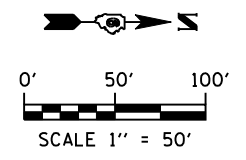

| REVISIONS | |
|-----------|------|
| NAME | DATE |
| | |
| | |
| | |
| | |
| | |
| | |
| | |
| | |
| | |
| | |

ILLINOIS DEPARTMENT OF TRANSPORTATION

ALIGNMENT AND TIES

DATE: 05/31/07

DRAWN BY JCW
 CHECKED BY JRB