

### LEGEND

- |  |   |
|--|---|
| <b>A</b> THERMOPLASTIC PAVEMENT MARKING LINE, 24" STOP BAR, WHITE  | <b>G</b> THERMOPLASTIC PAVEMENT MARKING LINE, 6" WHITE, CROSSWALK WIDTH 6" MIN.                                 |
| <b>B</b> THERMOPLASTIC PAVEMENT MARKING LINE, 6" 2' DASH, 6' SKIP, WHITE   | <b>H</b> THERMOPLASTIC PAVEMENT MARKING LETTERS & SYMBOLS   |
| <b>C</b> THERMOPLASTIC PAVEMENT MARKING LINE, 4" WHITE   | <b>I</b> THERMOPLASTIC PAVEMENT MARKING LINE, 4" 10" DASH, 30' SKIP, WHITE                                      |
| <b>D</b> THERMOPLASTIC PAVEMENT MARKING LINE, 6" WHITE   | <b>J</b> THERMOPLASTIC PAVEMENT MARKING LINE, 12" DIAGONAL 45°, 20' C-C OR A MINIMUM OF 5 EQUALLY SPACED, WHITE |
| <b>E</b> THERMOPLASTIC PAVEMENT MARKING LINE, 4" @ 11" C-C, DOUBLE YELLOW  | <b>K</b> THERMOPLASTIC PAVEMENT MARKING LINE, 8" WHITE  |
| <b>F</b> THERMOPLASTIC PAVEMENT MARKING LINE, 12" DIAGONAL 45°, 20' C-C OR A MINIMUM OF 5 EQUALLY SPACED, YELLOW | <b>INDICATES LOCATION OF DETECTABLE WARNING</b>   |

### REMOVAL LEGEND

- |  |
|--|
| <b>REM SP-1</b> REMOVE SIGN PANEL, TYPE 1      |
| <b>REM SA-A</b> REMOVE SIGN ASSEMBLY, TYPE A   |
| <b>REM SA-B</b> REMOVE SIGN ASSEMBLY, TYPE B   |
| <b>REL SP-1</b> RELOCATE SIGN PANEL, TYPE 1    |
| <b>REL SA-A</b> RELOCATE SIGN ASSEMBLY, TYPE A |
| <b>REL SA-B</b> RELOCATE SIGN ASSEMBLY, TYPE B |

NOTE:  
EXISTING SIGN PANELS TO BE SALVAGED SHALL BE DELIVERED TO THE CITY OF WAUKEGAN PUBLIC WORKS FACILITY.

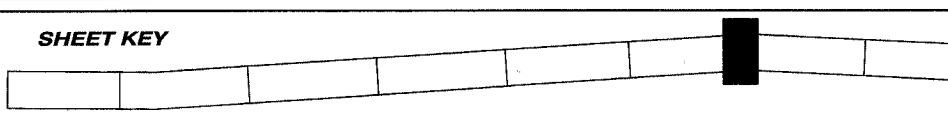
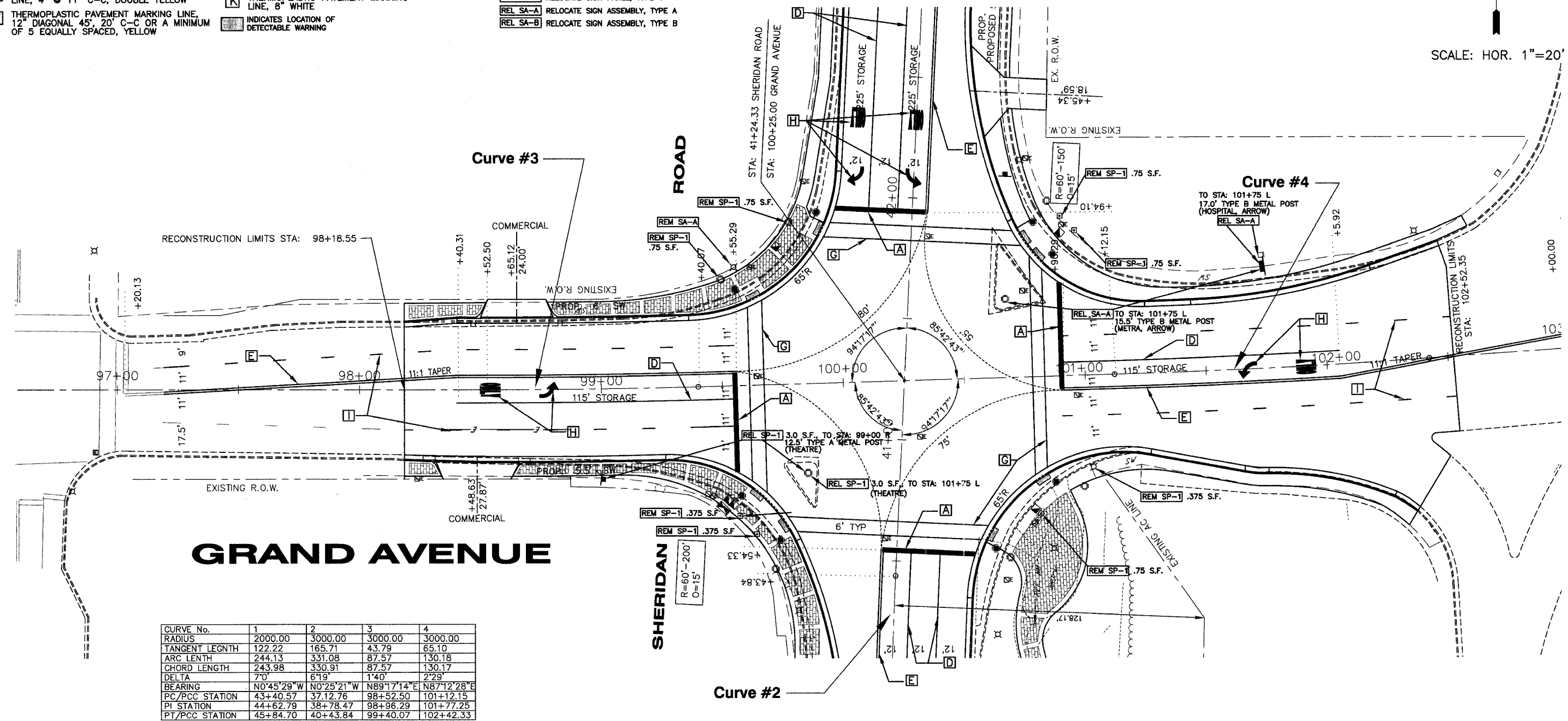
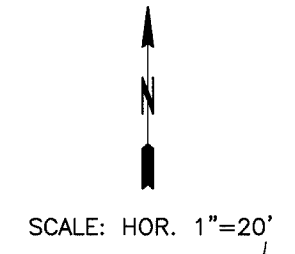

REVISIONS		
NO.	ITEM	DATE

SCALE: 1" = 20'  
 DRAWN BY: MS  
 CHECKED BY: DBD  
 DATE: 1-16-06

**McCLURE ENGINEERING ASSOCIATES, INC.**  
 2728 Grand Avenue  
 Waukegan, Illinois 60085  
 TEL 847-336-7100 FAX 847-336-7155  
 Design Firm License: Illinois #184-000816  
 Copyright 2004 by  
 McClure Engineering Associates, Inc.

**GEOMETRIC, STRIPING AND SIGNAGE PLAN**  
**SHERIDAN ROAD IMPROVEMENTS**  
 CITY OF WAUKEGAN JOB NUMBER: 02-28-04-164 LAKE COUNTY, ILLINOIS  
 W:\dwg\WK\SHERIDAN-RD\Sher-Striping.dwg 7/18/2006 9:49:01 AM CST

SHEET NO.  
**60**  
 of  
**122**