

BENCHMARK (WK1): COPPER DISK IN S.E. CORNER OF CONC. SIGNAL POST BASE AT S.W. CORNER OF SHERIDAN ROAD AND WASHINGTON STREET 4.55' S. OF BACK OF CURB, 10.4' E. OF THE CENTERLINE OF TRAFFIC HANDHOLE, 10' N.N.E. OF POST OF "CITY OF WAUKEGAN" SIGN. ELEV. 636.82

FAU RTE	SECTION	COUNTY	TOTAL SHEETS	SHEET NO.
2736	03-00227-00-RS	LAKE	122	62
F.H.W.A. REG.		ILLINOIS	PROJECT M-8003 (453)	
CONTRACT NO. 83829				

EXISTING STRUCTURE
NONE

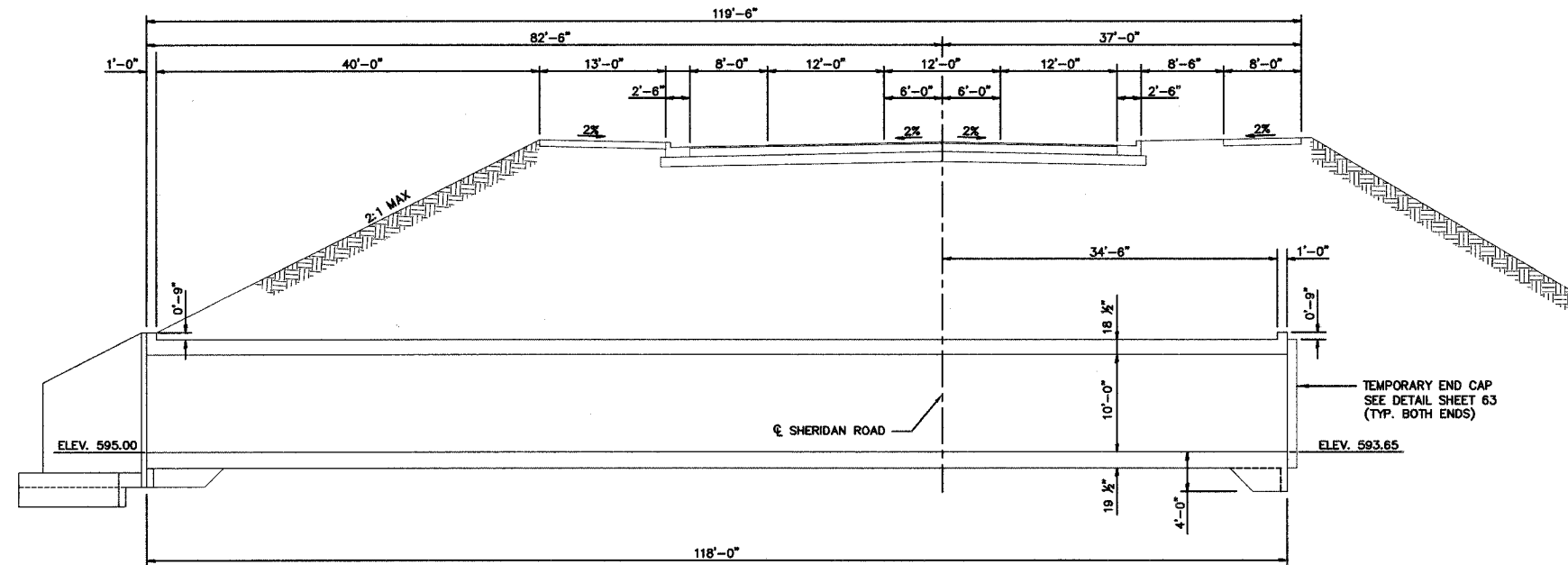

ELEVATION

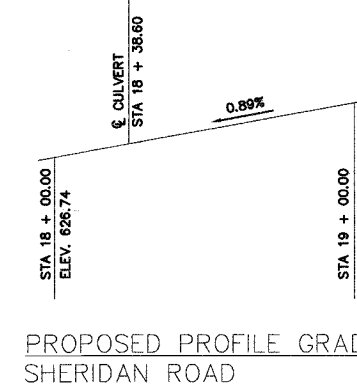

PROPOSED PROFILE GRADE
SHERIDAN ROAD

HIGHWAY CLASSIFICATION

SHERIDAN ROAD
ADT: 7300 (2005)
FUNCTIONAL CLASS: MINOR ARTERIAL
DESIGN SPEED: 35 MPH
POSTED SPEED: 30 MPH

DESIGN SPECIFICATIONS

2002 AASHTO STANDARD SPECIFICATIONS

DESIGN STRESSES

F'C = 3500 PSI
FY = 60,000 PSI (REINFORCEMENT)

SEISMIC DATA

SEISMIC PERFORMANCE CATEGORY (SPC) = A
BEDROCK ACCELERATION COEFFICIENT (A) = 0.039
SITE COEFFICIENT (S) = 1

LOADING HS20-44

GENERAL NOTES

- 1.) DRAWINGS SHALL NOT BE SCALED
- 2.) ALL CONSTRUCTION JOINTS SHALL BE BONDED.
- 3.) ALL EXPOSED EDGES SHALL HAVE A 3/4" X 45° CHAMFER, EXCEPT AS SHOWN OTHERWISE.
- 4.) ALL BACKFILL AND EMBANKMENT SHALL BE IN ACCORDANCE WITH THE STANDARD SPECIFICATIONS.
- 5.) PRIOR TO PLACING FOOTING CONCRETE FOR WINGWALLS THE SUB-GRADE SHALL BE INSPECTED BY A GEOTECHNICAL ENGINEER TO ENSURE THAT THE 2500 LBS/SQ-FT REQUIRED BEARING CAPACITY IS ACHIEVED. CONCRETE BOTTOM SLAB AND FOOTINGS SHALL NOT BE PLACED UNTIL THE SUBGRADE SOIL PREPARATION HAS BEEN INSPECTED AND APPROVED BY THE GEOTECHNICAL ENGINEER.
- 6.) PRECAST CONCRETE CULVERT SECTIONS OR PRECAST BRIDGE SECTIONS SUCH AS HY-SPAN MAY BE USED IN LIEU OF CAST-IN-PLACE WITH APPROVAL OF THE ENGINEER. DESIGN CALCULATIONS SIGNED AND SEALED BY AN ILLINOIS REGISTERED STRUCTURAL ENGINEER SHALL BE PROVIDED WITH PROPOSED PRECAST ALTERNATIVE.

INDEX OF SHEETS

- 62 GENERAL PLAN
- 63 BOX CULVERT DETAILS
- 64 BAR SPLICER ASSEMBLY DETAILS
- 65 BRACED EXCAVATION
- 66 BORING LOGS

TOTAL BILL OF MATERIAL

	UNIT	TOTAL
CONCRETE BOX CULVERTS	CU.YD.	399.7
REINFORCEMENT BARS	POUND	92,592
REINFORCEMENT BARS, EPOXY COATED	POUND	813
PIPE UNDERDRAINS FOR STRUCTURES, (4")	LIN. FT.	38
PIPE UNDERDRAINS FOR STRUCTURES, (6")	LIN. FT.	278
BAR SPLICERS	EACH	104
BRACED EXCAVATION	CU.YD.	3,247



I hereby certify that this engineering document was prepared by me or under my direct personal supervision and that I am a duly licensed Structural Engineer under the laws of the State of Illinois.

Ali A. Gharami 7/2/07
Ali A. Gharami, P.E., S.E.

Structural Engineer's License No. 081-005060

My license renewal date is November 30, 2008

Pages or sheets covered by this seal: 62-66

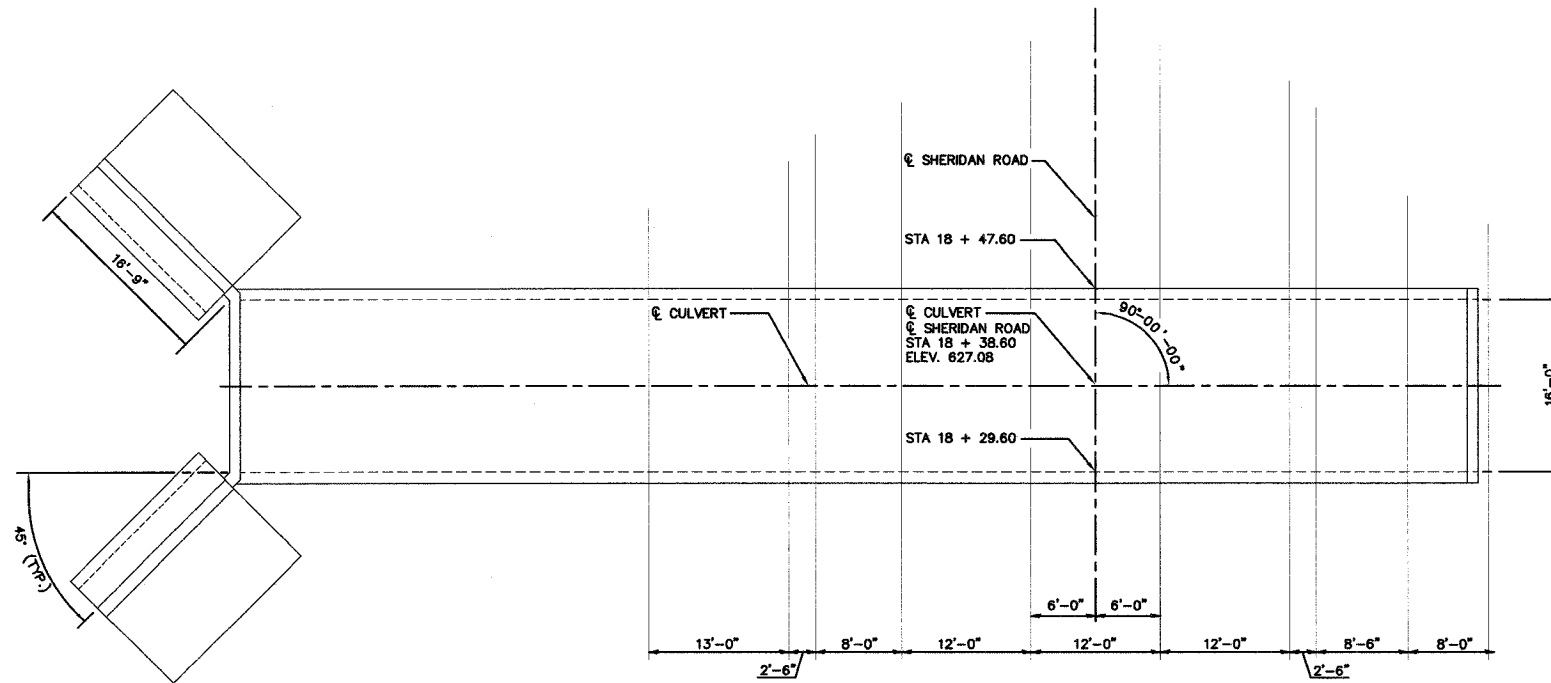

PLAN

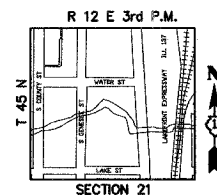

LOCATION SKETCH

SHEET KEY

REVISIONS		
NO.	ITEM	DATE

SCALE:	NTS
DRAWN BY:	CJP
CHECKED BY:	JIT
DATE:	1-16-06

McCLURE ENGINEERING ASSOCIATES, INC.
2728 Grand Avenue
Waukegan, Illinois 80385
TEL 847-336-7100 FAX 847-336-7155
Design Firm License: Illinois #184-000816
Copyright 2005 by McClure Engineering Associates, Inc.

GENERAL PLAN
SHERIDAN ROAD IMPROVEMENTS
CITY OF WAUKEGAN JOB NUMBER: 02-28-04-164 LAKE COUNTY, ILLINOIS

SHEET NO.
62
of
122