

ROUTE NO.	SECTION	COUNTY	TOTAL SHEETS	SHEET NO.
TR 251	*	IROQUOIS	18	18
STA. 61+50.00 TO STA. 62+50.00				
PROJECT BROS-075(130)			CONTRACT #87236	

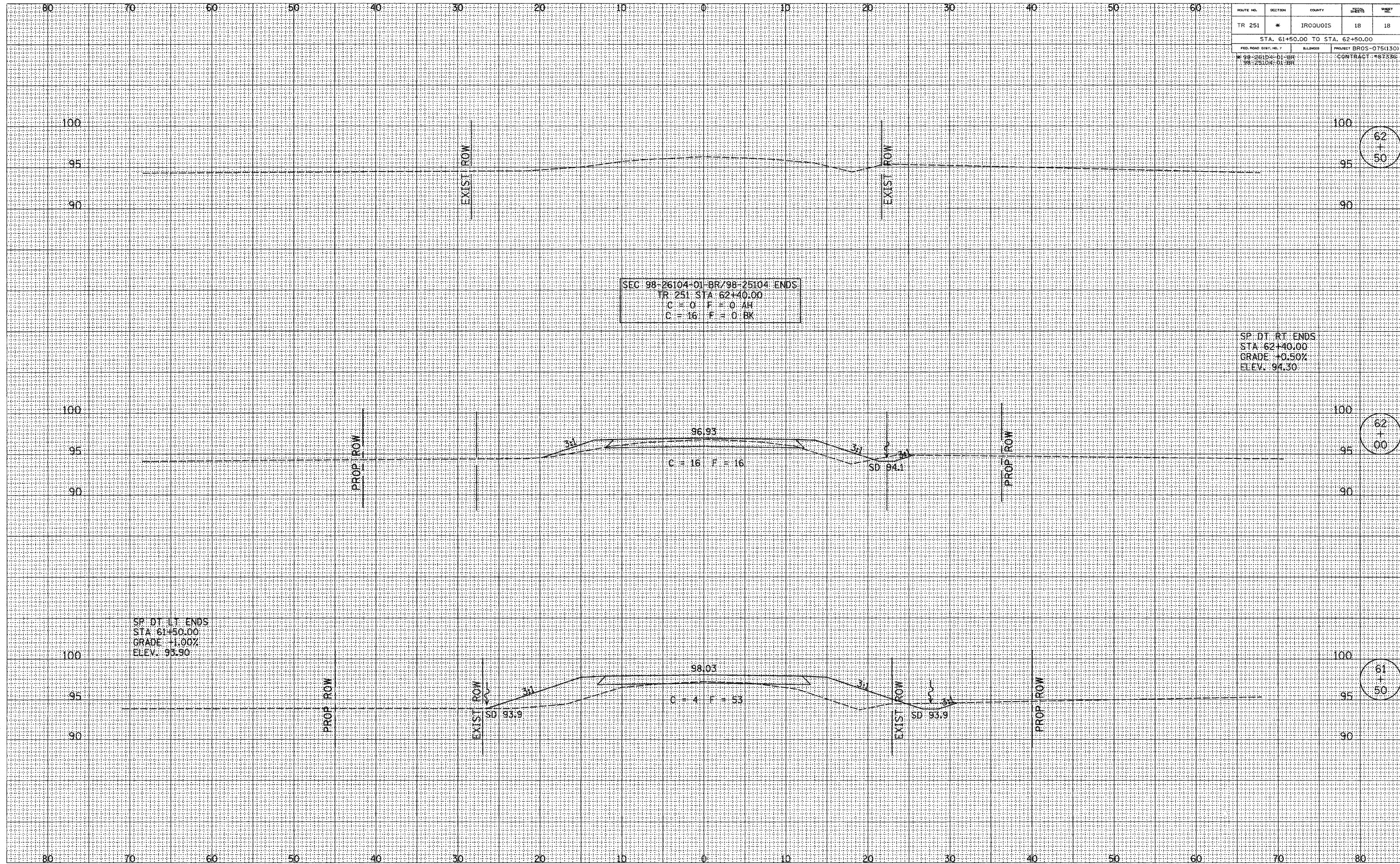

SEC 98-26104+01-BR/98-25104 ENDS
 TR 251 STA 62+40.00
 C = 0 F = 0 AH
 C = 16 F = 0 BK

SP DT RT ENDS
 STA 62+40.00
 GRADE +0.50%
 ELEV. 94.30

SP DT LT ENDS
 STA 61+50.00
 GRADE +1.00%
 ELEV. 93.90

62
+
50

62
+
00

61
+
50

NOTE BOOK TEMPLATE AREAS CHECKED

NOTE BOOK TEMPLATE AREAS CHECKED