

F.A.U. RTE.	SECTION	COUNTY	TOTAL SHEETS	SHEET NO.
6711	00-00164-00-SP	TAZEWELL	80	1
STA. TO STA.				
FED. ROAD DIST. NO.		ILLINOIS FED. AID PROJECT		

**INDEX OF SHEETS**

- 1 COVER SHEET
- 2-3 SUMMARY OF QUANTITIES
- 4 GENERAL NOTES
- 5-6 TYPICAL SECTIONS
- 7-12 SCHEDULE OF QUANTITIES
- 13-14 HORIZONTAL AND VERTICAL CONTROL
- 15-19 ROADWAY PLAN AND PROFILE
- 20-24 RIGHT-OF-WAY PLAN SHEETS
- 25-29 GEOMETRICS AND PAVEMENT GRADES
- 30-34 CONSTRUCTION DETAILS AND EROSION CONTROL
- 35-39 PAVEMENT MARKINGS
- 40-43 TRAFFIC SIGNAL PLANS
- 44-46 HIGHWAY LIGHTING PLANS
- 47-48 STORM SEWER PROFILES
- 49 CULVERT PROFILES
- 50-70 SPECIAL DETAILS
- 71-76 PARKWAY DRIVE CROSS SECTIONS
- 77-80 BROADWAY ROAD CROSS SECTIONS

**LIST OF STANDARDS**

- | NO.       | DESCRIPTION   |
|-----------|---|
| 00001-04  | STANDARD SYMBOLS, ABBREVIATIONS, AND PATTERNS   |
| 280001-03 | TEMPORARY EROSION CONTROL SYSTEMS   |
| 424001-04 | SIDEWALK RAMPS, ACCESSABLE TO THE DISABLED  |
| 442201-02 | CLASS C AND D PATCHES   |
| 542101-01 | REINFORCED CONCRETE END SECTIONS FOR PIPE CULVERTS 15" THRU 36" DIA. AT RIGHT ANGLES WITH ROADWAY |
| 542301-01 | PRECAST REINFORCED CONCRETE FLARED END SECTION  |
| 602301-01 | INLET-TYPE A  |
| 602401-01 | MANHOLE, TYPE A   |
| 602701-01 | MANHOLE STEPS   |
| 604001-02 | FRAME AND LIDS, TYPE 1  |
| 606001-03 | CONCRETE CURB TYPE B AND COMBINATION CONCRETE CURB AND GUTTER                                     |
| 701602-02 | URBAN LANE CLOSURE, MULTILANE, 2W WITH BIDIRECTIONAL LEFT TURN LANE                               |
| 701606-04 | URBAN LANE CLOSURE, MULTILANE, 2W WITH MOUNTABLE MEDIAN   |
| 701701-04 | URBAN LANE CLOSURE, MULTILANE INTERSECTION  |
| 701801-03 | LANE CLOSURE MULTILANE, 1W OR 2W CROSSWALK OR SIDEWALK CLOSURE                                    |
| 702001-06 | TRAFFIC CONTROL DEVICES   |
| 720016-01 | MAST ARM MOUNTED STREET NAME SIGNS  |
| 805001    | ELECTRICAL SERVICE INSTALLATION DETAILS   |
| 814001-01 | CONCRETE HANDHOLES  |
| 814006-01 | DOUBLE HANDHOLES  |
| 857001    | STANDARD PHASE DESIGNATION DIAGRAMS AND PHASE SEQUENCES   |
| 862001    | UNINTERRUPTABLE POWER SUPPLY (UPS)  |
| 873001    | TRAFFIC SIGNAL GROUNDING  |
| 877011-02 | STEEL COMBINATION MAST ARM ASSEMBLY AND POLE  |
| 878001-05 | CONCRETE FOUNDATION DETAILS   |
| 880001    | SPAN WIRE MOUNTED SIGNALS AND FLASHING BEACON INSTALLATION  |



**STATE OF ILLINOIS  
DEPARTMENT OF TRANSPORTATION**

**PLANS FOR  
PROPOSED LOCAL AGENCY IMPROVEMENT  
PROJECT: HS-M-6761(002)**

**F.A.U. ROUTE 6761 (BROADWAY ROAD)  
F.A.U. ROUTE 6711 (PARKWAY DRIVE)  
SECTION 00-00164-00-SP  
CITY OF PEKIN  
TAZEWELL COUNTY**

END PROJECT (PARKWAY DRIVE)  
STA. 42+00.00  
BEGIN PROJECT (BROADWAY ROAD)  
STA. 86+68.36

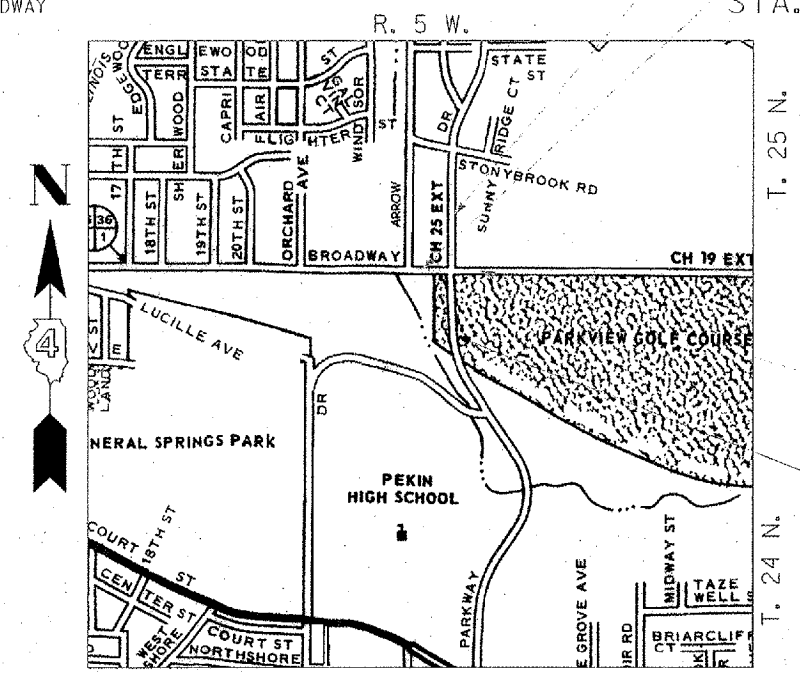
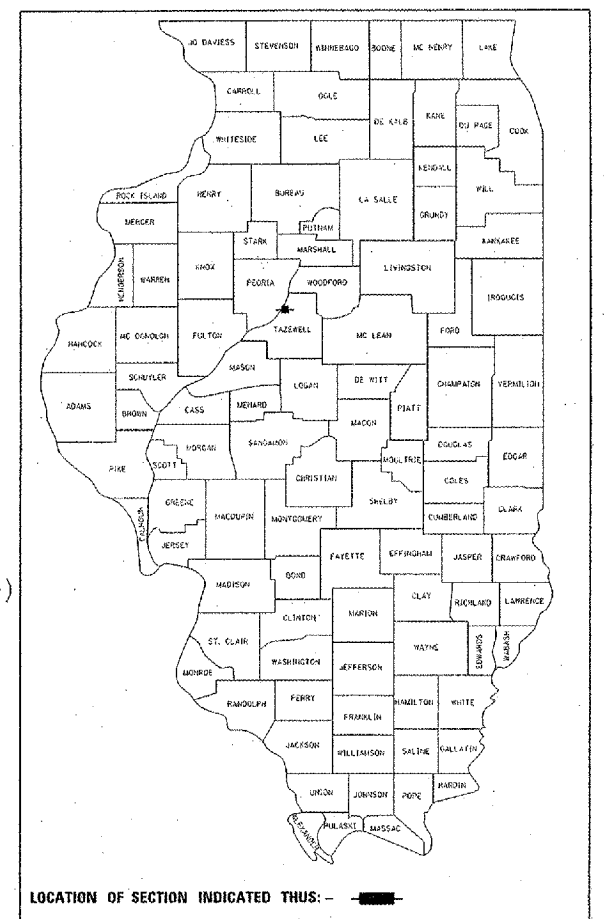

END PROJECT (BROADWAY ROAD)  
STA. 93+00.00  
BEGIN PROJECT (PARKWAY DRIVE)  
STA. 26+80.00

**ENGLISH RATIOS**

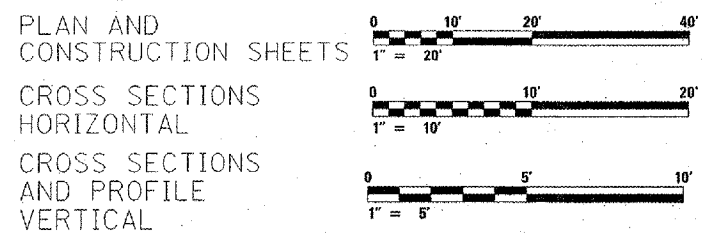

NPDES PERMIT IS NOT REQUIRED

FULL SIZE PLANS HAVE BEEN PREPARED USING STANDARD ENGINEERING SCALES  
REDUCED SIZED PLANS WILL NOT CONFORM TO STANDARD SCALES. IN MAKING  
MEASUREMENTS ON REDUCED PLANS, THE ABOVE SCALES MAY BE USED.

UTILITIES ARE SHOWN FOR INFORMATIONAL PURPOSES ONLY. CALL  
J.U.L.E. JOINT UTILITY LOCATION INFORMATION PRIOR TO  
EXCAVATION AT 1-800-892-0123.

**CONTRACT NO. 89318  
JOB NO. C-94-115-01**

LENGTH OF PROJECT: BROADWAY ROAD = 631.64 FEET = 0.120 MILES  
PARKWAY DRIVE = 1520 FEET = 0.288 MILES  
TOTAL GROSS & NET LENGTH OF PROJECT = 2151.64 FEET = 0.408 MILES

ROADWAY CLASSIFICATION - MINOR ARTERIAL (BROADWAY ROAD & PARKWAY DRIVE)  
2002 A.D.T. = 33,900 (BROADWAY ROAD)  
2002 A.D.T. = 42,100 (PARKWAY DRIVE)  
DESIGN GUIDELINES - URBAN  
DESIGN SPEED - 35 M.P.H. (35 M.P.H. POSTED)  
DESIGN VARIANCES  
20' RADIUS RETURN FOR ARROW DRIVE  
6' SIDEWALKS IN COMMERCIAL AREA

**PLANS PREPARED BY:**

**MAURER-STUTZ, INC.**  
ENGINEERS SURVEYORS

ROBERT A. WEBER III, P.E. #062-058062  
LICENSED PROFESSIONAL ENGINEER  
LICENCE EXPIRES: 11/30/2007

DATE: July 12, 2007

**CITY OF PEKIN  
DEPARTMENT OF PUBLIC WORKS**

DATE OF APPROVAL: July 12, 2007  
*Joseph W. Wallace*  
DIRECTOR OF PUBLIC WORKS

**STATE OF ILLINOIS  
DEPARTMENT OF TRANSPORTATION  
DIVISION OF HIGHWAYS**

PASSED: July 12, 2007  
*John Wallace*  
DISTRICT ENGINEER OF LOCAL ROADS AND STREETS

RELEASED FOR BID BASED ON LIMITED REVIEW: July 12, 2007  
*John Wallace*  
DEPUTY DIRECTOR OF HIGHWAYS, REGION THREE ENGINEER