

F.A.U. RTE.	SECTION	COUNTY	TOTAL SHEETS	SHEET NO.
6711	00-00164-00-SP	TAZEWELL	80	25
STA. 27+47.50		TO STA. 32+00.00		
FED. ROAD DIST. NO.		ILLINOIS	FED. AID PROJECT	

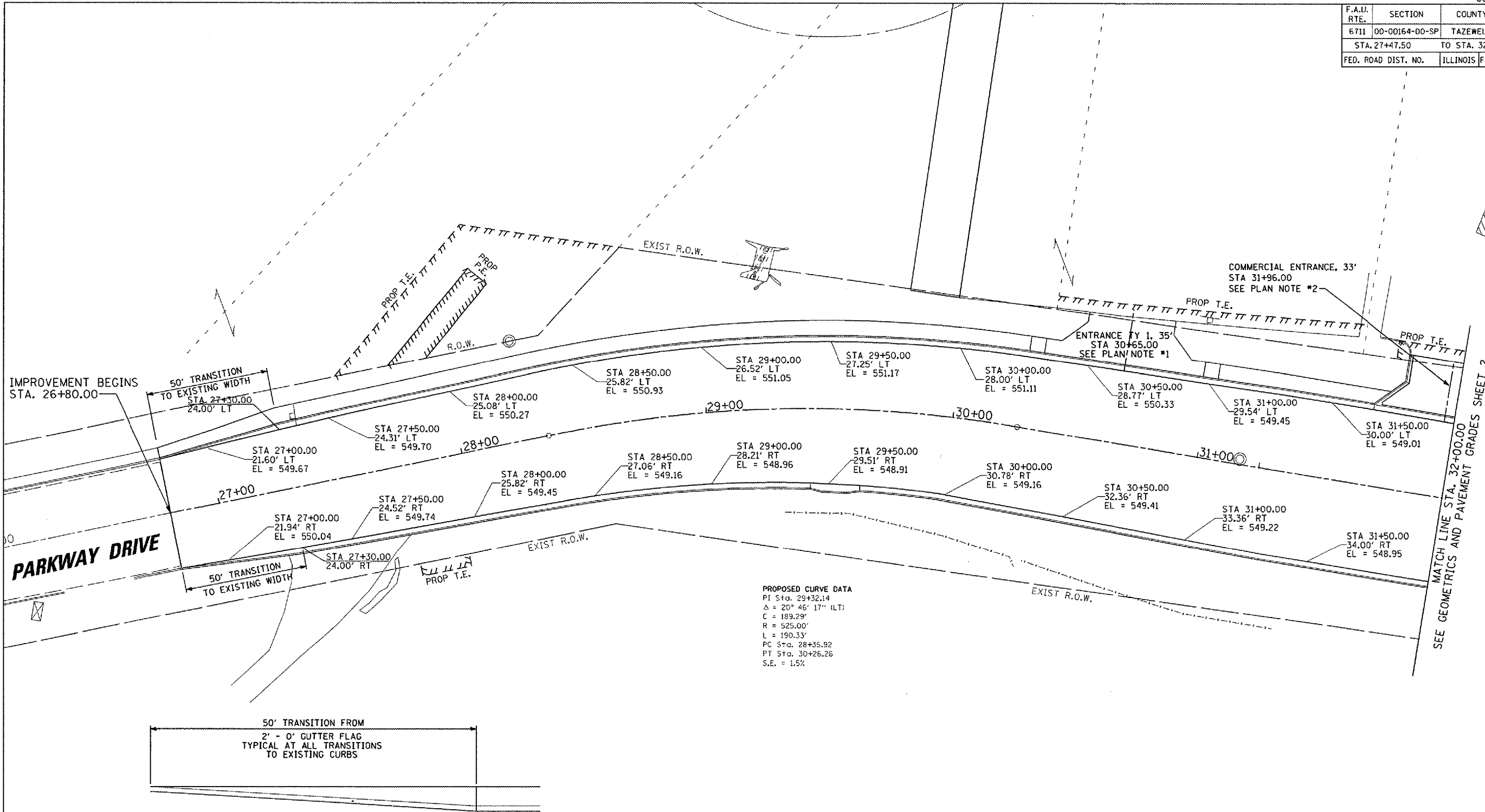

**PROPOSED CURVE DATA**  
 PI Sta. 29+32.14  
 $\Delta = 20^\circ 46' 17''$  (LT)  
 C = 189.29'  
 R = 525.00'  
 L = 190.33'  
 PC Sta. 28+35.92  
 PT Sta. 30+26.26  
 S.E. = 1.5%

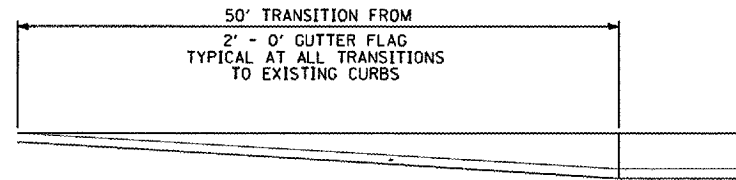

NOTES: 1. ENTRANCE TYPE 1 DENOTES URBAN ENTRANCES, ACCESSIBLE TO THE DISABLED, FOR CURBLINE SIDEWALKS - SEE SPECIAL DETAILS  
 2. FOR COMMERCIAL ENTRANCE, SEE DETAIL ON GEOMETRICS AND PAVEMENT GRADES, SHEET 2

