

F.A.U. RTE.	SECTION	COUNTY	TOTAL SHEETS	SHEET NO.
8419	99-00048-01-PV	FAYETTE	142	52

STA. TO STA.
 FED. ROAD DIST. NO. ILLINOIS FED. AID PROJECT
 CONTRACT NO. 95500 REVISED 4-13-07

INLETS, TY A, TY 3 F&G
 STA 606+44, 27.72' LT
 GRATE EL 504.12
 PIPE INV EL 500.12
 S S CL A, TY 2 12",
 3 FT

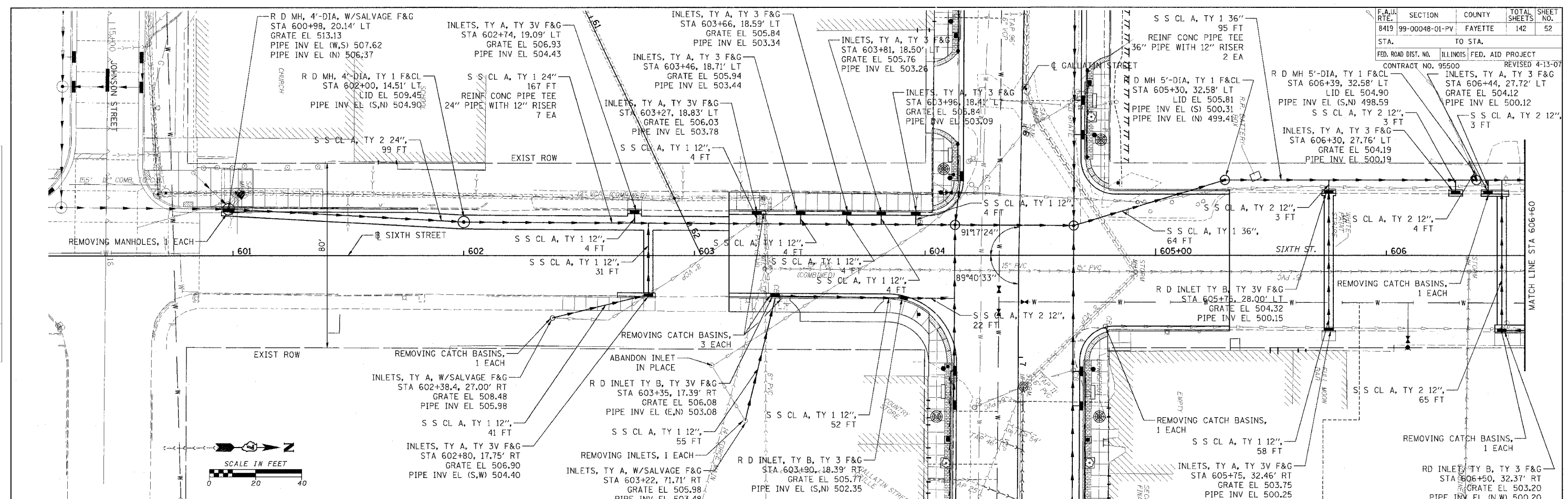

ABBREVIATIONS

S S CL A, TY 1	= STORM SEWERS CLASS A, TYPE 1
S S CL A, TY 2	= STORM SEWERS CLASS A, TYPE 2
INLETS, TY A, TY 3V F&G	= INLETS, TYPE A, TYPE 3V FRAME AND GRATE
INLETS, TY B, TY 3V F&G	= INLETS, TYPE B, TYPE 3V FRAME AND GRATE
INLETS, TY A, W/SALVAGE F&G	= INLETS, TYPE A, WITH SALVAGE FRAME AND GRATE
R D INLET TY B, TY 3V F&G	= RESTRICTED DEPTH INLET TYPE B, TYPE 3V FRAME AND GRATE
R D INLET TY B, TY 1 F&CL	= RESTRICTED DEPTH INLET TYPE B, TYPE 1 FRAME AND CLOSED LID
R D MH, 4'-DIA, TY 1 F&CL	= RESTRICTED DEPTH MANHOLE, 4'-DIAMETER, TYPE 1 FRAME AND CLOSED LID
R D MH, 5'-DIA, TY 1 F&CL	= RESTRICTED DEPTH MANHOLE, 5'-DIAMETER, TYPE 1 FRAME AND CLOSED LID
R D MH, 4'-DIA, W/SALVAGE F&G	= RESTRICTED DEPTH MANHOLE, 4'-DIAMETER, WITH SALVAGE FRAME AND GRATE

LEGEND

	PROPOSED SEWER
	PROPOSED MANHOLE
	PROPOSED INLET

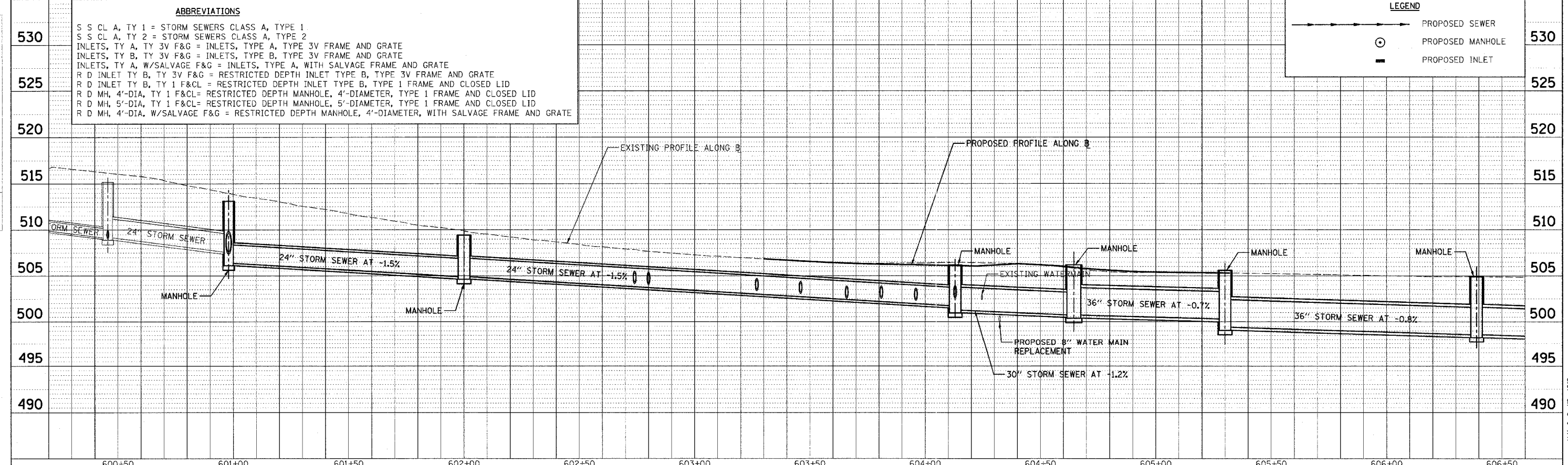

PLAN
 SURVEYED
 ALIGNED
 CHECKED
 DATE
 BY

PROFILE
 SURVEYED
 ALIGNED
 CHECKED
 DATE
 BY

CADD FILE: 14812.sss_Sixth_04.dgn
 PLOTTED: 5/9/2007