

ROUTE	SECTION	COUNTY	TOTAL SHEETS	SHEET NO.
T.R. 206	05-02121-00-BR	JASPER	13	4
CONTRACT NO. 95511		ILLINOIS	PROJECT BROS-079(134)	

GENERAL NOTES

- See Special Provisions for boring logs.
- Channel Excavation: This material shall be excavated as shown within the limits of the proposed bridge then tapered to the existing channel at the Roadway R.O.W. It is estimated that 50% of the Channel Excavation will be suitable for use in the embankment. Unsuitable material shall be disposed of by the Contractor.
- The Contractor shall drive 1 test pile as specified in Bent #2 before ordering the remaining piles. The test pile shall be driven to 110% of the Nominal Required Bearing indicated in the pile data information.
- The Steel H-Piles shall be according to AASHTO M270 Grade 50.

TOTAL BILL OF MATERIAL

Item	Unit	Super	Sub.		Total
			Piers	Abuts.	
Removal of Existing Structures	Each				1
Concrete Structures	Cu.Yds.			24.8	24.8
Precast Prestressed Concrete Deck Beams (33" Depth)	Sq.Ft.	2025			2025
Steel Railing, Type S-1	Foot	150			150
Reinforcement Bars	Pound			2980	2980
Furnishing Steel Piles HP 10 X 42	Foot			315	315
Driving Steel Piles	Foot			315	315
Test Pile Steel HP 10 X 42	Each			1	1
Name Plates	Each			1	1
Concrete Encasement	Cu.Yds.			2.6	2.6
Aggregate Base Course, Type B	Tons			60	60
Stone Dumped Riprap, Class A-4	Tons			260	260
Channel Excavation	Cu.Yds.			280	280
Fence (Erosion Control)	Foot			280	280

INDEX OF SHEETS

- GENERAL PLAN & ELEVATION
- STANDARD CS-2733-75L
- STANDARD CB-2733-36
- STANDARD CA-2733-30
- STANDARD CR-TS1
- STANDARD CN
- STANDARD CX-1

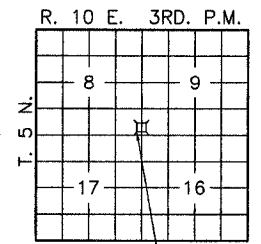

LOCATION SKETCH

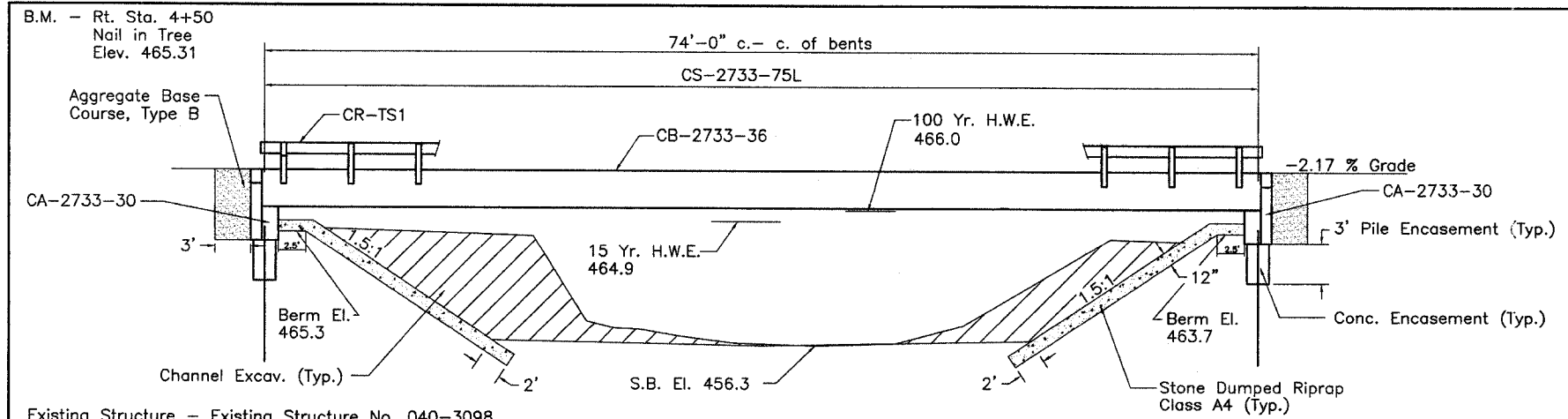

ELEVATION

Existing Structure - Existing Structure No. 040-3098
Single Span Concrete Beam Bridge
42' Bk. - Bk. Abuts.
Closed Concrete Abutments
16' Concrete Deck

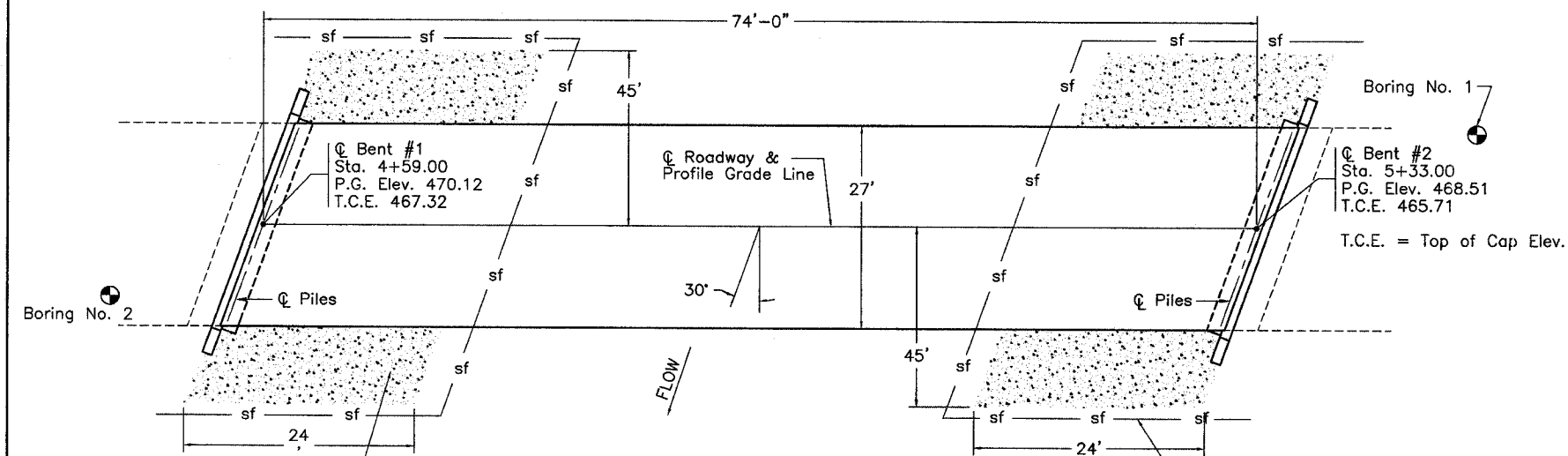

PLAN

Salvage - Any material deemed salvageable by the Engineer shall be stockpiled on the R.O.W. and shall become the property of the Fox Road District Commissioner. The Contractor shall dispose of all remaining material.

PILE DATA (2-ABUTS.)

Type:	HP 10 X 42
Nominal Required Bearing:	335 Kips
Allowable Resistance Available:	82 Kips
Estimated Length:	35'
Number Required:	10 Includes 1 Test Pile in Bent #2

STATION 4+96.00
RICHLAND CREEK
SEC. 05-02121-00-BR BUILT 200
JASPER COUNTY
PROJECT BROS-079(134)
LOADING HS20
STR. NO. 040-3255

LETTERING FOR NAME PLATE

Locate Name Plate at S.W. corner of Bridge (See Std. CN)

DESIGN SPECIFICATIONS

2002 AASHTO Standard Specifications - 17th ed.

LOADING HS20-44

Allow 25#/sq. ft. for future wearing surface

SEISMIC DATA

Seismic Performance Category (SPC) = A
Bedrock Acceleration Coefficient (A) = 7.5% g
Site Coefficient (S) =

WATERWAY INFORMATION

Drainage Area = 4.6 Sq. Mi.		Low Grade Elev. = 464.95 @ Sta. 7+50				
Flood	Freq. Yr.	Q ft ³ /s	Opening ft ²	Nat. H.W.E.	Head - ft	Headwater
Design	15	1095	261	464.9	0.3	0.1
Base	100	1790	261	466.0	0.2	0.1
Overtopping						
Max. Calc.	500					

GENERAL PLAN & ELEVATION

T.R. ROUTE 206
OVER RICHLAND CREEK
SECTION 05-02121-00-BR
JASPER COUNTY
STATION 4+96.00