

| F.A. RTE. | SECTION | COUNTY | TOTAL SHEETS | SHEET NO. |
|-----------|----------------|---------|--------------|-----------|
| | 06-00026-01-MS | MADISON | 43 | 28 |

FEDERAL AID PROJECT
KEYED NOTES:

- 1 SEE FOUNTAIN DETAILS ON SHEET PA3-04.
 - 2 COMPASS FOUNTAIN/WATERFALL FOUNTAIN CONTROLLER SHALL BE UL LISTED, NEMA 3R, WITH SINGLE POINT ELECTRICAL CONNECTION. CONTROLLER SHALL INCLUDE THE FOLLOWING:
 - *HAND-OFF-AUTO SWITCH (ONE FOR EACH FILTER/PUMP ASSEMBLY (FP-1, FP-2))
 - *TIMER FOR EACH SYSTEM
 - *INTERNAL BREAKERS
 - *LOW VOLTAGE TRANSFORMER FOR CONTROLS
 - *MICRO PROCESSOR FOR OPERATION
- SEE ELECTRICAL FOR SERVICE FEEDER AND PANEL.

211 N. Broadway
Suite 1100
St. Louis, MO 63102
PH: 314-241-9118
FAX: 314-241-9128

KAI

PHASE 2A
LEWIS AND CLARK MEMORIAL TOWER
VILLAGE OF HARTFORD, ILLINOIS
HARTFORD, ILLINOIS 62049

SHEET TITLE:
**FIRST FLOOR PLAN-
FOUNTAIN PIPING-
PLUMBING**

| REV. NO. | REMARKS | DATE |
|----------|---------|------|
| | | |
| | | |
| | | |

KENNEDY PROJECT NO
KAI# 10-02048

ISSUE DATE
12-JULY-05

SHEET NO

PA3-03

© 2005 KENNEDY ASSOCIATES INCORPORATED

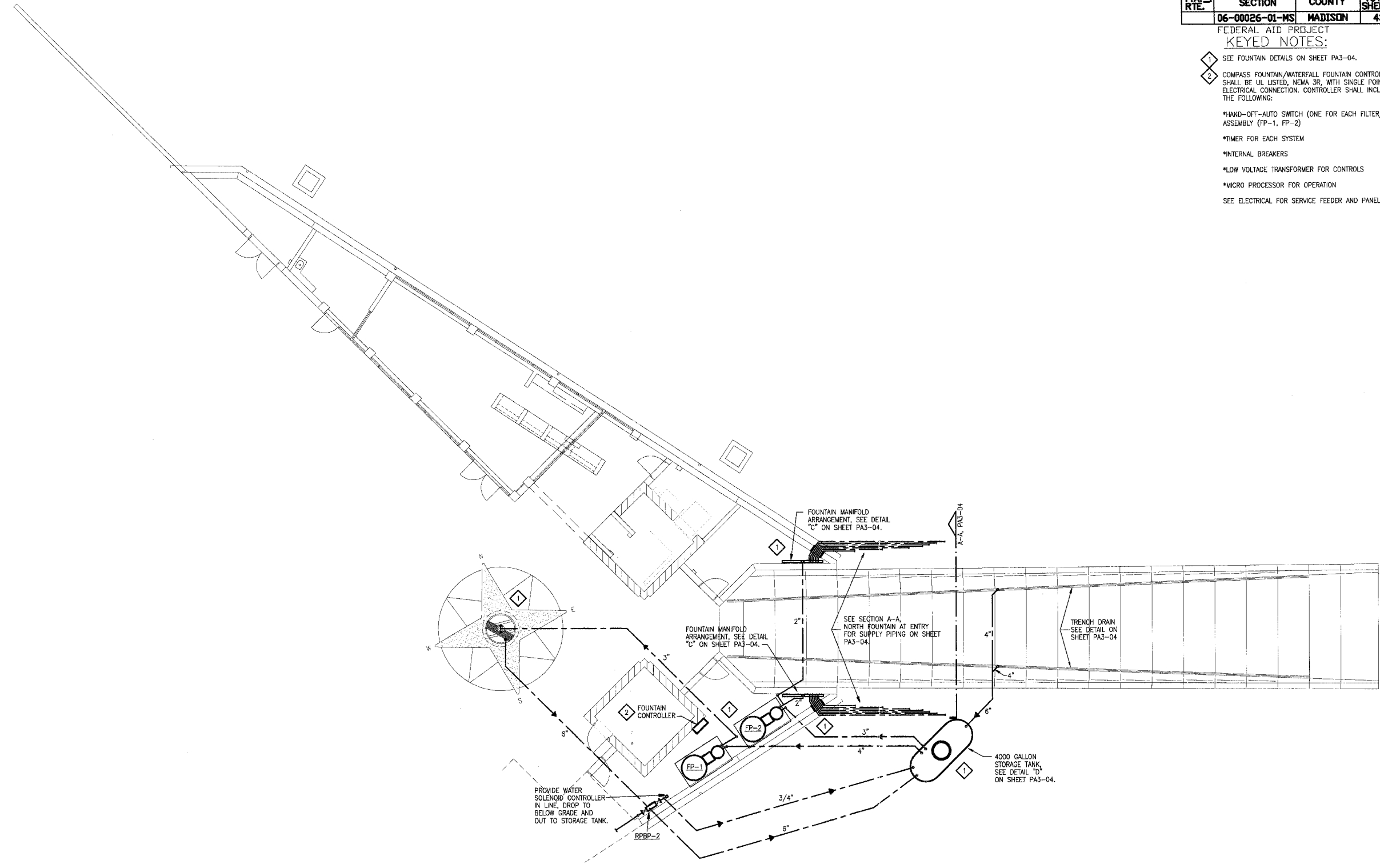

A FIRST FLOOR PLAN-FOUNTAIN PIPING- PLUMBING
1/8"=1'-0"