

F.A. RTE.	SECTION	COUNTY	TOTAL SHEETS	SHEET NO.
57/64	(41-3)HKB	JEFFERSON	518	117
STA.		TO STA.		
FED. ROAD DIST. NO.		ILLINOIS FED. AID PROJECT		

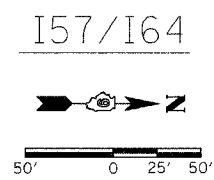
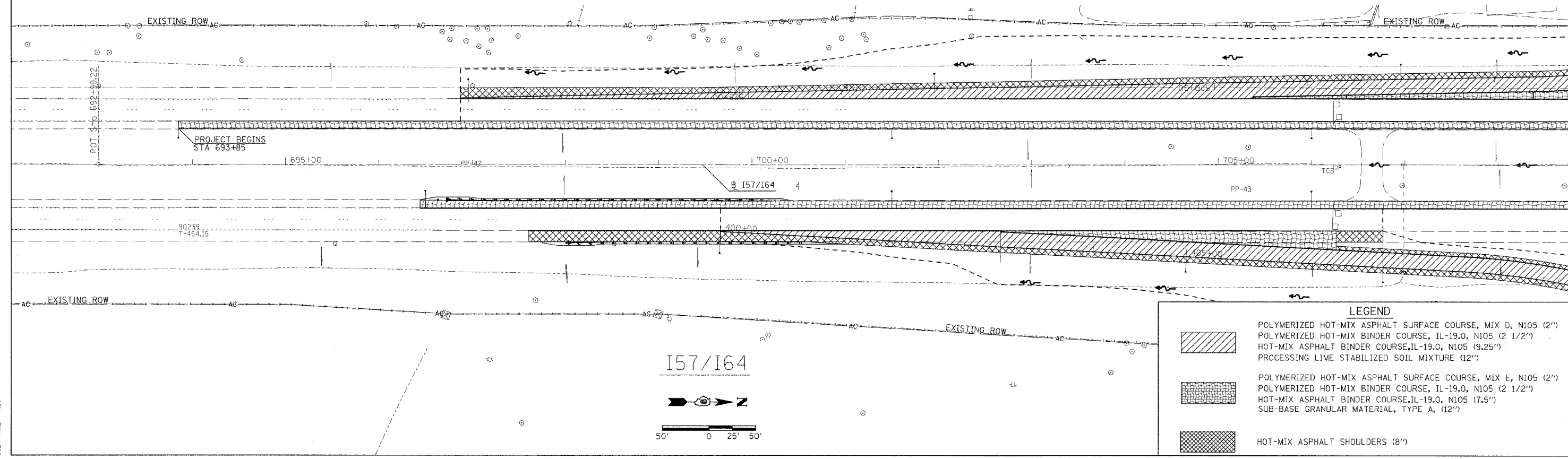
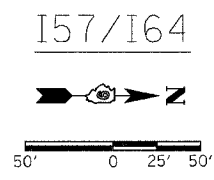
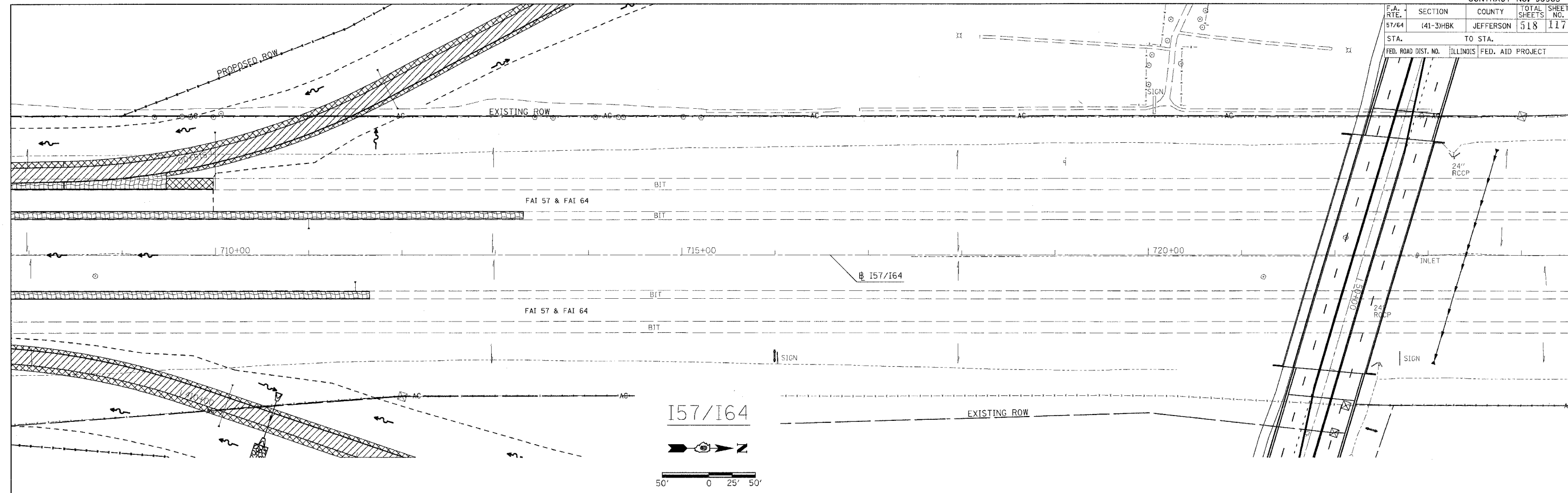

LEGEND

	POLYMERIZED HOT-MIX ASPHALT SURFACE COURSE, MIX D, N105 (2")
	POLYMERIZED HOT-MIX BINDER COURSE, IL-19.0, N105 (2 1/2")
	HOT-MIX ASPHALT BINDER COURSE, IL-19.0, N105 (9.25")
	PROCESSING LIME STABILIZED SOIL MIXTURE (12")
	POLYMERIZED HOT-MIX ASPHALT SURFACE COURSE, MIX E, N105 (2")
	POLYMERIZED HOT-MIX BINDER COURSE, IL-19.0, N105 (2 1/2")
	HOT-MIX ASPHALT BINDER COURSE, IL-19.0, N105 (7.5")
	SUB-BASE GRANULAR MATERIAL, TYPE A, (12")
	HOT-MIX ASPHALT SHOULDERS (8")

PLOT DATE = 05/21/2007 09:10 AM
 FILE NAME = I:\98963\98963\117\DOT\RAVPS\I57I64-4.mxd
 PLOT SCALE = 50.00000 1/16"
 USER NAME = Kct