

F.A.I. RTE.	SECTION	COUNTY	TOTAL SHEETS	SHEET NO.
57/64	(41-3)HBK	JEFFERSON	518	224
STA.	TO STA.			
FED. ROAD DIST. NO.	ILLINOIS	FED. AID PROJECT		

LEGEND

- UNIT DUCT 2 #6 XLP, 1 #6 XLPG, 1" P
- CONDUIT, AUGERED, 2" DIA., PVC (LENGTH AS NOTED)
- LIGHT POLE, ALUMINUM, 50' M.H., 15' MAST ARM WITH 400 WATT HPS HORIZONTAL MOUNT LUMINAIRE ON A TRANSFORMER BASE WITH A 30" X 7' CONCRETE FOUNDATION
- LIGHT CONTROLLER CB-RCS-60-480
- ELECTRIC SERVICE INSTALLATION WITH A SERVICE DISCONNECT

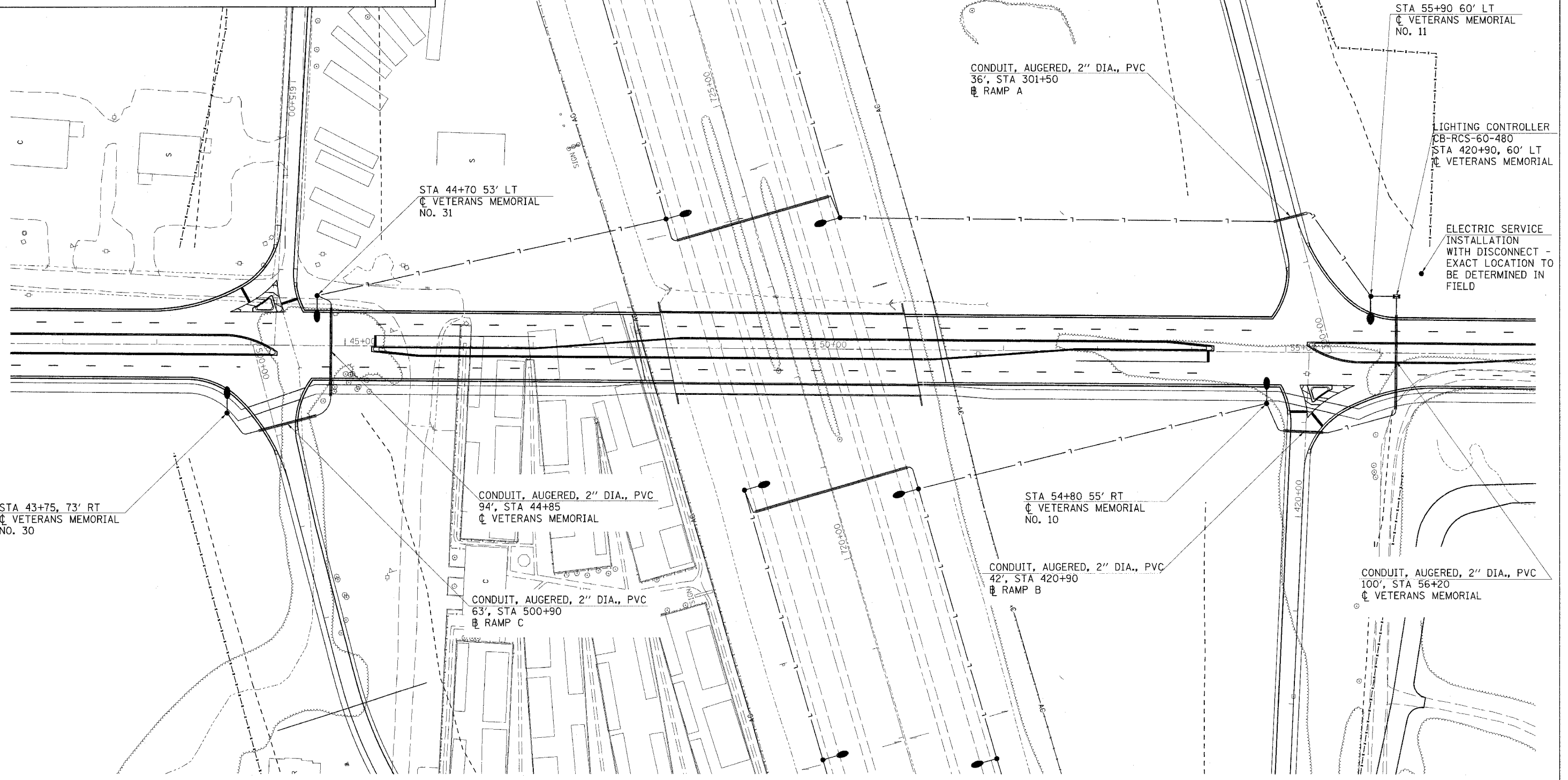
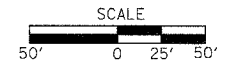

STA 44+70 53' LT
☉ VETERANS MEMORIAL
NO. 31

CONDUIT, AUGERED, 2" DIA., PVC
36', STA 301+50
☉ RAMP A

STA 55+90 60' LT
☉ VETERANS MEMORIAL
NO. 11

LIGHTING CONTROLLER
CB-RCS-60-480
STA 420+90, 60' LT
☉ VETERANS MEMORIAL

ELECTRIC SERVICE
INSTALLATION
WITH DISCONNECT -
EXACT LOCATION TO
BE DETERMINED IN
FIELD

STA 43+75, 73' RT
☉ VETERANS MEMORIAL
NO. 30

CONDUIT, AUGERED, 2" DIA., PVC
94', STA 44+85
☉ VETERANS MEMORIAL

STA 54+80 55' RT
☉ VETERANS MEMORIAL
NO. 10

CONDUIT, AUGERED, 2" DIA., PVC
42', STA 420+90
☉ RAMP B

CONDUIT, AUGERED, 2" DIA., PVC
63', STA 500+90
☉ RAMP C

CONDUIT, AUGERED, 2" DIA., PVC
100', STA 56+20
☉ VETERANS MEMORIAL

03/22/2007 03:21 PM
C:\Users\jrd\Documents\98963\11001_RAMP\98963.mxd
5/10/2007 7:11 AM
JMD

Rev.