

F.A.I. R.T.E.	SECTION	COUNTY	TOTAL SHEETS	SHEET NO.
57/64	(41-3)HBK	JEFFERSON	18	236
STA.		TO STA.		
FED. ROAD DIST. NO.		ILLINOIS FED. AID PROJECT		

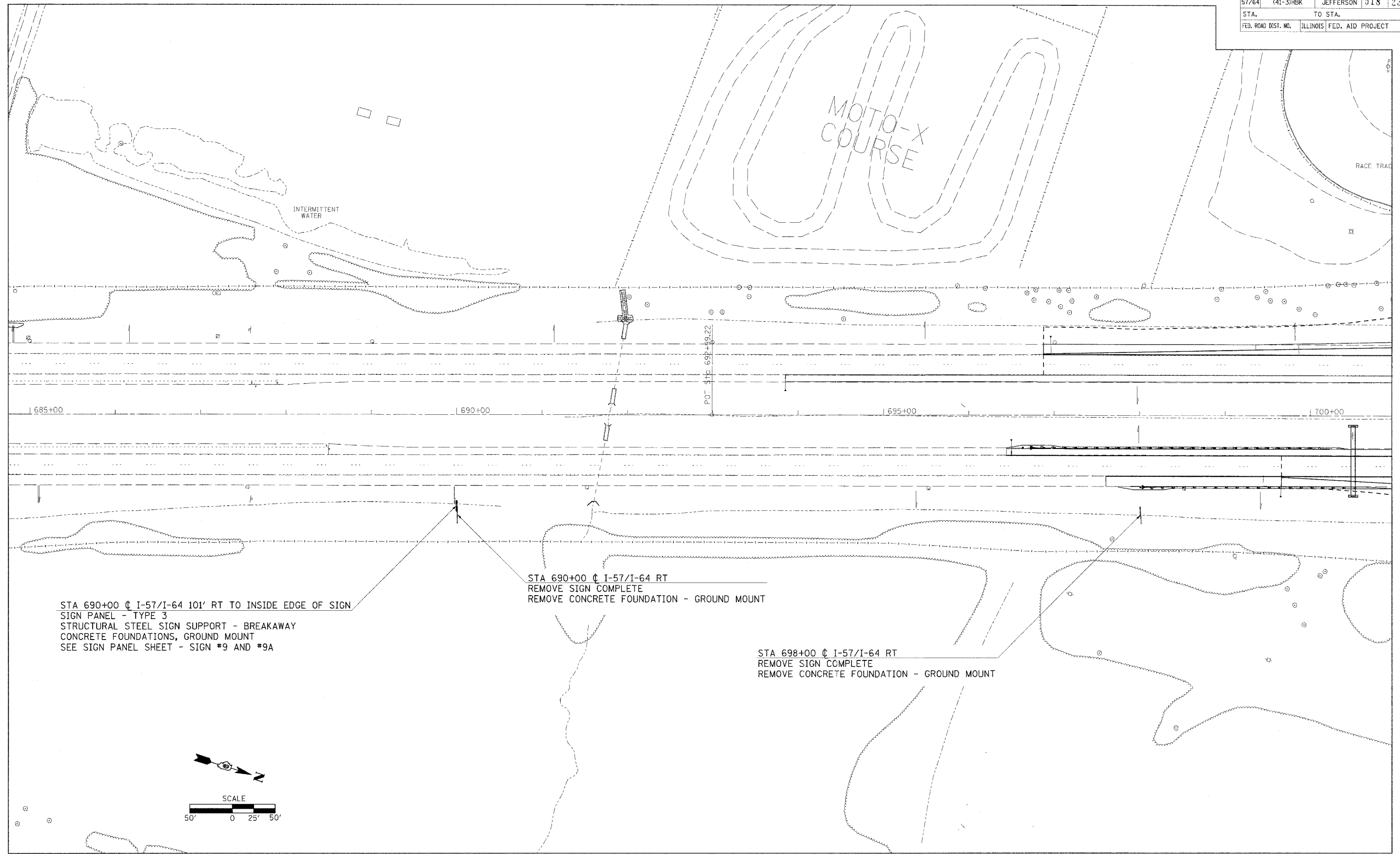

STA 690+00 \oslash I-57/I-64 101' RT TO INSIDE EDGE OF SIGN
 SIGN PANEL - TYPE 3
 STRUCTURAL STEEL SIGN SUPPORT - BREAKAWAY
 CONCRETE FOUNDATIONS, GROUND MOUNT
 SEE SIGN PANEL SHEET - SIGN #9 AND #9A

STA 690+00 \oslash I-57/I-64 RT
 REMOVE SIGN COMPLETE
 REMOVE CONCRETE FOUNDATION - GROUND MOUNT

STA 698+00 \oslash I-57/I-64 RT
 REMOVE SIGN COMPLETE
 REMOVE CONCRETE FOUNDATION - GROUND MOUNT

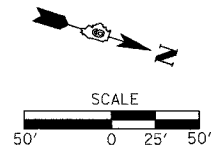

8/21/2007 09:55 AM
 I:\Jobs\98963\98963.DWG
 10/10/07 10:07 AM
 10/10/07 10:07 AM