

F.A.I. RTE.	SECTION	COUNTY	TOTAL SHEETS	SHEET NO.
57/64	(41-3)HBK	JEFFERSON	518	437
STA. 1+00.0000 TO STA. 1+10.0000				
FED. ROAD DIST. NO.		ILLINOIS	FED. AID PROJECT	

DATE	
BY	
REVISIONS	
1. SURVEYED	
2. DESIGNED	
3. CHECKED	
4. APPROVED	
5. ASSES CHECKED	

DATE	
BY	
REVISIONS	
1. SURVEYED	
2. DESIGNED	
3. CHECKED	
4. APPROVED	
5. ASSES CHECKED	

PLOT DATE = 03/22/2007 11:58 AM  
 FILE NAME = I:\18\p05\18a2201\DOT RAMP B SE QUAD RADIUS\DWG\437.DWG  
 PLOT SCALE = 5.0000' / 1" = 165.346  
 USER NAME = K&S

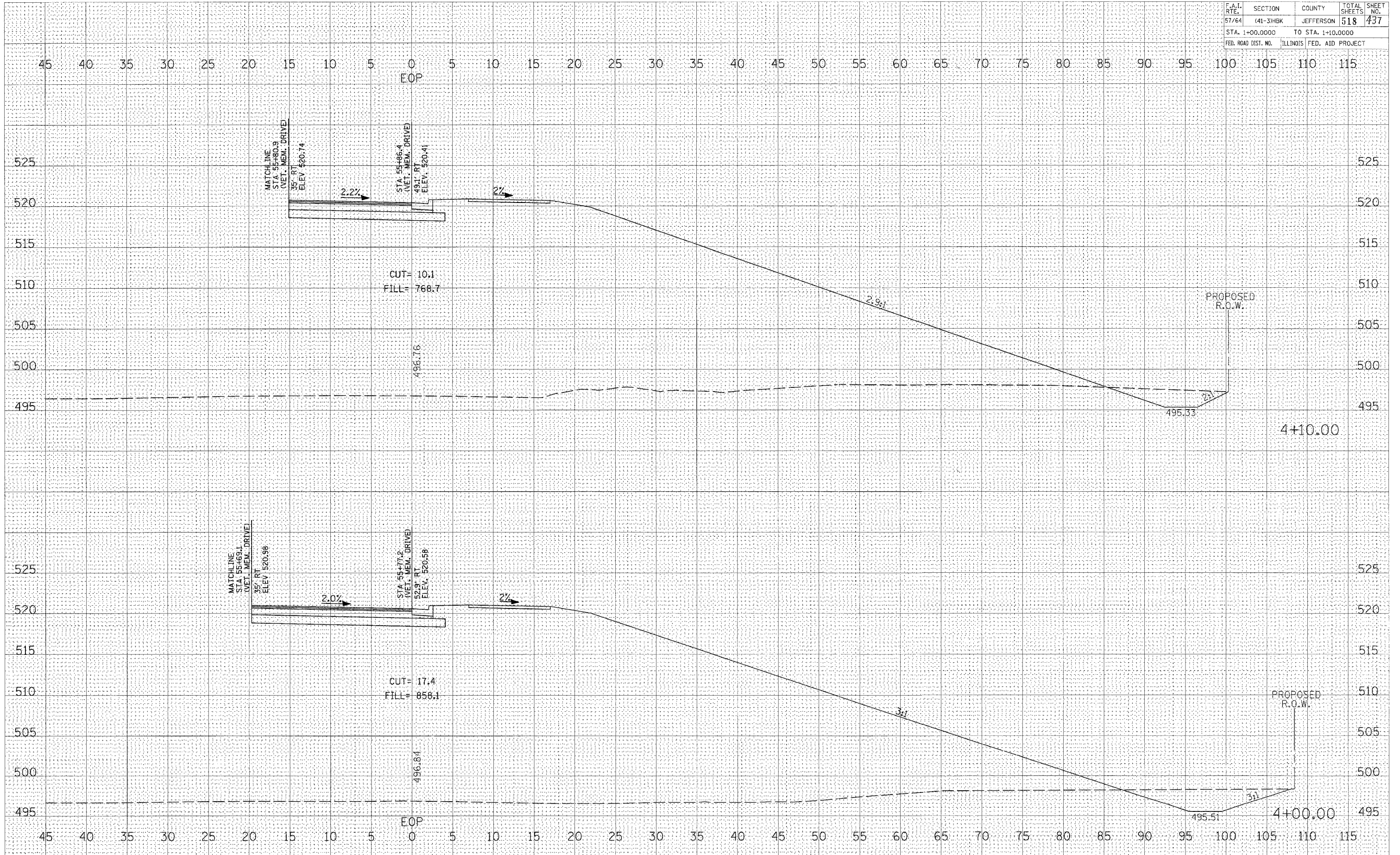

CROSS SECTIONS - RAMP B SE QUAD RADIUS