





**SCOPE OF WORK**

THIS PROJECT WILL CONSIST OF OVERLAYING THE HANGAR APRON AND ACCESS TAXIWAY. ASSOCIATED WORK INCLUDES BITUMINOUS CRACK REPAIR, REMOVE AND REPLACE BITUMINOUS PAVEMENT, POROUS FRICTION COURSE 0.10' AND MARKING.

**AIRPORT SECURITY NOTE**

AIRPORT SECURITY WILL BE MAINTAINED AT ALL TIMES. THE CONTRACTOR WILL CLOSE AND LOCK THE EXISTING GATE IN THE HAUL ROUTE AT THE END OF EACH WORKING DAY.

**UTILITY NOTE**

THE CONTRACTOR SHALL CONTACT ALL UTILITY COMPANIES AND AGENCIES WHICH HAVE LINES OR CONDUITS IN THE PROPOSED WORK AREA. ALL LINES AND CONDUITS SHALL BE LOCATED AND IDENTIFIED FOR DEPTH BEFORE ANY EXCAVATION BEGINS. THE CONTRACTOR WILL CALL J.U.L.I.E. (1-800-892-0123) TO ACCOMPLISH THE ABOVE. IT IS THE CONTRACTOR'S RESPONSIBILITY TO IDENTIFY ALL UNDERGROUND NON-JULIE UTILITIES LOCATED WITHIN THE PROPOSED CONSTRUCTION LIMITS. THESE UNDERGROUND IMPROVEMENTS WILL BE LOCATED AT THE CONTRACTOR'S OWN EXPENSE PRIOR TO THE START OF CONSTRUCTION ACTIVITIES.

**HEIGHT OF CONSTRUCTION EQUIPMENT**

THE MAXIMUM ANTICIPATED HEIGHT OF THE CONSTRUCTION EQUIPMENT WILL BE 25 FEET. THE TALLEST EQUIPMENT IS EXPECTED TO BE A SEMI-TRUCK WITH THE TRAILER IN THE UP POSITION.

**HAUL ROUTE AND VEHICLE PARKING**

THE CONTRACTOR WILL USE THE DESIGNATED HAUL ROUTE AND PARKING AREA AS SHOWN ON THIS SHEET. THE PROPOSED PARKING AREA WILL BE 200' X 200'. THE CONTRACTOR WILL BE REQUIRED TO MAINTAIN THE PROPOSED HAUL ROUTE AND PARKING AREA THROUGHOUT THE COURSE OF THE PROJECT. ANY AREAS DAMAGED OUTSIDE OF THESE AREAS WILL BE REPAIRED BY THE CONTRACTOR AND AT THE CONTRACTOR'S OWN EXPENSE. AT THE CONCLUSION OF THE PROJECT THE CONTRACTOR WILL GRADE, FERTILIZE, SEED AND MULCH THE PARKING AREA AS NEEDED TO RESTORE IT TO ITS ORIGINAL STATE. ANY PAVEMENT AREAS ON THE HAUL ROUTE THAT WERE DAMAGED BY THE CONTRACTOR WILL BE REPAIRED TO THE SATISFACTION OF THE RESIDENT ENGINEER. RESTORATION OF THE HAUL ROUTE AND PARKING AREA WILL BE CONSIDERED INCIDENTAL TO THE PROJECT AND NO ADDITIONAL COMPENSATION WILL BE ALLOWED.

**CONTRACTOR RESPONSIBILITIES**

THE CONTRACTOR'S EQUIPMENT PARKING AND STORAGE AREA WILL BE AS SHOWN ON THIS SHEET. THE CONTRACTOR'S EMPLOYEES WILL PARK THEIR VEHICLES IN THIS AREA. ONLY CONTRACTOR VEHICLES WILL BE ALLOWED OUTSIDE THIS AREA.

THE CONTRACTOR AND HIS EMPLOYEES WILL BE RESTRICTED TO THE WORK AREA AND ALL OTHER AREAS OF THE AIRPORT ARE "OFF LIMITS" TO THEM.

NO TRENCHES OR HOLES WILL REMAIN OPEN OVERNIGHT.

**BARRICADES AND TRAFFIC CONES**

IT WILL BE THE CONTRACTOR'S RESPONSIBILITY TO PLACE AND MAINTAIN BARRICADES AND TRAFFIC CONES AS DIRECTED BY THE AIRPORT MANAGER. THE BARRICADES WILL BE EQUIPPED WITH RED FLASHING OR STEADY BURN LIGHTS AND 20" SQUARE ORANGE FLAGS. THE BARRICADES, THEIR MAINTENANCE, PLACEMENT AND REMOVAL WILL BE CONSIDERED AS AN INCIDENTAL ITEM TO THE CONTRACT AND NO ADDITIONAL COMPENSATION WILL BE ALLOWED.

BENCHMARK DATA		
NO.	DESCRIPTION	ELEV.
1	CHISLED SQUARE ON CONC. BASE, GUIDANCE SIGN, STA 215+75, 111.4' LT.	612.94
2	BM #6 CHISLED SQUARE IN EAST SIDE OF NORTHEAST HANGAR FOUNDATION	613.46
3	BM CB #7 CHISLED SQUARE IN NW CORNER OF ELECTRICAL TRANSFORMER CONC. PAD	612.63

THE LOCATION, SIZE AND TYPE OF MATERIAL OF EXISTING UNDERGROUND UTILITIES INDICATED ON THE PLANS IS NOT REPRESENTED AS BEING ACCURATE, SUFFICIENT OR COMPLETE. IT SHALL BE THE CONTRACTOR'S RESPONSIBILITY TO DETERMINE THE ACTUAL LOCATION OF ALL SUCH FACILITIES, INCLUDING SERVICE CONNECTIONS TO UNDERGROUND UTILITIES. PRIOR TO CONSTRUCTION, THE CONTRACTOR SHALL NOTIFY THE UTILITY COMPANIES OF HIS OPERATIONAL PLANS AND SHALL OBTAIN FROM THE RESPECTIVE UTILITY COMPANIES DETAILED INFORMATION AND ASSISTANCE RELATIVE TO THE LOCATION OF THEIR FACILITIES AND THE WORKING SCHEDULE OF THE COMPANIES FOR REMOVAL OR ADJUSTMENT WHERE REQUIRED. IN THE EVENT AN UNEXPECTED UTILITY INTERFERENCE IS ENCOUNTERED DURING CONSTRUCTION, THE CONTRACTOR SHALL IMMEDIATELY NOTIFY THE UTILITY COMPANY OF JURISDICTION. THE ENGINEER SHALL ALSO BE IMMEDIATELY NOTIFIED. ANY SUCH MAINS AND SERVICES SHALL BE RESTORED TO SERVICE AT ONCE AND PAID FOR BY THE CONTRACTOR AT NO ADDITIONAL COST TO THE CONTRACT.

CALL J.U.L.I.E. FOR UTILITY INFORMATION AT 1-800-892-0123.

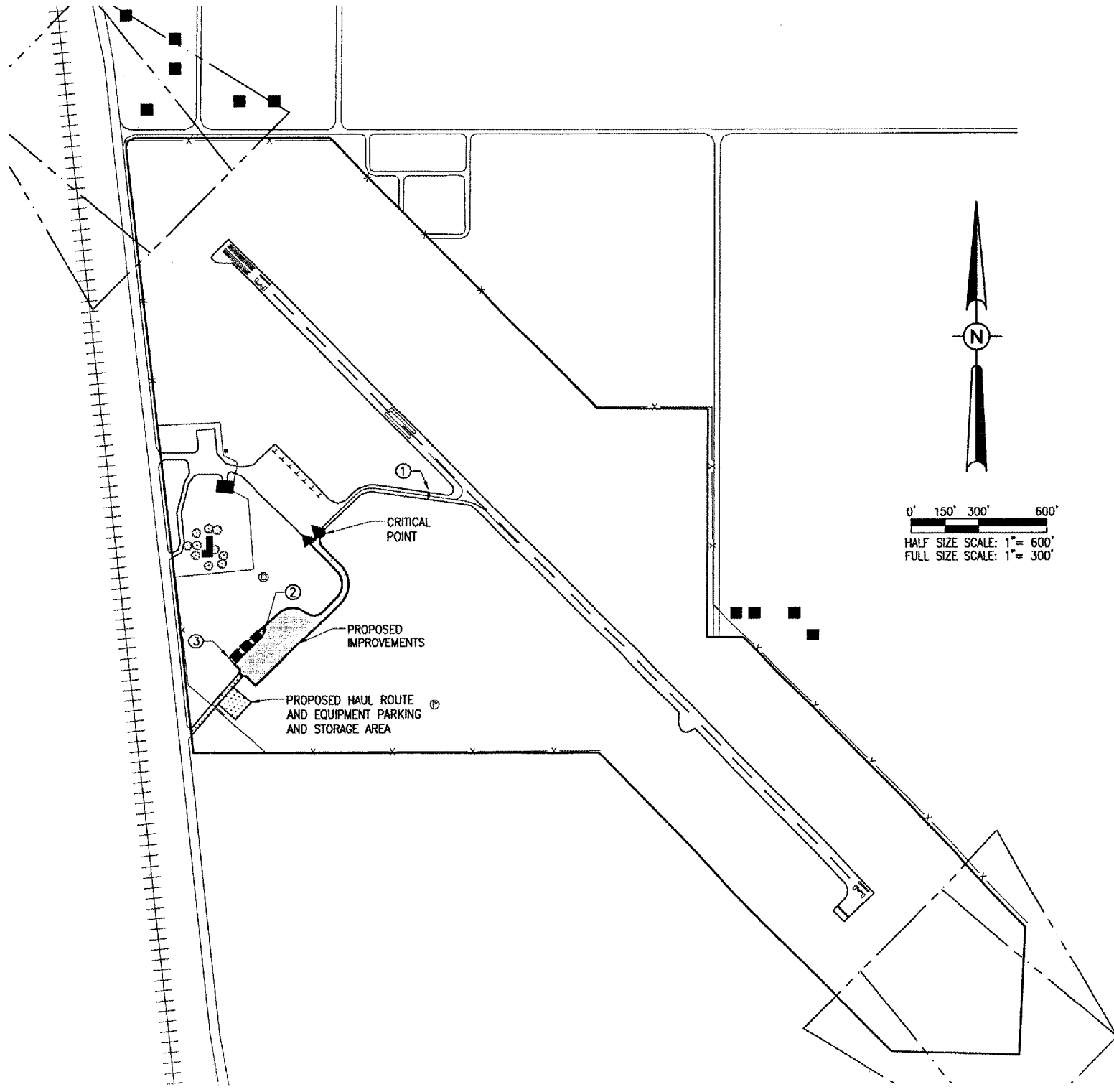

**PROPOSED SAFETY PLAN**

GENERAL - THE TRI-TOWNSHIP AIRPORT IS COMPRISED OF ONE RUNWAY. THE PROPOSED CONSTRUCTION WILL NOT NECESSITATE CLOSING THE RUNWAY.

IDENTIFICATION - WHEN THE CONTRACTORS VEHICLES AND EQUIPMENT ARE ON THE AIRPORT THEY SHALL BE PROPERLY MARKED WITH THREE (3') FOOT SQUARE CHECKERED FLAGS (INTERNATIONAL ORANGE AND WHITE). THE CONTRACTOR WILL ALSO PROVIDE WORKERS WITH SOME TYPE OF TAG OR GARMENT TO IDENTIFY THE PERSON AS BEING PART OF THE CONSTRUCTION CREW.

RADIO CONTROL - THE CONTRACTOR WILL BE REQUIRED TO BE IN TWO-WAY RADIO CONTACT (122.70 MHz.) WITH THE AIRPORT UNICOM. THIS WILL KEEP THE CONTRACTOR IN CONSTANT CONTACT WITH THE TRI-TOWNSHIP AIRPORT AND ENABLE THE AIRPORT TO IMMEDIATELY CONTACT THE CONTRACTOR IN CASE OF AN AERONAUTIC EMERGENCY THAT WOULD REQUIRE ACTION BY THE CONTRACTOR AND/OR HIS PERSONNEL.

**EROSION CONTROL**

THIS PROJECT WILL DISTURB LESS THAN 1 ACRE OF LAND, THEREFORE A N.P.D.E.S. PERMIT WILL NOT BE REQUIRED.

**CERTIFIED PAYROLLS**

THE RESIDENT ENGINEER CANNOT FORWARD CONSTRUCTION REPORTS TO THE ILLINOIS DIVISION OF AERONAUTICS FOR PROCESSING UNTIL ALL CERTIFIED PAYROLLS FOR THE PERIOD HAVE BEEN RECEIVED.

**MATERIAL CERTIFICATION**

COMPLETED WORK CANNOT BE PLACED ON A CONSTRUCTION REPORT UNTIL ALL MATERIAL CERTIFICATIONS FOR THAT PAY ITEM HAVE BEEN RECEIVED, REVIEWED AND ACCEPTED BY THE RESIDENT ENGINEER.

**J.U.L.I.E. INFORMATION**

COUNTY CARROLL  
 CITY SAVANNA  
 TOWNSHIP SAVANNA  
 SECTION NO. 25  
 ADDRESS TRI-TOWNSHIP AIRPORT  
 8049 IL ROUTE B4S  
 SAVANNA, ILLINOIS 61074

**CRITICAL POINT DATA**

LATITUDE: 42° 02' 46.64199"  
 LONGITUDE: 90° 06' 41.57575"  
 ELEVATION: 613.27 M.S.L.

**LEGEND**

- EXISTING IMPROVEMENTS
- PROPOSED IMPROVEMENTS
- EXISTING BUILDINGS
- PROPOSED HAUL ROUTE AND EQUIPMENT PARKING AREA
- PROPOSED BENCHMARK
- PROPOSED BARRICADES OR TRAFFIC CONES

REVISION	DATE	BY

TRI-TOWNSHIP AIRPORT  
 SAVANNA, CARROLL COUNTY  
 ILLINOIS

IL PROJ.: SFY-3712 A.I.P. PROJ.: 3-17-0091-813

Hanson Project No. B2607TXD_0800	04/02/07
File Name: R-003SFY.DWG	04/02/07
Scale: 1" = 300'	06/12/07
Date: 04/02/07	
LAYOUT	CCC
DRAWN	CCC
REVIEWED	CAH



OVERLAY HANGAR APRON AND TAXIWAY

PROPOSED SAFETY PLAN

**POROUS FRICTION COURSE NOTES**

THE PROPOSED POROUS FRICTION COURSE WILL BE CONSTRUCTED IN ONE LAYER, HAVING A COMPACTED NOMINAL THICKNESS OF 0.10 FOOT.

POROUS FRICTION COURSE SHALL BE PLACED ON A CLEAN AND PREPARED SURFACE ONLY AFTER THE APPROVAL OF THE RESIDENT ENGINEER.

POROUS FRICTION COURSE WILL BE CONSTRUCTED IN THE LOCATIONS SHOWN ON THE CONSTRUCTION PLANS AND IN ACCORDANCE WITH THE SPECIAL PROVISIONS.

THE CONTRACTOR WILL ONLY BE ALLOWED TO USE A TRACK PAVING MACHINE FOR PLACEMENT OF THE POROUS FRICTION COURSE.

ONLY TANDUM TRUCKS WILL BE ALLOWED FOR THIS PROJECT.

IF THE EXISTING PAVEMENT SHOWS SIGNS OF DISTRESS UNDER LOAD, THE TANDUM TRUCKS WILL BE REDUCED TO HALF LOADS AT THE RESIDENT ENGINEER'S DISCRETION.

SUMMARY OF QUANTITIES				
ITEM	DESCRIPTION	UNIT	TOTAL QUANTITIES	AS BUILT QUANTITIES
AR402622	POROUS FRICTION COURSE, 0.10'	S.Y.	7,685	
AR603510	BITUMINOUS TACK COAT	GAL.	2,306	

**603-BITUMINOUS TACK COAT NOTES**

THE BITUMINOUS TACK COAT (603) SHALL BE PLACED IN ACCORDANCE WITH ITEM AR603 "BITUMINOUS TACK COAT" AS STATED ON PAGE 62 OF THE SUPPLEMENTAL SPECIFICATIONS AND RECURRING SPECIAL PROVISIONS, ADOPTED JULY 1, 2004.

THE PROPOSED BITUMINOUS TACK COAT SHALL BE PLACED ON THE EXISTING BITUMINOUS PAVEMENT PRIOR TO THE PLACEMENT OF THE POROUS FRICTION COURSE. THE PROPOSED BITUMINOUS TACK COAT WILL BE PAID FOR UNDER ITEM:

AR603510 "BITUMINOUS TACK COAT" - PER GALLON

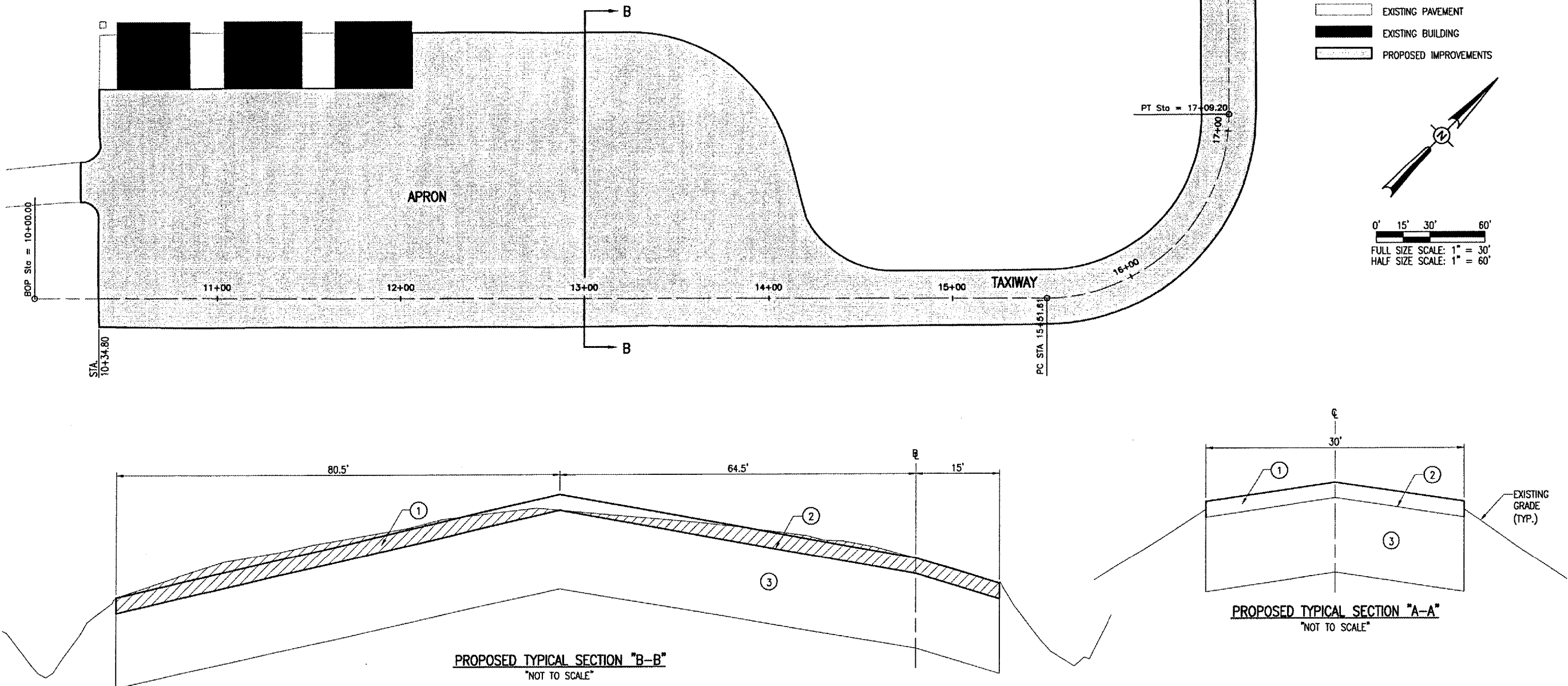

- PROPOSED LEGEND FOR TYPICAL SECTIONS "A-A" AND "B-B"**
- ① PROPOSED 402 - POROUS FRICTION COURSE (0.10' DEPTH)
  - ② PROPOSED 603 - BITUMINOUS TACK COAT (0.25 GAL./S.Y.)
  - ③ EXISTING 6" BITUMINOUS PAVEMENT
  - ▨ PROPOSED BITUMINOUS PAVEMENT MILLING

BY	REVISION	DATE

TRI-TOWNSHIP AIRPORT  
SAVANNA, CARROLL COUNTY  
ILLINOIS

IL. PROJ.: SFY-3712 A.I.P. PROJ.: 3-17-0091-B13

Hanson Project No. 02607XXD.0800	Drawn Date 04/04/07	Reviewed Date 06/12/07
Filename R-121CON.DWG	Scale 1" = 30'	Drawn By CCC
		Reviewed By CAH

**HANSON**

Hanson Professional Services Inc.  
1525 South Sixth Street  
Springfield, Illinois 62703-2888  
Offices Nationwide

OVERLAY HANGAR  
APRON AND TAXIWAY

PROPOSED  
CONSTRUCTION  
PLAN

AL: 24, 2007 9:16 AM BAK  
 C:\AIRPORTS\SAVANNA\B26-07TXX\AIRPORT\SHEETS\R-121CON.DWG - Construction Plan

**GENERAL PAVEMENT PREPARATION NOTES**

THE CONTRACTOR WILL BE RESPONSIBLE FOR THE FOLLOWING WORK ITEMS BEFORE A TACK COAT CAN BE APPLIED:

- \* BLADE THE EARTH AND SOD BACK FROM EDGE OF THE PAVEMENT.
- \* USE A PESTICIDE TO KILL ALL WEEDS ON THE EXISTING PAVEMENT SURFACE.
- \* ONCE THE WEEDS HAVE DIED USE A TORCH TO BURN OFF WEEDS.
- \* POWER BROOM THE LOOSE UNWANTED MATERIAL OFF THE PAVEMENT.

THE ABOVE WORK WILL BE CONSIDERED INCIDENTAL TO PAY ITEM AR603510 "BITUMINOUS TACK COAT" AND NO ADDITIONAL COMPENSATION WILL BE ALLOWED.

SUMMARY OF QUANTITIES				
ITEM	DESCRIPTION	UNIT	TOTAL QUANTITIES	AS BUILT QUANTITIES
AR201660	BITUMINOUS CRACK REPAIR	L.F.	1,311	
AR401650	BITUMINOUS PAVEMENT MILLING	S.Y.	6,364	
AR401655	BUTT JOINT CONSTRUCTION	S.Y.	95	
AR401910	REMOVE & REPLACE BIT. PAVEMENT	S.Y.	144	

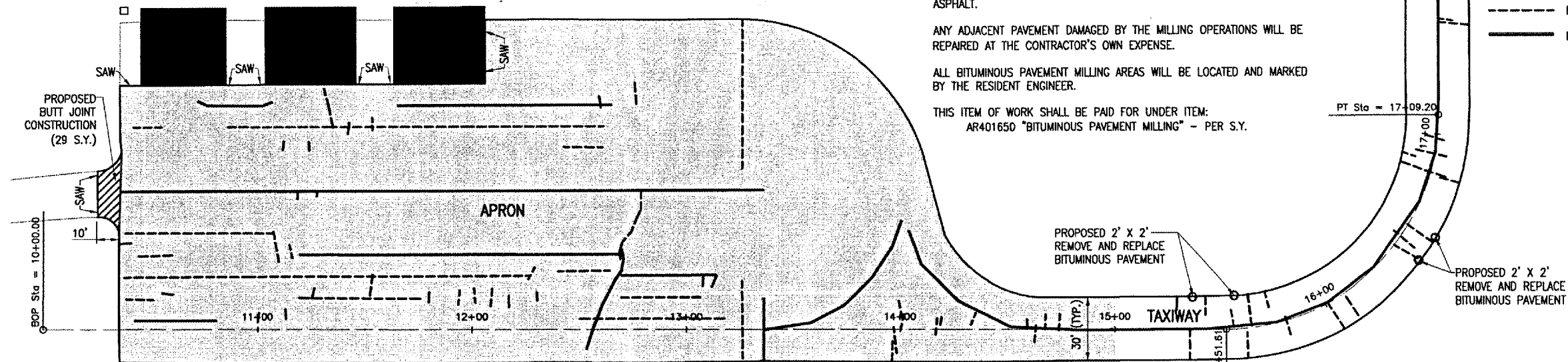

**BITUMINOUS PAVEMENT MILLING**

THE AREA(S) DESIGNATED AS [ ] ON THIS SHEET WILL BE CUT OR TRIMMED AS SHOWN ON THE CROSS-SECTIONS. THE CUTTING OR TRIMMING WILL BE DONE BY ROTO-MILLING. THE TOLERANCE OF THE MILLING WILL BE AS STATED IN THE STANDARD SPECIFICATIONS.

THE EXISTING PAVEMENT WILL BE SAWS AS SHOWN ON THIS SHEET. SAWING WILL BE CONSIDERED AS AN INCIDENTAL ITEM TO THE PROPOSED PAVEMENT MILLING AND NO ADDITIONAL COMPENSATION WILL BE ALLOWED.

ALL MILLED MATERIAL WILL BE DISPOSED OF OFF THE AIRPORT SITE.

PRIOR TO APPLYING THE BITUMINOUS OVERLAY ALL MILLED MATERIAL WILL BE BROOMED AND BLOWN CLEAN AND A BITUMINOUS TACK COAT APPLIED. THE VERTICAL FACE OF ALL SAW CUTS WILL BE PAINTED WITH A LIQUID ASPHALT.

ANY ADJACENT PAVEMENT DAMAGED BY THE MILLING OPERATIONS WILL BE REPAIRED AT THE CONTRACTOR'S OWN EXPENSE.

ALL BITUMINOUS PAVEMENT MILLING AREAS WILL BE LOCATED AND MARKED BY THE RESIDENT ENGINEER.

THIS ITEM OF WORK SHALL BE PAID FOR UNDER ITEM: AR401650 "BITUMINOUS PAVEMENT MILLING" - PER S.Y.

PROPOSED BUTT JOINT CONSTRUCTION (66 S.Y.)

**LEGEND**

- EXISTING PAVEMENT
- EXISTING BUILDING
- PROPOSED IMPROVEMENTS
- PROPOSED BUTTJOINT CONSTRUCTION
- PROPOSED BITUMINOUS PAVEMENT MILLING
- PROPOSED BITUMINOUS CRACK REPAIR
- PROPOSED REMOVE AND REPLACE BITUMINOUS PAVEMENT

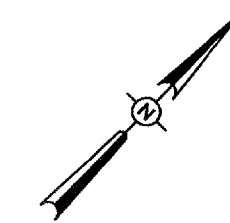

0' 15' 30' 60'  
FULL SIZE SCALE: 1" = 30'  
HALF SIZE SCALE: 1" = 60'

**REMOVE AND REPLACE BITUMINOUS PAVEMENT**

THE ITEM "REMOVE AND REPLACE BITUMINOUS PAVEMENT" WILL BE UTILIZED TO PERFORM LARGE CRACK REPAIR.

THE QUANTITY OF CRACKS TO BE REPAIRED WAS ESTABLISHED BY THE COMPLETION OF A CRACK SURVEY (SPRING 2006), AND CONSISTS OF THOSE CRACKS FOUND TO BE GREATER THAN ONE INCH IN WIDTH AT THE TIME OF THE SURVEY, AND EXHIBITING ROLLED EDGES. ALL CRACKS TO RECEIVE REPAIR SHALL BE LOCATED AND MARKED BY THE RESIDENT ENGINEER.

THE CRACKS SHALL BE REMOVED FROM THE PAVEMENT BY ONE OF TWO METHODS, OR A COMBINATION OF THE TWO. THE FIRST ALTERNATIVE IS TO SAWCUT THE WIDTH OF THE AREA TO BE REPAIRED BY USING A WHEEL SAW AND REMOVE THE PAVEMENT TO THE SPECIFIED DEPTH USING A BACKHOE OR OTHER MECHANICAL MEANS. THE SECOND ALTERNATIVE IS TO USE A SKID STEER (OR EQUIVALENT) MOUNTED MILLING HEAD TO REMOVE THE PAVEMENT TO THE REQUIRED DEPTH. REGARDLESS OF THE METHOD USED TO REMOVE THE PAVEMENT, THE EDGE OF THE TRENCH FORMED WILL HAVE A VERTICAL FACE PRIOR TO THE PLACEMENT OF THE BITUMINOUS MATERIAL. THE WIDTH OF REPAIR WILL BE 3' WIDE, CENTERED ON THE CRACK. THE DEPTH OF REPAIR WILL BE THE FULL DEPTH OF THE EXISTING PAVEMENT.

THE CONTRACTOR WILL DISPOSE OF THE EXCAVATED MATERIAL OFF THE AIRPORT SITE AT NO ADDITIONAL COST TO THE CONTRACT.

THE BOTTOM OF THE TRENCH WILL BE CLEANED AND COMPACTED TO PREVENT FUTURE SETTLEMENT, AND ACCEPTED BY THE RESIDENT ENGINEER. ONCE THE TRENCH IS CLEANED, THE BASE AGGREGATE COMPACTED, AND ACCEPTED, AN APPLICATION OF BITUMINOUS TACK MATERIAL WILL BE APPLIED TO THE VERTICAL BITUMINOUS FACE AND THE AGGREGATE BASE. THE REPAIR TRENCH WILL BE BACKFILLED WITH BITUMINOUS SURFACE COURSE MATERIAL (401), IN LIFTS OF THICKNESS NO GREATER THAN 3". THE FINAL LIFT SHALL BE FLUSH WITH THE SURFACE OF THE EXISTING BITUMINOUS PAVEMENT OR THE CONTRACTOR WILL BE REQUIRED TO MILL THE FINAL LIFT FLUSH AT HIS EXPENSE. EACH LIFT SHALL BE COMPACTED AND ACCEPTED BY THE RESIDENT ENGINEER. NO NUCLEAR DENSITY TESTING SHALL BE REQUIRED TO COMPLETE THIS TASK.

**REMOVE AND REPLACE BITUMINOUS PAVEMENT (CONT.)**

ANY DAMAGE TO THE EXISTING ADJACENT PAVEMENT WILL BE REPAIRED BY THE CONTRACTOR AT HIS EXPENSE. THE QUANTITY OF PAVEMENT REMOVAL, MILLING AND/OR SAWCUTS, IF UTILIZED, TACK MATERIAL, AND BITUMINOUS SURFACE COURSE MATERIAL (401) NECESSARY TO COMPLETE THIS TASK WILL BE CONSIDERED INCIDENTAL TO THE TASK, AND NO ADDITIONAL COMPENSATION WILL BE ALLOWED.

THE QUANTITY OF BITUMINOUS CRACK REPAIR TO BE PAID FOR SHALL BE THE NUMBER OF SQUARE YARDS OF PAVEMENT REMOVED AND REPLACED, IN ACCORDANCE WITH THE SPECIAL PROVISIONS, CONSTRUCTION DRAWINGS, AND ACCEPTED BY THE ENGINEER. MEASUREMENT OF BITUMINOUS CRACK REPAIR FOR PAYMENT SHALL BE TO THE NEAREST SQUARE YARD.

PAYMENT FOR THIS ITEM OF WORK WILL BE UNDER ITEM: AR401910 "REMOVE & REPLACE BIT. PAVEMENT" - PER S.Y.

**PAVEMENT SAWING NOTES**

THE PROPOSED SAWING WILL PROVIDE A STRAIGHT PAVEMENT EDGE TO BUTT AGAINST.

THE RESIDENT ENGINEER WILL MARK THE PROPOSED SAW LINE IN THE FIELD.

ANY BITUMINOUS PAVEMENT CUT FROM THE SAWING OPERATIONS WILL BE COLLECTED AND DISPOSED OF OFF THE AIRPORT SITE.

THE SAWING AND DISPOSAL OF ANY WASTE MATERIAL WILL BE CONSIDERED INCIDENTAL TO THE CONTRACT AND NO ADDITIONAL COMPENSATION WILL BE ALLOWED

**AR401655 BUTT JOINT CONSTRUCTION NOTES**

THE PROPOSED BUTT JOINTS SHALL BE CONSTRUCTED IN ACCORDANCE WITH ITEM AR401655 "BUTT JOINT CONSTRUCTION" AS STATED ON PAGE 295 OF THE SUPPLEMENTAL SPECIFICATION AND RECURRING SPECIAL PROVISIONS, ADOPTED JULY 1, 2004.

THIS ITEM SHALL CONSIST OF REMOVING THE EXISTING BITUMINOUS PAVEMENT SURFACE BY MILLING IN ORDER TO CONSTRUCT A BUTT JOINT FOR THE TRANSITION OF THE PROPOSED BITUMINOUS OVERLAY AT THE LOCATIONS AS SHOWN ON THE PLANS.

THE PAVEMENT SURFACE WILL THEN BE MILLED TO A DEPTH OF 0.125' AT THE BUTT END AND WILL TAPER TO 0 IN. AT THE OPPOSITE END. THE PLANER MUST BE CAPABLE OF MILLING THE SURFACE TO THE DESIRED ELEVATIONS AND GRADES.

PRIOR TO THE PLACEMENT OF THE BITUMINOUS SURFACE COURSE (401), ALL MILLED AREAS WILL BE BROOMED AND BLOWN CLEAN OF LOOSE MATERIALS AND DEBRIS. A BITUMINOUS TACK COAT WILL BE APPLIED ACCORDING TO THE SUPPLEMENTAL SPECIFICATIONS FOR ITEM 603 DATED JULY 1, 2004 AT A RATE OF 0.15 GAL/SY. THE VERTICAL FACE OF ALL SAW CUTS WILL BE PAINTED WITH A LIQUID ASPHALT.

ANY ADJACENT PAVEMENT DAMAGED BY THE MILLING OPERATIONS WILL BE REPAIRED AT THE CONTRACTOR'S OWN EXPENSE.

ALL BITUMINOUS PAVEMENT MILLING AREAS WILL BE LOCATED AND MARKED BY THE RESIDENT ENGINEER.

THE PAVEMENT MILLING WILL BE PAID FOR UNDER ITEM: AR401655 "BUTT JOINT CONSTRUCTION" - PER S.Y.

**BITUMINOUS CRACK REPAIR**

THE CRACKS TO BE REPAIRED WERE OBTAINED FROM A SURVEY (SPRING 2006) AND CONSIST OF THE CRACKS IN NEED OF REPAIR AT THE TIME OF THE SURVEY. OTHER LESS SEVERE, MAINTAINED CRACKS EXIST AND WILL NOT REQUIRE FURTHER REPAIR. THE ACTUAL LENGTH AND NUMBER OF CRACKS TO BE REPAIRED AS PART OF THIS PROJECT WILL BE DESIGNATED BY THE RESIDENT ENGINEER AT THE TIME OF CONSTRUCTION. THE PROJECT QUANTITY IS BASED ON THE AMOUNT OF CRACKS SURVEYED.

THE CRACKS SHALL BE CUT OPEN USING AN "EARTH SAW" OR "VERMEER TRENCHER" AT A WIDTH OF 10" PLUS OR MINUS 1", AND A DEPTH OF 8".

THE EXCAVATED MATERIAL WILL BE DISPOSED OF OFF THE AIRPORT SITE BY THE CONTRACTOR.

AN APPLICATION OF BITUMINOUS TACK MATERIAL WILL BE APPLIED TO THE VERTICAL BITUMINOUS FACE AND THE AGGREGATE BASE. THE REPAIR TRENCH WILL BE BACKFILLED WITH BITUMINOUS SURFACE COURSE MATERIAL (401), IN LIFTS OF THICKNESS NO GREATER THAN 3". THE FINAL LIFT SHALL BE FLUSH WITH THE SURFACE OF THE EXISTING BITUMINOUS PAVEMENT OR THE CONTRACTOR WILL BE REQUIRED TO MILL THE FINAL LIFT FLUSH AT HIS OWN EXPENSE. EACH LIFT SHALL BE COMPACTED TO THE SATISFACTION OF THE RESIDENT ENGINEER AND ACCEPTED. NO NUCLEAR DENSITY TESTING SHALL BE REQUIRED FOR THIS TASK.

ANY DAMAGE TO THE EXISTING ADJACENT PAVEMENT WILL BE REPAIRED BY THE CONTRACTOR AT HIS EXPENSE. THE QUANTITY OF PAVEMENT REMOVAL, MILLING AND/OR SAWCUTS, IF UTILIZED, TACK MATERIAL, AND BITUMINOUS SURFACE COURSE MATERIAL (401) NECESSARY TO COMPLETE THIS TASK WILL BE CONSIDERED INCIDENTAL TO THE TASK, AND NO ADDITIONAL COMPENSATION WILL BE ALLOWED.

THE BITUMINOUS CRACK REPAIR WILL BE PAID FOR UNDER ITEM: AR201660 "BITUMINOUS CRACK REPAIR" - PER L.F.

AUG 24, 2007 9:18 AM BAK \\A\AIRPORT\SAVANNA\826-077\X\AIRPORT\SHEETS\R-111\PRP.DWG - Pmnt. Prep. Plan

TR-004

DATE	REVISION

TRI-TOWNSHIP AIRPORT  
SAVANNA, CARROLL COUNTY  
ILLINOIS

I.L. PROJ.: SFY-3712 A.I.P. PROJ.: J-17-0091-B13

Revision Project No. 826071X.D 0800	04/02/07
Drawn: R-111PRP.DWG	04/04/07
Scale: 1" = 30'	06/12/07
Date: 04/04/07	
LAYOUT	CCC
DRAWN	CCC
REVIEWED	CAH



Hanson Professional Services, Inc.  
1525 South Sixth Street  
Springfield, Illinois 62703-2888  
Offices Nationwide

OVERLAY HANGAR  
APRON AND TAXIWAY

PROPOSED  
PAVEMENT PREPARATION  
PLAN

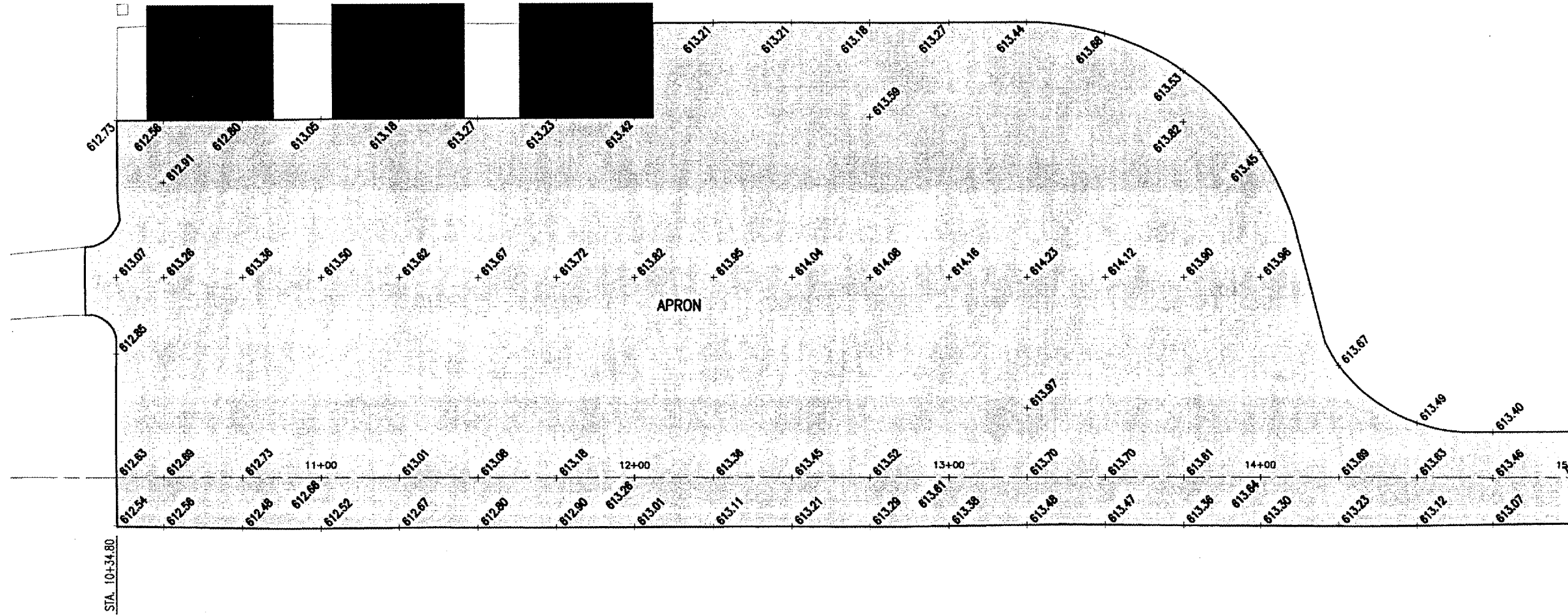

- LEGEND**
- EXISTING PAVEMENT
  - EXISTING BUILDING
  - PROPOSED IMPROVEMENTS
  - PROPOSED GRADE

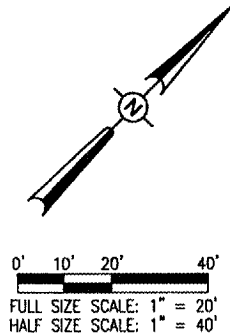

DATE	REVISION	BY

TRI-TOWNSHIP AIRPORT  
 SAVANNA, CARROLL COUNTY  
 ILLINOIS

IL PROJ.: SFY-3712 A.I.P. PROJ.: 3-17-0691-B13

Hanson Project No.	92607IX10_0800
Filename	R-191STK.DWG
Scale	1" = 20'
Date	06/06/07
LAYOUT	BAK 06/06/07
DRAWN	BAK 06/06/07
REVIEWED	CAH 06/12/07



OVERLAY HANGAR  
 APRON AND TAXIWAY

PROPOSED  
 STAKING  
 PLAN

AUG 24, 2007 9:21 AM BAK  
 I:\AIRPORTS\SAVANNA\B2B-07TX\AIRPORT\SHEETS\R-151MRK.DWG - Marking Plan

SUMMARY OF QUANTITIES				
ITEM	DESCRIPTION	UNIT	TOTAL QUANTITIES	AS BUILT QUANTITIES
AR620520	PAVEMENT MARKING-WATERBORNE	S.F.	526	

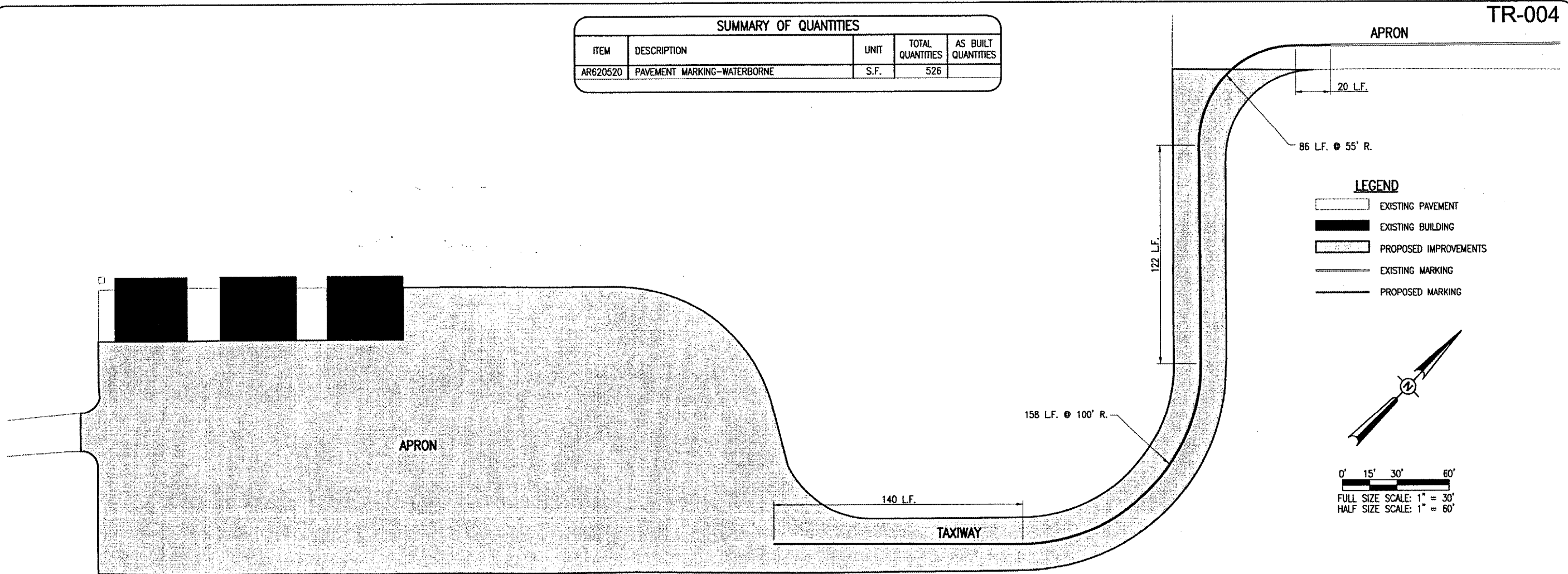

**LEGEND**

	EXISTING PAVEMENT
	EXISTING BUILDING
	PROPOSED IMPROVEMENTS
	EXISTING MARKING
	PROPOSED MARKING

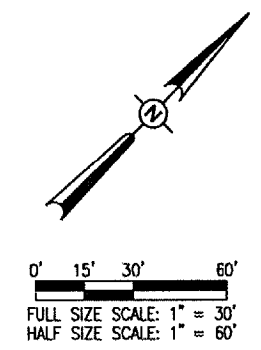

**620-PAVEMENT MARKING-WATERBORNE NOTES**

THE PAVEMENT MARKING-WATERBORNE (620) SHALL BE PLACED IN ACCORDANCE WITH ITEM 620 "PAVEMENT MARKING" AS STATED ON PAGE 77 OF THE SUPPLEMENTAL SPECIFICATIONS AND RECURRING SPECIAL PROVISIONS, ADOPTED JULY 1, 2004.

THIS ITEM SHALL CONSIST OF TAXIWAY CENTERLINE MARKING IN ACCORDANCE WITH THESE SPECIFICATIONS AND AT THE LOCATIONS SHOWN ON THE CONSTRUCTION PLANS. ALL MARKING WILL BE YELLOW IN COLOR. THE PROPOSED PAVEMENT MARKING WILL BE APPLIED IN TWO APPLICATIONS.

ANY MATERIAL DELIVERED THAT FAILS TO MEET THE SPECIFICATIONS SHALL BE DISPOSED OF BY THE VENDOR AND IMMEDIATELY REPLACED WITH ACCEPTABLE MATERIAL ENTIRELY AT THE VENDOR'S EXPENSE, INCLUDING HANDLING AND TRANSPORTATION CHARGES.

ALL CURING COMPOUND WILL BE CLEANED FROM CONCRETE PAVEMENT PRIOR TO APPLYING PAINT. NO EXCEPTIONS.

ALL PROPOSED MARKING WILL BE COMPLETED IN ACCORDANCE WITH THE DETAILS SHOWN ON THE CONSTRUCTION PLANS.

GLASS BEADS SHALL BE REQUIRED ONLY ON THE SECOND APPLICATION.

CUT-OFF SHEETS WILL BE REQUIRED TO INSURE STRAIGHT EDGES.

THE PROPOSED MARKING WILL BE PAID FOR UNDER ITEM:  
 AR620520 PAVEMENT MARKING-WATERBORNE \_\_\_ PER S.F.

TR-004

BY	REVISION	DATE

TRI-TOWNSHIP AIRPORT  
 SAVANNA, CARROLL COUNTY  
 ILLINOIS  
 IL PROJ.: SFY-3712 A.I.P. PROJ.: 3-17-0091-B13

Revision Project No. 92607TXD_0800	
Filename R-151MRK.DWG	
Scale 1" = 30'	
Date 04/04/07	
LAYOUT CCC 04/02/07	
DRAWN CCC 04/04/07	
REVIEWED CAH 06/12/07	



OVERLAY HANGAR  
 APRON AND TAXIWAY  
 PROPOSED  
 MARKING  
 PLAN

AUG 24, 2007 9:23 AM BAK  
 P:\REPORTS\SAVANNA\B26-07\TX\AIRPORT\ SHEETS\R-301XS.DWG - STA. 10+34.80 TO STA. 10+50

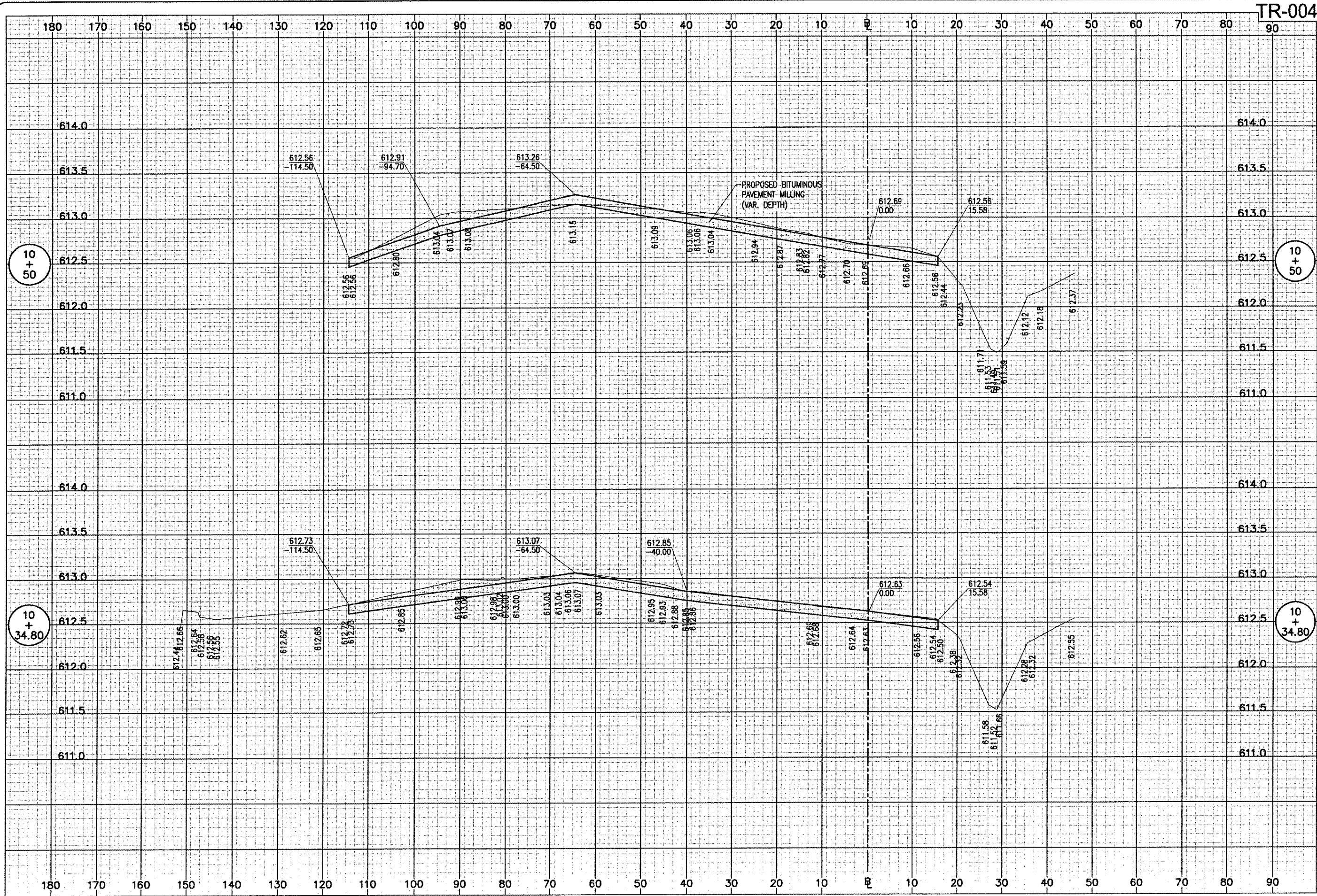

TR-004

DATE	REVISION	BY

TRI-TOWNSHIP AIRPORT  
 SAVANNA, CARROLL COUNTY  
 ILLINOIS

IL PROJ.: SFY-3712 A.I.P. PROJ.: 3-17-0091-813

Project No.	R-2607X10 0800
Filename	R-301XS.DWG
Scale	1"=10'H. & 1"=0.5'V.
Date	06/07/07
LAYOUT	CCC 06/07/07
DRAWN	CCC 06/07/07
REVIEWED	CAH 06/12/07



OVERLAY HANGAR  
 APRON AND TAXIWAY  
 PROPOSED CROSS-SECTIONS  
 FOR HANGAR PAVEMENT  
 STA. 10+34.80 TO STA. 10+50



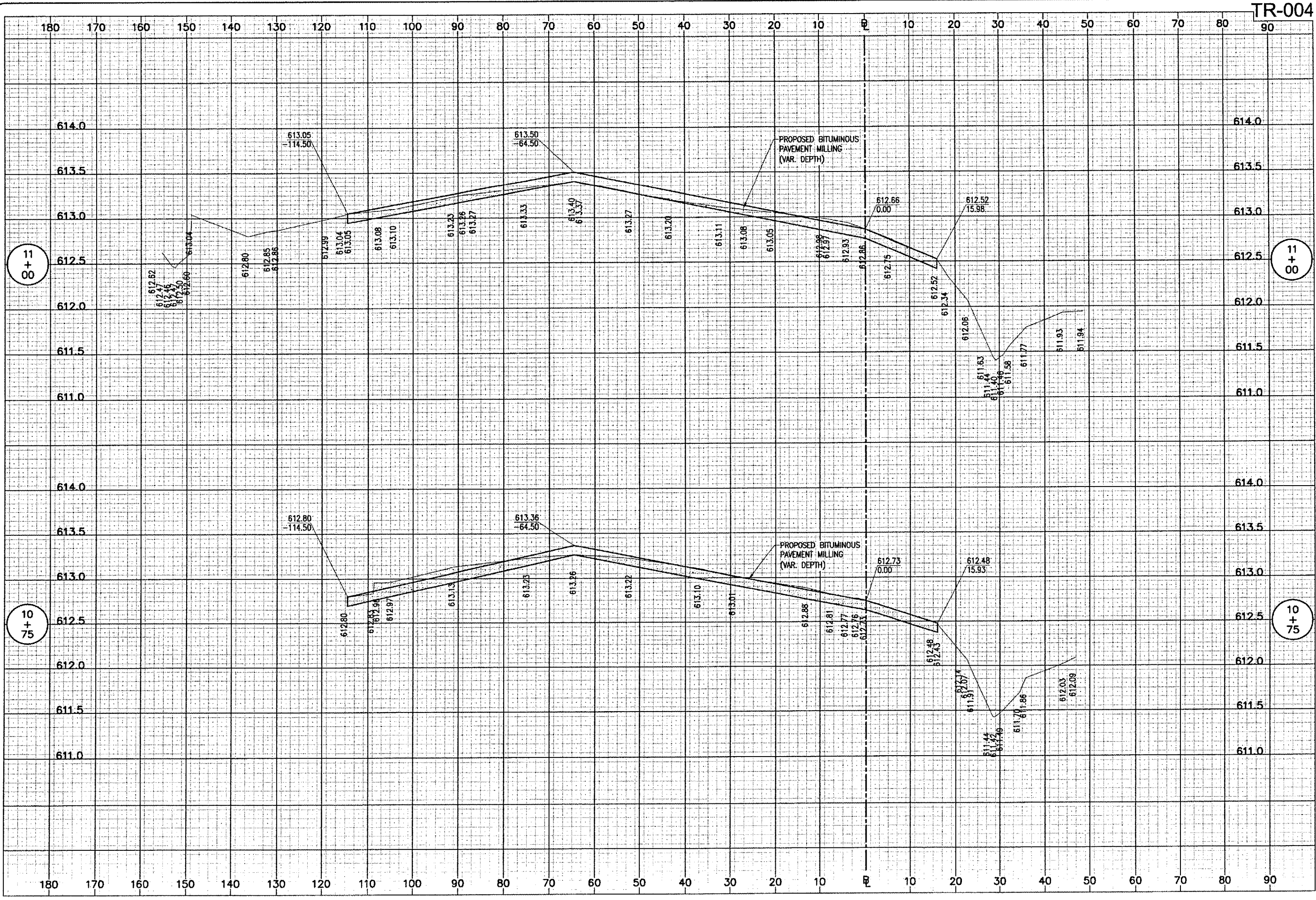

TR-004

11 + 00

11 + 00

10 + 75

10 + 75

DATE	REVISION	BY

TRI-TOWNSHIP AIRPORT  
 SAVANNA, CARROLL COUNTY  
 ILLINOIS

IL PROJ.: SFY-3712      A.I.P. PROJ.: 3-17-0091-B13

DATE	REVIEWED	BY
06/07/07	CCC	CCC
06/07/07	CCC	CCC
06/12/07	CAH	CAH

Project No: 82607XVD\_0800  
 Drawing: R-302XS.DWG  
 Scale: 1"=10'H. & 1"=0.5'V.  
 Date: 06/07/07

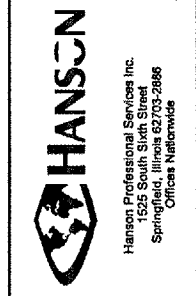

OVERLAY HANGAR  
 APRON AND TAXIWAY

PROPOSED CROSS-SECTIONS  
 FOR HANGAR PAVEMENT  
 STA. 10+75 TO STA. 11+00

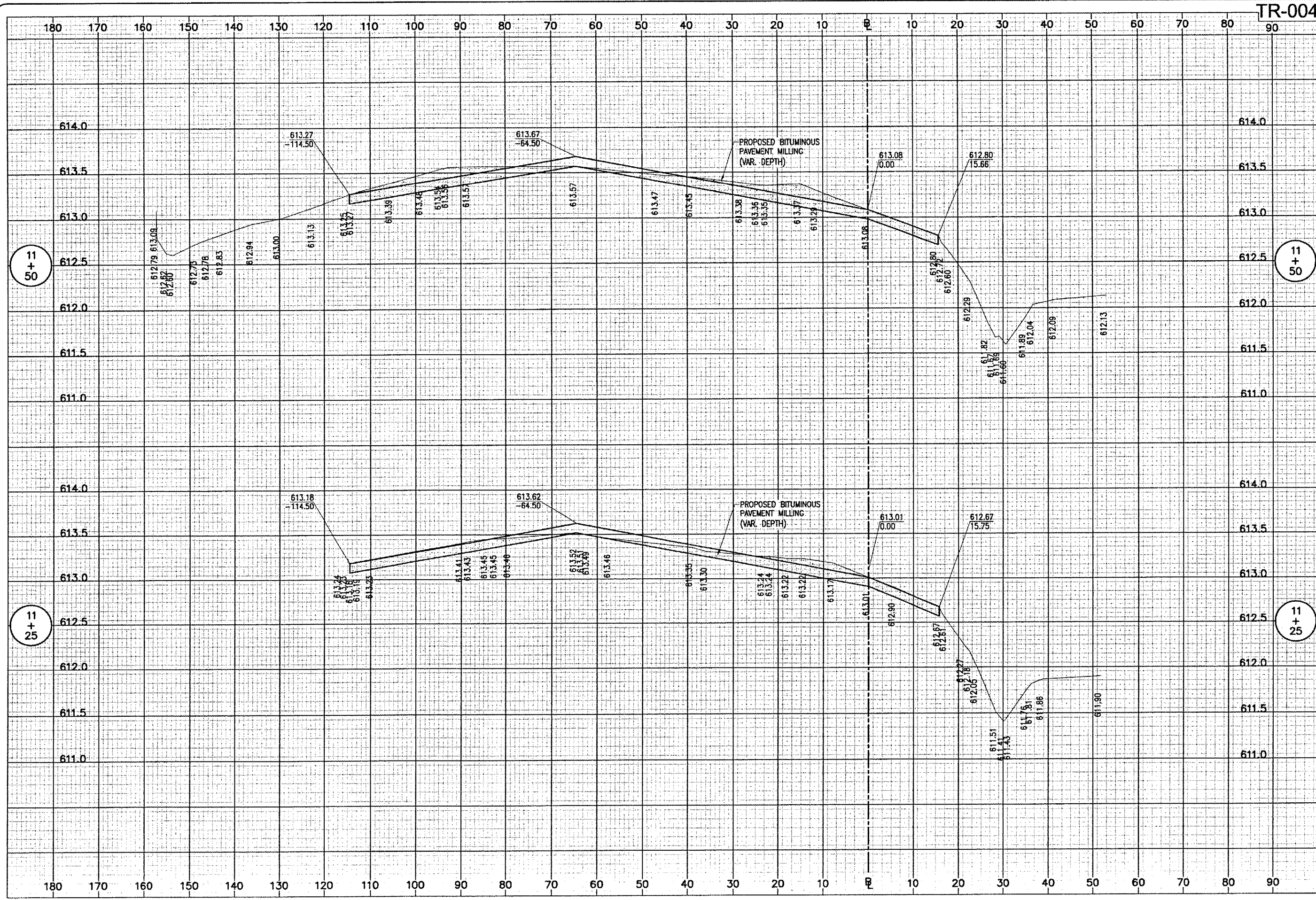

TR-004

DATE	REVISION

TRI-TOWNSHIP AIRPORT  
 SAVANNA, CARROLL COUNTY  
 ILLINOIS

IL PROJ.: SFY-3712 A.L.P. PROJ.: J-17-0091-B13

Hanson Project No.	82607XXD_0800
Filename	R-303XS.DWG
Scale	1"=10'H. & 1"=0.5'V.
Date	06/07/07
LAYOUT	CCC 06/07/07
DRAWN	CCC 06/07/07
REVIEWED	CAH 06/12/07



Hanson Professional Services Inc.  
 1525 South Sixth Street  
 Springfield, Illinois 62703-2886  
 Offices Nationwide

OVERLAY HANGAR  
 APRON AND TAXIWAY  
 PROPOSED CROSS-SECTIONS  
 FOR HANGAR PAVEMENT  
 STA. 11+25 TO STA. 11+50

AUG 24, 2007 9:25 AM BAK  
 \\AIRPORTS\SAVANNA\826-07\X\MAPPORT\SHEETS\R-304XS.DWG - STA. 11+75 TO STA. 12+00

TR-004

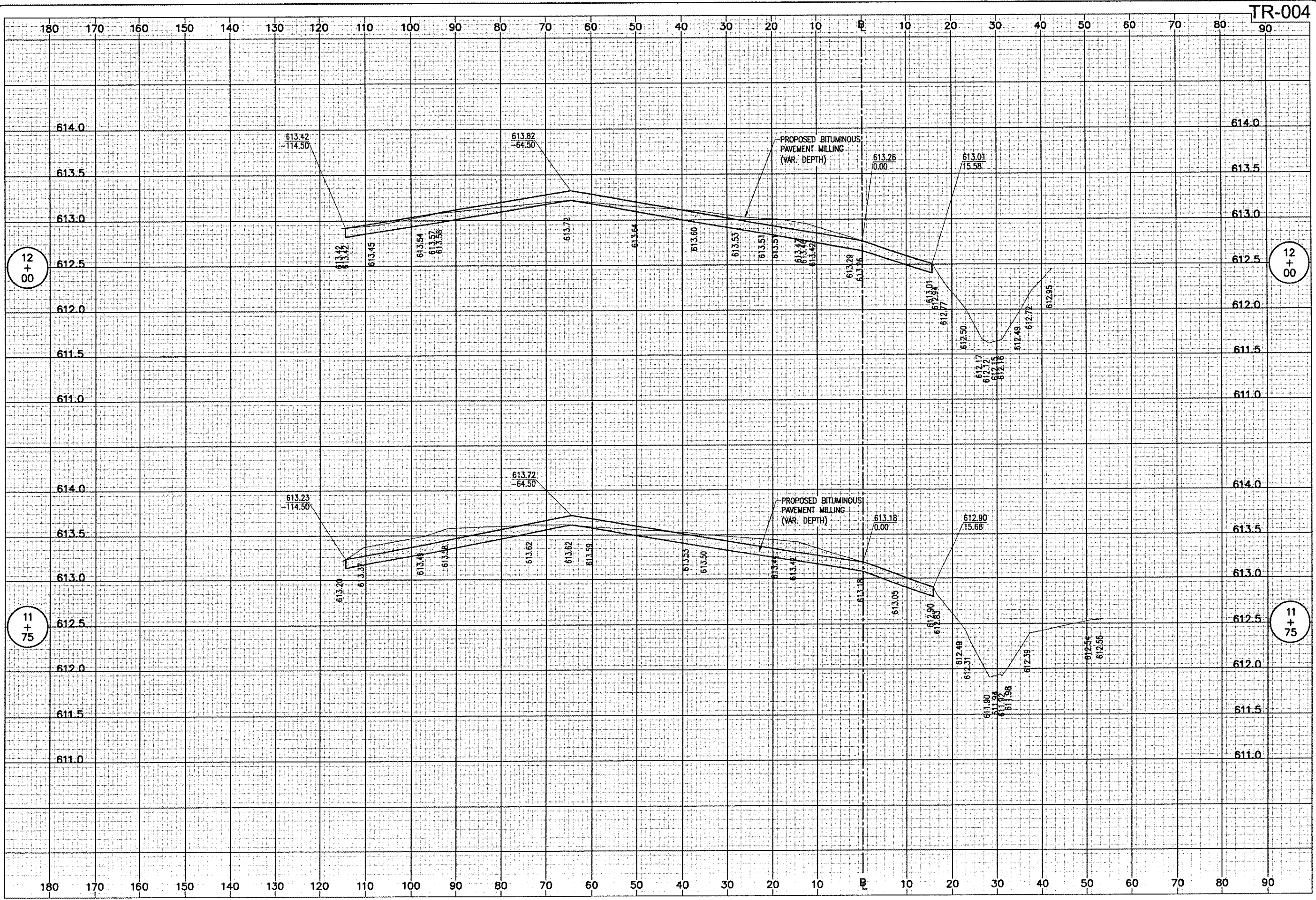

DATE	REVISION

TRI-TOWNSHIP AIRPORT  
 SAVANNA, CARROLL COUNTY  
 ILLINOIS

IL. PROJ.: SPY-3712 A.L.P. PROJ.: 3-17-0091-B13

Project No.	82607TXXD_0800
Drawn	R-304XS.DWG
Scale	1"=10'H. & 1"=0.5'V.
Date	06/07/07
LAYOUT	CCC
DRAWN	CCC
REVIEWED	CAH
	06/07/07
	06/07/07
	06/12/07



OVERLAY HANGAR  
 APRON AND TAXIWAY  
 PROPOSED CROSS-SECTIONS  
 FOR HANGAR PAVEMENT  
 STA. 11+75 TO STA. 12+00

AUG 24, 2007 9:26 AM BAK  
 \\AIRPORTS\SAVANNA\828-OTIXY\AIRPORT\SHEETS\R-305XS.DWG - STA. 12+25 TO STA. 12+50

TR-004

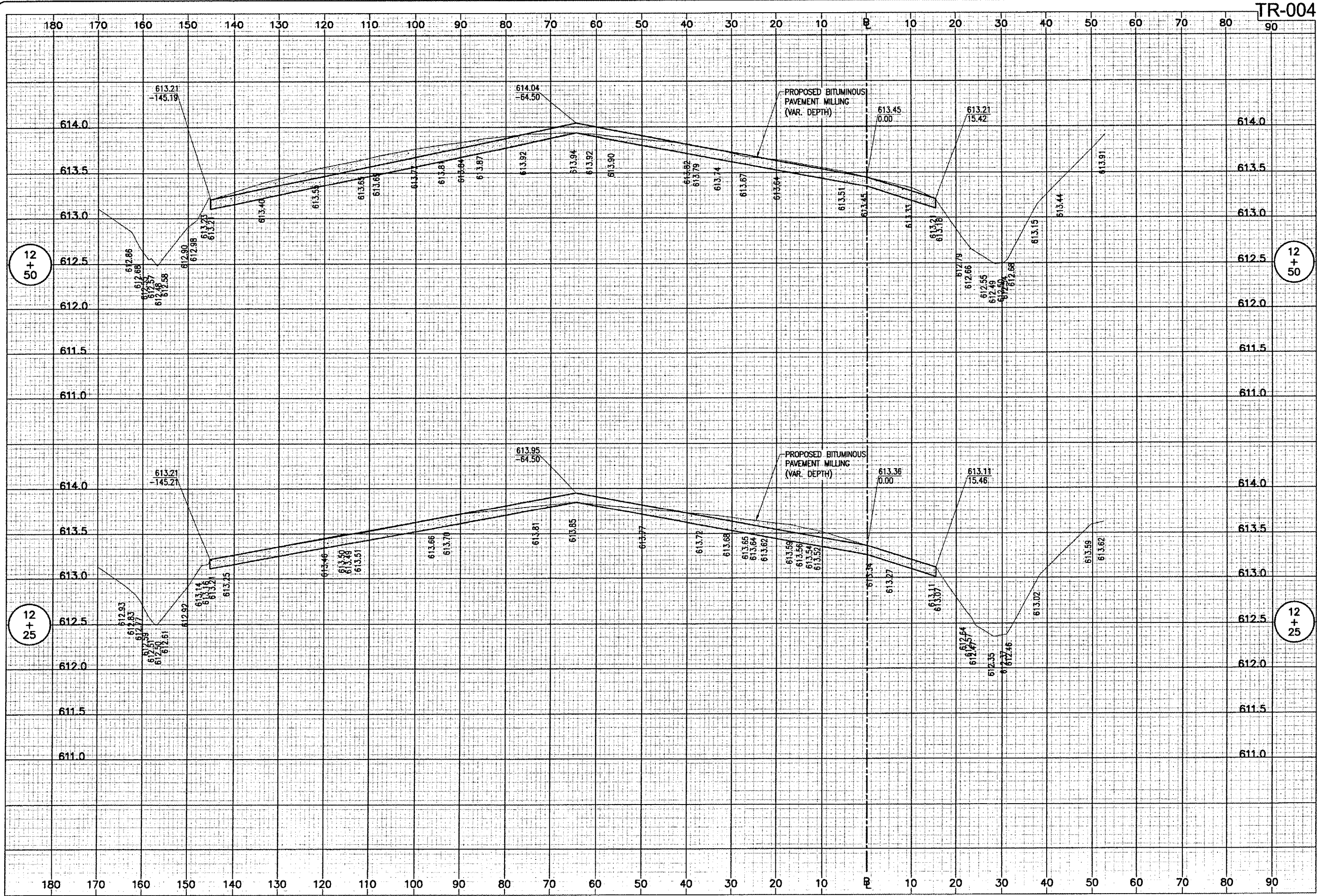

12  
+  
50

12  
+  
50

12  
+  
25

12  
+  
25

DATE	REVISION

TRI-TOWNSHIP AIRPORT  
 SAVANNA, CARROLL COUNTY  
 ILLINOIS

IL PROJ. SFY-3712 A.I.P. PROJ. 3-17-0091-B13

Human Project No. 82607TXD_0800	Reference R-305XS.DWG
Scale 1"=10'H. & 1"=0.5'V.	Date 06/07/07
LAYOUT	CCC 06/07/07
DRAWN	CCC 06/07/07
REVIEWED	CAH 06/12/07

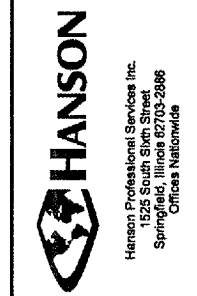

OVERLAY HANGAR  
 APRON AND TAXIWAY

PROPOSED CROSS-SECTIONS  
 FOR HANGAR PAVEMENT  
 STA. 12+25 TO STA. 12+50

AUG 24, 2007 9:27 AM BAK  
 I:\AIRPORTS\SAVANNA\B26-OTTKY\AIRPORT\SHEET5.P-306X5.DWG - STA. 12+75 TO STA. 13+00

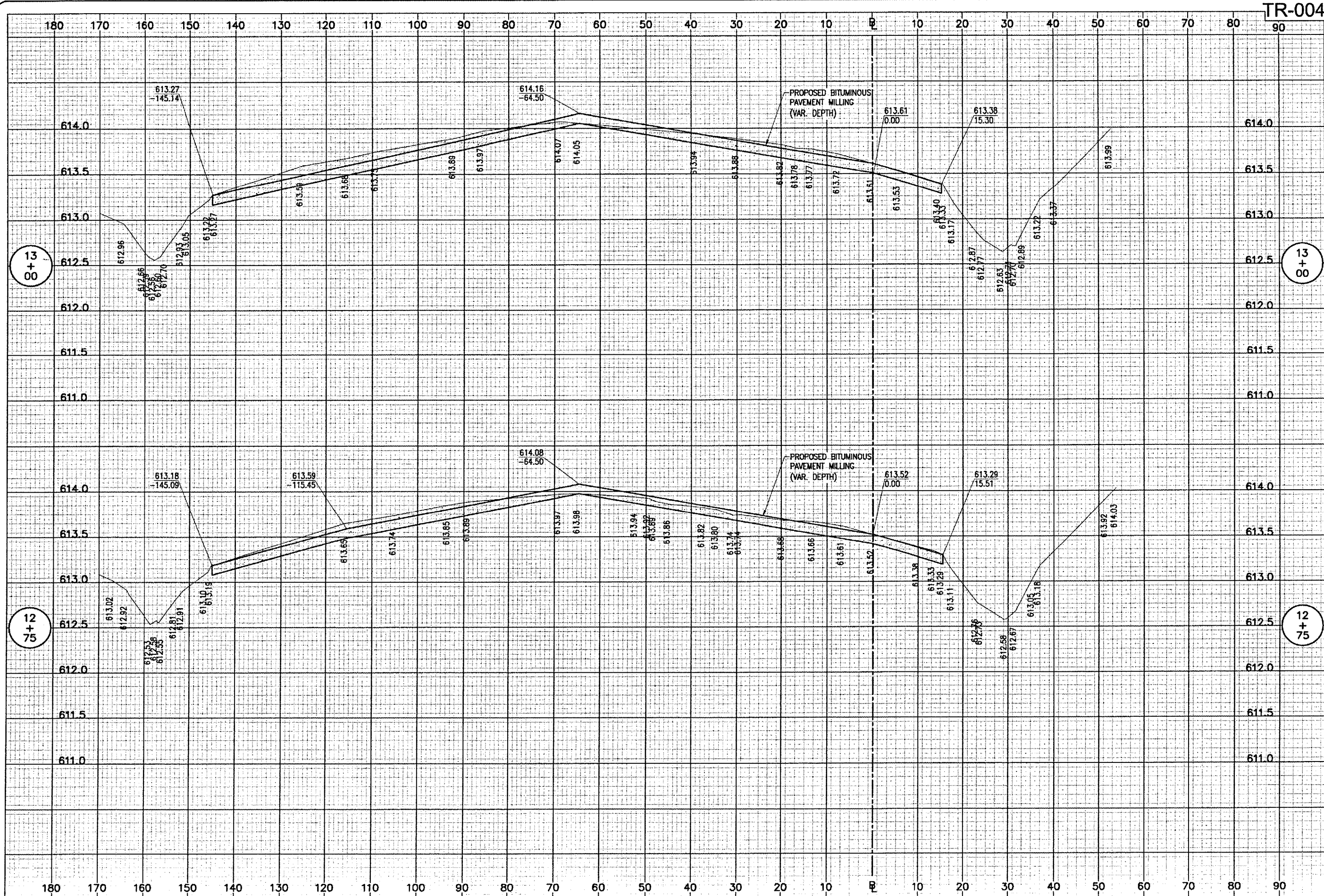

TR-004

13  
+  
00

13  
+  
00

12  
+  
75

12  
+  
75

DATE	REVISION

TRI-TOWNSHIP AIRPORT  
 SAVANNA, CARROLL COUNTY  
 ILLINOIS

IL PROJ.: SFY-3712 A.I.P. PROJ.: 3-17-0091-B13

Hanson Project No.	82607TXD_0800
Filename	R-306X5.DWG
Scale	1"=10'H. & 1"=0.5'V.
Date	06/07/07
LAYOUT	CCC 06/07/07
DRAWN	CCC 06/07/07
REVIEWED	CAH 06/12/07

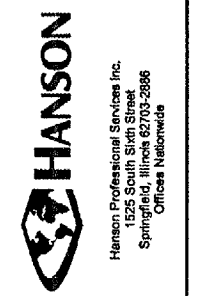

OVERLAY HANGAR  
 APRON AND TAXIWAY

PROPOSED CROSS-SECTIONS  
 FOR HANGAR PAVEMENT  
 STA. 12+75 TO STA. 13+00

AUG 24, 2007 9:27 AM BAK  
 I:\AIRPORTS\SAVANNA\826-OTTY\AIRPORT\SHEETS\R-307XS.DWG - STA. 13+25 TO STA. 13+50

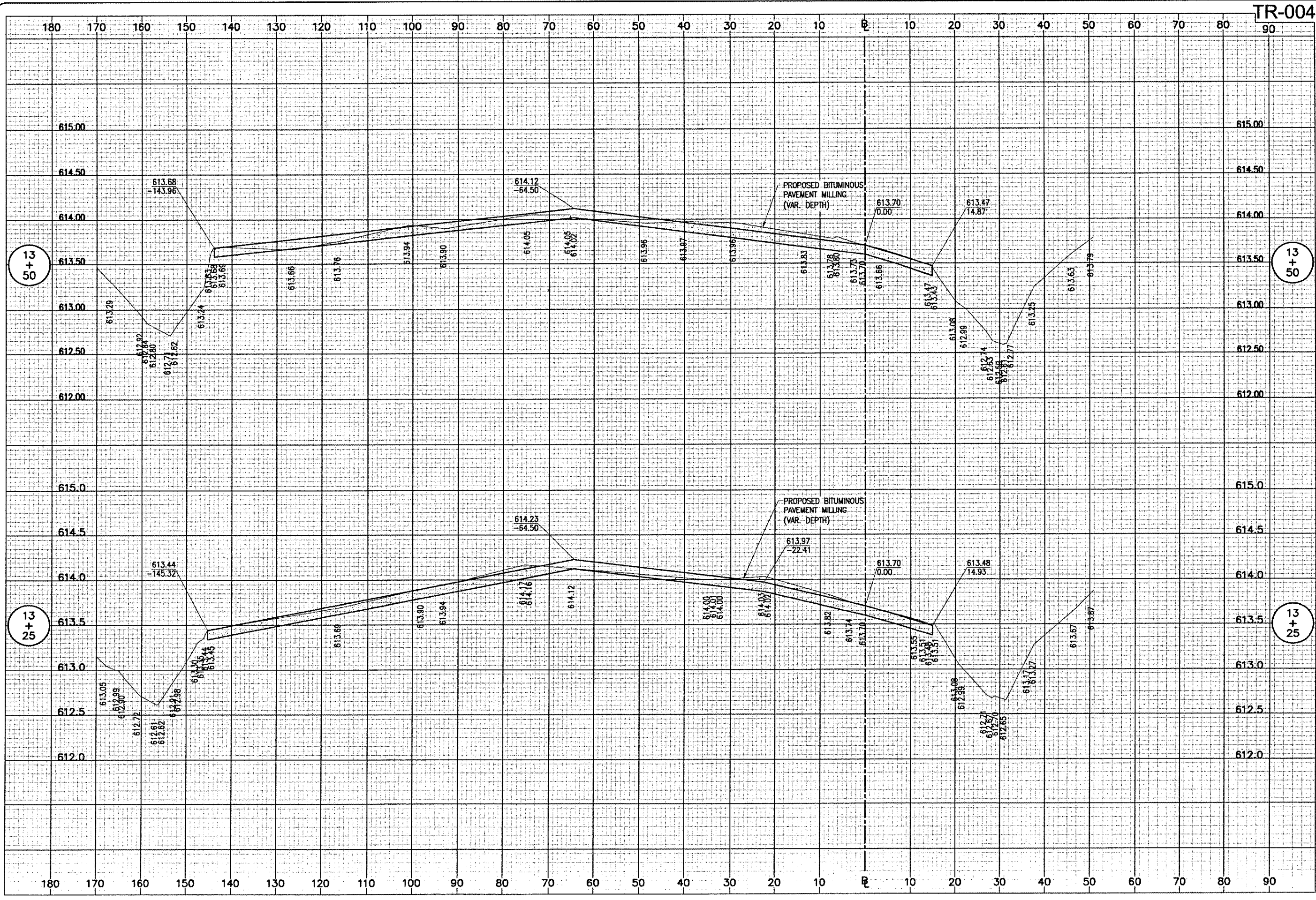

TR-004

13  
+  
50

13  
+  
50

13  
+  
25

13  
+  
25

DATE	REVISION	BY

TRI-TOWNSHIP AIRPORT  
 SAVANNA, CARROLL COUNTY  
 ILLINOIS  
 IL PROJ.: SFY-3712 A.I.P. PROJ.: 3-17-0091-B13

DESCRIPTION	DATE
LAYOUT	06/07/07
DRAWN	06/07/07
REVIEWED	06/07/07

**HANSON**  
 Hanson Professional Services Inc.  
 1525 South State Street  
 Springfield, Illinois 62703-2896  
 Offices Nationwide

OVERLAY HANGAR  
 APRON AND TAXIWAY  
 PROPOSED CROSS-SECTIONS  
 FOR HANGAR PAVEMENT  
 STA. 13+25 TO STA. 13+50



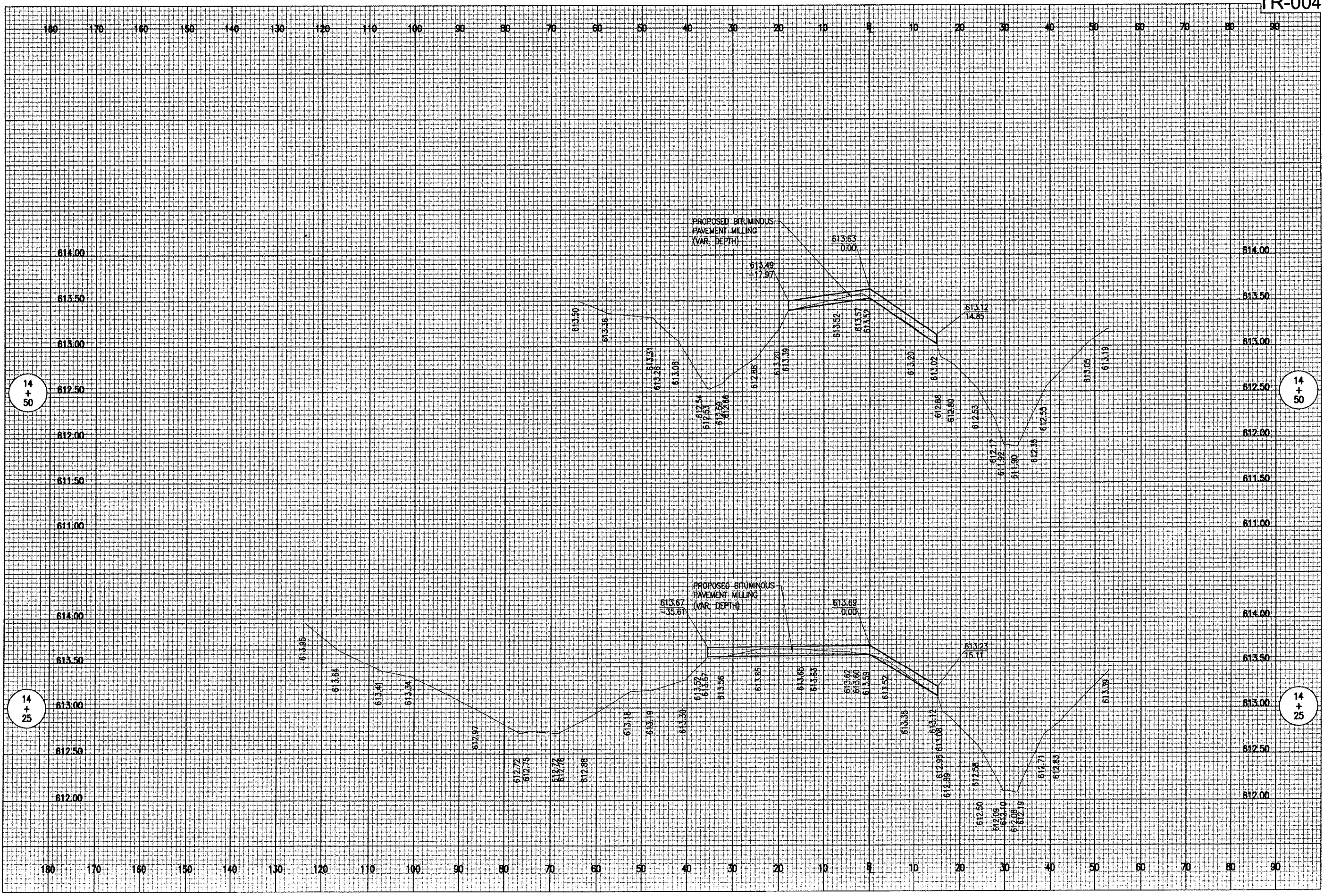



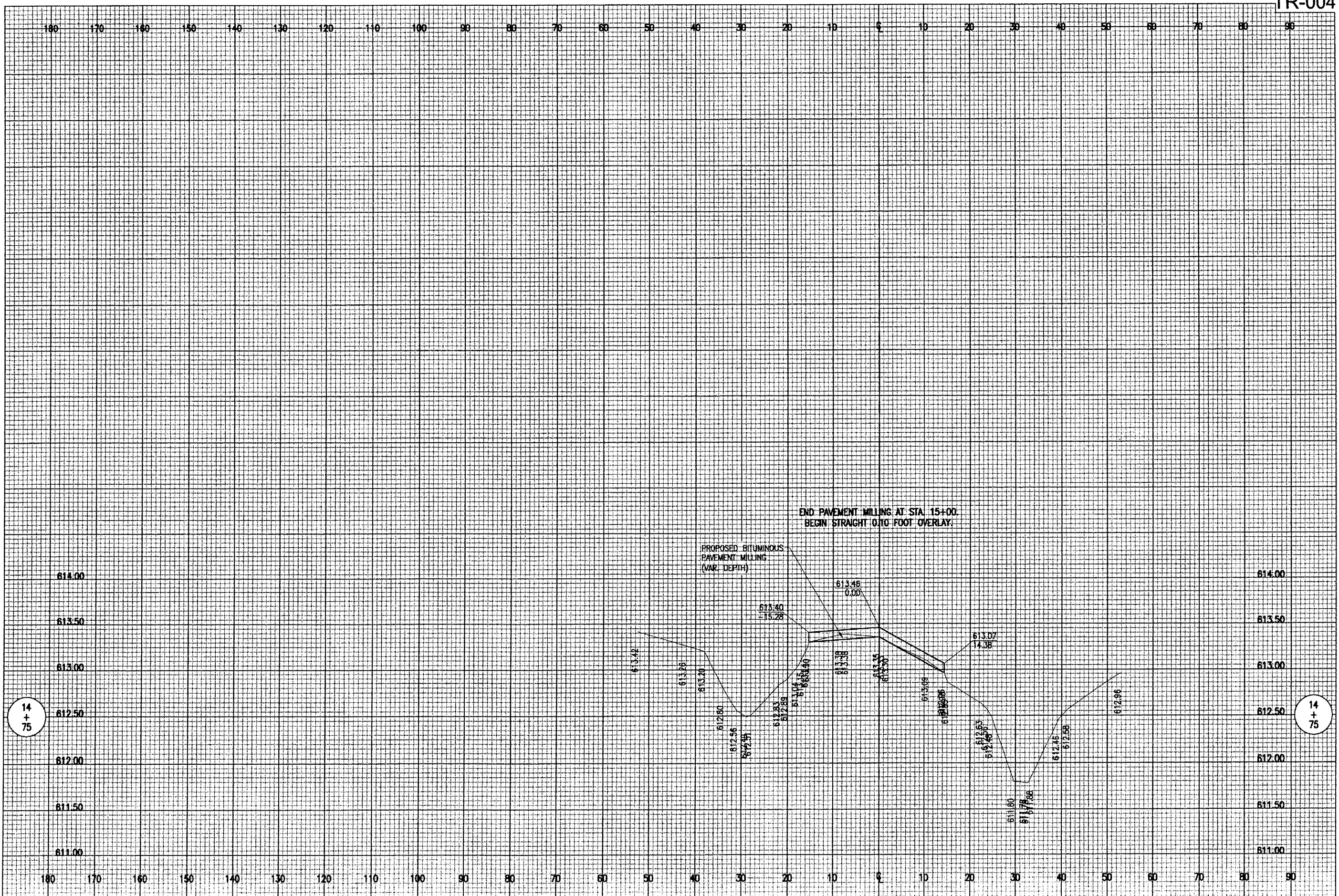

DATE	REVISION	BY

TRI-TOWNSHIP AIRPORT  
 SAVANNA, CARROLL COUNTY  
 ILLINOIS

IL. PROJ.: SFY-3712 A.I.P. PROJ.: 3-17-0091-B13

LAYOUT	CCC	06/07/07
DRAWN	CCC	06/07/07
REVIEWED	CAH	06/12/07

Hanson Project No. 82607TXD\_0800  
 Elevation R-310XS.DWG  
 Scale 1"=10'H. & 1"=0.5'V.  
 Date 06/07/07



OVERLAY HANGAR  
 APRON AND TAXIWAY

PROPOSED CROSS-SECTIONS  
 FOR HANGAR PAVEMENT  
 STA. 14+75