

□ DENOTES WORK INCLUDED IN THE COST OF OTHER ITEMS

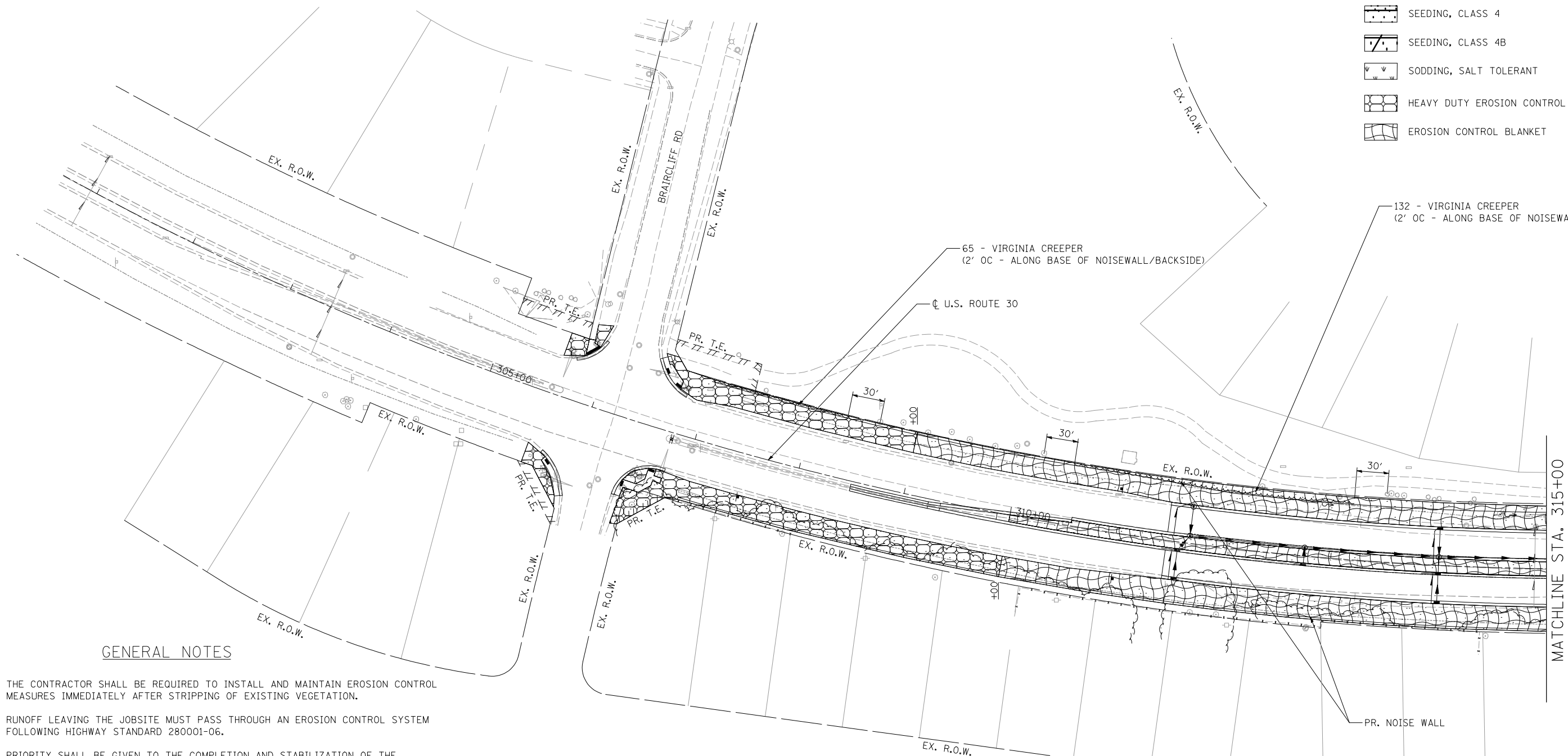

LEGEND

- SEEDING, CLASS 2A
- SEEDING, CLASS 4
- SEEDING, CLASS 4B
- SODDING, SALT TOLERANT
- HEAVY DUTY EROSION CONTROL BLANKET
- EROSION CONTROL BLANKET

GENERAL NOTES

1. THE CONTRACTOR SHALL BE REQUIRED TO INSTALL AND MAINTAIN EROSION CONTROL MEASURES IMMEDIATELY AFTER STRIPPING OF EXISTING VEGETATION.
2. RUNOFF LEAVING THE JOBSITE MUST PASS THROUGH AN EROSION CONTROL SYSTEM FOLLOWING HIGHWAY STANDARD 280001-06.
3. PRIORITY SHALL BE GIVEN TO THE COMPLETION AND STABILIZATION OF THE DISTURBED AREAS. WORK IN THESE AREAS SHALL NOT BE PROLONGED IN AN ATTEMPT THAT ALL FINAL GRADING AND STABILIZATION CAN TAKE PLACE AT ONE TIME.
4. PERMANENT LANDSCAPING ITEMS SHALL BE IMPLEMENTED IN CONJUNCTION WITH CONSTRUCTION STAGING.
5. VILLAGE WATER AND SEWER MAINS MAY BE LOCATED IN THE LANDSCAPE AREA.
6. THE CONTRACTOR WILL NOT BE ALLOWED TO PROCEED WITH ANY PLANTING WORK UNTIL ALL UTILITY OWNERS FIELD LOCATE THEIR FACILITIES WHICH MAY INTERFERE WITH CONSTRUCTION OPERATIONS.
7. THE ACTUAL LOCATION OF PROPOSED LANDSCAPING WILL BE ADJUSTED IN THE FIELD TO AVOID UTILITIES.
8. UNDERBRUSH OR DEBRIS AT PLANTING LOCATIONS SHALL BE REMOVED AND DISPOSED OF ACCORDING TO SECTION 201 OF THE STANDARD SPECIFICATIONS. THIS WORK WILL NOT BE PAID FOR SEPARATELY, BUT THE COSTS SHALL BE CONSIDERED AS INCLUDED IN THE CONTRACT UNIT PRICES FOR THE CONSTRUCTION ITEMS INVOLVED, AND NO ADDITIONAL COMPENSATION WILL BE ALLOWED.

9. THE CONTRACTOR SHALL TAKE ALL NECESSARY PRECAUTIONS FOR THE PROTECTION OF EXISTING PLANT MATERIAL FOR WHICH THE CONTRACT DOES NOT PROVIDE REMOVAL. THE PROTECTION OF EXISTING PLANT MATERIAL AND THE REPAIR OR REPLACEMENT OF EXISTING PLANT MATERIAL DAMAGED BY THE CONTRACTOR SHALL BE DONE IN ACCORDANCE WITH THE REQUIREMENTS OF SECTION 201 OF THE STANDARD SPECIFICATIONS.
10. FERTILIZER NUTRIENTS SHALL BE APPLIED AT THE RATE SPECIFIED IN SECTIONS 250 & 252 OF THE STANDARD SPECIFICATIONS.
11. PLANTINGS SHOULD BE 10' MIN. FROM RIPRAP AND 5' MIN. BEHIND GUARDRAIL.
12. THE SEEDING DATES FOR BARE EARTH SEEDING OF MIXTURE CLASS 4 AND 4B SHALL BE FROM NOVEMBER 15 TO MARCH 15. ALL SEEDING NOT SOWN ACCORDING TO THE SPECIFIED SEASONAL DATE SHALL REQUIRE PRIOR WRITTEN APPROVAL FROM THE ENGINEER. FAILURE TO SECURE SUCH APPROVAL SHALL RESULT IN THE REJECTION OF THE SEEDING AND REPLACEMENT BY THE CONTRACTOR AT HIS/HER EXPENSE.

13. THE LOCATION OF ALL PLANT MATERIAL SHALL BE STAKED BY CONTRACTOR. THE ENGINEER WILL CONTACT FABIOLA QUIROZ OF THE ROADSIDE DEVELOPMENT UNIT AT (847) 705-4596, AT LEAST 7 DAYS PRIOR TO PLANTING FOR LAYOUT APPROVAL OF THE TREES, SHRUBS, AND VINES. INDIVIDUAL TREES SHALL BE MARKED WITH IDENTITIES WRITTEN ON THE FLAGS. FLAGS SHALL BE OF VARIOUS COLORS DENOTING THE VARIOUS TREE TYPES. SHRUBS SHALL BE OUTLINED WITH STAKES AND PAINTED LINES.
14. BUILD BERMS BETWEEN INLETS ON THE PROPOSED MEDIAN FROM STA 435+00.00 TO STA 441+75.00. SEE DETAIL.

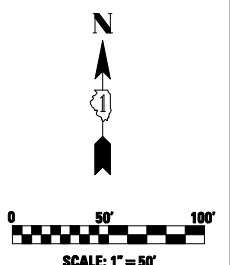

USER NAME = Plotted by Roadways8	DESIGNED - RK	REVISED -
	DRAWN - RK	REVISED -
PLOT SCALE = 100.0000' / IN.	CHECKED - ST	REVISED -
PLOT DATE = 6/8/2012	DATE - 04/2012	REVISED -

**STATE OF ILLINOIS
DEPARTMENT OF TRANSPORTATION**

**PERMANENT EROSION CONTROL AND LANDSCAPING PLANS
U.S. ROUTE 30 - BRIARCLIFF RD. TO U.S. ROUTE 34**

SCALE: 1"=50' SHEET NO. 1 OF 10 SHEETS STA. 300+64.50 TO STA. 315+00.00

F.A.P. RTE.	SECTION	COUNTY	TOTAL SHEETS	SHEET NO.
349	11 WRS-3	KENDALL	527	236
CONTRACT NO. 60I32				
FED. ROAD DIST. NO. 1 ILLINOIS FED. AID PROJECT				