

REMOVAL LEGEND

- PVMNT - PAVEMENT REMOVAL
- MILL - (US 30) HOT-MIX ASPHALT SURFACE REMOVAL; VARIABLE DEPTH
- (IL 31) HOT-MIX ASPHALT SURFACE REMOVAL; 3"
- HMA-SH - PAVED SHOULDER REMOVAL
- MEDIAN - MEDIAN REMOVAL
- LIR - LINEAR ITEM REMOVAL
- SSW - STORM SEWER/CULVERT REMOVAL
- CURB - CURB REMOVAL
- TREE - TREE, STUMP, OR SHRUB REMOVAL
- TF - TEMPORARY TREE PROTECTION FENCE
- REM - ITEM REMOVAL
- HMA-EN - HOT-MIX ASPHALT ENTRANCE REMOVAL
- PCC-EN - P.C.C. ENTRANCE REMOVAL
- AS - AGGREGATE SHOULDER REMOVAL
- A - STRUCTURE SHALL BE ADJUSTED
- ADJ - STRUCTURE SHALL BE ADJUSTED WITH NEW FRAME, LID, CONE, AND CHIMNEY SEAL
- M - MAILBOX TO BE RELOCATED (INCIDENTAL)
- S - SIGN TO BE REMOVED (INCIDENTAL)

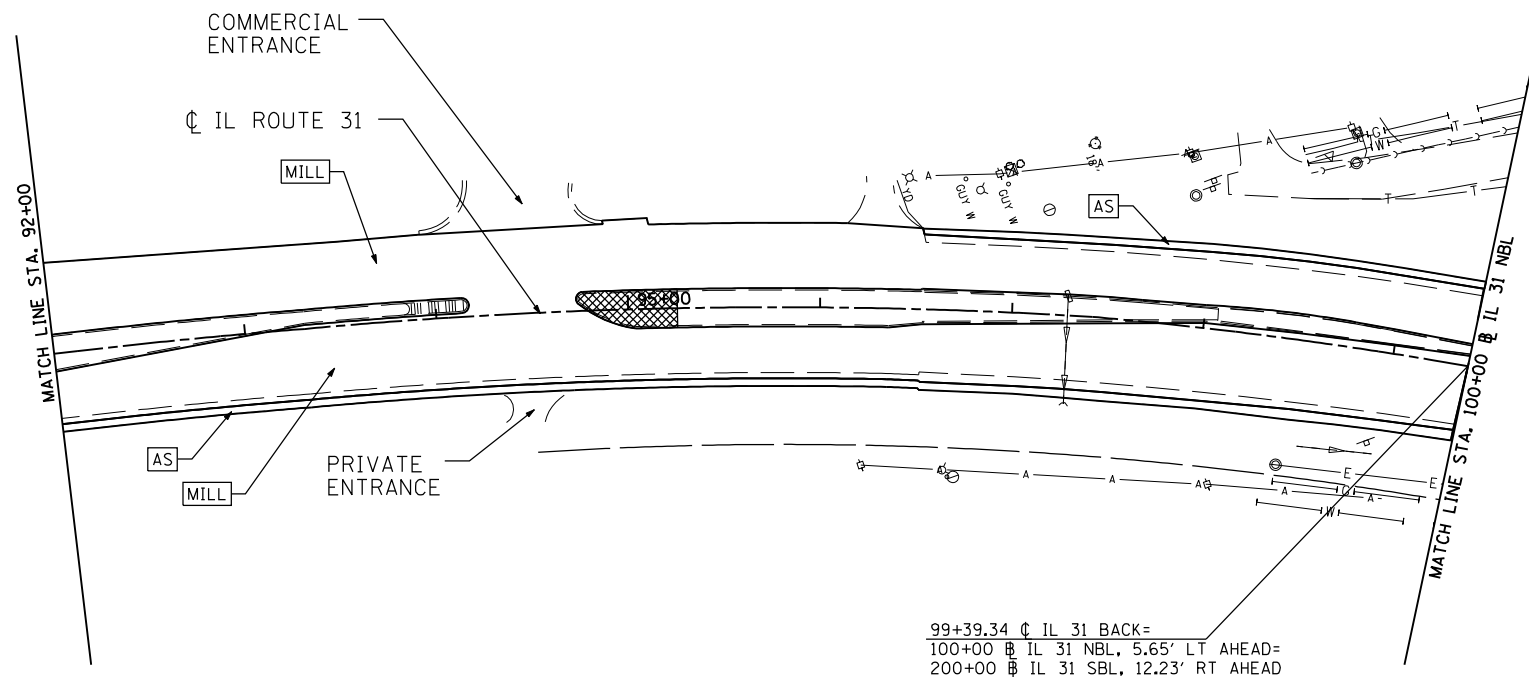

99+39.34 CL IL 31 BACK=
 100+00 CL IL 31 NBL, 5.65' LT AHEAD=
 200+00 CL IL 31 SBL, 12.23' RT AHEAD

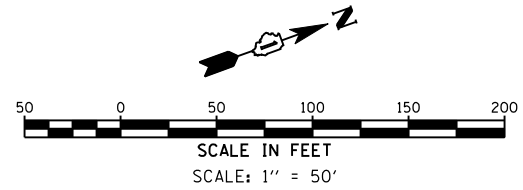

P:\Jobs\2010\20100303\cd\site\vgd\00\0160133-sit+rem-03-l.dgn
 6/15/2012 5:36:45 PM

USER NAME = 1654	DESIGNED - JWB	REVISED -
	DRAWN - JWB	REVISED -
PLOT SCALE = 100.0000' / IN.	CHECKED - RS	REVISED -
PLOT DATE = 6/15/2012	DATE - 06/15/2012	REVISED -

**STATE OF ILLINOIS
DEPARTMENT OF TRANSPORTATION**

**U.S. ROUTE 30 AT IL ROUTE 31
REMOVAL PLAN - IL ROUTE 31**

SCALE: 1"=50' SHEET NO. REM-3 OF 7 STA. 79+00 TO STA. 100+00

F.A.P. RTE.	SECTION	COUNTY	TOTAL SHEETS	SHEET NO.
349	(10 & 11 VB) R-3	*	507	68
* KANE AND KENDALL			CONTRACT NO. 60133	
ILLINOIS FED. AID PROJECT				