

**LEGEND**

- ① STEEL PLATE BEAM GUARDRAIL, TYPE A, 6 FT POSTS
- ② TRAFFIC BARRIER TERMINAL, TYPE 1 (SPECIAL) TANGENT
- ③ CONCRETE BARRIER, SINGLE FACE, 42" HEIGHT
- ④ TRAFFIC BARRIER TERMINAL, TYPE 6
- ⑤ AGGREGATE SHOULDER, TYPE B, 8"
- ⑥ AGGREGATE WEDGE SHOULDER, TYPE B, 3" MAX.
- ⑦ B-6.24 CURB AND GUTTER
- ⑧ CONCRETE MEDIAN, TYPE SB-6 OR SB-6.24
- ⑨ CONCRETE BARRIER, DOUBLE FACE, 42" HEIGHT
- ⑩ TOPSOIL, FURNISH & PLACE, 30"
- ⑪ CONCRETE MEDIAN, 4"
- ⑫ HOT-MIX ASPHALT PAVEMENT (FULL DEPTH)
- ⑬ HOT-MIX ASPHALT SHOULDER
- ⑭ HOT-MIX ASPHALT PAVEMENT OVERLAY AND WIDENING
- ⑮ HOT-MIX ASPHALT ENTRANCE
- ⑯ P.C.C. PAVEMENT, 10" (JOINTED)
- ⑰ P.C.C. SHOULDER, 10"

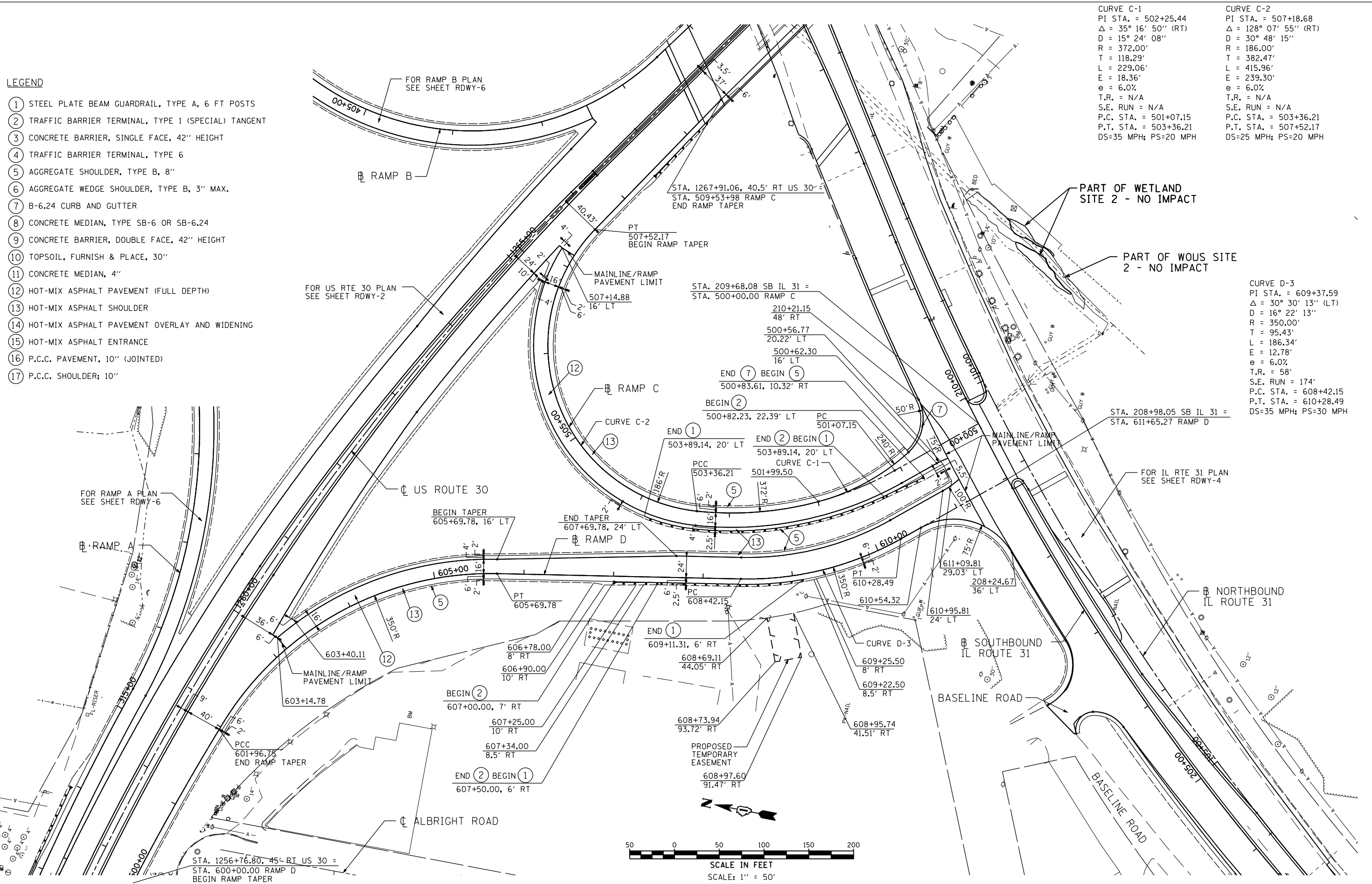

P:\Jobs\2010\20100303\cd\site\vgm\00\060133-sit-plan-06.dgn  
 6/15/2012 5:37:47 PM

**STATE OF ILLINOIS  
DEPARTMENT OF TRANSPORTATION**

**U.S. ROUTE 30 AT IL ROUTE 31  
ROADWAY PLAN - RAMP C AND RAMP D**

USER NAME = 1654	DESIGNED - JWB	REVISED -
	DRAWN - JWB	REVISED -
PLOT SCALE = 100.0000' / IN.	CHECKED - RS	REVISED -
PLOT DATE = 6/15/2012	DATE - 06/15/2012	REVISED -

SCALE: 1"=50' SHEET NO. RDWY-7 OF 7 (RAMP C) STA. 500+00 TO STA. 507+52 (RAMP D) STA. 600+00 TO STA. 609+96

F.A.P. RTE.	SECTION	COUNTY	TOTAL SHEETS	SHEET NO.
349	(10 & 11 VB) R-3	*	507	79
* KANE AND KENDALL			CONTRACT NO. 60133	
ILLINOIS FED. AID PROJECT				