

# STAGE I

**NOTE:**

FOR APPROACH SIGNING WHERE FLAGGERS ARE NEEDED TO STOP TRAFFIC FOR SHORT DURATIONS WHILE WORK ENCLOSES UPON THE LANE(S) OPEN TO TRAFFIC, FOLLOW IDOT HIGHWAY STANDARD 701326

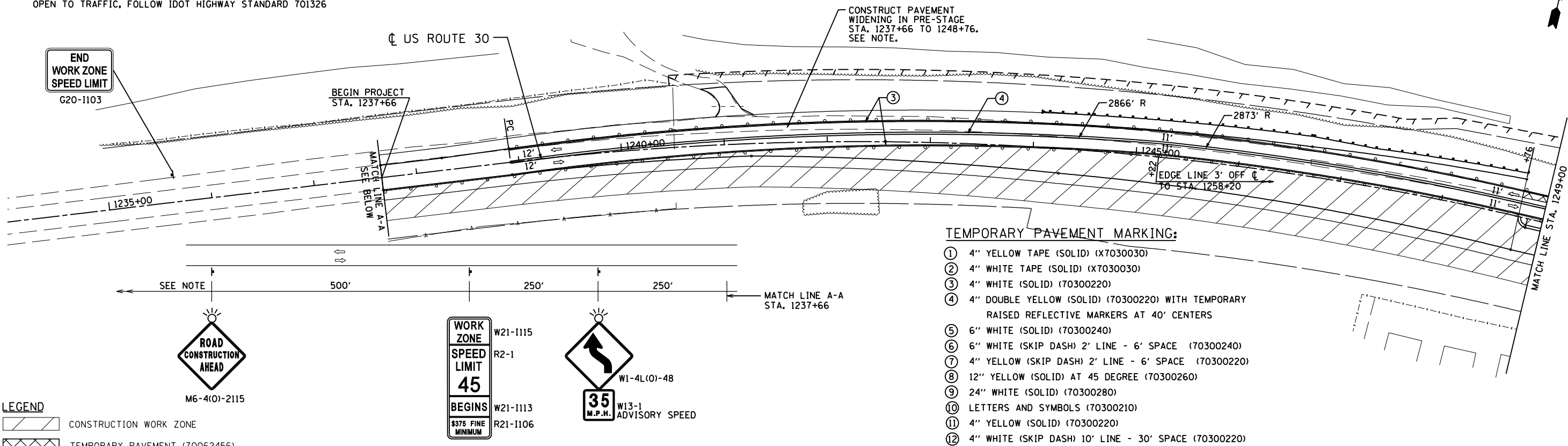

**TEMPORARY PAVEMENT MARKING:**

- ① 4" YELLOW TAPE (SOLID) (X7030030)
- ② 4" WHITE TAPE (SOLID) (X7030030)
- ③ 4" WHITE (SOLID) (70300220)
- ④ 4" DOUBLE YELLOW (SOLID) (70300220) WITH TEMPORARY RAISED REFLECTIVE MARKERS AT 40' CENTERS
- ⑤ 6" WHITE (SOLID) (70300240)
- ⑥ 6" WHITE (SKIP DASH) 2' LINE - 6' SPACE (70300240)
- ⑦ 4" YELLOW (SKIP DASH) 2' LINE - 6' SPACE (70300220)
- ⑧ 12" YELLOW (SOLID) AT 45 DEGREE (70300260)
- ⑨ 24" WHITE (SOLID) (70300280)
- ⑩ LETTERS AND SYMBOLS (70300210)
- ⑪ 4" YELLOW (SOLID) (70300220)
- ⑫ 4" WHITE (SKIP DASH) 10' LINE - 30' SPACE (70300220)

**LEGEND**

- CONSTRUCTION WORK ZONE
- TEMPORARY PAVEMENT (Z0062456)
- DIRECTION OF TRAFFIC
- DRUMS WITH BI-DIRECTIONAL STEADY BURN LIGHTS
- TYPE III BARRICADE
- IMPACT ATTENUATOR TEMPORARY (FULLY REDIRECTIVE, NARROW), TEST LEVEL 2 (Z0030255)
- TEMPORARY CONCRETE BARRIER (70400100)
- FLASHING ARROW BOARD

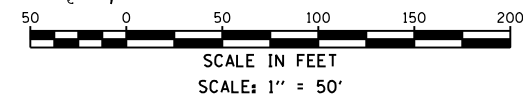
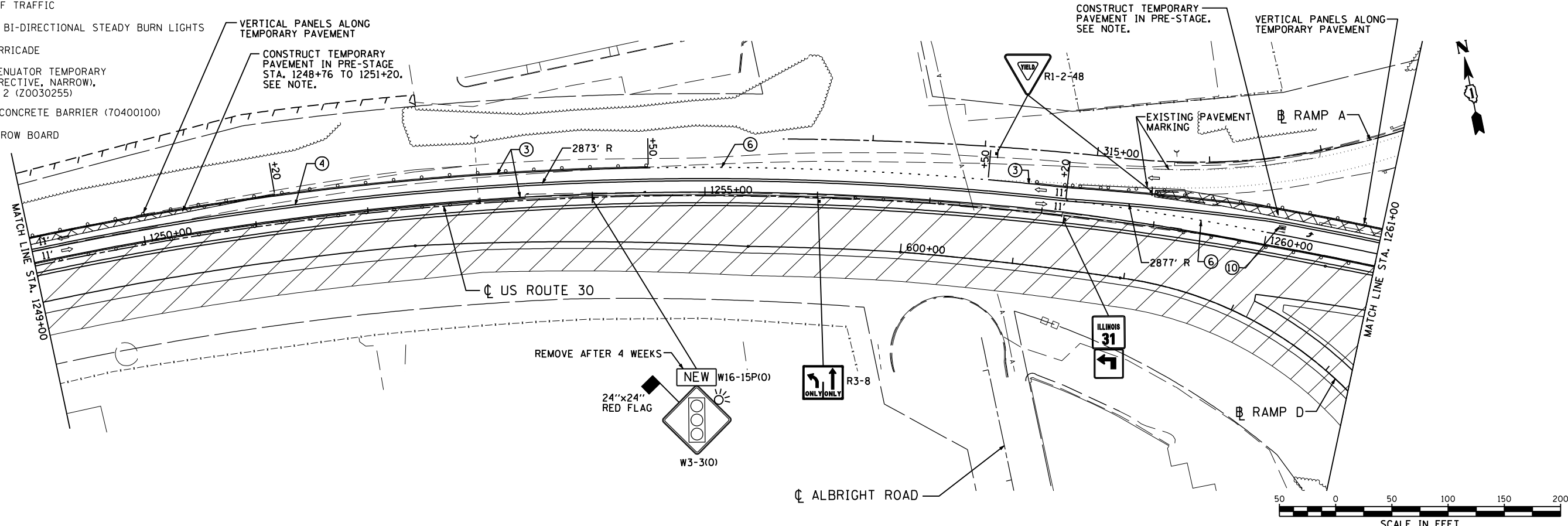

P:\Jobs\2010\201030033\cd\site\vdgn\00\0160133-sht+st+sl-01.dgn  
 8/8/2012 2:01:37 PM

USER NAME = 1654	DESIGNED - JWB	REVISED -
	DRAWN - JWB	REVISED -
PLOT SCALE = 100.0000' / IN.	CHECKED - RS	REVISED -
PLOT DATE = 8/8/2012	DATE - 06/15/2012	REVISED -

**STATE OF ILLINOIS  
DEPARTMENT OF TRANSPORTATION**

**U.S. ROUTE 30 AT IL ROUTE 31  
SUGGESTED STAGING AND TRAFFIC CONTROL - STAGE 1  
U.S. ROUTE 30**

SCALE: 1"=50' SHEET NO. MOT-3 OF 27 STA. 1234+00 TO STA. 1261+00

F.A.P. RTE.	SECTION	COUNTY	TOTAL SHEETS	SHEET NO.
349	(10 & 11 VB) R-3		507	90
* KANE AND KENDALL			CONTRACT NO. 60133	
ILLINOIS FED. AID PROJECT				