

# STAGE II

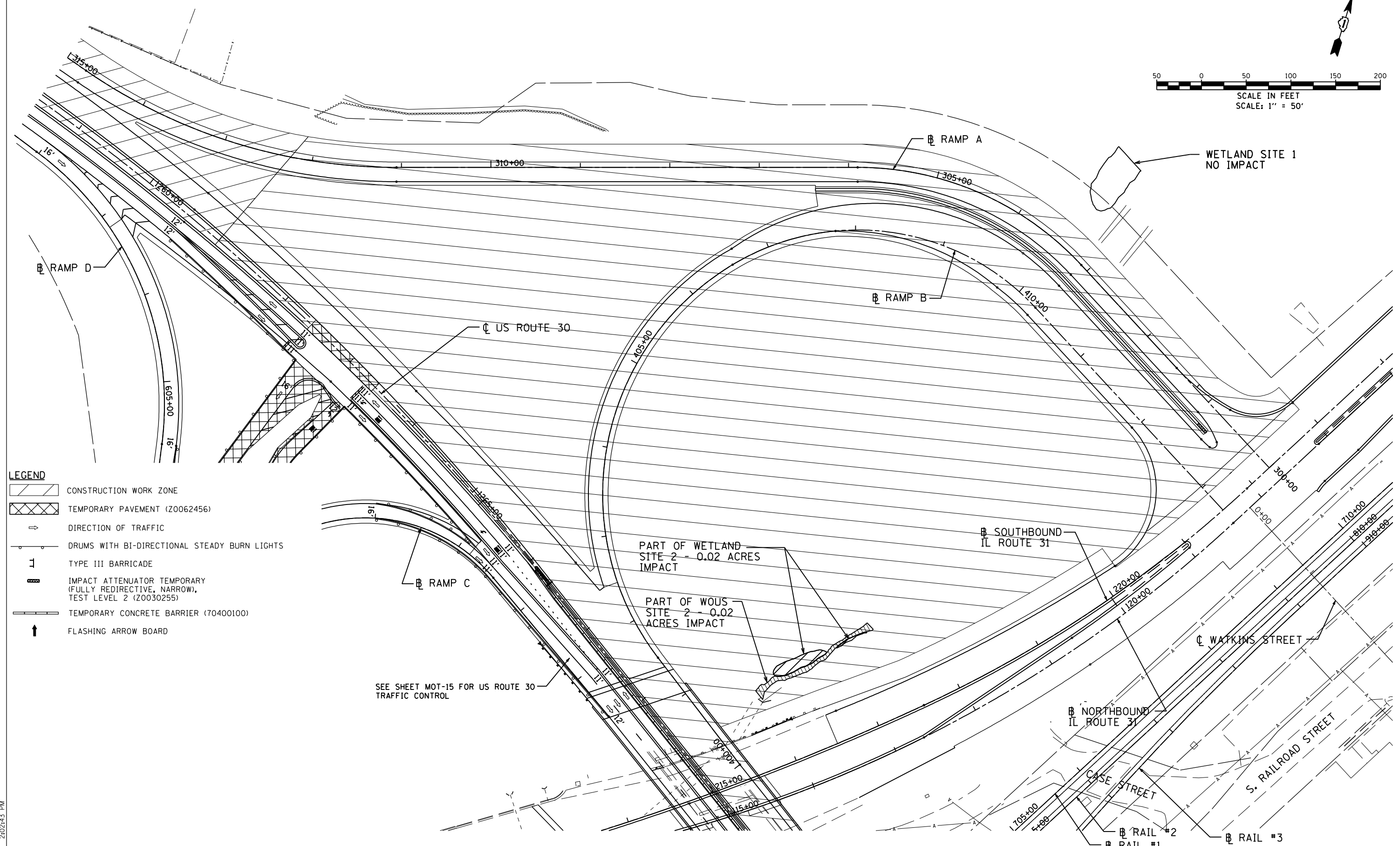
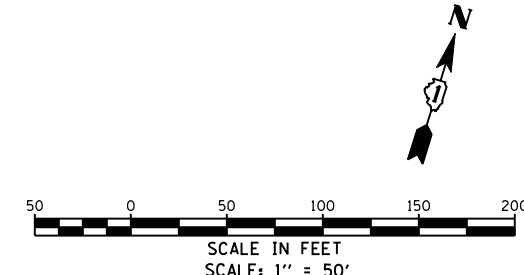

- LEGEND**
- CONSTRUCTION WORK ZONE
  - TEMPORARY PAVEMENT (Z0062456)
  - DIRECTION OF TRAFFIC
  - DRUMS WITH BI-DIRECTIONAL STEADY BURN LIGHTS
  - TYPE III BARRICADE
  - IMPACT ATTENUATOR TEMPORARY (FULLY REDIRECTIVE, NARROW), TEST LEVEL 2 (Z0030255)
  - TEMPORARY CONCRETE BARRIER (70400100)
  - FLASHING ARROW BOARD

SEE SHEET MOT-15 FOR US ROUTE 30 TRAFFIC CONTROL

P:\jobs\2010\20103003\cadd\site\vdgn\00\0160133-sht+mot-15-2-03.dgn  
 8/8/2012 2:02:43 PM

USER NAME = 1654	DESIGNED - JWB	REVISED -
	DRAWN - JWB	REVISED -
PLOT SCALE = 100.0000' / IN.	CHECKED - RS	REVISED -
PLOT DATE = 8/8/2012	DATE - 06/15/2012	REVISED -

**STATE OF ILLINOIS  
DEPARTMENT OF TRANSPORTATION**

**U.S. ROUTE 30 AT IL ROUTE 31  
SUGGESTED STAGING AND TRAFFIC CONTROL - STAGE 2  
RAMP A AND RAMP B**

SCALE: 1"=50' SHEET NO. MOT-15 OF 27

F.A.P. RTE. 349	SECTION (10 & 11 VB) R-3	COUNTY *	TOTAL SHEETS 507	SHEET NO. 102
* KANE AND KENDALL			CONTRACT NO. 60133	
ILLINOIS FED. AID PROJECT				