

WATERWAY INFORMATION TABLE

Drainage Area = 2.71 sq. mi.			Existing Overtopping Elev. = 639.67 ft. @ Sta. 113+50 Proposed Overtopping Elev. = 639.67 ft. @ Sta. 113+50						
Flood	Frequency (Year)	Discharge (C.F.S.)	Waterway Opening (Sq.Ft.)		Natural H.W.E.	Head (Feet)		Headwater Elev.	
			Exist.	Prop.		Exist.	Prop.	Exist.	Prop.
Ten Year	10	-	51.6	51.1	634.00	0.21	0	634.21	633.30
Design	50	-	60	60	635.03	2.00	0	637.03	634.08
Base	100	-	60	60	635.43	4.93	0	640.36	634.97
Max. Calc.	500	-	60	60	637.75	5.39	4.84	643.14	642.59

10-Year Velocity through Existing Structure = 4.4 fps
 10-Year Velocity through Proposed Structure = 4.4 fps
 All time H.W.E. = 642 to 643 on July 18, 1996
 Headwater elev. taken at existing river Sta. 43.76 along reach North 2SE.

BILL OF MATERIAL

Bar	No.	Size	Length	Shape
h200	4	#5	13'-10"	U
v200	4	#5	9'-10"	U
s200	40	#4	5'-11"	U
u200	6	#5	23'-0"	U
Concrete Removal			Cu Yd.	2.6
Reinforcement Bars			Pound	410
Concrete Collar			Cu Yd.	3.0
Precast Concrete Box Culvert 10 Ft x 6 Ft			Foot	36
Box Culvert End Section			Each	1

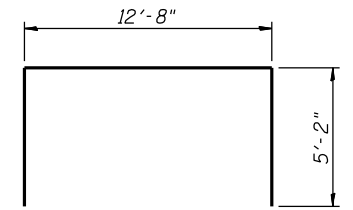

BAR u200

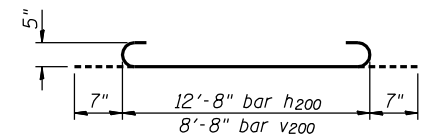

BARS h200 & v200

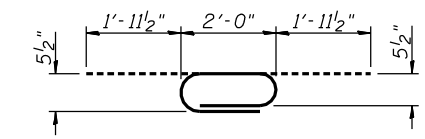

BAR s200

NOTES:

1. Work Sheets SB1, SB2 & SB3 together.

H:\Jobs\2010\20103003\CAD\Structural\Culvert-Ext\00\160133-sb3-details.dgn 8/2/2012 2:05:41PM

GRÄEF
 8501 W. Higgins Road, Suite 280
 Chicago, Illinois 60631; (773) 399-0112

USER NAME =	DESIGNED - J.J.G. 7/13/2012	REVISED -
	CHECKED - J.A.Z. 7/13/2012	REVISED -
PLOT SCALE =	DRAWN - E.U.B. 7/13/2012	REVISED -
PLOT DATE =	CHECKED - J.J.G. 7/13/2012	REVISED -

**STATE OF ILLINOIS
 DEPARTMENT OF TRANSPORTATION**

**WATERWAY INFORMATION TABLE & DETAILS
 U.S. RTE. 30 CULVERT EXTENSION (S.N. 045-0273)**

SHEET NO. SB3 OF 3 SHEETS

F.A.P. RTE.	SECTION	COUNTY	TOTAL SHEETS	SHEET NO.
349	(10 & 11VB) R-3	KANE	507	148
CONTRACT NO. 60133			ILLINOIS FED. AID PROJECT	