

PAVEMENT MARKING LEGEND

- 1 PAVEMENT MARKING - LINE 4" WHITE SOLID
- 2 PAVEMENT MARKING - LINE 4" YELLOW SOLID
- 3 PAVEMENT MARKING - LINE 4" WHITE 10' DASH, 30' SKIP
- 4 PAVEMENT MARKING - LINE 4" WHITE 2' DASH, 6' SKIP
- 5 PAVEMENT MARKING - LINE 4" YELLOW 2' DASH, 6' SKIP
- 6 PAVEMENT MARKING - DOUBLE LINE 4" YELLOW SOLID
- 7 PAVEMENT MARKING - LINE 6" WHITE SOLID
- 8 PAVEMENT MARKING - LINE 8" WHITE SOLID
- 9 PAVEMENT MARKING - LINE 8" YELLOW SOLID
- 10 PAVEMENT MARKING - LINE 12" WHITE SOLID
- 11 PAVEMENT MARKING - LINE 12" YELLOW SOLID
- 12 PAVEMENT MARKING - LINE 24" WHITE SOLID
- 13 PAVEMENT MARKING - SYMBOLS

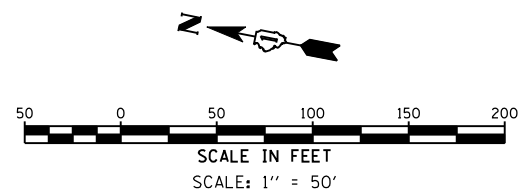
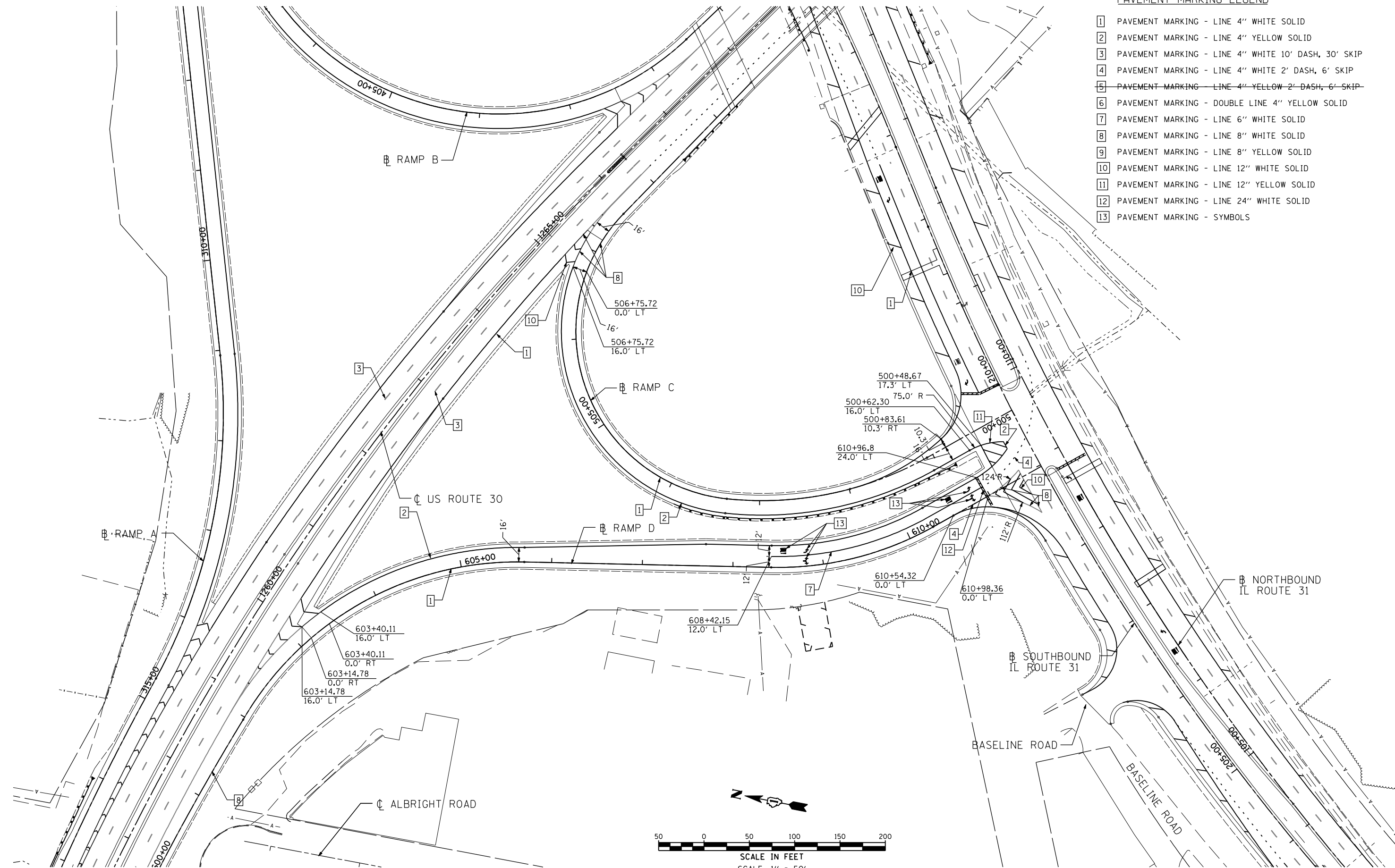

\$FILE# 5/16/2012 12:33:40 AM

USER NAME = 1654	DESIGNED - JWB	REVISED -
	DRAWN - JWB	REVISED -
PLOT SCALE = 100.0000' / IN.	CHECKED - RS	REVISED -
PLOT DATE = 5/16/2012	DATE - 05/11/2012	REVISED -

**STATE OF ILLINOIS**  
**DEPARTMENT OF TRANSPORTATION**

**U.S. ROUTE 30 AT IL ROUTE 31**  
**PAVEMENT MARKING PLAN - RAMP C AND RAMP D**  
 SCALE: 1"=50' SHEET NO. --

F.A.P. RTE.	SECTION	COUNTY	TOTAL SHEETS	SHEET NO.
349	(10 & 11 VB) R-3	-	507	164
KANE AND KENDALL			CONTRACT NO. 60133	
ILLINOIS FED. AID PROJECT				

(RAMP C) STA. 500+00 TO STA. 507+52  
 (RAMP D) STA. 600+00 TO STA. 609+96