

LIST OF UNDERPASS LIGHTING ITEMS TO BE REMOVED:

- 12- 50W LPS SUSPENDED MOUNT LUMINAIRES (6-ON CIRCUIT A&B AND 6 ON CIRCUIT E&F)
- 2- 12"x10"x6" SS JB ATTACHED TO PIER COLUMNS
- 6- 10"x8"x4" SS JB ATTACHED TO FACE OF THE PIER CAPS
- 12- 6"x4"x4" SS JB ATTACHED UNDERNEATH BRIDGE DECK.
- 72FT- 1" DIA. LIQUID TIGHT FLEXIBLE CONDUIT AND WIRING
- 567FT- 1" DIA. PVCC RGC ATTACHED TO THE STRUCTURE AND WIRING
- 32FT - 2 1/2" DIA. PVCC RGC ATTACHED TO THE STRUCTURE AND WIRING

NOTES:

1. THE EXISTING HIGH MAST LIGHTING TOWER UNITS, THE LIGHTING CONTROLLER AND UTILITY SERVICE DROP SHALL BE REMOVED AFTER THE PROPOSED LIGHTING SYSTEM IS FULLY OPERATIONAL. REMOVED ITEMS SHALL BE SALVAGED AS DESCRIBED IN THE SPECIFICATIONS AND BREAKDOWN THE FOUNDATIONS AS APPLICABLE.
2. THE EXISTING UNDERGROUND UNIT DUCTS IN CONDUIT CROSSING THE ROADWAY SHALL NOT BE DISRUPTED DURING EXISTING PAVEMENT REMOVAL AND INSTALLATION. CONTRACTOR SHALL BE RESPONSIBLE TO COORDINATE WITH THE ROADWAY CONSTRUCTION STAGES. ANY DAMAGE TO EXISTING UNIT DUCTS IN CONDUIT CROSSING THE ROADWAY SHALL BE REPLACED IN KIND THE SAME DAY SUCH THAT LIGHTING SYSTEM IS FULLY OPERATIONAL BEFORE NIGHT. THIS WORK SHALL BE APPROVED BY THE ENGINEER AND AT NO ADDITIONAL COST TO THE STATE.
3. THE EXISTING UNDERPASS LIGHTING SYSTEM REMOVAL SHALL BE COORDINATED WITH THE BRIDGE STRUCTURE REMOVAL. DURING CONSTRUCTION OF THE EASTBOUND U.S. ROUTE 30 BRIDGE DECK, CONTRACTOR SHALL BE RESPONSIBLE MAINTAIN THE EXISTING UNDERPASS LIGHTING UNDER THE WESTBOUND U.S. ROUTE 30 BRIDGE DECK OPERATIONAL IF NOT AFFECTED BY THE BRIDGE DECK REMOVAL. CONTRACTOR IS RESPONSIBLE TO MAKE THE PROPOSED UNDERPASS LIGHTING UNDER THE EASTBOUND U.S. ROUTE 30 BRIDGE DECK OPERATIONAL BEFORE REMOVING THE EXISTING UNDERPASS LIGHTING UNDER THE WESTBOUND U.S. ROUTE 30 BRIDGE DECK. THIS WORK SHALL BE INCIDENTAL TO THE MAINTENANCE OF LIGHTING SYSTEM PAY ITEM.
4. THE EXISTING UNDERGROUND UNIT DUCTS GOING TO THE JUNCTION BOX ATTACHED TO THE BRIDGE PIER AND FROM THE JUNCTION BOX TO THE EXISTING HIGH MAST LIGHTING TOWER SHALL BE ADJUSTED OR RE-ROUTED TO MAINTAIN EXISTING LIGHTING SYSTEM OPERATIONAL DURING CONSTRUCTION IF DEEMED NECESSARY DURING EXCAVATION WORK FOR THE BRIDGE PIER EXTENSION CONSTRUCTION. THIS WORK SHALL BE INCIDENTAL TO THE MAINTENANCE OF LIGHTING SYSTEM PAY ITEM.

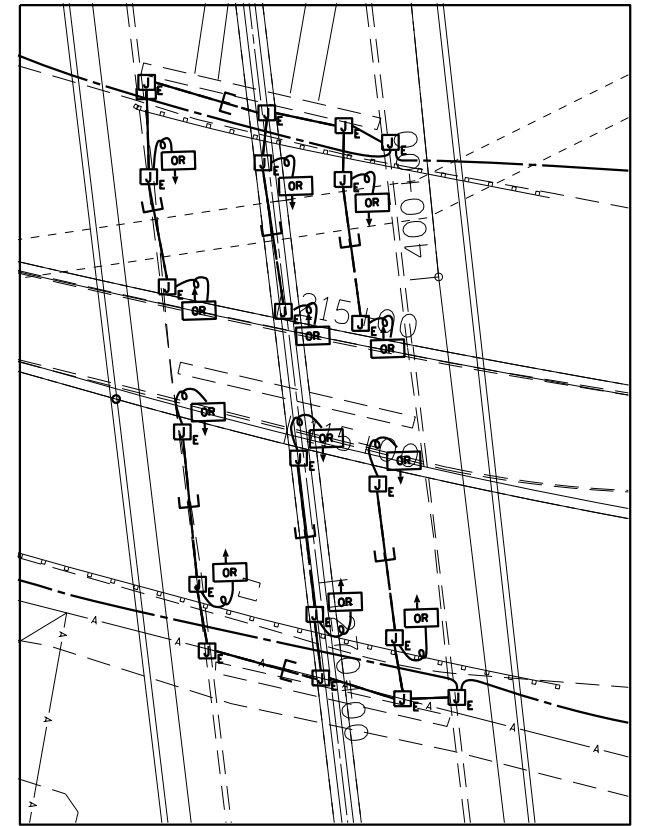
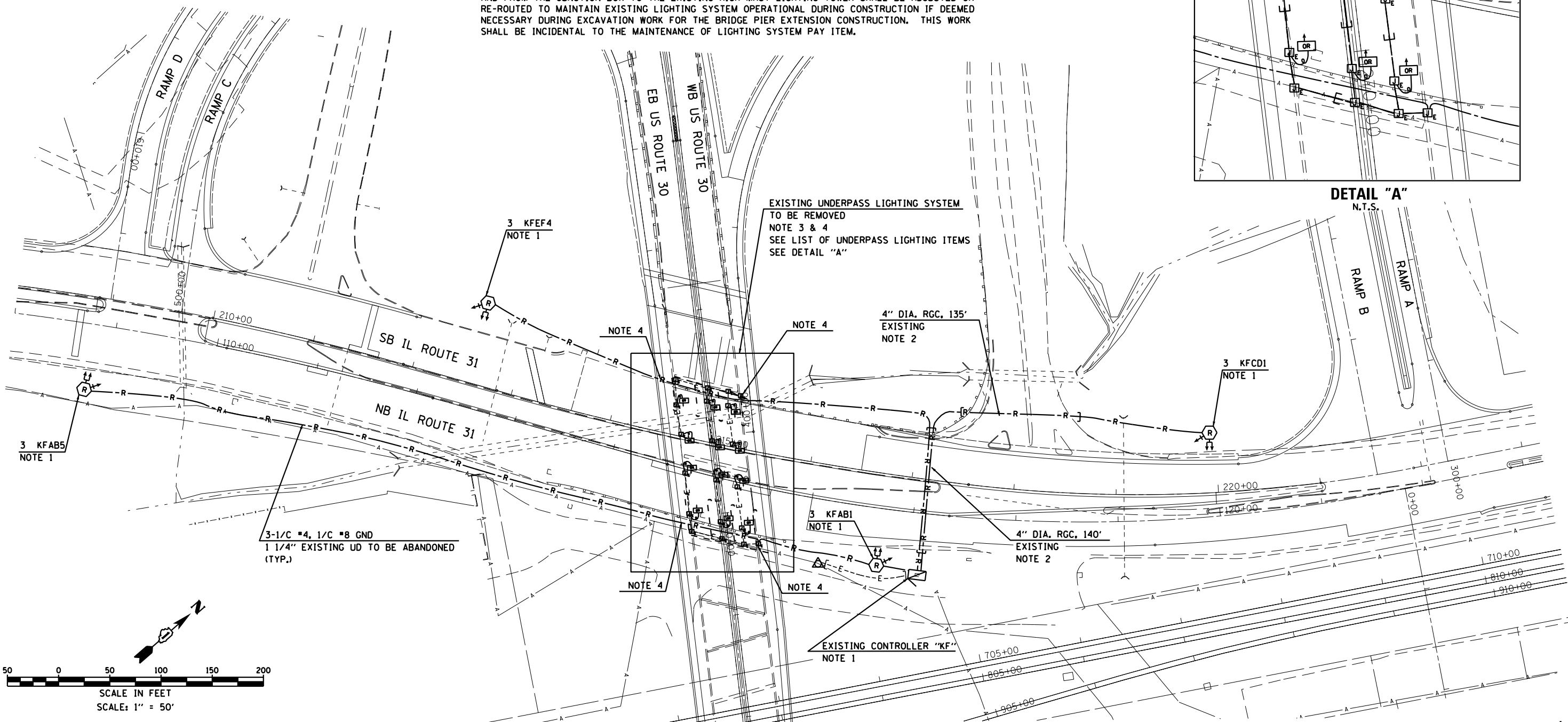

DETAIL "A"
N.T.S.

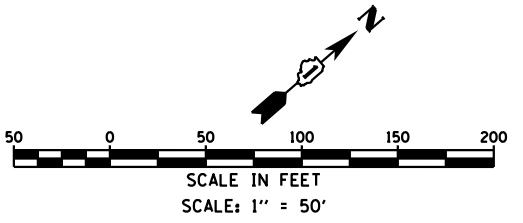

J:\265\dgn\Sheets\10033-shr-light-03.dgn
 6/26/2012 11:26:30 AM

SINGH
CONSULTING ENGINEERS
www.singhinc.com

USER NAME = kprejapati	DESIGNED - KP	REVISED -
	DRAWN - WC/RP	REVISED -
PLOT SCALE = 1/8" = 100'	CHECKED - GR	REVISED -
PLOT DATE = 6/26/2012	DATE - 06/15/2012	REVISED -

STATE OF ILLINOIS
DEPARTMENT OF TRANSPORTATION

U.S. ROUTE 30 AT IL ROUTE 31
EXISTING LIGHTING REMOVAL AND TEMPORARY LIGHTING PLANS
SCALE: AS NOTED SHEET NO. 3 OF 27 SHEETS STA. ----- TO STA. -----

F.A.P. RTE.	SECTION	COUNTY	TOTAL SHEETS	SHEET NO.
349	(10 & 11 VB) R-3	-	507	197
KANE AND KENDALL			CONTRACT NO. 60133	
ILLINOIS FED. AID PROJECT				