

**NOTES:**

1. THE LIGHT TOWER AND LIGHT TOWER FOUNDATION SHALL BE PAID FOR SEPARATELY. ALL REMAINING WORK INCLUDING GRADING, FILL, SERVICE PAD, RUSTICATION, CONCRETE AND REINFORCEMENT SHALL BE PAID FOR AT THE CONTRACT UNIT PRICE PER EACH FOR "LIGHT TOWER SERVICE PAD".
2. SEE IDOT-D1 DRAWING NO BE-501 FOR TOWER FOUNDATION AND GROUND WELL DETAILS.

**TYPE A - LIGHT TOWER, SERVICE PAD DETAILS - PLAN VIEW**

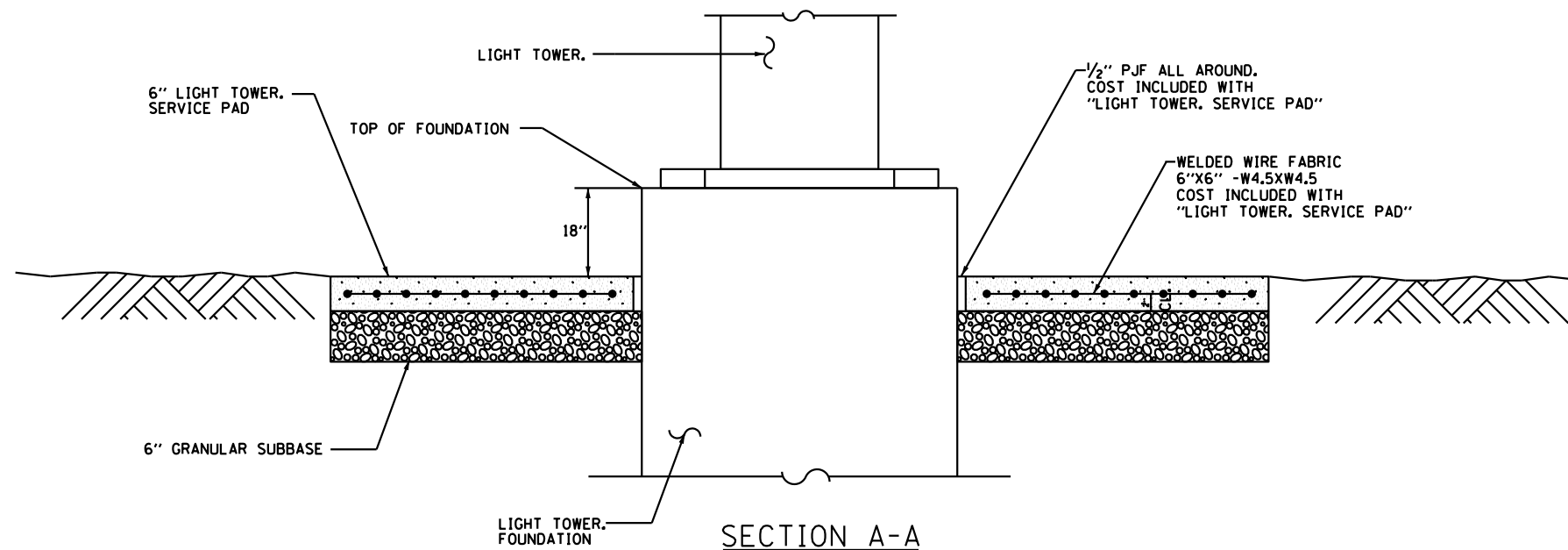

**SECTION A-A**

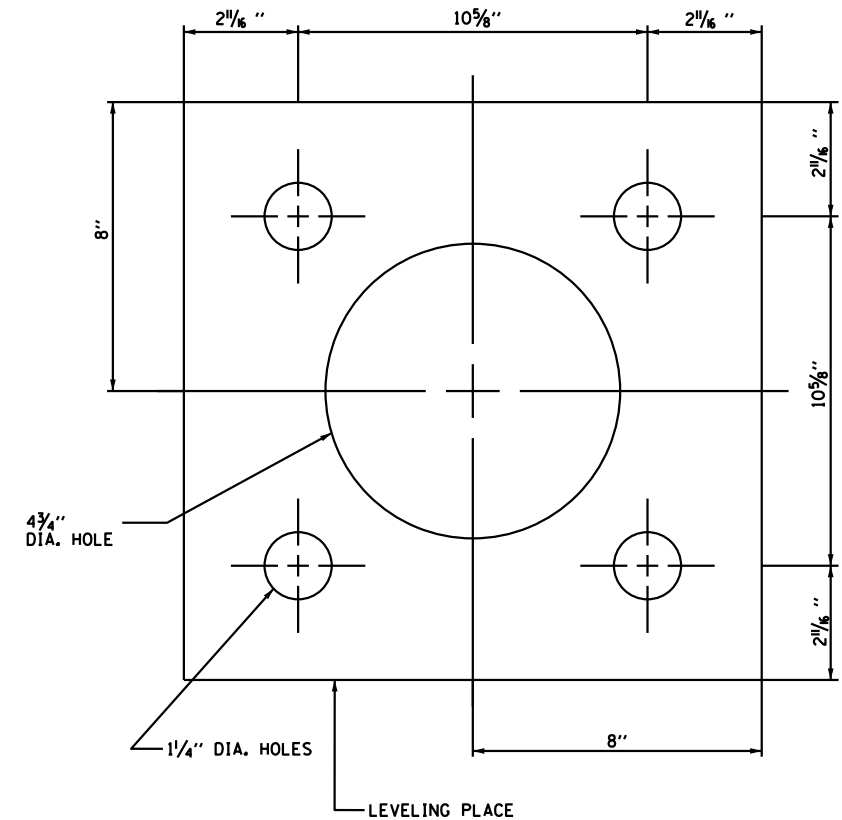

**LEVELING PLATE DETAIL  
FOR STRUCTURE MOUNTED LIGHT POLE.**

J:\265\dgn\Sheets\10033-shr-light-14.dgn  
 6/26/2012 11:26:48 AM

**SINGH**  
 CONSULTING ENGINEERS  
 www.singhinc.com

USER NAME = kprejapati	DESIGNED - KP	REVISED -
PLOT SCALE = 200.0000' / in.	DRAWN - WC/RP	REVISED -
PLOT DATE = 6/26/2012	CHECKED - GR	REVISED -
	DATE - 06/15/2012	REVISED -

**STATE OF ILLINOIS  
 DEPARTMENT OF TRANSPORTATION**

**U.S. ROUTE 30 AT IL ROUTE 31  
 HIGH MAST TOWER PAD DETAIL - TYPE A**

SCALE: N.T.S. SHEET NO. 14 OF 27 SHEETS STA. ----- TO STA. -----

F.A.P. RTE.	SECTION	COUNTY	TOTAL SHEETS	SHEET NO.
349	(10 & 11 VB) R-3	*	507	208
* KANE AND KENDALL			CONTRACT NO. 60133	
ILLINOIS FED. AID PROJECT				