

FIELD SPLICES - W36 x 160
(Splices 1 thru 3)

FIELD SPLICES - W33 x 130
(Splices 4 thru 7)

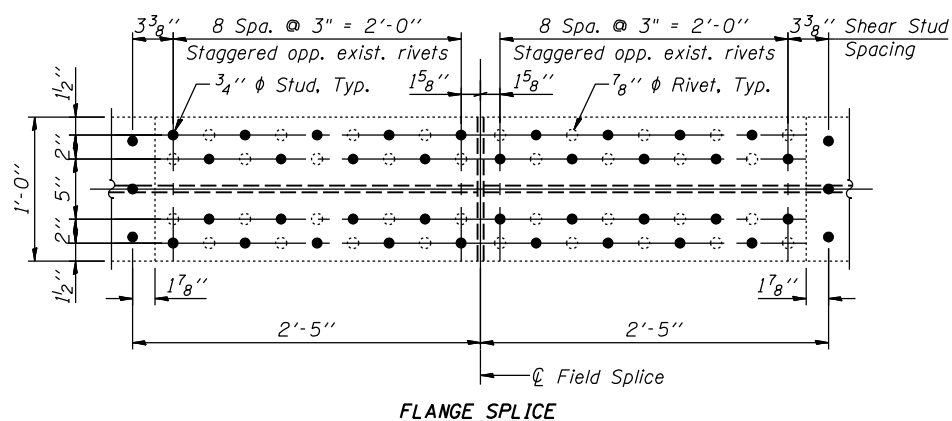

EXISTING FIELD SPLICES - 36 WF 182 & 36 WF 150

NOTES

1. Work this sheet with Sheets S42 thru S46 and S48 thru S50.
2. Load carrying components designated "NTR" shall conform to the Impact Testing Requirement, Zone 2.

P:\10522010\20103003\cadd\structure\dwg\045-0039_f\incl\00\1060133-e047-fid-splc-dt.dgn
 6/14/2012 6:07:41PM

USER NAME =	DESIGNED - J.Z. 6/15/2012	REVISED -
PLOT SCALE =	CHECKED - J.A.Z. 6/15/2012	REVISED -
PLOT DATE =	DRAWN - E.U.B. 6/15/2012	REVISED -
	CHECKED - J.Z. 6/15/2012	REVISED -

F.A.P. RTE.	SECTION	COUNTY	TOTAL SHEETS	SHEET NO.
349	(10 & 11VB) R-3	KANE	507	268
CONTRACT NO. 60133				